

BOUNDARY ADJUSTMENT SURVEY

MAP FILE M.114-40
C.S. File No. 63/135

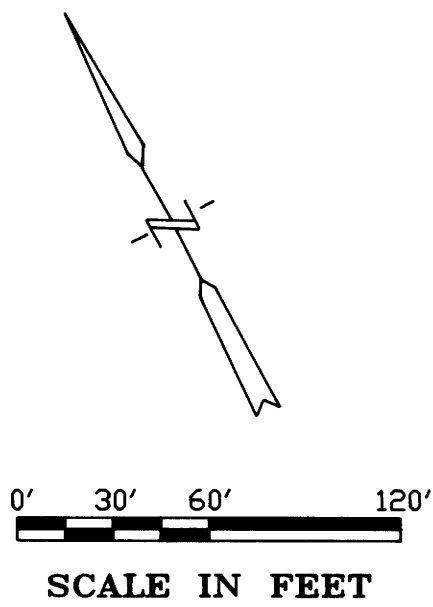

LEGEND:

- SET 5/8" DIA. X 30" IRON ROD WITH PLASTIC CAP, #872.
- FOUND MONUMENTS, AS NOTED.
- SET HUB
- CALCULATED CORNER ON BROZIO ROAD R/W, (NOT SET)
- EXISTING POWER LINE
- EXISTING NATURAL GAS LINE
- EXISTING TELEPHONE LINE
- EXISTING FENCE

ALL OTHERS AS NOTED ON PLAN.

NOTES:

TEMP. BENCH MARK:
SPIKE IN RED AND WHITE FENCE POST,
SOUTH R/W COUNTY ROAD NEAR
TELEPHONE RISER.
T.B.M. ELEV.=618.30.
BEARINGS SHOWN ARE TRUE.
θ = -1° 58' 08"
NARRATIVE FIELD NOTES FILED SEPARATELY.

CORNER OF HOUSE 231.2'
ELEV. = 614.1

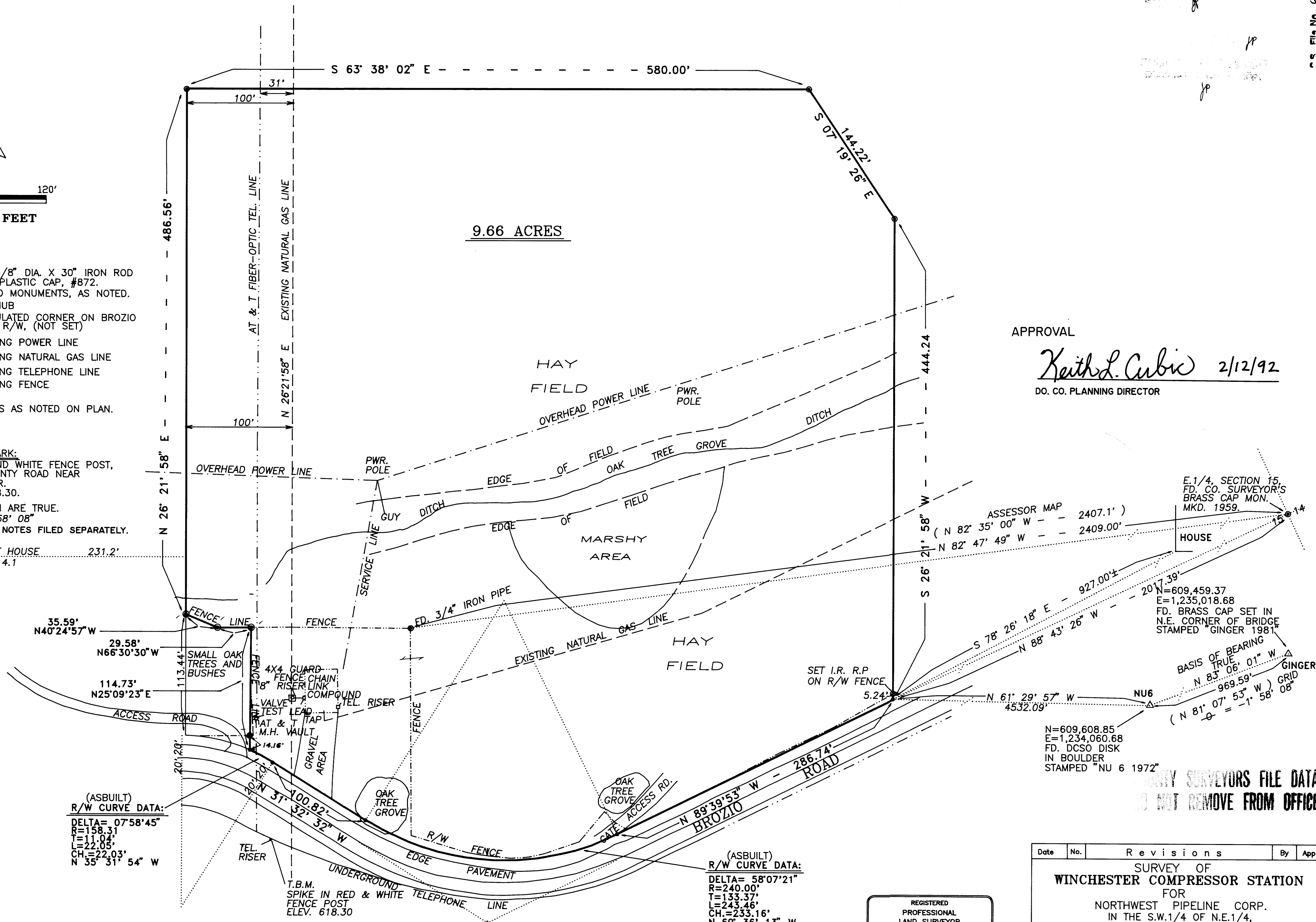

(ASBUILT)
R/W CURVE DATA:
DELTA= 07°58'45"
R=158.31
T=11.04'
L=22.05'
CH.=22.03'
N 35° 31' 54" W

(ASBUILT)
R/W CURVE DATA:
DELTA= 58°07'21"
R=240.00'
T=133.37'
L=243.46'
CH.=233.16'
N 60° 36' 13" W

APPROVAL

Keith L. Cubic 2/12/92

DO. CO. PLANNING DIRECTOR

E.1/4, SECTION 15,
FD. CO. SURVEYOR'S
BRASS CAP MON.
MKD. 1959.

ASSESSOR MAP
(N 82° 35' 00" W - 2407.1')
(N 82° 47' 49" W - 2409.00')

N=609,459.37
E=1,235,018.68
FD. BRASS CAP SET IN
N.E. CORNER OF BRIDGE
STAMPED "GINGER 1981"

BASIS OF BEARING
TRUE, 01° W
N 83° 06' 01" W
969.59'
(N 81° 07' 53" W) GRID
θ = -1° 58' 08"

N=609,608.85
E=1,234,060.68
FD. DCSO DISK
IN BOULDER
STAMPED "NU 6 1972"

**UTILITY SURVEYORS FILE DATA
DO NOT REMOVE FROM OFFICE**

REGISTERED
PROFESSIONAL
LAND SURVEYOR
David P. Tuttle
OREGON
DAVID L. TUTTLE
JULY 13, 1988
8 7 2

Date	No.	Revisions	By	App.
SURVEY OF WINCHESTER COMPRESSOR STATION FOR NORTHWEST PIPELINE CORP. IN THE S.W.1/4 OF N.E.1/4, SECTION 15, TWP. 26 S., RANGE 6 W. W.M. DOUGLAS COUNTY, OREGON				
Design	TENNESON ENGINEERING CORP.			Scale
Survey	Consulting Engineers 409 Lincoln Street The Dalles Oregon			Date 7/31/91
Drawn	Checked	Approved	Work Order No.	Sheet
E.H.			7593	1 of 1

MAP FILE M.114-40
C.S. File No. 63/135

M 114 - 40

ENGINEERING REPORTS

BUILDING DESIGN

LAND SURVEYS

CONSULTING
Engineers TENNESON ENGINEERING CORPORATION

PHONE (503) 296-9177
409 LINCOLN STREET
THE DALLES, ORE. 97058

December 18, 1991

FILED

Mr. Fritz Ingram
Douglas County Surveyor
Room 206, Justice Building
Roseburg, Oregon 97470

DEC 23 1991

**COUNTY SURVEYOR
DOUGLAS COUNTY, ORE.**

Reference: Work Order No. 7593 - Winchester Compressor Station
Northwest Pipeline Corporation

Dear Mr. Ingram:

Enclosed is an original mylar of the survey we did for Northwest Pipeline Corporation of the site known as Winchester Compressor Station. This is the one we submitted earlier which you returned for some corrections and additional information.

I understand there still may be a boundary change survey plat required but we are going ahead and file this as a preliminary filing drawing so you have something on record of this survey. As soon as Northwest Pipeline notifies us the revisions, we will then proceed to furnish the boundary change drawing.

If you have any questions, or need more information, please feel free to contact me.

Yours very truly,

TENNESON ENGINEERING CORPORATION

Donald J. Rohde, Corporate Secretary

DJR:lg
Enclosure

C.S. File No. 63/135

M 114-40

ENGINEERING REPORTS

BUILDING DESIGN

LAND SURVEYS

CONSULTING
Engineers TENNESON ENGINEERING CORPORATION

PHONE (503) 296-9177
409 LINCOLN STREET
THE DALLES, ORE. 97058

November 1, 1991

FIELD NOTES: Northwest Pipeline Corporation
Work Order No. 7593

CREW: David L. Tuttle, Oregon Land Surveyor #872
Douglas Stroh, Assistant

EQUIPMENT: Wild T-1600, E.D.M. and 1" Theodolite
Relative accuracy of this survey is a closed traverse
of 1 part in 66,000.

DATE COMPLETED: October 20, 1991

REFERENCE: Douglas County Alignment Map of Brozio Road #89
Douglas County Vertical and Horizontal Control and
Section Corner Data.
Northwest Pipeline Drawing 2443.0-21
Unrecorded survey by El Paso Gas Company in 1963. Drawing
#2443.9-X-0.

A SURVEY IN SECTION 15,
TOWNSHIP 26 SOUTH, RANGE 6 WEST,
WILLAMETTE MERIDIAN, DOUGLAS COUNTY, OREGON

On May 10, 1991, our firm was retained by Northwest Pipeline Corporation to survey and set boundaries for a proposed compressor station along their existing natural gas line near Winchester, Oregon.

Prior to beginning the survey, the Douglas County Surveyor's Office records were researched. Those drawings used as reference are noted above.

The survey was carried out by locating the existing buried natural gas line. The South line and a portion of the North line were laid off parallel to the gas line. The West line is formed by the apparent right-of-way of Brozio Road. A portion of the Northwest corner of the tract was formed by an agreed upon fence line.

The alignment of Brozio Road, past subject's property, could not be found of record. The alignment is an as-built with references set in the approximate right-of-way fences.

C.S. File No. 63/135

M 114 - 40

FIELD NOTES - Northwest Pipeline Corporation
Work Order No. 7593
November 1, 1991
Page 2

Corners set are 5/8" x 30" rebar with yellow plastic caps attached marked L.S.#872. Bearings are based on the Oregon Coordinate System from a tie made to the Douglas County monuments marked "Ginger" and "NU6". Said monuments and coordinates provided by the Douglas County Surveyor's Office.

Corners found or set during the course of this survey, along with measured angles, distances and ties, are shown on the attached map, Tenneson Engineering Corporation Work Order No. 7593, which by reference is made a part hereof.

Signed:

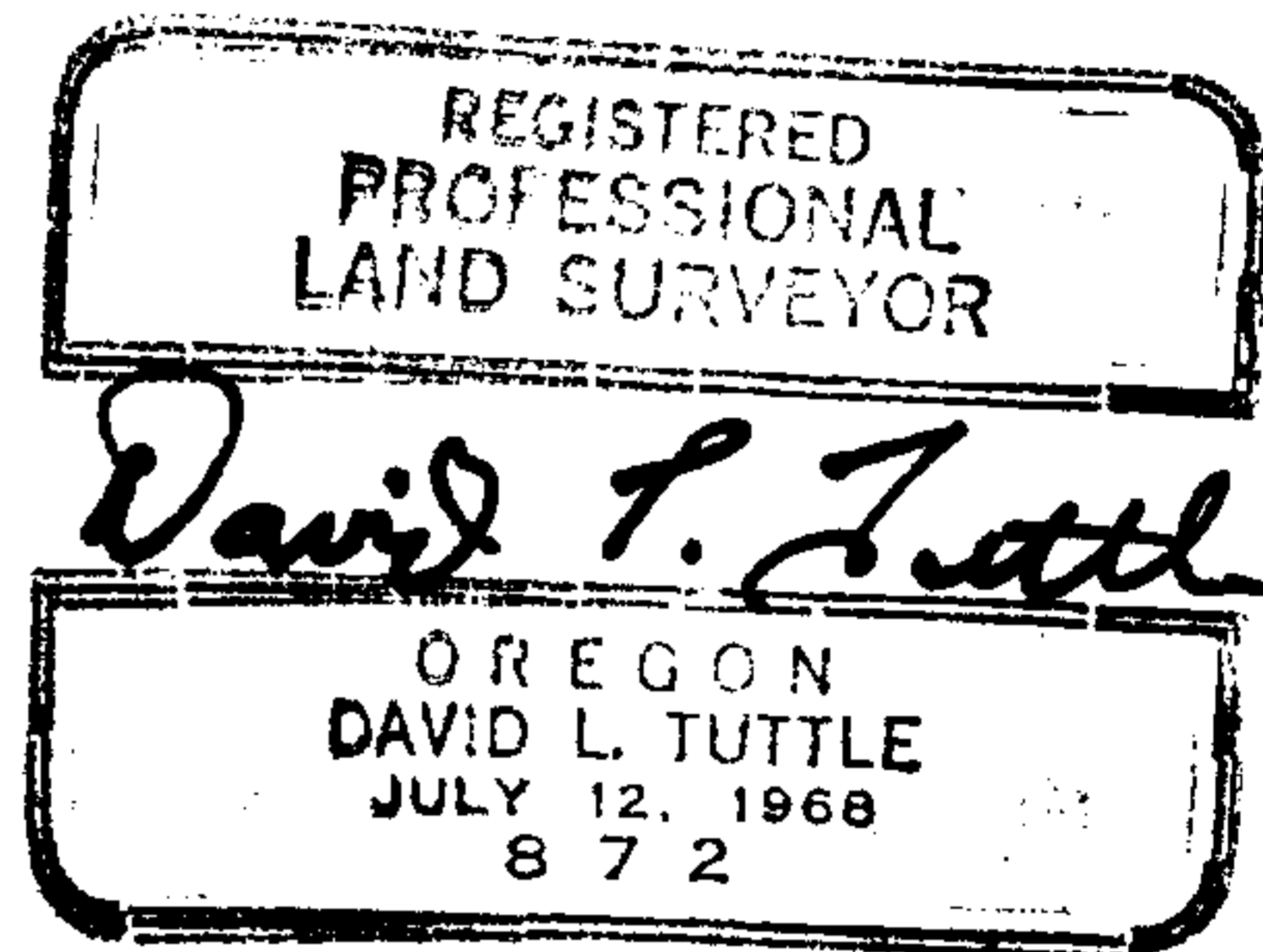

CHECKED AND APPROVED
TENNESON ENGINEERING CORPORATION

Donald J. Branton, President

FILED

DEC 23 1991

COUNTY SURVEYOR
DOUGLAS COUNTY, ORE.

C.S. File No. 63/135