

SEC. 4 & 5, T. 21 S., R. 12 W., W. M.

FILED
Date: 1/8/2001 By: JP
This survey consists of: 6 Pgs.
Map: M136-27A
Narrative:
Corner Rpt:

DOUGLAS COUNTY
SURVEYOR

CONFIDENCE LEVEL LIMITS

POINT	SEMI MAJOR	SEMI MINOR	ORIENTATION
100	0.003 m	0.002 m	S 61°24'10" E
101	0.003 m	0.002 m	S 70°04'03" E
102	0.003 m	0.001 m	S 69°57'51" E
103	0.003 m	0.001 m	S 61°38'23" E
104	0.003 m	0.001 m	S 61°22'46" E
107	0.004 m	0.001 m	S 59°21'17" E
109	0.007 m	0.001 m	S 58°11'02" E
110	0.008 m	0.001 m	S 61°62'28" E
105	0.004 m	0.002 m	S 61°17'12" E
106	0.004 m	0.002 m	S 61°00'00" E
108	0.006 m	0.001 m	S 56°33'24" E
112	0.009 m	0.001 m	S 66°23'04" E
113	0.009 m	0.001 m	S 67°12'53" E
116	0.011 m	0.001 m	S 71°30'31" E
117	0.012 m	0.001 m	S 73°14'42" E
118	0.014 m	0.002 m	S 75°57'06" E
115	0.012 m	0.002 m	S 77°31'07" E
120	0.016 m	0.002 m	S 80°09'30" E
111	0.010 m	0.002 m	S 60°02'08" E
114	0.008 m	0.002 m	S 75°05'06" E
119	0.013 m	0.002 m	S 79°53'40" E
122	0.019 m	0.003 m	S 87°46'12" E
121	0.018 m	0.003 m	S 86°24'29" E
123	0.020 m	0.003 m	N 88°29'03" E
140	0.018 m	0.003 m	S 87°13'43" E
124	0.022 m	0.005 m	N 81°21'03" E
125	0.023 m	0.005 m	N 79°38'50" E
126	0.023 m	0.006 m	N 75°50'09" E
128	0.028 m	0.009 m	N 59°06'18" E
129	0.029 m	0.010 m	N 55°51'38" E
127	0.025 m	0.008 m	N 65°24'27" E
130	0.028 m	0.010 m	N 54°10'14" E
131	0.032 m	0.011 m	N 48°43'32" E
132	0.033 m	0.011 m	N 46°29'23" E
138	0.035 m	0.012 m	N 42°52'27" E
139	0.036 m	0.012 m	N 41°51'12" E
133	0.033 m	0.011 m	N 49°34'30" E
135	0.036 m	0.011 m	N 46°20'29" E
137	0.032 m	0.012 m	N 40°48'00" E
136	0.033 m	0.012 m	N 43°37'22" E
134	0.035 m	0.011 m	N 47°54'08" E

BASIS OF BEARING

(FROM SHEET 2 OF 6)

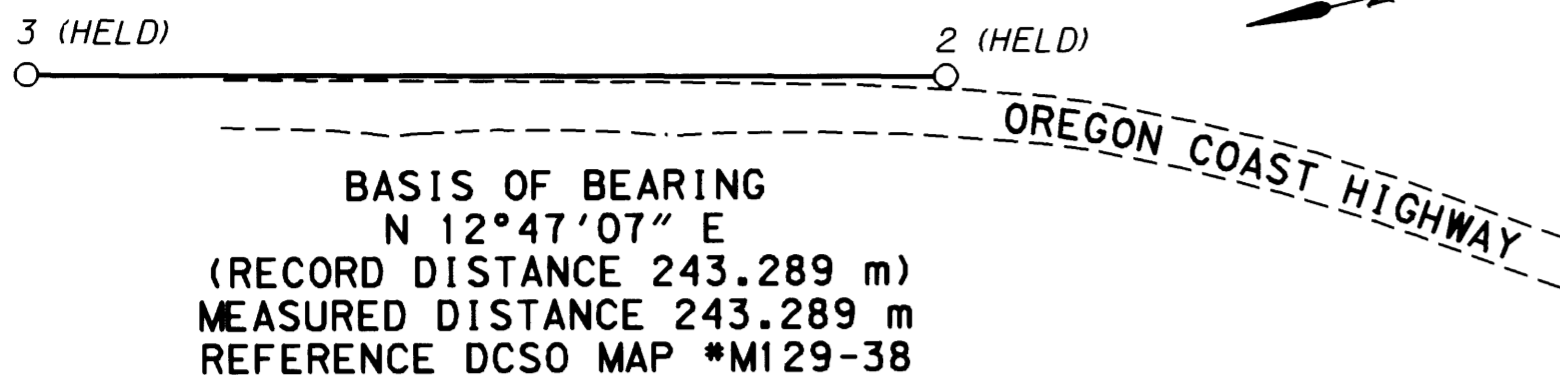

RETRACEMENT NARRATIVE

RETRACEMENT OF THE RIGHT-OF-WAY CENTERLINE AND BOUNDARY FOR THIS MAP ARE BASED ON ALIGNMENT DATA FOUND IN ODOT R/W DRG. NO. 7B-15-16 AND LOCATED R/W PINS FOUND DURING THE SURVEY. A TANGENT LINE WAS CREATED USING POINTS CALCULATED FROM A SPLIT OF THE DIFFERENCE BETWEEN RECORD OFFSETS OF R/W BOUNDARY POINTS 2036 AND 2037 (ENGLISH STA. 380+00) AND POINTS 2039 AND 2041 (ENGLISH STA. 385+00). THIS TANGENT LINE WAS THEN PROJECTED BACKWARD, RETRACING RECORD ALIGNMENT AND CURVE DATA TO THE BEGINNING OF THE PROJECT. STATIONING WAS OBTAINED BY CONVERTING ENGLISH STATION 375+47.33 P.T. TO METRIC. FOR THE PURPOSES OF THIS SURVEY THE PROPERTIES ADJACENT TO THE HIGHWAY CORRIDOR WERE NOT RETRACED.

NETWORK OBSERVATIONS

AT	TO
3	2, 100, 101, 102
2	3, 102, 103, 104, 107, 109, 110
100	3, 102
101	3, 102
102	3, 2, 100, 101, 103, 104, 107, 109, 3, 105, 106, 108
103	2, 102, 107, 109, 110
104	2, 102, 109, 110
105	102, 110, 112
106	102, 110, 112
107	2, 102, 109, 110, 112
108	102, 109, 110, 112, 113, 116, 117, 118
109	2, 102, 103, 104, 107, 108, 115
110	2, 103, 104, 105, 106, 107, 108, 112, 113, 2, 116, 117, 115, 118, 2, 120
112	105, 106, 107, 108, 110, 111, 114, 115, 105, 116, 117, 119, 120
111	112, 113
113	108, 110, 111, 114, 115, 116, 117, 119, 120
114	112, 113, 116
116	108, 110, 112, 113, 114, 115, 117, 119, 120
115	109, 110, 112, 113, 116, 117, 118, 120
117	108, 110, 112, 113, 116, 115, 119, 120
119	112, 113, 116, 117, 118
118	115, 119, 120, 122
120	110, 112, 113, 116, 115, 117, 118, 121, 122, 110, 123, 140
121	120, 122, 123,
140	120, 122, 123
122	118, 119, 120, 121, 140, 123, 124, 125, 126
123	120, 121, 122, 124, 125, 126, 140
124	122, 123, 125, 126
125	122, 123, 124, 126, 128, 129, 122, 123, 124, 127, 128, 129
127	126, 128,
128	125, 126, 127, 129, 130, 131, 132, 138, 139
130	128, 129
129	125, 126, 128, 130, 131, 132, 138, 139
131	126, 128, 129, 132, 133, 139, 126, 125
132	126, 129, 131, 133, 138, 139, 128
138	128, 129, 132, 135, 137
139	128, 129, 131, 132, 136, 137
136	139, 137
137	139, 138, 136
133	131, 132, 134
134	133, 135
135	138, 134

SURVEY NARRATIVE

THE PURPOSE OF THIS METRIC SURVEY WAS TO ESTABLISH HORIZONTAL CONTROL FOR AN OREGON DEPARTMENT OF TRANSPORTATION PROJECT CALLED "ELBOW CR. SLIDE" ON THE OREGON COAST HIGHWAY (HWY 101) FROM MILE POINT 204.8 TO MILE POINT 205.6. THE CONTROL NETWORK WAS CONDUCTED BY AN OREGON DEPARTMENT OF TRANSPORTATION (ODOT) SURVEY CREW BASED IN ROSEBURG FROM JULY 11 TO JULY 19, 2000. THE ORIGINAL FIELD NOTES ARE ARCHIVED IN SALEM AS BOOK #3735.

THIS SURVEY UTILIZES A LOCAL DATUM PLANE (LDP) COORDINATE SYSTEM WHICH IS RELATIVE TO THE OREGON COORDINATE SYSTEM (OCS), SOUTH ZONE, 1927 DATUM, WITH RESPECT TO LOCAL LATITUDE AND GROUND ELEVATIONS. THE LDP COORDINATES DEFINE TRUE GROUND DISTANCES. TO CONVERT METRIC COORDINATES TO ENGLISH COORDINATES, DIVIDE BY 0.30480061 (OR ONE METER = 3937 U.S. SURVEY FEET/1200).

POINT #2 AND POINT #3 FROM DOUGLAS COUNTY SURVEYORS OFFICE (DCSO) MAP *M129-38 WERE USED AS BASIS OF BEARING FOR THIS SURVEY.

A LEICA TCA 1800 TOTAL STATION (S/N 418939) WAS USED TO MAKE THE NETWORK OBSERVATIONS. THE LEICA TCA1800 HAS THE FOLLOWING ACCURACY: STANDARD ANGULAR ERROR OF +/- 1 SECOND AND STANDARD DISTANCE ERROR OF +/- 2 mm, +/- 2 PPM.

THE LEAST SQUARES ADJUSTMENT PRODUCED: ANGULAR RESIDUALS (THE AMOUNT THE FIELD OBSERVED ANGLES WERE CHANGED DUE TO THE ADJUSTMENT) 80% BEING WITHIN 3 SECONDS AND 100% BEING WITHIN 9 SECONDS. DISTANCE RESIDUALS (THE AMOUNT THE FIELD OBSERVED DISTANCES WERE CHANGED DUE TO ADJUSTMENTS) WHERE 100% OF THE RESIDUALS WERE WITHIN 4 mm.

THERE IS A 95% PROBABILITY THAT THE FINAL POSITIONS OF THE CONTROL POINTS ARE WITHIN THE ERROR ELLIPSES AS SHOWN IN THE "CONFIDENCE LEVEL LIMITS" TABLE.

LEGEND

- () RECORD DATA
- ▲ SET MONUMENT
- FOUND MONUMENT
- EDGE OF PAVEMENT
- R/W CENTER LINE

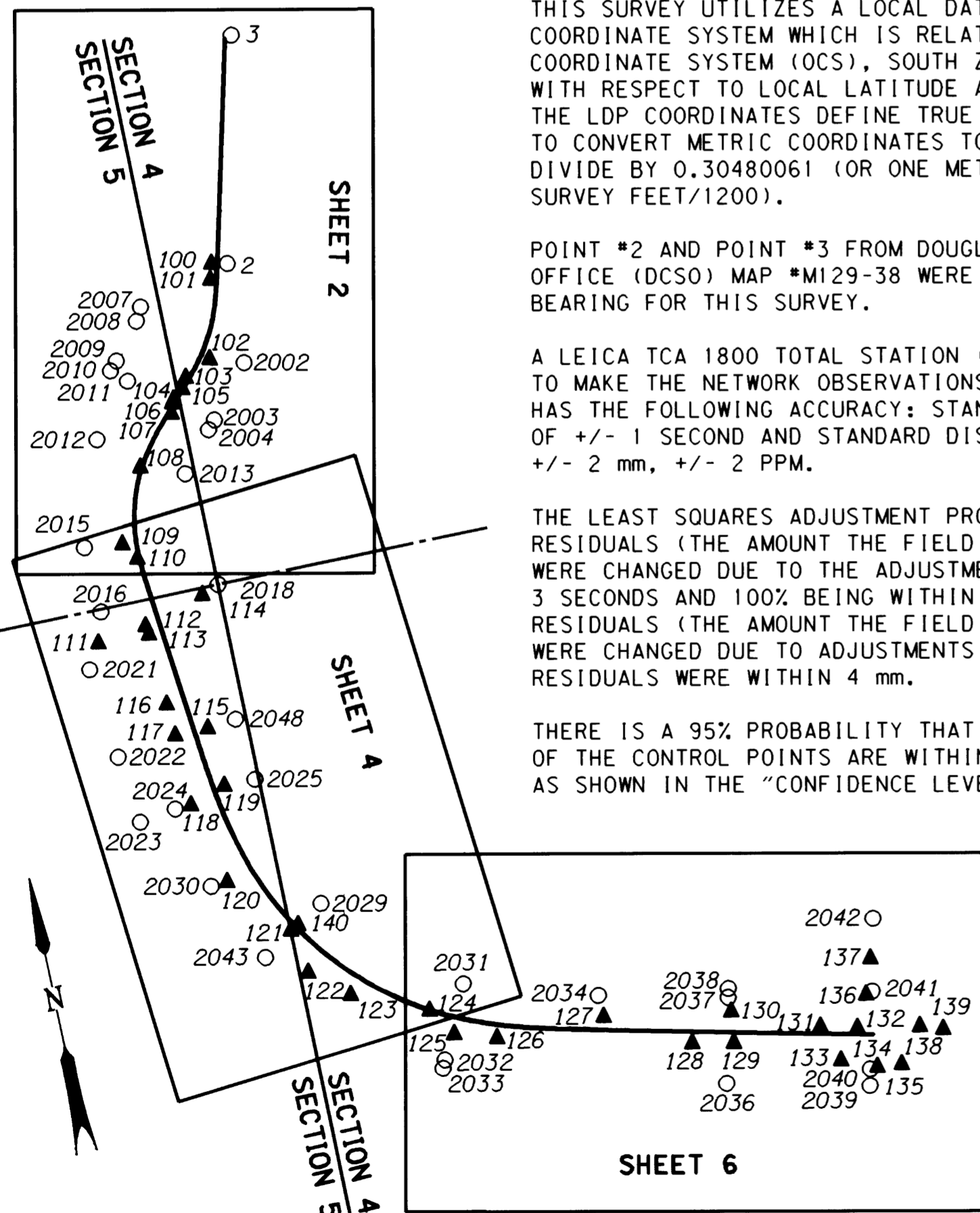

REGISTERED
PROFESSIONAL
LAND SURVEYOR
Christine V. Blawie
OREGON
JULY 19, 1994
CHRISTINE V. BLAWIE
2000
EXPIRES: DEC. 31, 2001

METRIC SURVEY
1 METER = 3937 U.S. FEET / 1200
TO CONVERT A METRIC DISTANCE DIVIDE BY 0.30480061

OREGON DEPARTMENT OF TRANSPORTATION
HORIZONTAL CONTROL, RECOVERY,
AND RETRACEMENT MAP
ELBOW CREEK SLIDE
OREGON COAST HIGHWAY (HWY. 101)
DOUGLAS COUNTY
3500 STEWART PARKWAY, SUITE 140
ROSEBURG, OREGON 97470

NETWORK SCHEMATIC AND SHEET LAYOUT DIAGRAM

NOT TO SCALE