

# DOUGLAS COUNTY HIGHWAY IMPROVEMENT

PROFILE AND ALIGNMENT  
YONCALLA - ELKHEAD ROAD

SECTION 2  
IN  
SECTIONS 1-6-31 Twp 23-22 S R 5-4 W W.M.  
STA 104+42.5 TO STA 137+81.5

OFFICE OF  
**F. C. FREAR**  
COUNTY SURVEYOR & ROADMASTER  
APRIL 1921  
Sheet No 2

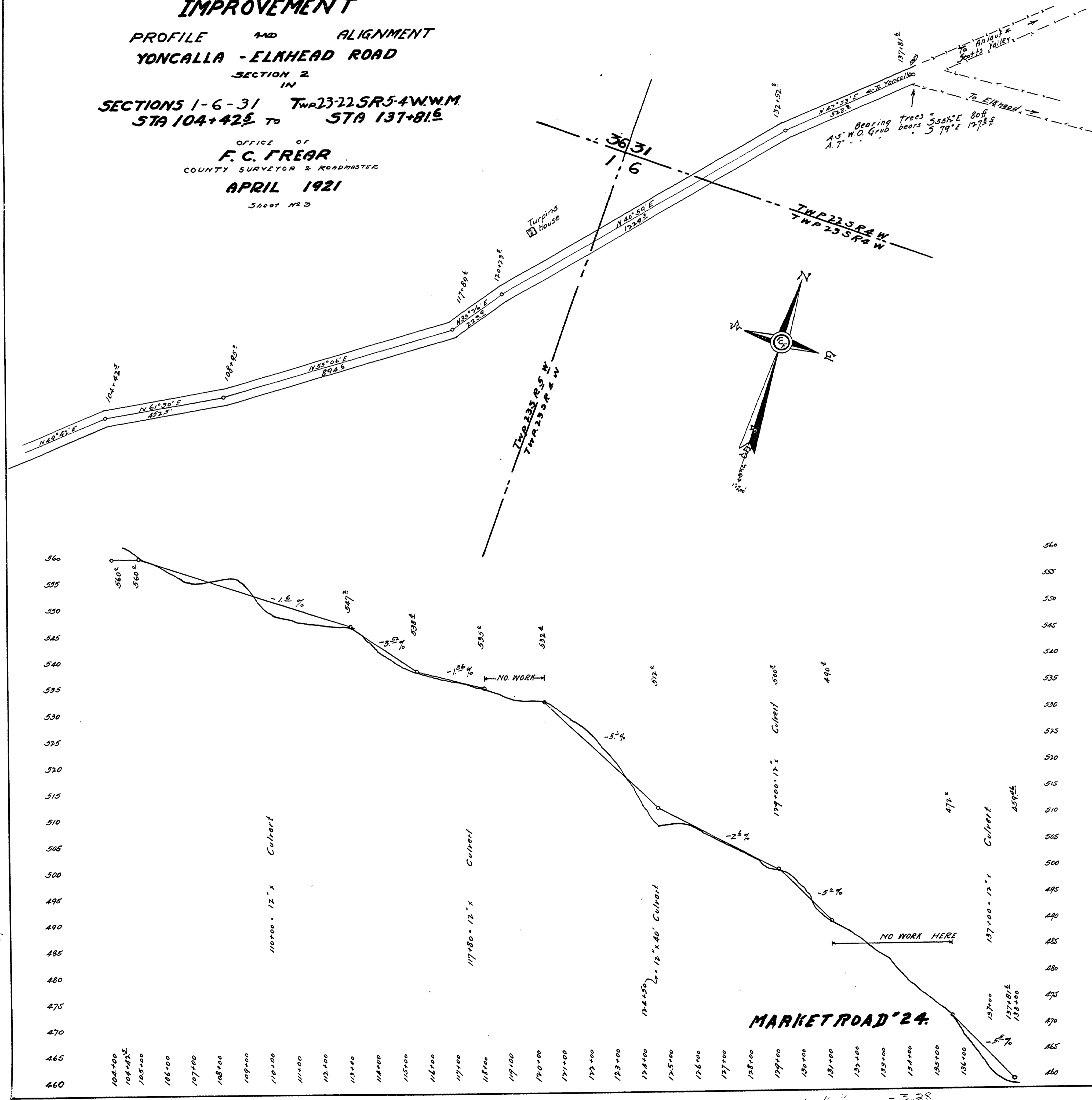

02650328