

F. B. No 1

Sept 22 FBI Pg. 0061

Field Notes of B. B. R. R.
Subdividing Thence
I found that S36.7
did on high mountain
unit to Survey.

I therefore began
at cor of S28.930
and ran N. but S. and
sections, ran 10.79
along base of Mt.

5.73 Run 18 in diameter

17.34 R. J. 24 in

3800 feet of Mt. N. N. S. E.

40.00 Set 40 cor on hill side

facing S. 430 to 14.12.16

B. L. Horn 24 S 73 W = 23

12 N 2 W = 76

Timber R. J. Horn National
Land poor & rocky
unsuit for cultivation

5707 Ham. 24 in
80 on S of Cor S 25, 20, 31
on hill facing N + 60

Granite 15, 10, 3

B.L. Ham. 50, N 32 E 20

R.F. 36. S 21 E 42

Ham 36 S 71 E 30

R.F. 6. N 22 W 43

Similar R.F. Ham.

Brick Basin, ...

land ...

this ...

along side

high range

mountain ...

859

N bet S25 & 26 T38

R 5 E van 18 2

560 Ann. 30 in Diameter

4000 Sat 1/4 cor on bench

at Mt - 300, ls 14.10.6

R 7 R 7 8 N 66 E 9

R 7 8 S 60 W 13

Upper Red from Brush Bar

land - rolling Stony

80 Sat cor S 23 24 25 26

on bench at Mt - 200

to granite 12 12 12

R 7 R 7 12 S 3 E 26

R 7 12 S 26 W 20

R 7 6 N 73 W 27

R 7 4 5 N 8 E 8

Upper Red from

limb, bahn & chink in

land - good timbered

land

1000

Q on road bet S 24th 25
T38R59 Var 19
down gentle slope of hill
H on setting near T130
6175 dry branch N of S
7950 fill 25 links N of
cor S 23 25 T38R59
N 89.49° W on line
bet S 24th 25
18.10 dry branch course N of S
3990 Set 1/2 cor stake 4 in
B J W P 15 N 12 E 13
R F 6 S 34 W 12
7980 cor S 23 24 25 26 + B is
Timber R F White Pine
Hemlock Jam
no rinder brush
land good rich
timber land

N. bet S 23 W 24 358

R 39 var 19

900 R F 30 in Diameter

1950 R F 60 " "

2300 To be rich in full 100

4000 Set 1/2 Sec Stake in

B. L. Jam. 6 S 10 E 10

Jam. 12 S 12 W 20

Timber Jam W P R F
no brush

good rich land

4500 low Jam Bottom 50

5000 margin B. Lake

Set Frac. cor S 23 W 24

Post 4 in in diameter

B. L. Jam. 8 S 7 E ~~48~~ 30

Jam. 6 S 7 W 20

Timber Jam R F 1/2 P

Brush, willow also grass

good rich bottom land

2000

W bet S 13 & 24. T 38 R 5 E

Jan 20

2190. S Margin of B. Lake

Set frac. cor post. 1/4 mi

B. T. Jan 10 S 34 E 135'

Jan 40 N 71 E 136'

Jan. bottom rich

land

Brush will be going

Sept 23 FBI 0004

I find that S. 26
Canyon high Mountain
I therefore run
W bet S 23 & 26 S 38 R 3 E
Van 20 along on side
of Mountain

3.65 R F 24 in in D diam

40.00 S at 7.00. W 12.10 6

on hill side facing
N. E. + 100

B. J. White pine 15 S 68 W 17

White pine 18 S 78 E 37

62.27 diam 30 in diameter

80.00 for S 22 23 26 & 27 + 70

granite 14 10 6

B. J. R F 8. S 28 E 18

diam 10 N 8 W 16

W P 10 N 74 E 45

R F 18 S 78 W 46

Tim R F M P diam. Bush
v. chin. alder land
side land with 5 pines hill

91100 193

N bet S 22 W 23 T 38 R 5 E

Mar 193

6.90 Kern 36 in in diameter

16.72 R F 30 " " "

34 in foot of steep hill - 800

40 on 1/2 cord on bench of hill - 500

Granite 18 14 3 8

B. J. W. P. 8. S 68 E 22

R F 12 S 62 W 44

Timber R. F. W. P. Kern

no brush, land steep & stony

45 Jam Bottom - 25

19.85 Prairie & brush 3 km

corn 50 & wheat 9

80 on top of ridge E & W + 50

Set cor 15 14 15 22 W 23

Granite 15 15 8

B. J. R. S. 8 9 29 13 - R F 8

5 35 2 W 48 - R F 15 13 5 W 40

Jam. 10 118 E 5 4

Timber R. J. W. P. Jam
 Brush willow alder huckle
 good land mostly rich
 Bottom bordering on
B. Lake

E bet S 14923 38 R 34 cor 17
 1250 margin of B Lake - 76 -
 Set frac cor S 14923
 Stake 3 in diameter
 B. J. Jam. 8. N 21 W
 Jam 6 S 29 W

Timber Jam R. J. W. P.
 brush huckle Berry Bals
 good rich timbered land

N. bet S 14 W 13 - T 38 R 5 E
 var 17

4000 S 4 Cor Stake 3 in

B.T. Jam. 12 N 43 W - 19

Jam. 10 N 82 E 37

Timber R. F. W. y. pine

Bush Balsam fir

land level wood

rich soil

4675/ 15 in diameter

8000 S 10 Cor S 10 11 14 W 15

Granite. 12. 10. 10

B.T. R F 12. S 43 W 20

R F 8 N 83 W 34

R F 8 S 78 E 10

R F 6 N 31 E 10

Timber R. F. W. y. pine

Bush Balsam fir

land level brush land

good soil heavy timber

FBI Pg

0006₅

9 Oct 5 11814 var 17 $\frac{1}{2}$

3250 margin of B Lake - 75

Set stake for trace cor

3 in in diameter

B.L. Jan 18 S 26 W 66

Jan. 15 N 88 W 67

Timber Jamy R.L.

brush balance Asp

land good

Sept. 24.

N bet S 102 W 11 T 35 R 5
var 17 1/2

1032 R F 10 in diameter

1402 R F 20 "

4000. Set cor on bench.

Granite 10/8/2

B. Jam 8 N 70 W 34

R. F. 14. S 86 E 44

Timber, Jam, R. F. 45

no brush, good bench
land.

4537 Jam 8. diameter

7300 running brook 17 1/2

8000. Set cor 2, 3, 10, 11

Stake 4 in diam - 75

B. L. Jam 6 S 78 E 12

Jam 6 S 34 W 17

Jam 8. N 40 W 6

Jam 8. N 33 E 19

Jam, Timber no brush
good rich land

E. on ram bet S 28 11

of 1/2 12 var. 19 1/2

2.00 granite bottoming S 150

9.00 edge of timber

13.25 running brook S 100

course S 100

13.85 recrop brook course NE

16.83 recrop brook in S

21.90 road to B Lake S E 1/4 N

33.00 running B 3 L S

35.00 foot of hill

40.00 Sat temple on

hill side facing S + 50

62.00 top of ridge NE S + 50

80.00 Sat temple on S 1.2. 11/2

on hill facing S + 50

Thence E bet S 1/2

40.00 Sat temple + 50

80.82 fell 68 links S of

cor S 1/2 on E road

589³/₄ W on true line
bet S 18 12

40³/₄ ~~5~~ ⁴ cor granite 15-15 10

B. J. Jam. 18. N 42 50

Jam. 15 S 53 W 18

80³/₄ L. Cox Section 1.2 11 1/2 12

on hills facing N 75 0

granite 15 12. 12

B. J. R F 10 S 28 9 15

R F 10 S 22 W 20

Y. P. 36 N 15 W 36

Y. P. 18 N 10 E 18

this line runs over
rolling country good
land mostly chestnut
woods.

Timber Jam. R F Y P
very little underbrush
Thence

589³/₄ on true line

bet S 2¹/₁₁ var 18

1850 top of ridge NS + 50

40.15¹/₂ S ¹/₄ cor on hillside

facing S - 50

Granite 4.10.10

B. J. YP 125.15 W. 87

45 30 Jam. 6 NW. 45 - 50

47 30 Brook 3 links runs S

58 41 road to Blake S E of NW

63 47 Brook 3 links runs S

66 45 recrop Brook runs NE

67 05 recrop " " S

71 30 edge of granite bottom

78 30 " " timber

80 31 Cor S 2.3. 108 11

This line runs over
rolling country

good land

Timber Jam. B. J. Y. P.
no brush

8000

S bet S 114 12 T 35 25

var 18

30 00 Y P 36

40 00 OS 1/2 Cor Grant 12/12/10

B.J. R F G. N 52 E 19'

Y P. 10. S 58 E

Timber Land R F Y P 29

Brush, Balm & Asp

good bench land

5300 margin of B Lake - 50

Sat. face S Cor Stake 4 in

B. J. Jan. 12 N 38 W 36

Jan. 6. N 14 E 27

this line runs down

gradual descent of

hill, Timber Land

R F Y P Brush asp

& Balm good rich

land

FBI P₃ 00097

W Lot S120/13 J38 R54
var 20

17.50. margin of Botak

-100

S. of track S cor S120/13

post 3 in diameter

J.S. Jam. 6.5858-64

y P. 8. N34E. 100

Timber Jam. R.F. 1 P

Brush valm. Alpo

Sarwal

land good Timber
land

Sept 23rd

N bet SW² T38 R54

var 18

9.80 N P 48 in in D. in situ

4000 S of 1/4 S Corner on ridge

N 75° E granite 15 12 10 + 4 ft

B. S. Jam. 6 S 81° E - 8' Cub.

Jam 6 N 43° E 12'

80.00 S of Cor SW² T38 R54

S 35° 30' T37 R54

post 4 in Square

B. S. Jam. 8 N 25° E 15'

Jam 6 N 74° W 6 B

Jam. 8. S 31° W 15'

Jam. 12 S 28° E 6 B

this line runs over
rolling bench land

rich soil heavy Jam

& R F timber a J

Baldern buckles willow

brush

E on road about N
 road of S1 T38 R5E
 var. 20 1/2
 Horn set 1/2 5 cor.
 this line runs over
 level largely level
 good soil same R.F.
 by P. J. Fisher no way
 530 feet of hill N of
 80.10 Well 336 N of T 38 R 5 E
 T 38 R 5 E on hill
 W + 120
 N 89.46' W on true line
 along N road S1 T38 R5E
 27.10 feet of hill - 120
 40.05 Set 45 cor. C 12x10x6
 R.F. R.F. 70 S 46 W 58
 R.F. 48 N 15 E 42
 80.10 cor S 18 2 on N road
 T 38 R 5 E

0100

N bet S 2 & 3 T 38 R 3 E

Mar. 19^{1/2}

4:30 Brook runs SW 3 km

5:30 foot of hill

12 on top of ridge NW & SE 4 75

24:50 dry branch SW & NE - 50

27:50 top of bench 4 50

28:25 road to B Lake SW NW

40 00 S 1/4 cor. 10 10 10

B.J. Jan 10 S 21 W 4

Jan. 10 S 59 E 10

80 00 Set cor. S 2 & 3 on N

bound, T 38 R 3 E. Co. 30. 24. 8

B.J. R F 18. S 60 E 24

R F 18. S 19 W 44

R J 12 N 53 W 45

R F 48 N 58 E 7

Timber R.F. Jan. no

on Brush. This line

runs over slightly rising
bench land good soil burnt

E on road, along N
 bound S 2 T 38 R 5 E var. 19 1/2
 40.00 Set term. 1/4 S cor on top of
 bench + 100 feet
 5500 brink of hill. + 50
 70.00 foot of hill - 400
 80.25 fell 46 links S of cor
 S 1/2 on N bound T 38 R 5 E
 S 89° 40' W on true line
 along N bound S 2 T 38
 R 5 E var
 10.25 foot of hill
 25.25 top of hill + 400
 40.12 Set 1/4 S cor on bench
 of hill - 50. S 24.18.5
 B.L. R 5 S 73 W 23.
 R 7 6 N 53 E 29
 80.25 cor S 28 3 on N bound
 of T 38 R 5 E, this line runs
 through heavy timber R 7
 rds no bench

26

W bet S 22 & 27 S 38 R 3E

var. 20'

3.32 Kern 30 in Diameter

1121 Kern 36 "

4000 Set $\frac{1}{4}$ S cor. on hill side facing W - 200

Granite 75.14.10

B.S. R.F. 25 N 15 E 5'

Kern 20. S 12 W 29

4500 Alder S facing, and W

8000 Set cor S 21 & 22 & 27 & 28

on hill side facing W - 200

Granite 20.12.8

B.S. W.P. 20. N 82 E. 19

R.F. 20 S 43 E 22

W.P. 24. S 53 W 26

R.F. 18 N 82 W 47

This line runs down

gradual S slope of hill

Timber R.F. Kern. W.P. Birch

Alder. Substrate of fine gravel

N. lat S 21 $\frac{1}{2}$ 22. T38R5E
 var 18

or. 15 running brook W

434 R F 30 in in dia

1056 R F 20 "

4000 Set $\frac{1}{2}$ S cor S. 15-10 H

B.S. W.P. 24. S 21 E 7

Rem 12 S 76 W 29

80. Set cor S 15-16. 21 $\frac{1}{2}$ 22.

Granite. 14, 12 10

B.S. W.P. 30. S 34 W 25-

R F 12 S 76 E 21

Rem. 20 N 41 W 23

Rem. 24 N 22 E 47

This line runs over bench

land mostly level, good

timber land.

Timber. R.F. Rem. W.P.

no under brush

9th m. ran bet S 15th 22
 S 38 R 5 E. ran 18 $\frac{1}{2}$
 40 5th set term $\frac{1}{4}$ S cor
 80 5th - fell 26 links N of
 cor S 14 15 22 23

This line runs over
 rolling bench land
 Timber R. F. Hem. WP
 J. J. Sam. Brush
 Balm. fir alder
 N 89.49' W on true line
 bet S 15th 22 S 38 R 5 E. ran 7
 40 27 $\frac{1}{2}$ set $\frac{1}{4}$ S cor S 15 11 5
 B. J. WP 10 S 829 5
 M P 12 S 38 W 11

80 55 cor S 15 16 21 22
 This line runs over bench
 land Timber WP
 R F J. P. Brush balm
 fir &c

27

F.B. 1 Pg. 0013

W bet S 21 28 Y 38 R 5 E

var 19 1/2

34.00 Brook 5 links and

course SW

40.00 Set 1/2 S Cor G 12.10 18

B.T. WP 8. S 42 E 8

WF 3 - N 30 E 18

70.00 dry branch N 45

71.00 foot of bluff

72.00 top of bluff + 2 v

80.00 Cor S 20 21 28 29

Set G. 10 12 15

B.T. WF 10 S 31 E 17

WF 8 N 72 E 15

WP 25 S 31 W 30

WP 12 N 41 W 82

timber WP R F y P WF

brush, alder

rolling bench land

rocky unfit for crop

E on ran but S16821
 T38R5E var 19E
 4000 Set tem 4 S Cor
 8020 full 12 links N of
 cot S1516 21822
 N 89°55' W. on true line bet
 S16821. var 19

40.10 S 45 Cor 6 12-10 6
 B.S. Y. Pine 48. E. 3
 R.F. 48 N 40 W 26

8020 intersect cor S16172021
 This line runs over
 rolling brush land
 Stone suitable for cultivation
 Linton R.F. Horn of P
 W.P.
 Brush balin & fir

Sept 27

A bet S 20.21 T38

R5E var 19 1/2

1.45 Pine 30 diameter

4000 Set 45 cor 6, 6.10.12

B.L. WF 10 S 71E 13

WF 8 N 23W 3

8000 Set cor S 16 17 20 21

Granite 8.12.14.

B.L. WF 10 N 67W 45

WF 10 S 79W 30

Ham 40 N 17E 103

R 7 12 S 46E 10

Timber WF R 7 W 30

Ham Brush Balmy

Robing bench land

rocky soil not fit

for cultivation

N bet. S 13 W 16 J 38 R 54
var. 19

4000 S et S cur. l. 14 12 12

B J. R. F. 20 N 73 W 27

W. m. 30 S 60 E 21

8000 S et cur S 9 10 15 14

granite 16 12 8

B J. R. F. 12 N 66 W 18

R. F. 14 S 44 W 32

R. F. 14 N 54 E 38

R. F. 6 S 33 E 46

This line runs over
rolling bench land

Soil & Stone near
tumble. R. F. W. J. Kern,
W. P. Y. P.

Brush lalm chinquin
fir,

Gen road bet S 10 & 15
 var 2 1/2
 40 sit time 1 con
 80.10 fell 30 links N
 of cor S 10 & 14 & 15
 found that this line
 was run at to
 high var. I therefore
 ran W on true line
 bet S 10 & 15. var 1 1/2
 40.05 set 1/4 S cor on hill + 10
 granite 12 12 12
 B. J. R 24, S 36 W 20
 R 7 12 N 2 W 12
 80.10 intersect cor S
 9.10. 15 & 16
 this line runs over
 making bench land
 suitable for cultivation
 timber R. J. W. P. from
 no brush

Sept. 28

A bet S 10 W 33 R 5 E
var. used 19°

2014 W F 40 in 9 diameter
21 00 var 14 1/2° E

40 00 Set 45 cor 6 10 10 10

B.S. Horn 6 N 28 E 12

R.F. 12 N 88 W 24

var. of Needle 18° E

80 00 Set cor 3, 8, 9, 16, 17

Granite 18, 12, 14

B.S. R.F. 10 S 48 W 31

R.F. 8 S 34 E 21

R.F. 10 N 32 E 45

R.F. 30 N 59 W 25

This line runs over

Stony bench land

unsit for cultivation

Timber R.S. Horn, W.P. & P.

is under brush

E on road bet S 9 & 16
 T38 R3E var
 3000 brink of hill NWS
 4000 set 1/4 S cor on
 flat bench - 100
 8036 full 65 links N of cor
 S 9 & 10 16 & 16

N 89.32° W on true line bet
 S 9 & 16 T38 R5E var
 N 89.32° W on true line
 bet S 9 & 16 T38 R5E var 18
 4018 set 1/4 S cor tree 12 diam
 B.M. R.F. 20 S 53° W 12
 Run 30 N 3 E 33

at foot of hill
 5000 top of hill + 100
 8036 intersect cor S 8.9
 16 & 17

This line runs over
 bench land Timber stand
 R.F. no. bush

8100

N bet S 9 & 10 T 38 R 52

var 18 1/2

2122 Run 50 in in Diameter

410 Set of cor 14, 6, 20

B.T. R.F. 24 N 46 E 5'

R.F. 18 S 65 W 8'

4600 bank of hill N 45 E

8000 Set cor 5, 3, 4, 9 & 10

on bench of hill - 200

Granite 18, 6, 12

B.L. Run 18 N 43 E 22'

R.F. 18 N 40 W 32'

R.F. 15 S 34 W 45'

Run 30 S 10 E 52'

This line runs over rolling

bench land. Soil stony

Lumber Run R.F. W.P. & P.

Brush bar

E on road bet S3410
 T38 R3E var 18 1/2
 4000 Sct 1/4 Sec
 on hill side facing E
 - 150

80.46. fell 188 N of cor S
 2. B. 10011

N 88° 39' W on true line bet
 S3410 T38 R3E var 18 1/2

40.23 Sct 1/4 Sec on hill facing E
 + 50. G. 18. 12.5 B J. P. 12 N 35 W 17
 80.46 intersect the cor
 R F 12 S 42 E 10

S 3.4.9410 on bench of hill
 + 150

This line was run by
 needle, sun obscured
 Timber R. F. of P. Lam
 thru brush. Balance
 for good timber
 land

18 1/2

FB 1 Pg 0018

Gen Rand bet S 489
T38 Rd E var 18 1/2

4000 Sat. tem 1/5 cov at

foot of Butte - 300

79.68 fell 186 links S of cor
S 304.9.10

8

186

130

147

125

~~180~~ 233

293

147

299

2.80

2.00

4.80

86.00

4.80

81.20

1140

N bet S384, T38R5E

var. 19⁰⁰

4000 Set $\frac{1}{4}$ S cor ls. 20.8.6

B.L. R.F. 14 N 68E 12

Ann. 10 S 37W 29

7500 road to B Lake E W

8000 Set cor S384, T38R5E

S34W33, T37R5E, ls 14.12.6

B.L. Jam 8 S84E 135

Jam. 6 S17W 92

Jam 6 N81W 42

Jam 8 N37E 111

This line runs over rolling

bench land good soil

timber mostly burned

Jam. R.F. Hunt

no underbrush

E on road along stream
 of 53 38 R 59 way 20
 110 do. Set terminals on
 45 on dry branch ch 59 NW
 81.45, full 199. banks N of
 S

Aug 3. 1908

17-33-23.7

M. Gemma C. F.

7 10.1

17-26-13.6 + 43 = 17-26-56.6

39.1

25 345 + 1.00 = 17 21-34.5

39.1

24 554 + 1.26 = 17 25 = 31.4

$$\begin{array}{r} 3910 \\ 3910 \\ \hline 420.10 \\ 420 \end{array}$$
 M. Lumber 0020
 E on road bet 10815

Variety

T 32 S R 6 W

North bet Secs 27 + 28

17. Trail on Summit of ridge.

32.50 Str 4 lbs

40.00 Set post

W oak 8" dia S 67 W 66

" " 9 " N 62 E 125

45.00 Ridge

54.00 Str 4 lbs

80.00 Set post

B. B. oak 11" dia S 17° E 129 lbs

L. oak 10 " N 52 E 93 "

W oak 10 " N 61 W 121 "

" " 12 " S 39 W 102 "

North bet 33 + 24 80.00

Yel pine 30" dia N 36 E 90 "

" " 24 " N 27 W 43 "

" " 32 " S 45 W 35 "

" " 24 " S 30 E 62 "

North

3980
11940
60

But 34 + 35

80. Set post

Oak 13" dia S 40 E 93

" 12" " S 61 W 115

" 16" " N 85 W 125

" 14" " N 69 E 96

North but 26 + 27

4000 set post

B oak 15" dia S 48 E 61

" " 3 " N 49 W 15

80.00 Lam 5 set post

Lam 5" dia S 71 E 47

fir 6 " N 22 W 18

" 20 " N 61 E 60

Maple 5" S 75 W 94

W but 22 + 27

" Sta 16 lbs

2375 " 10 "

39.9 Set post

FBI Pg. 002A

W oak 11" dia S 68 E 188

W all 15 " N 42 E 168

224

Wrest bet 27 & 34

229 Summit of ridge

1020 set gv point

W fir 12 dia S 33

Chimney post 11 N 31 E 18

7490 Bottom of descent

7515 Station 20

8040

Aug 4 '08

17-17-366

1 594

17-15 37.2 + 1.36 = 17-17 132 7

14 ^{37.2} 57.4 + 1.00 = 17-15 374 8

14 ^{29.5} 77.6 + .73 = 17-15 506 9

13 ^{39.8} 37.8 + .35 = 17-14 128 10

13 39.8 + .30 = 17-13 280 11

12 58.0

12 ^{34.2} 78.2 + .30 = 17-12 482 12

12 39.8

11 38.4 + .30 = 17-12 084 1

10 ^{34.6} 58.6 + .35 = 17-11 336 2

FBI Pg 21A8

Line on road along S
bound S 34. 38 R 29 W 20
22.00 top of ridge +500
5650 Fredregal 3. 1/2 mile
cont. S
8000 Set term S on
hill side +500

This line runs over
rough hills land poor
and rocky

Lincoln best, Fir, y. P
Brush Balsam, Manzan

40

$$17-10-58.6+35=17-11-33.6 \quad \frac{52}{2} \quad 2$$

$$10 \quad \frac{398}{188} + 43 = 17-11 \quad 018 \quad \frac{31}{2} \quad 3$$

$$9 \quad \frac{398}{390} + 1.00 = 17-10 \quad 34 \quad \frac{700}{934} \quad 4$$

$$8 \quad \frac{398}{592} + 1.36 = 17-10-35.2 \quad 5$$

1907 ST
Gore rand along
S bound 8 35 T 38 R 52
van 21

4000 Set tem 45 corner
on hill facing Mt 300
8000. Set tem 3 cor. fell 234
N of Mt. Mc changed over
at hill side + 500
this line runs over
rough Mts. Soil
poor & rocky & claf
Timber fir cedar
y P
Brush Balsm fir

Even road down

S bond S36°38' R3° E on
 var 20 1/2

3.00 Top of Mt + 50

33 on high rock from which

Mt Pitt bears N 23° 10' W

Lake of woods N 9° W

Last river gap N 84° E

Little Chaminath from 1900
 to S 62° 45' E

Mt Chasta S 53° W

800 set tent & car on hill

facing E - 500

this fine crosses summit
 of high Mt. Rocky land

4 claps timber mostly

burned, Brush Balise

79	234
170	146
<hr/>	<hr/>
249	380
	<hr/>
	320
	79
	<hr/>
	399

Jan 3: 6

En on road at 2.5
bound 31 139 R 6 9
var 19

410 W. St. Tenn 1/5 cor
line runs over the
country

700 Brinks of Sleepstill
81 50 Mc fell 1/4 1/2 S
road lower N.

9100 interest line bet.
531 & 32 700 W. St. cor
S 1/2 1/2 on S bound of

FBI Pg. 22A^o

24.26, failed to find
L5 cor.

20. full 412 W of
cor of S 8.9, 16017 J415
R 8E

S bet 5 / 6017 J415 R 8E

15.00 Top of hill + 15.0

35.00 Sage plain - 3.00

36.40 intersect State

line 5.38 W of the
94th mile post

Aug 4 1908 9th Leonard
C.B.
East across sec. 27 T32S
RLW

Began at $\frac{1}{4}$ stake West side
Sec 27. Var $20^{\circ} 45' E$

46.00 Set traps

80.88 I fell 57 lbs N of $\frac{1}{4}$ corner
on West side Sec. 27

Began at $\frac{1}{4}$ stake on N side
of Sec 27

thence South thro center
of section. V $21^{\circ} 07'$

39.78 I fell 75 lbs E of 40 chs
traps on E+W center line

80.22 I fell 1.03 lbs E of $\frac{1}{4}$ corner
South side Sec 27

Aug 5 08 40.49
 FBI Pg 127 0023

17-1-32.6
 $\frac{2}{16} + \frac{1.5}{59} + \frac{40.5}{31.1} + 1.36 = 17 \quad 1 \quad 07.1 \quad 7$
 $\frac{40.5}{58} + 1.80 = 16-59 \quad 50.6 \quad 8$
 $\frac{40.5}{48} + 43 = 16-58 \quad 53.1 \quad 9$
 $\frac{40.5}{57} + 35 = 16-58-0 \quad 4.6 \quad 10$
 $\frac{40.5}{36} + 30 = 16-57-1 \quad 9.1 \quad 11$
 $\frac{40.5}{56} + 30 = 16-56 \quad 38.6 \quad 12$
 $\frac{40.5}{35} + 30 = 16 \quad 55 \quad 58.1 \quad 1$
 $\frac{40.5}{54} + 35 = 16 \quad 55 \quad 22.6 \quad 2$
 $\frac{40.5}{34} + 43 = 16 \quad 54 \quad 50.1 \quad 3$
 $\frac{40.5}{33} + 1 = 16 \quad 54 \quad 26.6 \quad 4$
 $\frac{40.5}{32} + 136 = 16 \quad 53 \quad 22.1 \quad 5$

Let you post at Can See
 from Kitch.

Doc road 5 N 62° 27' E 41
 Bulb only 5 S 22° 08' E 27
 Red fir 7 S 58° 30' W 31
 " " 12 N 11° 00' W 64

At 3/4 dist. on road way on
 E half of E center line of sec

2030 7.00

27 at 2037 from SE ^{Center of sec.}

2037 set your post for a con
& albert's 80 acres
from which

for Macdow's ¹⁰ sec N 38 1/2 W 24
a Maple 12" dia S 83 1/2 E 77

2007 Set your post for N.E. of
Scott's 80 from which

W pin 6 N 41 50 E 95

R 11 6 N 58 W 2.18

16-45-122

$\frac{2}{44.5}$
16-42-27.5 + 1.00 = 16-43-27.5

$\frac{41.2}{41-46.3} + 43 = 16-42-29.3$

$\frac{41.2}{41-45.1} + 35 = 16-41-40.1$

$\frac{41.7}{70-23.7} + 30 = 16-41-53$

$\frac{41.7}{39-41.7} + 30 = 16-40-11$

$\frac{41.7}{39-000} + 30 = 16-39-30$

41.17

16468
122
44.9

FBI Pg. 0024

Survey for School property
in Dist. No 128 Wandy Creek
Fernvale

Began at corner of secs
22, 23, 26 + 27 T32 S RLW

	Thence E	2.00 ch
"	N	7.74
"	N 70° E	5.00
"	N 45° 30' E	4.00
"	N 68° 30' E	7.00
"	N	95
"	E	4.00
8	S	2.50
4	W	4.00
10	N	1.55

11
12

to the line

H. G. Bernstein
Glendale, Ar

Field Book #1

Pages 25-38 Blank

FB 1 P 0039

Trander in Sec. 11

N	S	E	W
00.82			6.95
03			29
2.61			5.40
12			24
	1.41		11.92
	.07		63
1.43			5.83
20			84
2.33			4.41
23			44
	8.09		5.88
	4.58		2.07
	6.44	2.74	
	41	17	
	7.44		5.07
	15		10
	6.66	2.16	
	36	18	
7.79	35.70	5.25	30.07
80.00	5.300	80.31	3.250
87.79	88.78	85.56	82.57

Manderin 512

N	S	E	W
16.12			16.40
48			49
2.61			23.86
⁰⁷ 3.88			9 ⁶⁴ 24
⁰⁸			19
	118		6.00
	0		10
1.15			4.87
14			61

24.48	.18	8031	62.40
53.00	80.00		17.50
77.48	80.18	80.31	79.90
<u>79.18</u>			

2.2.00
 1.00
 1.12
 90

80329

Meander's Buck Lake

Began at meander post and

frac cor S 13 T 38 R 5 E S 18

T 38 R 6 E. 17.42 chs N of S

bound of said sections

1 Thence N 8 $\frac{1}{2}$ E 16.45 chains

2 Thence N 78 $\frac{1}{2}$ E 5.22 to ^{Lake} outlet

3 " " N 13 $\frac{1}{4}$ E 0.70 d across

outlet of lake Metap Creek

which runs E & W

4 Thence N 48 $\frac{1}{2}$ W 5.40 chs

5 " " N 26 $\frac{3}{4}$ W 7.81 "

to frac cor bet S 13 T 38 R 5 E

& S 18 T 38 R 6 E 34 mi. S of N

boundary of said sections

6 Thence N 9 $\frac{1}{2}$ W 23.30 chs

7 " " N 24 $\frac{1}{2}$ W 14.97 "

to frac cor S 12 & 13 T 38 R 5 E

17.50 chs N of E bound of said Sec

8 Thence N 45 $\frac{1}{2}$ W 23.69 chs

over

- 9 Thence N 83 $\frac{3}{4}$ W 24.63 chs
- 10 " " N 67 $\frac{1}{2}$ W 10.21 "
- 11 " " S 88 $\frac{1}{4}$ W 6.10 "
- 12 " " N 76 $\frac{3}{4}$ W 5.63 "

To frac cor S 112 12.130 chs
 South of $\frac{1}{4}$ S cor bet Said Sec.

- 13 N 83 $\frac{1}{4}$ W 7.29 chs
- 14 N 64 $\frac{1}{4}$ W 6.27 chs
- 15 S 83 $\frac{1}{4}$ W 12.67 "
- 16 N 76 $\frac{1}{4}$ W 6.86
- 17 N 62 W 4.72 ch to creek

10 links wide cor SE
 5.50 chs to organ post

- 18 S 36 W 10.00 chs
- 19 S 24 $\frac{1}{2}$ W 5.00 "
- 20 S 23 E 7.44 "
- 21 S 34 $\frac{1}{4}$ W 9.18 "
- 22 S 18 E 7.59

To frac cor S 114 32.50
 E of W bound of Said Sec

23	thence S $24\frac{3}{4}^{\circ}$ E	14.80 chs
24	S $19\frac{1}{2}^{\circ}$ E	3.39 "
25	S $28\frac{3}{4}^{\circ}$ W	6.83 "
26	S $18\frac{1}{4}^{\circ}$ W	8.12 "
27	S 41° W	8.80
28	S $28\frac{1}{2}^{\circ}$ E	7.77
29	S 51° W. 60 chs to creek	
	60 links side formed	
	by large spruce 2.50 chs	
	west of meander line	
	9.57 link to Meander	
30	thence S $52\frac{1}{2}^{\circ}$ E	6.04
31	" S $4\frac{1}{4}^{\circ}$ E	3.28
32	" S 78° W	3.80
33	" S $86\frac{3}{4}^{\circ}$ W	2.68
34	" S 20° W	21.51

to frac S. cor S, 14 $2\frac{1}{2}^{\circ}$
 12 B O E of W bound Sand
 Section

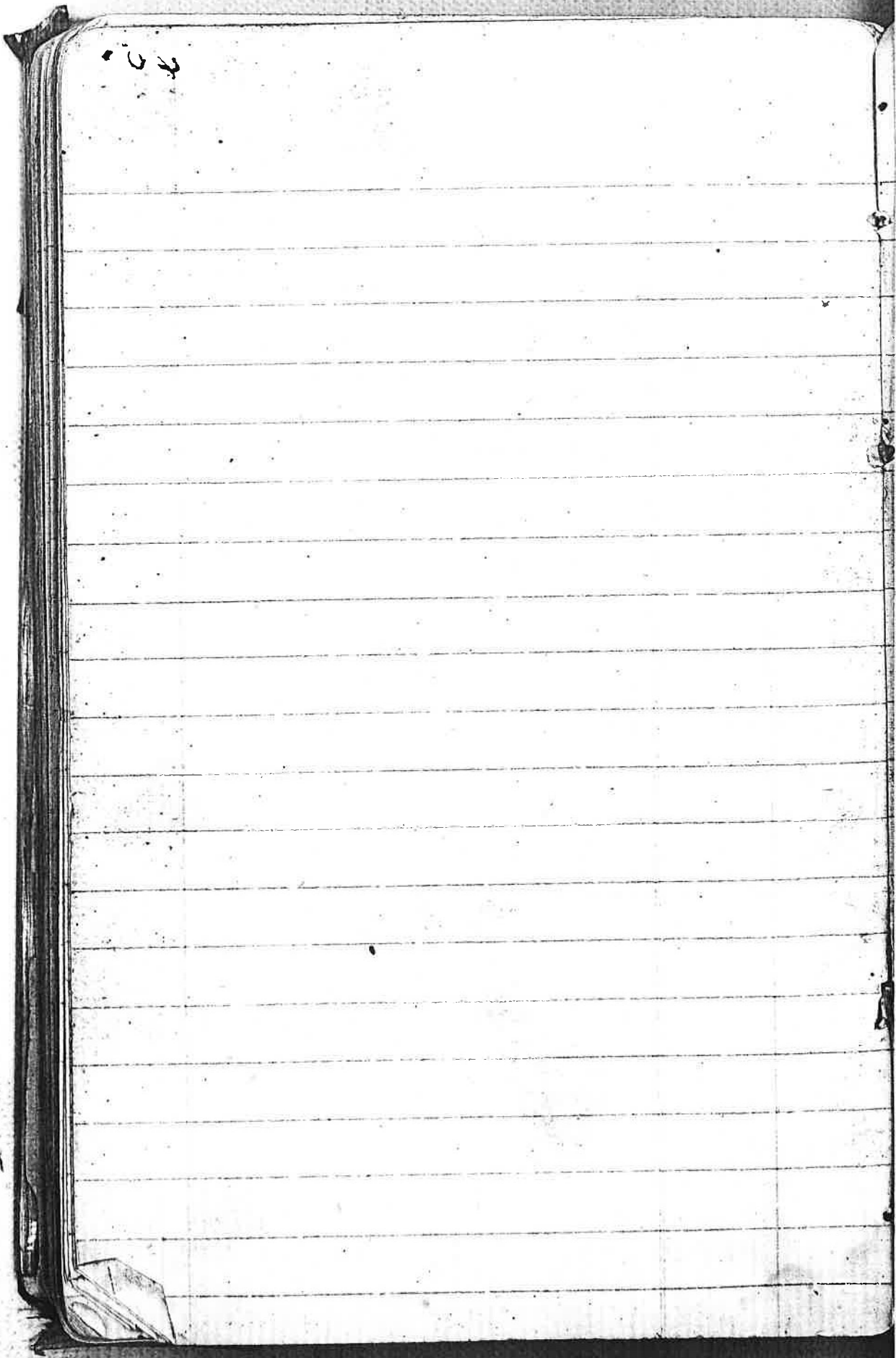

N	S	E	W
	7.56	2.60	
	11.67	2.80	
	9.18	—	5.09
	6.26		4.98
	10.43		3.49
	5.71		3.10
	11.68		2.75
	4.99		0.33
	3.76		1.37
	7.54		2.67
	6.1		2.2
8000	79.38	5.40	2402
		12.50	12.50
		32.50	
		37.90	3652
		36.32	
		1.58	

14

N. S. E. W

8.87 19.03
36 78

20.27 22.72
17.62 14.78
38 32

38.27 9.23 57.03
50.00 80.00 22.90 79.80

88.27 89.23 79.93
88 27
96
19

11.45 6.15
74 40
4.96 14.24
12 38

17.27 23.19 22.90

from frac cor S 23 24
40 S 63 E 21.86 chains

41 N 47 1/2 E 30.00 "

42 N 40 E 23.50 "

to frac cors 13 24, 22 24

chains N. of cors. 13 24, 24

T. 38 R 5 E and S. 18 21 9

T 38 R 6 E

43 N 28 1/4 E 138.4

44 N 73 E 17.10

to frac cors 13 T 38 R 5

and S 18 T 38 R 6 E

from S. bound of said

Sections

from frac cors 14 23

33 S 29 E - on main line

17.50 back N. line

21.50 to main post

36 N 58 E - B-50

37 N 8 1/4 E 14.25

38 S 50 1/2 E 24.00

39 5619 11.67 70.

frac cur 23022

N	S	E	W
	18° 81	10.42	
8.22		13.14	
2.17		14.09	
	15735	18.45	
	565	10.21	
1039	39.81	6631	8000
8000	5000	1230	7881
<u>4039</u>	8981	7881	<u>1.19</u>
8481			
58			

N 89° 28' W on a line line
along S. 1/4 Sec. 31, T37S, R5E
W. 16° E

40. 40 S. 1/4 Sec. 15, 10, 5 1/4 S.

Area 12 N 29° W 34, W. 7/10

N 52.26

83.85 Cor of Twp. 38 & 37, R
544 E

0043

N 89° 28' W on this line along
 S body Sec 34 T 37 R 5 E 2 19^b
 40.00 S. 18. 12. 4 Jan. 9. Δ 35 W
 44 Jan 9 N 30 1/4 E 85
 80. S 15. 13. 4 Cor Sec 33 & 34
 Jan 10. S 37 1/2 E 47 Jan. 12 N 41 1/2 E 40
 Jan 14, N 30 1/4 W 36 Jan 8 Δ 62 1/2 W
 - 91.

N 89° 28' W along S body Sec 33
 T 37 S R 5 E var 18^b
 40.00 S. 14. 10. 10. 1/4 S Jan 10 Δ 26
 S 54. Jan 12 N 22 1/2 E 79
 80. 00 S 18. 10. 4 Jan 5 7/4 1/2 E 34
 107. 30 Δ 39 1/2 W ⁶⁴ Jan 10 N
 27 1/2 E 64 W. P. 12 N 10 W 98

N 89° 28' W along S. body Sec. 32
 T 37 S R 5 E var. 16^b
S at front of wid. E of cor - 70 m. to the
 40.00 S. W 26 N 15 1/2 W 12. Aug 10
 Δ 1 E 17.

80 Cor Sec 31 & 32 S. 15. 12. 6
 W 7 15 Δ 47 W 15 W 7 30 Δ 65 S 47
 W. 7. 15 N 28 W 46 Aug 10 N 8 E 46

West ^{N 89° 28' W} on a true line

Along Sldy Sec 36 & 38

N 52°

40. Stom W. F 6 D 40 10 42, W 7

50 N 50 W 15,

80 Post-Cor Sec. 35 & 36, 142 J 37 &

385 N 52° for Wh a Jan

9. 167 E, 21. Jan 8 16 1/2 W

53. Jan 7 N 58 1/2 W 94

Jan 10 N 82, 102,

N 89° 28' W on true line along

Sldy Sec. 35 J 375 N 52° Va 19° 15'

1, 0. Set 1/45. W. F. N 70° 16'

37. W. F. 9 546 W 24 -

80. W. F. 16. 12. 6 W. F. Sec. 34 & 35

W. F. 20 N 70 E 11. W. F. 18 D 24

S 14. W. F. 24 N 11 W 29.

W. F. 12 D 52 1/2 W 30

47	44	10
40	46	47
36		46
27		

E on RD along S. by Sec 34
 37 S R 5 E Var 18° East
 40 S 1/4 S Low a Tamarack marsh
 Fir in mostly dead Tamarack
 50. Int- gum pine T. an a more
 heavy NW 1/4 E

79.79 To a point 522 lmb north
 of Cor Sec 35 T 38 R 5

80. S. T. Cor. to 349 35 T 37 S R 5 E
 Low light & stony low 30 chs
 mainly Tamarack & Hem Pine

E on RD along S. by Sec 35 T 37 S
 R 5 E Var 19 1/2°

40. T. 1/4 S. Land ascending a
 100. hill sloping to SW, heavy
 Fir Hem. Pine T.

52. Top of hill + 50

70. Foot of hill - 400 Int-Tamarack
 a flat

80 T. 1/4 Cor Sec. 35 & 36 T 37 S R 5 E
 hill steep & stony Tamarack
 flat level T. F. P. H. Tamarack

0045

2 along S. vely Sec 32 7375 R

var. 16 1/5 E

Road from Ashland to Pitts-
bury Vermont Lake. bears

2100 N E 4 SW

40.00 1/4 S. 2. des. E, Stony-
hill - well 7 Fir & Pine 250

50. To flat-top Fir Timber - 50

80 Set 1/4 cor p. To Sec 32 & 33.

Land last 30 ch, Town rack

has Stony high soil

2 along S. vely Sec 33 7375 R 55

var. 16 1/5 E

40. 1/4 S p. Land level top

Stony 7 Town rack & more

75.16 by dead

75.16 To a point - 4.54 N. of cor Sec 33

7385 R 55 1/4 N cor Sec. 33 & 34

77.00 1/4 cor. Sec 33 & 34

Oct-16-1870

Begin at The corner of Twp.
37438 N R 14518 and run
thence on a Random along
the S on the boundary of
Section 31 Twp 37 S. R 55 E
to cor 14015'

46 Set by 1/4 Sp. Land
+300 ascending to S. heavy T. +300

Fir Pine No. same & talus

53.00 Top of ascent +30

67. Land begins to ascend again

79. a stack of Rocks on top of

Top ridge +200

86.00 Set by cor. for 319 32

100 Twp 37 S R 55 E rolling & stony

heavily timbered with Pine

& Fir

~~48~~
~~80. Set by 1/4 Sp. Land for 32433~~

0045

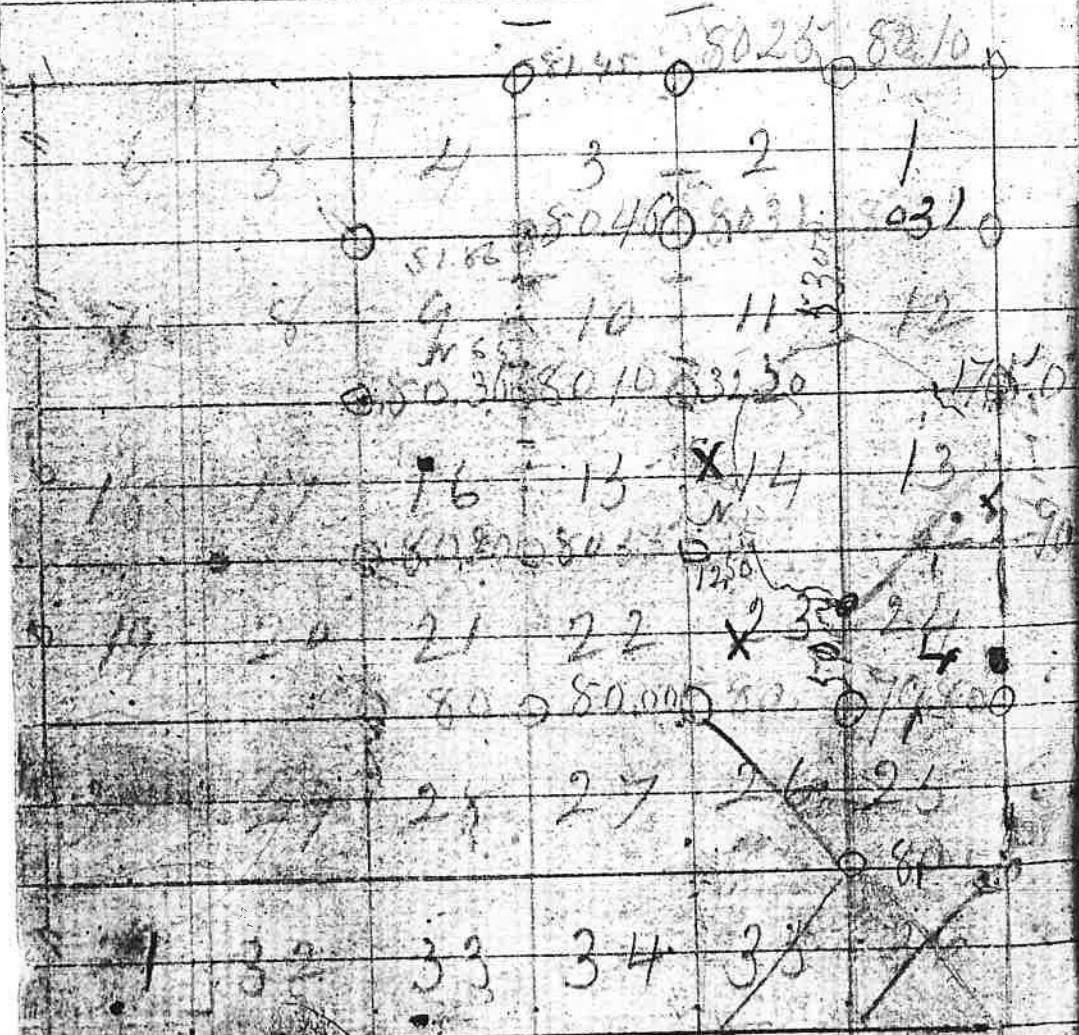

22
 29 24, 28
 12
348 30 2396