

MAP OF SURVEY

LOCATED in the NW & SW 1/4's of Section 5, T. 22 S., R. 9 W., W.M.
in Douglas County, Oregon.

July, 2025

FILED

Date: 7/29/25 By: KC
This survey consists of:

Map: M186-16

MAP FILE M186-16

CLOSING CORNER SECTIONS 5 AND 6.
FOUND 1977 B.L.M. BRASS CAP.
THE 1977 B.L.M. BEARING TREES ARE GONE.
FROM THIS POINT THE 1971 D.C.S. B.T.'S:
A 24" DIAM. FIR BEARS S 70° E, 8.1'
A 30" DIAM. FIR BEARS N 49° W, 12.4'
BOTH WITH HEALED BLAZE.
A 5.5' STEEL POST IS SET 2 FEET S 1° E ON LINE.

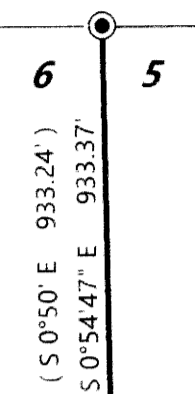

B.L.M.

CN 1/16 CORNER SECTION 5.
A 30" DIAM. FIR STUMP W/METAL CAP BEARS S 40 1/2° E, 40.9'
A 36" DIAM. HEMLOCK W/H.B. BEARS S 81 1/2° W, 24.1'
NEW B.T.: AN 18 DIAM. FIR SCRIBED "CN 1/16 S5 BT" BEARS N 18° W, 15.9'
A 5.5' STEEL POST IS SET 2 FEET S 1° E ON LINE.

SURVEYED FOR: ROSEBURG RESOURCES CO.
23129 VAUGHN ROAD
VENETA, OREGON 97487

SURVEYED BY: DAVID EDWARDS LAND SURVEYING
P.O. BOX 361
OAKLAND, OREGON 97462
PHONE: (541) 459-0512

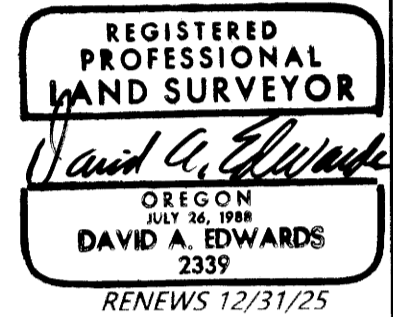

NORTH 1/16 CORNER SECTION 5 ONLY.
A TRIPLE MAPLE WITH NO VISIBLE
MARKS BEARS N 80° E, 14.9'
A 30" DIAM. FIR STUMP BEARS S 40 1/2° E, 42.2'
NEW B.T.: AN 8" DIAM. FIR SCRIBED
"N 1/16 S5 BT" BEARS S 69° E, 14.5'
A 5.5' STEEL POST IS SET 2 FEET N 1° W ON LINE.

[S 89°49' E 2244.0']
S 89°51'24" E 2243.62'

CO.

CENTER 1/4 CORNER SECTION 5.
A 60" DIAM. FIR STUMP W/METAL CAP BEARS N 40 1/2° E, 149.8'
A 41" DIAM. FIR STUMP BEARS N 18° W, 101.0'
NEW B.T.'S:
A 14" DIAM. FIR SCRIBED "C 1/4 S5 BT" BEARS S 1° W, 12.1'
A 10" DIAM. FIR SCRIBED "C 1/4 S5 BT" BEARS N 30° W, 7.5'
A 5.5' STEEL POST IS SET 2 FEET N 1° W ON LINE.

LEGEND

- FOUND BRASS CAPPED IRON PIPE PER 1986 B.L.M. RESURVEY UNLESS OTHERWISE NOTED.
 - FOUND BRASS CAPPED IRON PIPE PER 1988 B.L.M. SURVEY.
 - [] DENOTES RECORD DATA PER 1988 B.L.M. RESURVEY.
 - () DENOTES RECORD DATA PER 1986 B.L.M. RESURVEY.
 - DENOTES LINES BLAZED AND POSTED THIS SURVEY.
- SCALE: 1" = 400' H.B. = HEALED BLAZE.
BASIS OF BEARINGS: 1988 B.L.M. RESURVEY AS SHOWN.

NARRATIVE

THE PURPOSE OF THIS SURVEY IS TO MARK THE BOUNDARIES SHOWN AS BOLD LINES HEREON.
A RANDOM TRAVERSE WAS RUN NEAR THE DESIRED BOUNDARIES AND OFFSETS MADE TO THE
TRUE LINES. THE BOUNDARIES WERE MARKED BY BLAZING TREES ON EACH SIDE OF THE LINES,
BY SETTING 5.5 FOOT STEEL POSTS ALONG THE LINES AT INTERVALS OF 200 FEET OR LESS AND BY
HANGING LIBERAL AMOUNTS OF RED FLAGGING ALONG THE TRUE LINES.

FIELD CREW: BRANT MILLER, ERIC SPRINKLE AND IAN SPRINKLE.

EQUIPMENT: NIKON TOTAL STATION.

COMPUTATIONS AND DRAFTING: DAVID EDWARDS.

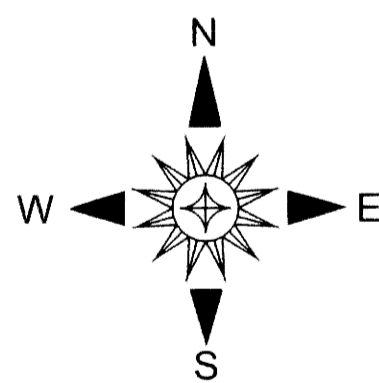

ROSEBURG

B.L.M.

SW 1/4 SE 1/4

D.L.C. NO. 39

CROSSING CLOSING CORNER.
A 25" DIAM. FIR W/H.B. BEARS N 36 1/4° E, 25.1'
A FIR STUMP BEARS N 47 1/2° W, 39.9'
NEW B.T.: A 5" DIAM. FIR SCRIBED "X BT" BEARS N 64° E, 2.2'
A 5.5' STEEL POST IS SET 2 FEET N 1° W ON LINE.