

G-E N 59°21'32\" W 34.03' (N 59°33' W 34.1')
G-I S 59°31'57\" E 129.95' (S 59°33' E 130.2')
E-J S 59°34'32\" E 488.94' (S 59°33' E 489.9')
I-J S 59°36'55\" E 324.96' (S 59°33' E 325.6')
I-M S 37°28'31\" W 399.33' (S 37°20' W 399.5')
Q-P S 37°57'07\" W 207.60' (S 38°04'40\" W 207.60-COMP)
J-P S 37°55'21\" W 478.87' (S 37°58' W 479.6')

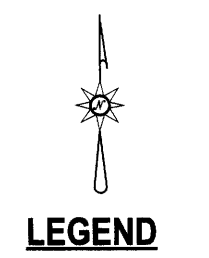

○ FOUND 5/8\" IRON ROD UNLESS OTHERWISE NOTED
● FOUND 5/8\" IRON ROD PER M185-14 UNLESS OTHERWISE NOTED
● SET 5/8\"30\" IRON ROD w/CAP STAMPED \"HIBBS-LS 52989\"
△ CALCULATED POSITION
() RECORD PER CS 51130-7
[] RECORD PER M100-2
[] RECORD PER M63-44
◊ RECORD PER LAND PARTITION 1993-0083
{ } RECORD PER M66-32
- - - - - EXISTING FENCE

FIELD CREW: KADIN BAKER, SAGE BAKER
EQUIPMENT: TRIMBLE R10 RECEIVER W/ ORGN
OFFICE: NEIL HIBBS
DRAFTING: NEIL HIBBS

BASE OF BEARING - OREGON COORDINATE REFERENCE SYSTEM (O.C.R.S.)
COTTAGE GROVE TO CANYONVILLE ZONE

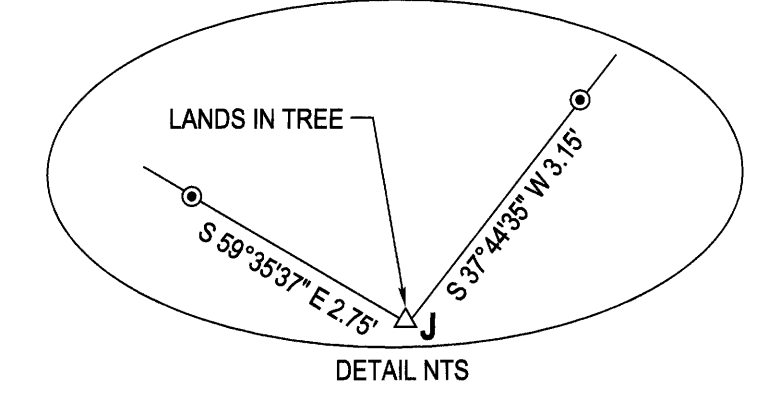

NARRATIVE:

THE PURPOSE OF THIS SURVEY WAS TO SURVEY THE BOUNDARY OF THE SUBJECT PROPERTY, TAX ID. NO. R63581. WE RECENTLY FINISHED SURVEY M185-14 WHICH SHARES A PORTION OF THE NORTHERN BOUNDARY OF THE SUBJECT PROPERTY. WE ADDED ON TO OUR EXISTING JOB. MONUMENTS USED PER M185-14 WERE NOT ALL REVISITED BUT WE DID FIND TWO THINGS THAT WERE MISSED ON M185-14. ONE OF THOSE IS THAT AT POINT \"J\", THE ACTUAL CORNER LANDS INSIDE OF A TREE AND 2 REFERENCE MONUMENTS WERE ACTUALLY SET FOR THAT CORNER. THE OTHER THING WAS THAT AT POINT \"N\", A REFERENCE MONUMENT WAS ACTUALLY SET AS WELL. ALL COURSES BETWEEN MONUMENTS USED IN M185-14 ARE SHOWN AS RECORD PER M185-14, EXCEPT AS NOTED ABOVE.

POINT \"C\" WAS CALCULATED AT A PROPORTIONED DISTANCE-DISTANCE INTERSECTION BETWEEN POINTS \"A\" AND \"B\" PER M100-2. POINT \"F\" WAS SET AT A RECORD ANGLE OFF OF LINE \"D-E\" AND AT RECORD DISTANCE FROM POINT \"D\". POINTS ALONG CARTE LANE BETWEEN POINT \"F\" AND \"C\" WERE PROPORTIONED PER CS 51130-7. POINTS ALONG DUSTIN LANE WERE PROPORTIONED BETWEEN POINTS \"E\" AND \"J\" FOR DISTANCES BUT WERE PLACED IN BETWEEN OTHER FOUND MONUMENTS PER M185-14 FOR ALIGNMENT. POINT \"P\" WAS CALCULATED ON AN EXTENSION OF LINE \"J-O\", AT RECORD DISTANCE FROM POINT \"Q\" PER M66-32.

SURVEY LYING IN THE NW 1/4, NE 1/4, SE 1/4 & SW 1/4 OF SEC. 33, T29S, R5W WILLAMETTE MERIDIAN, DOUGLAS COUNTY, OREGON		REGISTERED PROFESSIONAL LAND SURVEYOR
CLIENT: FEDERAL NATIONAL MORTGAGE ASSOC. GRANT PARK VII- 5800 GRANITE PRKWAY, PLANO, TX. 75024	NEIL HIBBS LAND SURVEYING, INC 4739 LOOKINGGLASS RD. ROSEBURG, OR. 97471 phone: 541-887-8303 neilhibbslandsurvey@gmail.com	[Signature] OREGON JANUARY 13, 1988 F. NEIL HIBBS 52989 EXPIRATION DATE 6/30/2027
DWG SCALE: 1\" = 40'	JOB NO.: 3174-01	DATE: AUGUST 2025
PAGE 1 OF 1		