

**DETAIL "A"**

1010R - FD. 1/4 CORNER BETWEEN SECTION 25 & 36. BRASS CAP MISSING FROM PIPE, INSTEAD A 1-1/2" HEX NUT WITH 2-1/2" WASHER WAS FOUND ON 2-1/2" O.D. PIPE. CORNER LOCATED IN MONUMENT BOX IN ASPHALT ON MEDIAN SHOULDER OF SOUTH BOUND INTERSTATE 5. (PER CS 56/51-19)

(JUNE 5, 2024)  
N: 92587.72  
E: 124704.80

FD. BT:  
30" DIAMETER CEDAR  
\*\*BT BEARS N 72°56'16" W 148.82'  
{N 71°30'00" W 148.90}

(JUNE 5, 2024)  
N: 92631.38  
E: 124562.53

1001 - FD. 5/8" REBAR WITH ALUMINUM CAP STAMPED "OREG STATE HWY DEP" POST & PADDLE NEARBY MARKED "SHRW POT 399+00 244" (PER ODOT DRG. NO. 8B-30-21)

(JANUARY 19, 2022)  
N: 92931.038  
E: 124926.82'

N 32°53'25" E 408.86' {408.79}

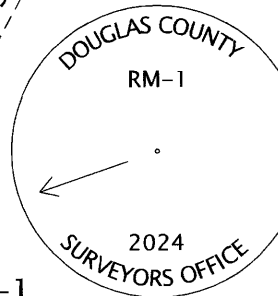

RM-1: SET 5/8"x30" REBAR WITH ALUMINUM CAP STABILIZED IN CONCRETE  
\*\*RM-1 BEARS N 66°02'42" E 30.00' FROM 1/4 COR.

(JUNE 5, 2024)  
N: 92599.90  
E: 124732.21

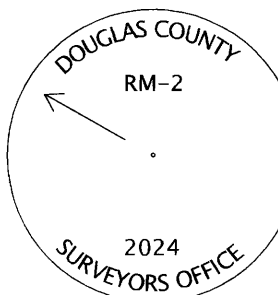

RM-2: SET 5/8"x30" REBAR WITH ALUMINUM CAP, STABILIZED IN CONCRETE  
\*\*RM-2 BEARS S 39°39'58" E 20.00' FROM 1/4 COR.

(JUNE 5, 2024)  
N: 92572.32  
E: 124717.57

1000 - FD. 5/8" REBAR WITH ALUMINUM CAP (BADLY ERODED) POST & PADDLE NEARBY MARKED "SHRW POT 365+00 229" (PER ODOT DRG. NO. 8B-30-21)

(JANUARY 19, 2022)  
N: 95107.99  
E: 127538.09

SW 1/4 & SE 1/4 SECTION 25, T.32S., R.6W., W.M.  
NW 1/4 & NE 1/4 SECTION 36, T.32S., R.6W., W.M.  
DOUGLAS COUNTY, OREGON

FILED  
Date: 7/23/2024 By: JC  
This survey consists of:  
Map: M184-1  
Narrative:  
Corner Rpt: CS 65/113-42  
DOUGLAS COUNTY SURVEYOR

**CONTROL NARRATIVE AND BASIS OF BEARINGS:**

ALL BEARINGS FOR THIS SURVEY ARE BASED ON THE OREGON COORDINATE REFERENCE SYSTEM (OCRS), CANYONVILLE - GRANTS PASS ZONE, NAD83(2011), EPOCH 2010. ALL COORDINATES ARE IN INTERNATIONAL FEET UNITS.

SURVEY WORK FOR THIS PROJECT WAS COMPLETED BY ODOT SURVEY CREWS BETWEEN JANUARY 19, 2022 AND JUNE 5, 2024. THE SURVEY EQUIPMENT USED CONSISTED OF A LEICA CS20 DATA COLLECTOR WITH A LEICA TS-17 TOTAL STATION AND A LEICA GS14 GNSS RECEIVER. HORIZONTAL POSITIONS OF CONTROL AND MONUMENTS WERE ESTABLISHED BY UTILIZING THE OREGON REAL-TIME GEODETIC NETWORK (ORGN) AND OBSERVING A MINIMUM OF 2 REDUNDANT 60 EPOCH OBSERVATIONS ON EACH POINT. THESE OBSERVATIONS WERE A MINIMUM OF 30 MINUTES APART IN ACCORDANCE WITH ODOT'S POLICY AND PROCEDURES MANUAL AND THE RESULTING COORDINATES ARE REPORTS ON THE FACE OF THIS MAP.

CONTROL POINTS FOR THIS SURVEY WERE NOT SET ON AND DO NOT REPRESENT PROPERTY OR RIGHT OF WAY LINES AND ARE INTENDED FOR THE USE BY ODOT IN SUPPORT OF THIS AND FUTURE PROJECTS. IT IS NOT THE INTENT OF ODOT TO PERPETUATE THESE CONTROL POINTS AS MONUMENTS.

**SURVEY NARRATIVE:**

THIS SURVEY WAS MADE AS A RESULT OF THE OREGON DEPARTMENT OF TRANSPORTATION'S I-5: AZALEA - GLENDALE SECTION PROJECT. DURING THE COURSE OF THIS PROJECT THE BEARING TREE IN THE MEDIAN FOR THE QUARTER CORNER BETWEEN SECTIONS 25 AND SECTION 36, TOWNSHIP 32 SOUTH, RANGE 6 WEST, W.M. WAS DESTROYED.

THE PURPOSE OF THIS SURVEY IS TO ESTABLISH NEW CORNER ACCESSORIES FOR SAID QUARTER CORNER. ALSO, AS PART OF THIS PROJECT THE MEDIAN SHOULDER OF THE SOUTH BOUND LANES OF INTERSTATE 5 WAS WIDENED AND A MONUMENT BOX WAS PLACED OVER THE SAID QUARTER CORNER TO HELP PRESERVE AND PROTECT IT IN THE FUTURE.

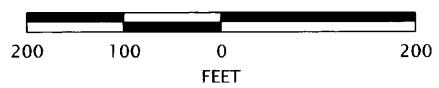
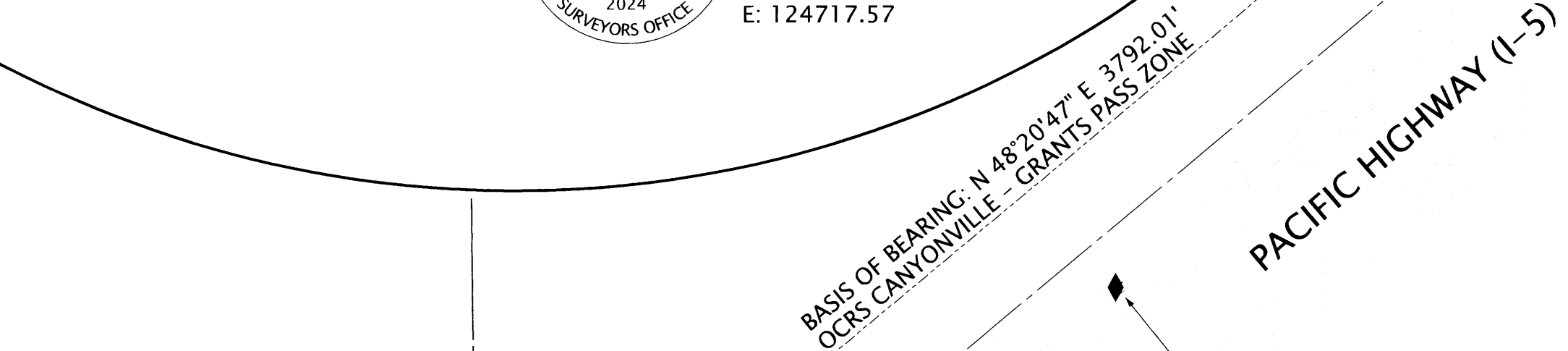

RECORD DATA & POINT LEGEND	
{ }	RECORD DATA PER CS 56/51-19 & COUNTY PLSS 640200 RENEWAL SHEET
○	FOUND MONUMENT AS NOTED
✱	FOUND BEARING TREE
◆	SET STRATEGIC POINT
●	SET REFERENCE MONUMENT

LINE LEGEND	
---	BASIS OF BEARING LINE
---	EXISTING HIGHWAY ACCESS CONTROL / RIGHT OF WAY
---	GOVERNMENT SECTION LINE
---	GOVERNMENT QUARTER SECTION LINE
---	EDGE OF ASPHALT PAVING

REGISTERED PROFESSIONAL LAND SURVEYOR  
*Eric B. Hibbs*  
OREGON NOVEMBER 13, 2018  
ERIC BENJAMIN HIBBS 90437PLS  
RENEWS: 06/30/2025

OREGON DEPARTMENT OF TRANSPORTATION  
1/4 CORNER ACCESSORIES RESTORATION MAP  
I-5: AZALEA - GLENDALE SECTION  
PACIFIC HIGHWAY  
DOUGLAS COUNTY

ODOT REGION 3 TECH CENTER  
3500 NW STEWART PKWY.  
ROSEBURG, OR 97470 KEY NO. K21673

JULY 11, 2024  
SCALE: 1" = 200'  
SHEET 1 OF 1

C.S. FILE 65/113-42  
MAP FILE M184-1

C.S. FILE 65/113-42  
MAP FILE M184-1