

~~ENCUMBRANCES PER PUBLIC RECORDS REPORT:
FIRST AMERICAN TITLE INSURANCE COMPANY
DATED JUNE 15, 2022, REPORT ORDER NUMBER 7399-3957609.
SAID REPORT SHOWS NO EASEMENTS OF RECORD.~~

~~DECLARATION:~~

~~KNOW ALL PERSON BY THESE PRESENTS, THAT I, DUANE L. RAY AM THE OWNER OF THE LANDS PRESENTED
HEREON AND DID CAUSE THE LANDS TO BE PARTITIONED, AND PLATTED SHOWN HEREON, IN ACCORDANCE WITH
THE PROVISIONS OF CHAPTER 92. OREGON REVISED STATUTES, AND DO HEREBY DEDICATE
TO THE PUBLIC FOREVER THE USE OF THE STREET SHOWN AS " JADECLOD " DRIVE AS INDICATED THEREON.~~

~~DUANE L. RAY _____ DATE _____~~

~~ACKNOWLEDGEMENT:~~

~~PERSONALLY APPEARED BEFORE ME DUANE L. RAY, AND ACKNOWLEDGED THE FOREGOING TO BE A VOLUNTARY
AND FREE ACT~~

~~THIS INSTRUMENT WAS ACKNOWLEDGED BEFORE ME ON THIS THE _____ DAY OF _____, 2022~~

~~NOTARY PUBLIC (PRINT) _____ SIGN _____~~

~~COMMISSION NUMBER _____ MY COMMISSION EXPIRES _____~~

APPROVALS:

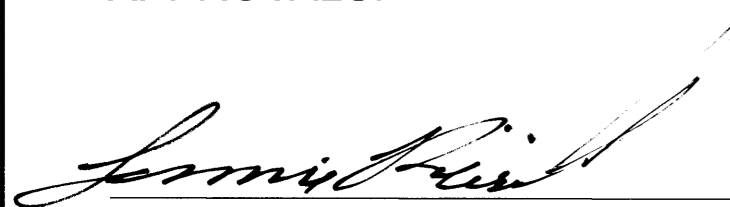
 _____
CITY OF MYRTLE CREEK ADMINISTRATOR DATE 02/01/2024

~~DOUGLAS COUNTY SURVEYOR _____ DATE _____~~

~~CERTIFICATION OF TAX PREPAYMENT:~~

~~I, HEREBY CERTIFY THAT ALL TAXES AND OTHER ASSESSMENTS OR
OTHER CHARGES HAVE BEEN PAID~~

~~DOUGLAS COUNTY TAX COLLECTOR _____ DATE _____~~

MAP OF SURVEY

~~LAND PARTITION
WITH
ADJUSTMENT OF COMMON
BOUNDARY LINE SURVEY~~

LOCATED IN THE:
NORTHEAST QUARTER OF SECTION 27,
TOWNSHIP 29 SOUTH, RANGE 5 WEST,
WILLAMETTE MERIDIAN, DOUGLAS COUNTY, OREGON
" CITY OF MYRTLE CREEK PLANNING DEPARTMENT FILE NUMBER 21-MC016 "

~~TOTAL NUMBER OF PARCELS: THREE (3)
WATER SUPPLY: CITY OF MYRTLE CREEK
SEWER DISPOSAL: CITY OF MYRTLE CREEK
ZONING: R-1
COMP. PLAN DESIGNATION: RESIDENTIAL~~

PREPARED FOR:
DUANE L. RAY
P.O. BOX 2218
MYRTLE CREEK, OR. 97457

PREPARED BY:
RAYMOND F. BROWN - P.L.S. # 2391
P.O. BOX 539
CANYONVILLE, OR. 97417
PHONE: 541-839-6185

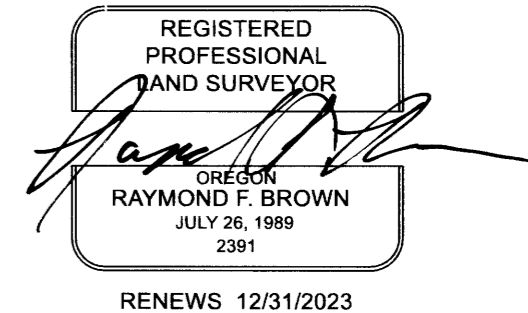

RECORDING:
PROPERTY LINE ADJUSTMENT DEED
RECORDED AS INSTRUMENT NUMBER 2022-015943
DOUGLAS COUNTY CLERK'S RECORDS

NARRATIVE:

PURPOSE OF THE SURVEY WAS TO PERFORM THE ADJUSTMENT OF COMMON BOUNDARY LINE,
THEN CREATE THE PARCELS AS SHOWN. FIELD INVESTIGATION LOCATED THE SAID FOUND
MONUMENTS AND CONDITIONS. EXISTING SAID FOUND MONUMENTS PER HERMANN'S
SECOND SUBDIVISION, AS RECORDED IN VOLUME 7 PAGE 15 AND VILLAGE ADDITION,
AS RECORDED IN VOLUME 14, PAGE 4 CONTROLLED THE SURVEY.

FILED AS A
ADJUSTMENT OF COMMON
BOUNDARY LINE " ONLY "

FILED
Date: 2/1/2024 By: M
This survey consists of:
Map: M183-32A & B
Narrative: _____
Corner Rpt: _____
DOUGLAS COUNTY
SURVEYOR

MAP FILE M183-32B

MAP FILE M183-32B