

BOUNDARY SURVEY IN
NORTHEAST 1/4, SOUTHEAST 1/4 & SOUTHWEST 1/4 OF SECTION 6, T32S, R4W, W.M.
DOUGLAS COUNTY, OREGON
JULY 25, 2019

FILED
 Date: 10/16/19 By: [Signature]
 This survey consists of:
 Map: M176-18A-C
 Narrative: _____
 Corner Rpt: _____
DOUGLAS COUNTY SURVEYOR

MAP FILE M176-18C

① 1/4 CORNER 31 AND 6 (GCDB NO. 140700)

FOUND: 5/8" IRON ROD WITH YELLOW PLASTIC CAP "TEMPLIN LS 2359" PER M120-58
 10" FIR, N49E, 13.2' (REC.=N50E, 13.2') TO NAIL SIDE/CENTER-M120-58 BEARING TREE
 20" CEDAR, S69E, 35.3' (REC.=S69E, 35.2') TO NAIL SIDE/CENTER-M120-58 BEARING TREE
 9" FIR, S41W, 17.3' (REC.=S42W, 17.1') TO NAIL SIDE/CENTER-M120-58 BEARING TREE
 14" FIR, N61W, 24.8' (N61W, 24.7') TO NAIL SIDE/CENTER-M120-58 BEARING TREE

② 1/4 CORNER 5 AND 6 (GCDB NO. 200640)

NOTHING FOUND AT CORNER POSITION (FALLS IN COW CREEK ROAD)
 2 1/2" DOUGLAS COUNTY BRASS CAP-WITNESS CORNER-1983, BEARS N22°17'31"E, 41.00 FEET (REC.=N22°19'33"E)
 5/8" IRON ROD BY DOUGLAS COUNTY-1979, BEARS N45°45'06"W, 30.00 FEET (REC.=N45°40'14"W)
 21" SOUTH TRUNK OF MADRONE, N18E, 67.6' TO CENTER (REC.=N22E, 101 LKS)-1959 BLM BEARING TREE
 DECAYED FIR STUMP, S14E, 46.9' TO CENTER (REC.=S14E, 71 LKS) TO CENTER-1910 ROBERTS BEARING TREE
 24" MADRONE, S26W, 54.2' (REC.=S25W, 82 LKS) TO CENTER- 1959 BLM BEARING TREE
 35" ROTTEN FIR STUMP, S46W, 115.5' (REC.=S47 1/4W, 114.0') TO CENTER-1946 DOUGLAS COUNTY BEARING TREE

③ 1/4 CORNER 1 AND 6 (GCDB NO. 100640)

FOUND: 2 1/2" DOUGLAS COUNTY BRASS CAP "1984"
 32" FIR, S85E, 25.9' (REC.=S83E, 25.0') TO NAIL SIDE/CENTER-DOUGLAS COUNTY BEARING TREE
 13" MAPLE, S35E, 13.3' (REC.=S34 1/2E, 13.2') TO NAIL SIDE/CENTER-DOUGLAS COUNTY BEARING TREE
 15" MAPLE, S58W, 35.3' (REC.=S58W, 35.9') TO NAIL SIDE/CENTER-DOUGLAS COUNTY BEARING TREE
 27" INCENSE CEDAR, N25W, 57.5' (REC.=N23 1/2W 57.6') TO NAIL SIDE/CENTER-DOUGLAS COUNTY BEARING TREE

④ SOUTHEAST 1/16 CORNER SECTION 6

FOUND: 5/8" REBAR WITH YELLOW PLASTIC CAP "TEMPLIN LS 2359"-PER M120-58

⑤ SECTION CORNER 1, 6, 7, 12 (GCDB NO. 100600)

FOUND: 3 1/4" BUREAU OF LAND MANAGEMENT BRASS CAP "1971"
 8" FIR, N31E, 48.4' (REC.=N31 1/2E, 47.6') TO NAIL SIDE/CENTER-2013 BLM BEARING TREE
 9" FIR, S66E, 10.6' (REC.=S67 1/4E, 10.4') TO NAIL SIDE/CENTER-2013 BLM BEARING TREE
 19" PINE, S36W, 57.2' (REC.=S37W, 57.3') TO NAIL SIDE/CENTER-M34-26 BEARING TREE
 11" FIR, N82W, 52.0' (REC.=N82W 51.7') TO NAIL SIDE/CENTER-2013 BLM BEARING TREE

⑥ WEST 1/16 CORNER 6 AND 7

FOUND: 3 1/4" BUREAU OF LAND MANAGEMENT BRASS CAP "1971"
 8" FIR, S8E, 9.2' (REC.=S8E, 24 LKS) TO NAIL SIDE/CENTER-1971 BLM BEARING TREE
 17" WHITE FIR, N4E, 15.9' (REC.=N3W, 14 LKS) TO NAIL SIDE/CENTER-1971 BLM BEARING TREE

⑦ 1/4 CORNER 6 AND 7 (GCDB NO. 140600)

FOUND: 3 1/4" BUREAU OF LAND MANAGEMENT BRASS CAP "1971"
 35" PONDEROSA PINE, N22E, 21.7' (REC.=N25E, 21.7') TO NAIL SIDE/CENTER-1956 DOUGLAS COUNTY BEARING TREE
 36" CEDAR, S51W, 10.0' (REC.=S51W, 9.7') TO NAIL SIDE/CENTER-1956 DOUGLAS COUNTY BEARING TREE
 47" CEDAR, N7W, 178.6' (REC.=N7 1/2W, 178.7') TO NAIL SIDE/CENTER-M3-32 BEARING TREE
 NE CORNER OF GARAGE, N45W, 12.0' (REC.=N59W 0.18 CHS.) TO BLDG. CORNER-1971 BLM BEARING OBJECT

⑧ SOUTHWEST 1/16 CORNER SECTION 6

SET: 5/8" X 36" REBAR WITH 2 1/2" ALUMINUM CAP, MARKED AS SHOWN
 MARKED: 8" FIR, N59E, 10.5' TO NAIL SIDE/CENTER-SCRIBED "SW1/16S6 BT"
 5" FIR, N31W, 4.4' TO NAIL SIDE/CENTER-SCRIBED "SW1/16S6 BT"
 5 FOOT METAL POST ALONGSIDE CORNER

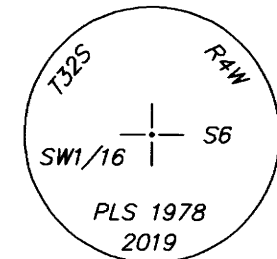

⑨ CENTER-SOUTH 1/16 CORNER SECTION 6

SET: 5/8" X 36" REBAR WITH 2 1/2" ALUMINUM CAP, MARKED AS SHOWN
 MARKED: 32" FIR, S52E, 7.2' TO NAIL SIDE/CENTER-M3-32 BEARING TREE
 OLD 1 1/4" IRON PIPE, N8°50'56"E, 20.40' (OLD CORNER PER M3-32)
 5 FOOT METAL POST ALONGSIDE CORNER

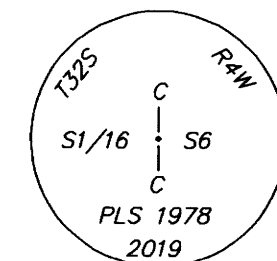

⑩ SECTION CORNER 5, 6, 31, 32 (GCDB NO. 200700)

FOUND: 3 1/4" BUREAU OF LAND MANAGEMENT BRASS CAP "1959"
 13" FIR, N27E, 34.8' (REC.=N27 3/4E, 35.0') TO NAIL SIDE/CENTER-2013 BLM BEARING TREE
 11" MADRONE, S53E, 22.4' (REC.=S52 1/4E, 22.5') TO NAIL SIDE/CENTER-CS 40/246 BEARING TREE
 9" MADRONE, S33W, 26.6' (REC.=S32W, 26.7') TO NAIL SIDE/CENTER-CS 40/246 BEARING TREE
 14" CHINQUAPIN, N35W, 9.1' (REC.=N35W 9.2') TO NAIL SIDE/CENTER-CS40/246 BEARING TREE

⑪ NORTH 1/16 CORNER 5 AND 6

FOUND: 3 1/4" BUREAU OF LAND MANAGEMENT BRASS CAP "2013"
 28" FIR, N32E, 20.2' (REC.=N31 3/4E, 20.3') TO NAIL SIDE/CENTER-CS 40/246 BEARING TREE
 ROTTEN FIR STUMP, S21E, 15.9' (REC.=S21 3/4E, 16.0) TO NAIL SIDE/CENTER-CS 40/246 BEARING TREE
 16" FIR, N67W, 9.0' (REC.=N67 1/4W, 9.0') TO NAIL SIDE/CENTER-2013 BLM BEARING TREE

⑫ NORTHEAST 1/16 CORNER SECTION 6

SET: 5/8" X 36" REBAR WITH 2 1/2" ALUMINUM CAP, MARKED AS SHOWN
 MARKED: 9" FIR, S40W, 16.5' TO NAIL SIDE/CENTER-SCRIBED "NE1/16S6 BT"
 9" CEDAR, N49W, 21.6' TO NAIL SIDE/CENTER-SCRIBED "NE1/16S6 BT"
 5 FOOT METAL POST ALONGSIDE CORNER

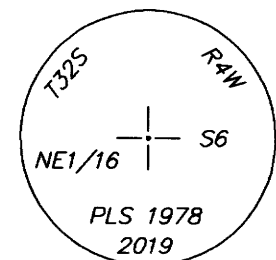

⑬ CENTER-EAST 1/16 CORNER SECTION 6

SET: 5/8" X 36" REBAR WITH 2 1/2" ALUMINUM CAP, MARKED AS SHOWN
 MARKED: 22" FIR, S17W, 27.0' TO NAIL SIDE/CENTER-SCRIBED "CE1/16S6 BT"
 21" FIR, N79W, 13.0' TO NAIL SIDE/CENTER-SCRIBED "CS1/16S6 BT"
 5 FOOT METAL POST ALONGSIDE CORNER

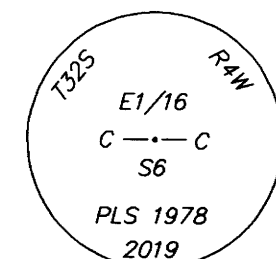

REGISTERED PROFESSIONAL LAND SURVEYOR

[Signature]
 OREGON
 JULY 16, 1982
 DANIEL W. BAKER
 1978

EXPIRES 12/31/19

I CERTIFY THAT THIS MAP WAS PREPARED USING A HP51645A INK CARTRIDGE ON JPC-4M2 DOUBLE MATTE FILM

SHEET 3 OF 3

BOUNDARY SURVEY IN NE 1/4, SE 1/4 & SW 1/4 OF SECTION 6, T32S, R4W, W.M. DOUGLAS COUNTY, OREGON	
CLIENT: WEYERHAEUSER COMPANY	
DRAWN BY: DWB	BAKER AND ASSOCIATES, SURVEYORS
DATE: 7/25/19	1347 MARKET STREET
FILE: PL320406	SPRINGFIELD, OREGON (541) 343-7243

MAP FILE M176-18C