

MAP OF SURVEY

LOCATED in the West 1/2 of Section 19 and the NW 1/4 of Section 30,
T. 25 S., R. 5 W., W.M. in Douglas County, Oregon.

May, 2019

FILED

Date: 6-3-19 By: *DE*
This survey consists of:

Map: M175-50
DOUGLAS COUNTY SURVEYOR

SURVEYED FOR: *ROBINSON LIVING TRUST*
2015 EAST WILDFLOWER LANE
SPOKANE, WA. 99224

AND

DAVID AND ULENA ROBINSON
1714 SOUTH COLUMBUS AVENUE
GOLDENDALE, WA. 98620

SURVEYED BY: *DAVID EDWARDS LAND SURVEYING*
P.O. BOX 361
OAKLAND, OREGON 97462
PHONE: (541) 459-0512

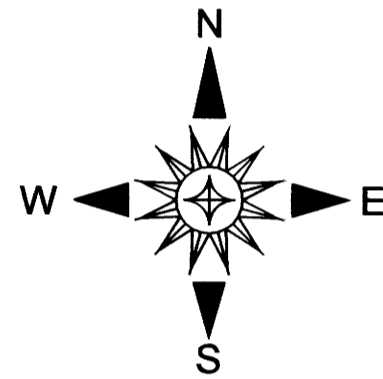
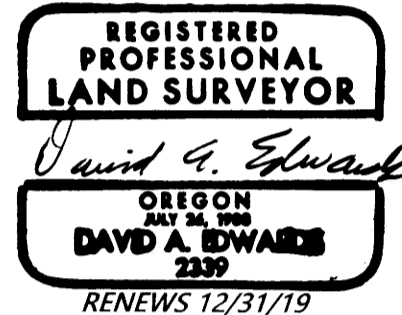

LEGEND

- INDICATES 5/8" DIAM. IRON ROD WITH CAP FOUND PER M 119-6 AT SW CORNER D.L.C. NO. 53.
 - INDICATES 1" DIAM. IRON PIPE FOUND PER M 24-14.
 - INDICATES 3/4" DIAM. IRON ROD FOUND AT SE CORNER D.L.C. NO. 53 PER RENEWAL 053040.
 - INDICATES 5/8" X 30" STEEL REBAR WITH RED PLASTIC CAP MKD. "D.A. EDWARDS-L.S. 2339" SET.
 - ⊕ INDICATES 5/8" DIAM. STEEL REBAR W/CAP FOUND PER P.P. 2019-0003.
 - ◆ INDICATES 1/2" DIAMETER IRON ROD FOUND PER PLAT OF FIR GROVE TRACTS. (VOL. 9, PAGE 20).
 - () DENOTES RECORD DATA PER M 119-6.
 - { } DENOTES RECORD DATA PER PLAT OF FIR GROVE TRACTS.
 - [] DENOTES DEED RECORD DATA UNLESS NOTED OTHERWISE.
 - COMP. = COMPUTED.
 - P.P. = PARTITION PLAT NUMBER
 - F.G.T. = FIR GROVE TRACTS.
- SCALE: 1" = 300'
- BASIS OF BEARINGS: EXISTING CONTROL PER MY SURVEY PARTITION PLAT NO. 2019-0004.

LINE TABLE

NO.	BEARING	DISTANCE
L1	N 0°13'47" E { N 0°10' E }	50.41'
L2	N 0°01'15" E { N 0°10' E }	100.05' 99.99'
L3	N 0°13'37" E { N 0°10' E }	99.40' 99.99'

NARRATIVE

THE PRIMARY PURPOSE OF THIS SURVEY IS TO MONUMENT THE SOUTHEAST AND SOUTHWEST CORNERS OF THAT TRACT OF LAND DESCRIBED IN DOCUMENTS NUMBERED 26450 AND 95-18465, OFFICIAL RECORDS FOR DOUGLAS COUNTY AND TO MARK THE LINE CONNECTING THOSE TWO CORNERS. I HOLD TO THE FOUND MONUMENTS FOR THE SOUTH-SOUTHEAST AND SOUTHWEST CORNERS OF DONATION LAND CLAIM NUMBER 53 AND DEED RECORD DISTANCES TO ESTABLISH THE CORNERS AND THE LINE IN QUESTION. A THOROUGH SEARCH FOR THE "IRON BAR" SET AT THE SOUTHWEST CORNER OF D.L.C. NO. 53 ON SURVEY VOLUME 3, PAGE 35 WAS UNSUCCESSFUL. ALL BEARING TREES MARKED ON M 119-6 ARE STUMPS WITH THE EXCEPTION OF A 17" DIAM. FIR WITH HEALED BLAZES THAT BEARS N 87° W, 32.0 FEET. A SIX FOOT STEEL POST IS SET ON THE EAST SIDE OF THE FOUND MONUMENT. THE SUBJECT SOUTH LINE WAS MARKED WITH SIX FOOT STEEL POSTS PAINTED FLOURESCENT ORANGE AND WITH BLUE-ORANGE COMBINATION FLAGGING ALONG THE TRUE LINE.

A SECONDARY PURPOSE OF THIS SURVEY IS TO SHOW THE OVERALL DIMENSIONS OF THE SUBJECT PROPERTY AND TO IDENTIFY THE FOUND MONUMENTS WHICH WILL CONTROL THE BOUNDARIES OF SAID LANDS ON A FUTURE LAND PARTITION. THAT PARTITION WILL INCLUDE ONLY THAT PORTION OF THE SUBJECT PROPERTY WHICH IS LOCATED IN SECTION 19 AND WHICH HAS BEEN ANNEXED INTO THE CITY OF SUTHERLIN.

FIELD CREW: BRANT MILLER AND ERIC SPRINKLE.

EQUIPMENT: NIKON TOTAL STATION.

COMPUTATIONS AND DRAFTING: DAVID EDWARDS.

