

MAP FILE M173-80A

FIELD CREW: NOLAN FROMDAHL & JEREMY LEONARD

EQUIPMENT: TOPCON TOTAL STATION AND TDS RANGER DATA COLLECTOR

OFFICE: BRENT KNAPP

DRAFTING: BRENT KNAPP/ANDREW VASQUEZ

FILED
Date: 12-7-17 By: JC
This survey consists of:
Map: M173-80 A-B
Name:
Corner:
DOUGLAS COUNTY SURVEYOR

APPROVALS:

Brian Sutherlin 12-7-2017
SUTHERLIN COMMUNITY DEVELOPMENT DIRECTOR DATE

ACREAGE NOTE:

ORIGINAL ACREAGE FOR UNITS 1, 2, AND 3 AND ADJUSTED ACREAGE FOR UNIT 1 ARE BASED ON TAX ASSESSOR AND DOUGLAS COUNTY PLANNING DEPARTMENT INFORMATION LESS THE SURVEYED AREAS OF ADJUSTED UNITS 2 AND 3.

ADJUSTED ACREAGE FOR UNITS 2 AND 3 ARE BASED ON FIELD SURVEY MEASUREMENTS.

UNIT 4 INFORMATION:
ORIGINAL ACREAGE-22.06± ACRES
ADJUSTED ACREAGE-0.00 ACRES

NARRATIVE:

THE PURPOSE OF THIS SURVEY IS TO ADJUST THE BOUNDARIES BETWEEN PARCEL 1 OF PARTITION PLAT 2005-0018, DOUGLAS COUNTY PLAT RECORDS, LOT 178 OF THE REPLAT OF LOT 138, LOT 139, AND LOTS 155 THROUGH 165 OF KNOLLS ESTATES PUD, PHASE 3, VOLUME 21, PAGE 50, PLAT RECORDS OF DOUGLAS COUNTY, TRACT "H" OF FAIRWAY ESTATES AT UMPQUA GOLF RESORT PUD, PHASE 2, AND THOSE TRACTS OF LAND DESCRIBED IN INSTRUMENT NUMBERS 2008-00022 AND 2016-12443, OFFICIAL RECORDS OF DOUGLAS COUNTY INTO 3 UNITS OF LAND WITH UNIT 4 BEING ELIMINATED. THE PROCEDURE WAS AS FOLLOWS:

MONUMENTS OF RECORD WERE TIED AND HELD AS SHOWN. THE SOUTHEAST CORNER OF TRACT "H" WAS ESTABLISHED BY THE WESTERLY EXTENSION OF NORTH BOUNDARY OF TRACT D AT RECORD DISTANCE PER SAID PLAT OF FAIRWAY ESTATES AT UMPQUA GOLF RESORT PUD, PHASE 2. THE NORTHEAST CORNER OF SAID TRACT "H" WAS ESTABLISHED BY DISTANCE-DISTANCE INTERSECTION. MONUMENTS WERE SET AT THE ANGLE POINTS OF THE DEED CALLS AT THE CLIENTS REQUEST.

ADJUSTMENT RECORDING INFORMATION:

ADJUSTED UNITS 1, 2, AND 3: PROPERTY LINE ADJUSTMENT DEED RECORDED AS INSTRUMENT NUMBER 2017-19375, DEED RECORDS OF DOUGLAS COUNTY.

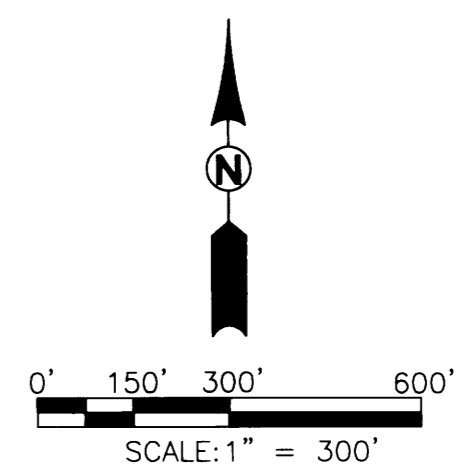
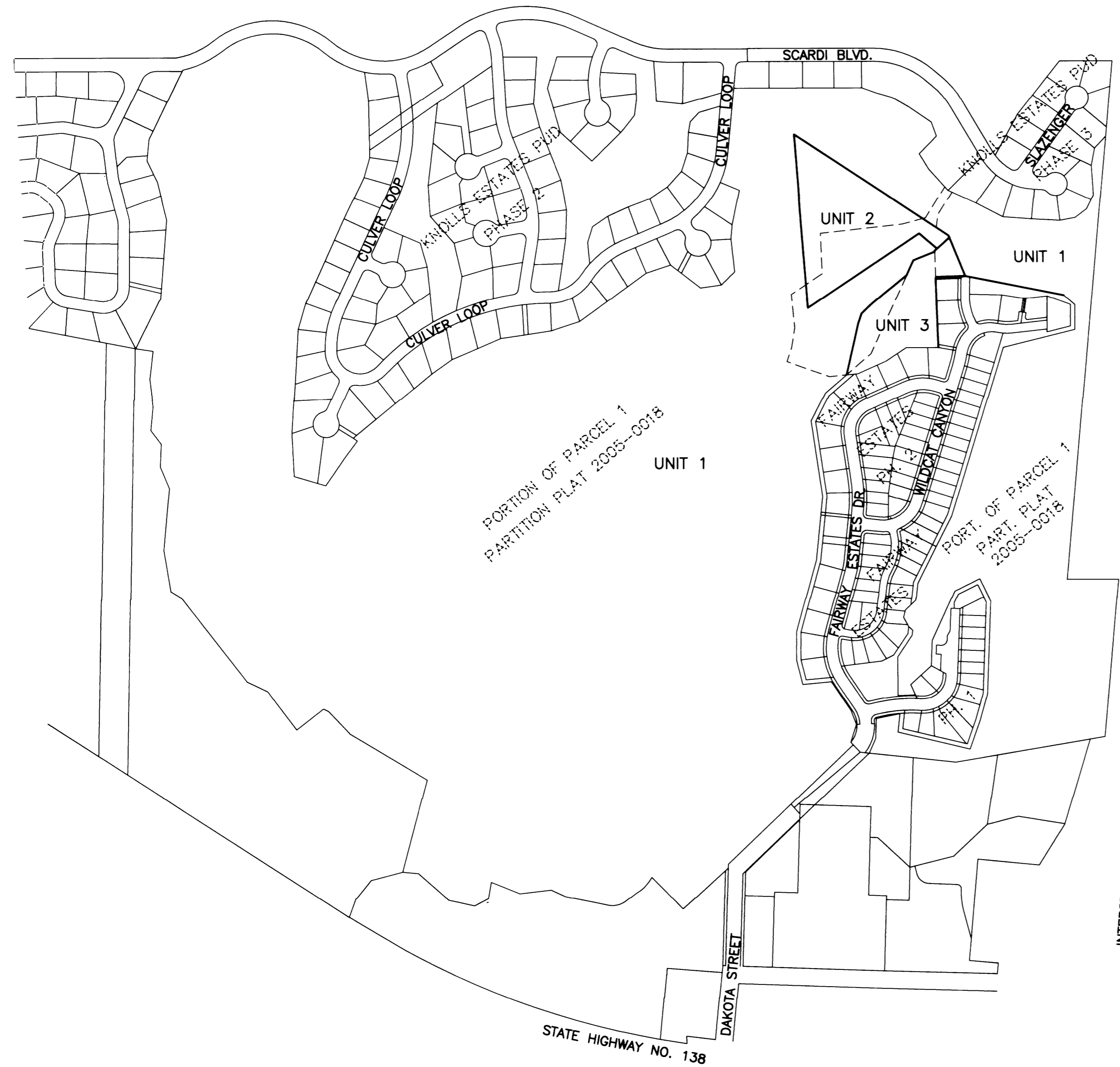

REGISTERED PROFESSIONAL LAND SURVEYOR OREGON NOVEMBER 10, 2010 BRENT H. KNAPP 81116 EXPIRES: 6/30/2019	PROPERTY LINE ADJUSTMENT LOCATED IN THE SW 1/4 OF SEC. 18, T.25S., R.5W., WILLAMETTE MERIDIAN., DOUGLAS COUNTY, OREGON	
	SURVEYED FOR: VASE, LLC 3610 GOODPASTURE LOOP EUGENE, OR 97401	SURVEYED BY: 809 SE Pine Street Roseburg, Oregon 97470 PHONE (541) 673-0166 FAX (541) 440-9392 email@ieengineering.com
SCALE: AS SHOWN	DATE: 10/02/2017	PAGE: 1 OF 2

MAP FILE M173-80A