

RECORD OF SURVEY
 FOR: OXBOW TIMBER 1 LLC
 NE1/4, SECTION 8, T.21 S., R.8 W, W.M.
 DOUGLAS COUNTY, OREGON
 24 OCTOBER 2016

FILED
 DATE: 12-29-2016 BY: JC
 THIS SURVEY CONSISTS OF:
 MAP: M172-76
 NARRATIVE:
 CORNER RPT:
 DOUGLAS COUNTY
 SURVEYOR



S5
S8

BASIS OF BEARING
 [N 84°50' W 39.38 CHAINS]
 N 84°50'00" W 2594.61'

S5 S4
S8 S9

1/4 CORNER SECTIONS 5, 8
 FOUND GLO BRASS CAP DATED 1945
 WITH THE FOLLOWING ACCESSORIES:
 40" ROTTED D. FIR STUMP BEARS N 86-1/2° W 143.9' - NO MARKS
 19" MAPLE BEARS N 82° E 14.9' - HEALED FACE
 30" D. FIR BEARS N 21° W 64.0' - HEALED FACE
 RECORD 15" D. FIR BEARING S 77° W - DOWN OUT OF POSITION
 15" ALDER BEARS S 39° E 30.5' - BARK SCRIBING VISIBLE
 STEEL POST ADJACENT TO CORNER

SECTION CORNER SECTIONS 4, 5, 8, 9
 FOUND BLM BRASS CAP DATED 1967 ON FIBERGLASS PIPE
 CHECKED TO CONFIRM PIPE IS FIBERGLASS (RECORD IRON PIPE PER 2009 BLM)
 WITH THE FOLLOWING ACCESSORIES:
 ROTTED D. FIR STUMP OF INDETERMINATE DIAMETER BEARS N 57° W 9.9' - NO MARKS
 34" D. FIR SNAG BEARS S 46-1/2° W 63.4' - SCRIBING VISIBLE
 18" D. FIR BEARS N 17-1/2° E 9.4' - HEALED FACE
 7" D. FIR BEARS S 17° E 1.9' - HEALED FACE
 9" D. FIR BEARS S 69-3/4° W 12.8' - HEALED FACE
 12" D. FIR BEARS N 67-1/2° W 13.8' - HEALED FACE
 STEEL POST ADJACENT TO CORNER

NARRATIVE:

THE PURPOSE OF THIS SURVEY WAS TO MARK TRUE LINE BETWEEN THE CORNERS SHOWN HEREON IN SECTION 8, TOWNSHIP 21 SOUTH, RANGE 8 WEST, OF THE WILLAMETTE MERIDIAN.

EXISTING CORNERS WERE TIED BY GROUND TRAVERSE AND HELD IN THEIR AS-TIED POSITION FOR THE MARKING OF TRUE LINE.

TRUE LINE WAS MARKED WITH RED PAINTED BLAZES, RED FLAGGING AND 5-1/2" GALVANIZED STEEL POST SET AT 200' +/- INTERVALS.

THE BASIS OF BEARING FOR THIS SURVEY WAS THE 1946 BUREAU OF LAND MANAGEMENT DEPENDENT RESURVEY OF SECTION 8, TOWNSHIP 21 SOUTH, RANGE 8 WEST, WILLAMETTE MERIDIAN.

THIS SURVEY WAS PERFORMED USING A NIKON TOTAL STATION.

N 0°09' W 37.815 CHAINS
 N 0°51'08" W 2502.10'

LEGEND



1/4 CORNER AS NOTED



SECTION CORNER AS NOTED

LINE MARKED AS DEFINED IN NARRATIVE



1946 BUREAU OF LAND MANAGEMENT DEPENDENT RESURVEY RECORD DATA



GENERAL LAND OFFICE



BUREAU OF LAND MANAGEMENT

1/4 CORNER SECTIONS 8, 9
 FOUND GLO BRASS CAP DATED 1945
 WITH THE FOLLOWING ACCESSORIES:
 60" D. FIR STUMP BEARS S 9° E 40.9' - ROTTED FACE
 72" D. FIR STUMP BEARS S 52° W 68.6' - ROTTED FACE
 18" D. FIR BEARS S 60° W 34.6' - HEALED FACE
 15" D. FIR BEARS N 7-1/2° W 4.3' - HEALED FACE
 12" D. FIR BEARS N 50-1/2° E 25.6' - HEALED FACE
 12" D. FIR BEARS S 45° E 35.3' - HEALED FACE
 STEEL POST ADJACENT TO CORNER

S8 S9

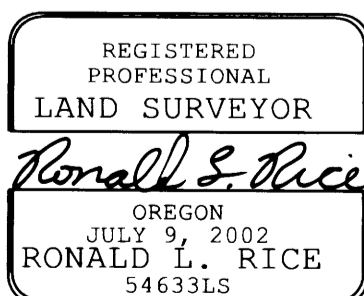

EXPIRATION DATE: 12-31-2016

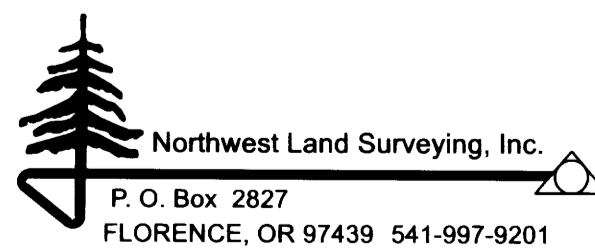

| | | | |
|-------------------------|--------------------|-----------------------------|--|
| FILE NAME 16-120.TRV | | DRAWING RECORD OF SURVEY | |
| SCALE 200 Ft/In | DATE 10-24-2016 | DRAWN BY RLR | |
| JOB BIG EASY | REVISION ----- | SHEET 1/1 | |

This map was drawn with TRAVERSE PC Software