

RECORD OF SURVEY
FOR OXBOW TIMBER 1 LLC
ALL QUARTERS, SECTION 30, T.20 S., R.7 W., W. M.
DOUGLAS COUNTY, OREGON
24 SEPTEMBER 2015

FILED
DATE: 11-10-2015 BY: JC
THIS SURVEY CONSISTS OF:
MAP: M170-15 A & B
NARRATIVE:
CORNER RPT:
DOUGLAS COUNTY
SURVEYOR

A
CLOSING CORNER SECTIONS 19, 30
FOUND GLO BRASS CAP DATED 1954
WITH THE FOLLOWING ACCESSORIES:
17" D. FIR BEARS S 4° E 15.2' - SCRIBING VISIBLE
15" D. FIR BEARS N 81° E 20.0' - SCRIBING VISIBLE
AND OTHER ACCESSORIES AS NOTED IN CSF M167-70
STEEL POST ADJACENT TO CORNER

H
1/4 CORNER SECTIONS 30, 31
FOUND BLM BRASS CAP DATED 1966
WITH THE FOLLOWING ACCESSORIES:
53" D. FIR STUMP BEARS N 24° E 50.5' - HEALED FACE
31" D. FIR BEARS S 41° W 40.3' - HEALED FACE
NEW BEARING TREES THIS SURVEY
17" D. FIR BEARS S 81° E 17.1' - BLAZED, SCRIBED 1/4 S31 BT
18" D. FIR BEARS N 38° W 22.1' - BLAZED, SCRIBED 1/4 S30 BT
STEEL POST ADJACENT TO CORNER

B
1/4 CORNER SECTIONS 19, 30
FOUND GLO BRASS CAP DATED 1966
WITH THE FOLLOWING ACCESSORIES:
31" D. FIR STUMP BEARS N 28° W 27.7' - SCRIBING VISIBLE
50" D. FIR STUMP BEARS S 26° W 4.0' - AXE WORK VISIBLE
NEW BEARING TREES THIS SURVEY
18" D. FIR BEARS N 38° W 17.9' - BLAZED, SCRIBED 1/4 S19 BT
17" D. FIR BEARS N 68° E 14.3' - BLAZED, SCRIBED 1/4 S19 BT
17" D. FIR BEARS S 86° E 11.5' - BLAZED, SCRIBED 1/4 S30 BT
17" D. FIR BEARS S 54° W 13.6' BLAZED, SCRIBED 1/4 S30 BT
STEEL POST ADJACENT TO CORNER

I
TRUE CLOSING CORNER SECTIONS 30, 31
FOUND GLO BRASS CAP DATED 1966
WITH THE FOLLOWING ACCESSORIES:
40" ROTTED D. FIR STUMP BEARS S 33° E 16.5' - NO MARKS
15" ROTTED D. FIR STUMP BEARS N 85° W 21.1' - NO MARKS
SANDSTONE 20 X 20 X 4" ABOVE GROUND BEARS N 80° W 4.0' - WC CHISEL MARKS
34" D. FIR SNAG BEARS N 3-1/4° E 154.1' - NO MARKS
NEW BEARING TREE THIS SURVEY
19" D. FIR BEARS S 86° E 30.5' - BLAZED, SCRIBED T20S R7W S31 CC BT
14" D. FIR BEARS S 46° W 5.2' - BLAZED, SCRIBED X BT
STEEL POST ADJACENT TO CORNER

C
E1/16 CORNER SECTIONS 19, 30
FOUND BLM BRASS CAP DATED 1966
WITH THE FOLLOWING ACCESSORIES:
47" BURNED D. FIR STUMP BEARS N 9° E 24.2' - NO MARKS
35" BURNED D. FIR STUMP BEARS SOUTH 22.4' - NO MARKS
NEW BEARING TREES THIS SURVEY
12" D. FIR BEARS N 10° E 8.7' - BLAZED, SCRIBED E1/16 S19 BT
13" D. FIR BEARS S 71° E 1.5' - BLAZED, SCRIBED E1/16 S30 BT
STEEL POST ADJACENT TO CORNER

J
E1/4 CORNER SECTION 25, T20S, R8W
FOUND GLO BRASS CAP DATED 1950
WITH THE FOLLOWING ACCESSORIES:
40" D. FIR STUMP BEARS S 85-1/2° W 40.9' - NO MARKS
39" D. FIR STUMP BEARS N 75-1/2° W 89.8' - NO MARKS
NEW BEARING TREES THIS SURVEY
13" D. FIR BEARS N 48° E 3.2' - BLAZED, SCRIBED X BT
9" D. FIR BEARS N 52° W 10.5' - BLAZED, SCRIBED 1/4 S25 BT
STEEL POST ADJACENT TO CORNER

D
SECTION CORNER SECTIONS 19, 20, 29, 30
FOUND COUNTY SURVEYORS OFFICE BRASS CAP DATED 1966
WITH THE FOLLOWING ACCESSORIES:
37" ROTTED D. FIR SNAG BEARS N 45° E 17.8' - BURNT OPEN FACE
3' X 10" VERTICAL ROCK OUTCROPPING CHISEL MARKED X S29
WITH 1" BRASS DISK NAILED IN X BEARS S 68-1/4° E 17.9'
38" ROTTED D. FIR STUMP BEARS S 33° E 53.7' - SCRIBING VISIBLE
53" ROTTED D. FIR STUMP BEARS N 12-1/2° W 60.9' - NO MARKS
10" D. FIR BEARS N 70° E 10.8' - HEALED FACE
13" D. FIR BEARS S 76° W 7.3' - HEALED FACE
12" D. FIR BEARS N 51° W 14.6' - HEALED FACE

K
W1/4 CORNER SECTION 30
FOUND GLO BRASS CAP DATED 1966
WITH THE FOLLOWING ACCESSORIES:
SANDSTONE BOLDER 10 X 6 10" ABOVE GROUND BEARS N 63-1/2° E, 26.4' - RECORD MARKS NOT FOUND
SANDSTONR BOLDER 8 X 5 X 6" ABOVE GROUND BEARS S 19-1/2° E 38.9' - MARKED X BO
NEW BEARING TREES THIS SURVEY
11" D. FIR BEARS N 5° E 5.7' - BLAZED, SCRIBED 1/4 S30 BT
12" D. FIR BEARS N 68° W 13.4' - BLAZED, SCRIBED X BT
14" D. FIR BEARS S 5° W 19.4' - BLAZED, SCRIBED X BT
STEEL POST ADJACENT TO CORNER

E
N1/16 CORNER SECTIONS 29, 30
FOUND BLM BRASS CAP DATED 1966
WITH THE FOLLOWING ACCESSORIES:
47" D. FIR STUMP BEARS S 36° E 58.7' - HEALED FACE
62" D. FIR STUMP BEARS S 78° W 60.4' - NO MARKS
NEW BEARING TREE THIS SURVEY
17" D. FIR BEARS N 78° E 14.6' - BLAZED, SCRIBED N1/16 S29 BT
STEEL POST ADJACENT TO CORNER

L
SECTION CORNER SECTIONS 24, 25 T20S, R8W
FOUND GLO BRASS CAP DATED 1950
WITH THE FOLLOWING ACCESSORIES:
12" D. FIR BEARS S 71-3/4° W 39.7' - HEALED FACE
15" D. FIR BEARS N 13-1/4° W 11.1' - HEALED FACE
AND OTHER ACCESSORIES AS NOTED IN CSF 65/76-19
STEEL POST ADJACENT TO CORNER

F
1/4 CORNER SECTIONS 29, 30
FOUND BLM BRASS CAP DATED 1966
WITH THE FOLLOWING ACCESSORIES:
20" FIR STUMP BEARS S 39-1/2° E 93.7' - NO MARKS
62" D. FIR STUMP BEARS N 75° W 38.9' - NO MARKS
NEW BEARING TREES THIS SURVEY
16" D. FIR BEARS S 66° E 33.0' - BLAZED, SCRIBED 1/4 S29 BT
19" D. FIR BEARS N 48° E 22.5' - BLAZED, SCRIBED 1/4 S29 BT
21" D. FIR BEARS N 56° W 25.3' - BLAZED, SCRIBED 1/4 S30 BT
18" D. FIR BEARS S 36° W 15.4' - BLAZED, SCRIBED 1/4 S30 BT
STEEL POST ADJACENT TO CORNER

M
CS1/16 CORNER SECTIONS 30
SET 5/8" X 30" REBAR WITH 2-1/2" ALUMINUM CAP MARKED
AS SHOWN AND ESTABLISHED THE FOLLOWING ACCESSORIES:
15" D. FIR BEARS S 10° W 17.3' - BLAZED, SCRIBED CS1/16 S30 BT
12" D. FIR BEARS N 22° W 9.2' BLAZED, SCRIBED CS1/16 S 30 BT
UNRECORDED 1/2" IRON PIPE BEARS N 66°22' 11" E 1.54'
STEEL POST ADJACENT TO CORNER

C
S1/16 S30
C
2015
54633LS

N
CE1/16 CORNER SECTIONS 30
SET 5/8" X 30" REBAR WITH 2-1/2" ALUMINUM CAP MARKED
AS SHOWN AND ESTABLISHED THE FOLLOWING ACCESSORIES:
16" D. FIR BEARS S 84° E 10.8' - BLAZED, SCRIBED CE1/16 S30 BT
14" D. FIR BEARS N 2° E 24.0' - BLAZED, SCRIBED CE1/16 S30 BT
UNRECORDED 1/2" IRON PIPE BEARS N 89°10'26" E 1.38'
STEEL POST ADJACENT TO CORNER

E1/16
C --- C
S30
2015
54633LS

G
S1/16 CORNER SECTIONS 29, 30
FOUND GLO BRASS CAP DATED 1966
WITH THE FOLLOWING ACCESSORIES:
43" BURNED FIR STUMP BEARS S 89-1/2° E 38.3' - NO MARKS
20" BURNED FIR SNAG BEARS S 57-1/2° W 15.5' - AX WORK VISIBLE
NEW BEARING TREES THIS SURVEY
14" D. FIR BEARS N 85° W 10.8' - BLAZED, SCRIBED S1/16 S30 BT
15" D. FIR BEARS N 21° E 19.2' - BLAZED, SCRIBED S1/16 S29 BT
STEEL POST ADJACENT TO CORNER

O
NE1/16 CORNER SECTIONS 30
SET 5/8" X 30" REBAR WITH 2-1/2" ALUMINUM CAP MARKED
AS SHOWN AND ESTABLISHED THE FOLLOWING ACCESSORIES:
18" D. FIR BEARS S 36° E 13.7' - BLAZED, SCRIBED NE1/16 S30 BT
11" D. FIR BEARS N 72° E 10.0' - BLAZED, SCRIBED NE1/16 S30 BT
STEEL POST ADJACENT TO CORNER

NE1/16 S30
2015
54633LS

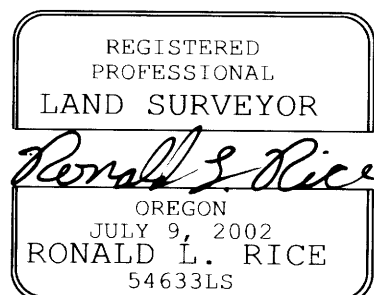

EXPIRATION DATE: 12-31-2016

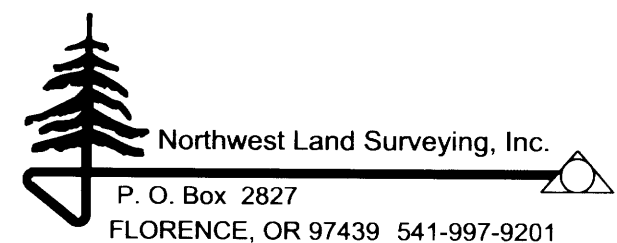

FILE NAME 15-06.TRV		DRAWING ROS PAGE, 2	
SCALE 500 Ft/in	DATE 9-24-2015	DRAWN BY RLR	
JOB H. TIMES	REVISION ----	SHEET 2/2	

This map was drawn with TRAVERSE PC Software