

RECORD OF SURVEY  
 FOR: OXBOW TIMBER 1 LLC  
 NW1/4, NE1/4, SE1/4, SECTION 10, T. 20 S., R. 8 W., W.M.  
 DOUGLAS COUNTY, OREGON  
 8 AUGUST 2014

FILED  
 DATE: 9/3/2014 BY: nwr  
 THIS SURVEY CONSISTS OF:  
 MAP: M 168-37  
 NARRATIVE:  
 CORNER RPT:  
 DOUGLAS COUNTY  
 SURVEYOR

NOTE: PIPE AND CAP FOUND  
 LOOSE ON THE GROUND. RESET BY  
 DISTANCE-DISTANCE INTERSECTION  
 FROM EXISTING ACCESSORIES.



N 88°45'28" W 2630.87' [N 88°46' W 39.97 CHAINS]



BASIS OF BEARING [N 88°46' W 39.97 CHAINS] N 88°46'00" W 2658.08'

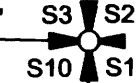

SECTION CORNER SECTIONS 3,4,9,10  
 FOUND GLO BRASS CAP DATED 1954 (SEE NOTE)  
 WITH THE FOLLOWING ACCESSORIES:  
 50" D. FIR STUMP BEARS N 47-1/2° E 33.7' - NO MARKS  
 43" D. FIR BEARS S 78-1/2° E 33.7' - HEALED FACE  
 60" D. FIR SNAG BEARS S 33° W 74.5' (RECORD 73.3') - ROTTED FACE  
 RECORD 52" D. FIR BEARING N 77° W 60 LKS. - DOWN OUT OF POSITION  
 NEW BEARING TREES THIS SURVEY  
 16" D. FIR BEARS N 66° W 48.5' - BLAZED, SCRIBED T20S R8W S4 BT  
 18" D. FIR BEARS N 27° E 63.1' - BLAZED, SCRIBED T20S R8W S3 BT

1/4 CORNER SECTIONS 3,10  
 FOUND GLO BRASS CAP DATED 1954  
 WITH THE FOLLOWING ACCESSORIES:  
 28" CEDAR STUMP BEARS S 15° E 57.4' - NO MARKS  
 RECORD 24" MAPLE BEARING N 79° E 37 LKS. MISSING  
 21" MULTISTEM MAPLE BEARS S 73° W, 31.0' (RECORD 31.7')  
 BLAZED, RESCRIBED 1/4 S10 BT  
 NEW BEARING TREES THIS SURVEY  
 25" D. FIR BEARS N 75° W 53.9' - BLAZED, SCRIBED 1/4 S3 BT  
 21" D. FIR BEARS N 64° E 25.9' - BLAZED, SCRIBED 1/4 S3 BT  
 24" TWIN MAPLE BEARS S 51° E 10.5' - BLAZED SCRIBED 1/4 S10 BT  
 STEEL POST ADJACENT TO CORNER

SECTION CORNER SECTIONS 2,3,10,11  
 FOUND GLO BRASS CAP DATED 1954  
 WITH THE FOLLOWING ACCESSORIES:  
 36" D. FIR STUMP BEARS N 70° E 19.8' - SCRIBING VISIBLE  
 66" D. FIR STUMP BEARS S 45-3/4° E 19.1' - SCRIBING VISIBLE  
 36" D. FIR STUMP BEARS S 48° W 14.5' - SCRIBING VISIBLE  
 46" D. FIR STUMP BEARS N 56-3/4° W 11.9' - SCRIBING VISIBLE  
 NEW BEARING TREES THIS SURVEY  
 12" D. FIR BEARS N 6° E 26.6' - BLAZED, SCRIBED T20S R8W S2 BT  
 12" D. FIR BEARS S 62° E 11.4' - BLAZED SCRIBED T20S R8W S11 BT  
 17" D. FIR BEARS S 1° W 13.8' - BLAZED, SCRIBED T20S R8W S10 BT  
 8" D. FIR BEARS N 80° W 5.4' - BLAZED, SCRIBED T20S R8W S3 BT  
 STEEL POST ADJACENT TO CORNER

NARRATIVE:

THE PURPOSE OF THIS SURVEY IS TO DOCUMENT THE MARKING  
 OF TRUE LINE ON THE NORTH LINE OF SECTION 10, AND THE EAST LINE  
 OF SECTION 10, TOWNSHIP 20 SOUTH, RANGE 8 WEST OF THE WILLAMETTE  
 MERIDIAN.

EXISTING CORNERS WERE TIED BY GROUND TRAVERSE FOR CONTROL  
 AND HELD IN THEIR AS-TIED OR RESET FROM ACCESSORIES POSITIONS  
 FOR MARKING TRUE LINE. TRUE LINE WAS MARKED WITH RED PAINTED  
 BLAZES, RED FLAGGING AND 5-1/2" GALVANIZED STEEL POSTS SET AT AN  
 AVERAGE INTERVAL OF 200'

THE BASIS OF BEARING FOR THIS SURVEY WAS THE 1960 BUREAU OF LAND  
 MANAGEMENT DEPENDENT RESURVEY OF SECTION 10, TOWNSHIP 20  
 SOUTH, RANGE 8 WEST OF THE WILLAMETTE MERIDIAN.





THIS SURVEY WAS PERFORMED USING A NIKON TOTAL STATION.

NOTE: EXISTING BRASS CAP AND PIPE MISSING.  
 SET NEW MONUMENT BY RECORD BEARING AND  
 DISTANCE FROM THE SOUTHWEST BEARING TREE.  
 DISTANCE-DISTANCE INTERSECTION SHOWED AN  
 ERROR IN THE NORTHEAST BEARING TREE RECORD  
 DISTANCE BY PRODUCING AND UNACCEPTABLE  
 POSITION.

1/4 CORNER SECTIONS 10,11  
 NO MONUMENT FOUND (SEE NOTE)  
 SET 5/8" X 30" REBAR WITH 2-1/2" ALUMINUM CAP MARKED AS SHOWN  
 34" D. FIR STUMP BEARS S 36° W 35.6' - HEALED FACE  
 48" D. FIR STUMP BEARS N 26° E 40.6' (RECORD 42.9') - NO MARKS  
 RECORD 14" ALDER BEARING N 41-1/4° E 21 LKS. - MISSING  
 NEW BEARING TREES THIS SURVEY  
 14" ALDER BEARS N 12° E 21.7' - BARK SCRIBED 1/4 S11 BT  
 18" D. FIR BEARS N 19° W 34.7' - BLAZED, SCRIBED 1/4 S10 BT  
 16" D. FIR BEARS S 59° W 9.7' - BLAZED, SCRIBED 1/4 S10 BT  
 12" D. FIR BEARS S 19° E 6.4' - BLAZED, SCRIBED 1/4 S11 BT  
 STEEL POST ADJACENT TO CORNER

T20S R8W  
 1/4  
 S10 | S11  
 2014  
 54633LS

LEGEND

-  1/4 CORNER AS NOTED
-  SECTION CORNER AS NOTED
-  BUREAU OF LAND MANAGEMENT  
1960 DEPENDENT RESURVEY  
RECORD DATA
-  GLO GENERAL LAND OFFICE

SECTION CORNER SECTIONS 10,11,14,15  
 FOUND GLO BRASS CAP DATED 1954  
 WITH THE FOLLOWING ACCESSORIES:  
 46" D. FIR BEARS N 43° E 18.0' - HEALED FACE  
 10" ALDER BEARS N 89° E 23.6' - BARK SCRIBE VISIBLE  
 14" ALDER BEARS WEST 22.4' - BARK SCRIBE VISIBLE  
 12" ALDER BEARS N 59° W (RECORD N 59° E) 16.6' - BARK SCRIBE VISIBLE  
 OTHER ACCESSORIES OF RECORD NOT SEARCHED FOR  
 STEEL AND ALUMINUM POSTS ADJACENT TO CORNER

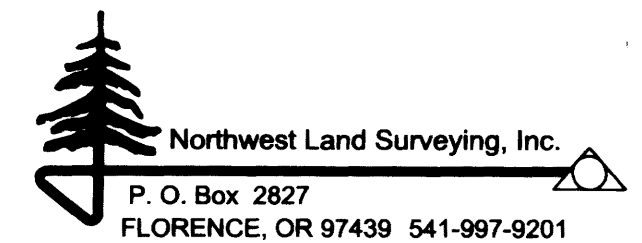

REGISTERED  
 PROFESSIONAL  
 LAND SURVEYOR  
*Ronald L. Rice*  
 OREGON  
 JULY 9, 2002  
 RONALD L. RICE  
 54633LS

EXPIRATION DATE: 12-31-2014

FILE NAME		
14-33.TRV		
SCALE	DATE	DRAWN BY
500 Ft/in	8-8-2014	RLR
JOB	REVISION	SHEET
SWEDISH 10-4	---	1/1

This map drawn with TRAVERSE PC Software

MAP FILE M-168-37

MAP FILE M-168-37