

RECORD OF SURVEY
 FOR: OXBOW TIMBER 1 L. L. C.
 NW1/4, NE1/4, SE1/4, SECTION 24, T. 20 S., R. 8 W., W.M.
 DOUGLAS COUNTY, OREGON
 5 MARCH 2014

FILED
 DATE: 4-25-2014 BY: JC
 THIS SURVEY CONSISTS OF:
 MAP: M167-70
 NARRATIVE:
 CORNER RPT:
 DOUGLAS COUNTY
 SURVEYOR

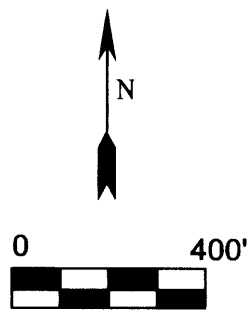

1/4 CORNER SECTIONS 13, 24
 FOUND 2-1/2" GLO BRASS CAP, DATED 1954
 WITH THE FOLLOWING ACCESSORIES:
 33" CEDAR STUMP BEARS N 66° E 50.2' - NO SCRIBING VISIBLE
 31" CEDAR STUMP BEARS S 36-1/4° E 30.4' - NO SCRIBING VISIBLE
 NEW BEARING TREES THIS SURVEY
 19" D. FIR BEARS N 64° W 4.2 FT. - BLAZED, SCRIBED 1/4 S13 BT
 24" D. FIR BEARS N 81° E 22.4 FT. - BLAZED, SCRIBED 1/4 S13 BT
 18" D. FIR BEARS S 74° E 14.6 FT. - BLAZED, SCRIBED 1/4 S24 BT
 16" D. FIR BEARS S 70° W 14.8 FT. - BLAZED, SCRIBED 1/4 S24 BT
 STEEL POST ADJACENT TO CORNER

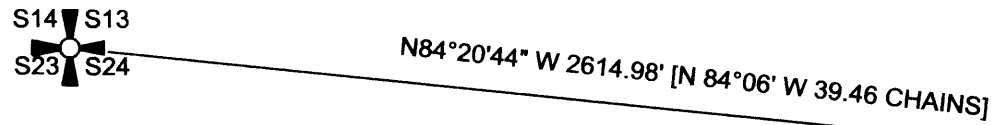

SECTION CORNER SECTIONS 13, 14, 23, 24
 FOUND 2-1/2" GLO BRASS CAP, DATED 1954
 WITH THE FOLLOWING ACCESSORIES:
 27" FIR STUMP BEARS N 52-1/2° E., 53.5' - HEALED FACE
 A MAPLE CLUMP GROWING AROUND A ROOT HOLE BEARS
 N.27° W 22.4' - NO MARKS VISIBLE
 21" FIR BEARS N 13-1/2° E., 33.7 FT - HEALED FACE
 14" FIR BEARS S 32° E 38.8' - HEALED FACE
 16" FIR BEARS S 60-1/2° W 56.4' - HEALED FACE
 10" FIR BEARS N 86-1/2° W 46.5' - HEALED FACE
 STEEL POST ADJACENT TO CORNER

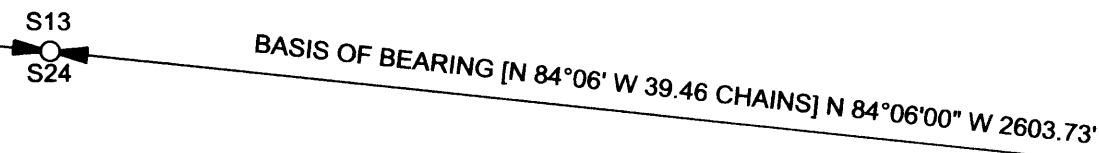

SECTION COR SECTIONS 13, 24
 FOUND 2-1/2" GLO BRASS CAP DATED 1954
 WITH THE FOLLOWING ACCESSORIES:
 RECORD 24" MAPLE STUMP BEARING N 70° E 36 LKS. NOT FOUND
 30" BURNED FIR STUMP BEARS S 65° W 20.5' - BURNER FACE
 RECORD 36" FIR STUMP BEARING N 41° W 63 LKS. - NOT FOUND
 33" FIR STUMP BEARS N 27° W 61.4' - SCRIBING VISIBLE
 RECORD SANDSTONE OUTCROP 3X6X3 FT. ABOVE GROUND BEARING S19-
 1/2° W 62-1/2 LKS. DIST. MKD. X - NOT FOUND
 NEW BEARING TREES THIS SURVEY
 19" D. FIR BEARS N 22° W 17.3 FT. - BLAZED, SCRIBED T20S R8W S13 BT
 19" D. FIR BEARS S 68° W 16.6 FT. - BLAZED, SCRIBED T20S R8W S24 BT
 STEEL POST ADJACENT TO CORNER

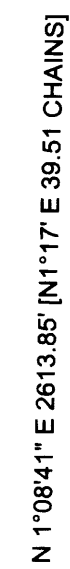

1/4 CORNER SECTION 24 ONLY
 FOUND 2-1/2" GLO BRASS CAP DATED 1954
 WITH THE FOLLOWING ACCESSORIES:
 39" CEDAR STUMP N 62° E 15.8' - SEMI-HEALED FACE
 ROOT HOLE WITH UPROOTED BURNED CEDAR LOG 20" DIA.
 BEARS S 53° W 7.9 FT - NO MARKS VISIBLE
 56" FIR SNAG BEARS N 7° W 48.8' - SCRIBING VISIBLE
 10" FIR BEARS N 78° W 7.7' - HEALED FACE.
 18" FIR BEARS N 9-1/2° W 33.6' - HEALED FACE
 FOUND 16" D. FIR BEARING N 42° E 20.3' WITH HEALED FACE.
 APPEARS TO BE 2005 BLM UNRECORDED BEARING TREE
 STEEL POST ADJACENT TO CORNER



CLOSING CORNER CORNER SECTIONS 19, 30
 FOUND 2-1/2" GLO BRASS CAP, DATED 1954
 WITH THE FOLLOWING ACCESSORIES:
 RECORD 12" BURNED MAPLE BEARING N 40° W 43 LKS. - MISSING
 48" FIR STUMP BEARS N 50-1/2° E 34.3' - SCRIBING VISIBLE
 RECORD 10" HEMLOCK BEARING S 17° E 44 LKS. - MISSING
 37" FIR STUMP BEARS S 38° E 52.1' - NO MARKS
 NEW BEARING TREES THIS SURVEY
 17" D. FIR BEARS S 4° E 15.2 FT. - BLAZED, SCRIBED T20S R7W S30 CC BT
 15" D. FIR BEARS N 81° E 20.0 FT. - BLAZED, SCRIBED T20S R7W S19 CC BT
 STEEL POST ADJACENT TO CORNER

LEGEND

- FOUND SECTION CORNER 2 SECTIONS AS NOTED
- FOUND 1/4 CORNER 2 SECTIONS AS NOTED
- FOUND SECTION CORNER 4 SECTIONS AS NOTED
- FOUND 1/4 CORNER 1 SECTION AS NOTED
- [] 1960 BUREAU OF LAND MANAGEMENT DEPENDENT RESURVEY SECTION 24, T20S, R8W, WM RECORD DATA
- BLM BUREAU OF LAND MANAGEMENT
- GLO GENERAL LAND OFFICE

NARRATIVE:

THE PURPOSE FOR FILING THIS SURVEY IS TO DOCUMENT A PROPERTY LINE SURVEY FOR OXBOW TIMBER 1 L. L. C. THAT WAS PERFORMED IN OCTOBER OF 2013. ROSEBURG RESOURCES CO., HAS REQUESTED THAT ALL SURVEY WORK PERFORMED FOR THEM BETWEEN 2011 AND 2014 BE SHOWN IN A RECORD OF SURVEY. WHEN THE SURVEY WORK WAS PERFORMED, NO CORNERS WERE SET, ONLY PROPERTY LINES WERE MARKED AS NOTED HEREON.

THIS SURVEY RESULTED IN THE MARKING OF TRUE LINE BETWEEN THE CORNERS SHOWN ON THIS RECORD OF SURVEY OF SECTION 24, TOWNSHIP 20 SOUTH, RANGE 8 WEST OF THE WILLAMETTE MERIDIAN.

EXISTING CORNERS WERE TIED BY GROUND TRAVERSE FOR CONTROL AND HELD IN THEIR AS TIED POSITIONS FOR MARKING TRUE LINE. TRUE LINE WAS MARKED WITH RED PAINTED BLAZES, RED FLAGGING AND 5-1/2" GALVANIZED STEEL POSTS SET AT AN AVERAGE INTERVAL OF 200'

THE BASIS OF BEARING FOR THIS SURVEY WAS THE 1960 BUREAU OF LAND MANAGEMENT DEPENDENT RESURVEY OF SECTION 24, TOWNSHIP 20 SOUTH, RANGE 8 WEST OF THE WILLAMETTE MERIDIAN.

THIS SURVEY WAS PERFORMED USING A NIKON TOTAL STATION.

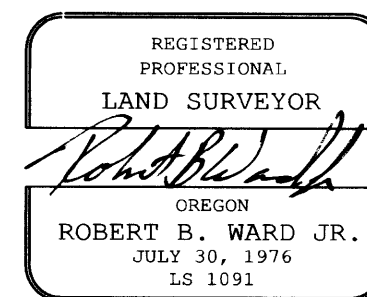

EXPIRATION DATE: 6/30/14

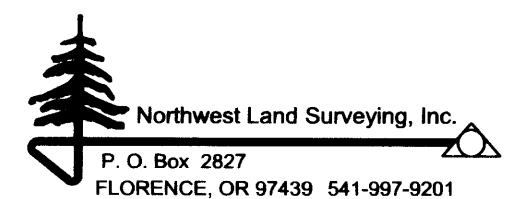

FILE NAME		
13-79	DATE	DRAWN BY
400 F/In	3-5-2014	RLR
JOB	REVISION	SHEET
BUM 24		1/1

This map drawn with TRAVERSE PC Software