

RECORD OF SURVEY
 FOR: OXBOW TIMBER 1 L. L. C.
 NE1/4, SECTION 14, T. 20 S., R. 8 W., W. M.
 DOUGLAS COUNTY, OREGON
 20 FEBRUARY 2014

FILED
 DATE: 4-3-2014 BY: XC
 THIS SURVEY CONSISTS OF:
 MAP: M 167-51
 NARRATIVE: _____
 CORNER RPT: CS 65/78-17
 DOUGLAS COUNTY
 SURVEYOR CS 65/78-19
CS 65/78-20

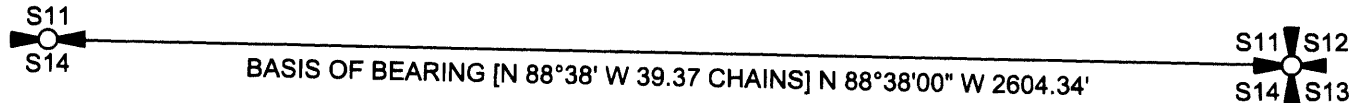
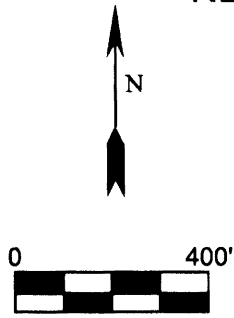

1/4 CORNER SECTIONS 11, 14
 FOUND 1954 G. L. O. BRASS CAP
 WITH THE FOLLOWING ACCESSORIES:
 15" D. FIR SNAG BEARS S 57° W 35.0 FT. - HEALED FACE
 17" D. FIR SNAG BEARS N 45° W 12.0 FT. - HEALED FACE
 RECORD 12" D. FIR SNAG N34° E 17.5 FT. - NOT FOUND
 20" D. FIR SNAG BEARS N 34° E 17.5 FT. - HEALED FACE
 10" D. FIR BEARS S 2° W 23.3 FT. - HEALED FACE
 17" D. FIR BEARS N 73° W 22.0 FT. - HEALED FACE
 STEEL POST ADJACENT TO CORNER

SECTION CORNER SECTIONS 11, 12, 13, 14
 FOUND 1954 GLO BRASS CAP WITH THE FOLLOWING ACCESSORIES:
 37" D. FIR SNAG BEARS S 60° E 31'.0' - BURNED FACE, NO SCRIBE MARKS
 30" D. FIR SNAG BEARS S 18° W 15.8' - NO MARKS
 34" D. FIR STUMP BEARS N 13-1/2° W 48.2' - BURNED FACE, NO SCRIBING
 35" D. FIR STUMP BEARS N 54° E 19.1' - ROTTED FACE, CRUISER MARK IN BARK
 NEW BEARING TREES THIS SURVEY
 8" D. FIR BEARS N 21° W 11.2 FT. - BLAZED, SCRIBED, T20S R8W S11 BT
 14" D. FIR BEARS N 38° E 24.2 FT. - BLAZED, SCRIBED, T20S R8W S12 BT
 15" D. FIR BEARS S 1° E 24.6 FT. - BLAZED, SCRIBED, T20S R8W S13 BT
 12" D. FIR BEARS S 26° W 9.8 FT. - BLAZED, SCRIBED, T20S R8W S14 BT

NARRATIVE:

THE PURPOSE FOR FILING THIS SURVEY IS TO DOCUMENT A PROPERTY LINE SURVEY FOR OXBOW TIMBER 1 L. L. C. THAT WAS PERFORMED IN FEBRUARY OF 2013. ROSEBURG RESOURCES CO., HAS REQUESTED THAT ALL SURVEY WORK PERFORMED FOR THEM BETWEEN 2011 AND 2014 BE SHOWN IN A RECORD OF SURVEY. WHEN THE SURVEY WORK WAS PERFORMED, NO CORNERS WERE SET, ONLY PROPERTY LINES WERE MARKED AS NOTED HEREON.

THIS SURVEY RESULTED IN MARKING THE TRUE LINE BETWEEN N1/4 CORNER AND NE SECTION CORNER OF SECTION 14 THEN SOUTH TO THE EAST 1/4 CORNER OF SECTION 14 TOWNSHIP 20 SOUTH, RANGE 8 WEST OF THE WILLAMETTE MERIDIAN

EXISTING CORNERS WERE TIED BY GROUND TRAVERSE FOR CONTROL AND HELD IN THEIR AS TIED POSITIONS FOR MARKING TRUE LINE. TRUE LINE WAS MARKED WITH RED PAINTED BLAZES, RED FLAGGING AND 5-1/2' GALVANIZED STEEL POSTS SET AT AN AVERAGE INTERVAL OF 200'

THE BASIS OF BEARING FOR THIS SURVEY WAS THE 1960 BUREAU OF LAND MANAGEMENT DEPENDENT RESURVEY OF SECTION 14, TOWNSHIP 20 SOUTH, RANGE 8 WEST OF THE WILLAMETTE MERIDIAN.

THIS SURVEY WAS PERFORMED USING A NIKON TOTAL STATION.

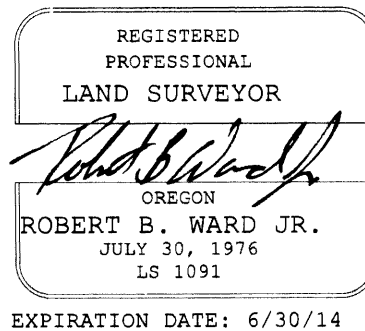

EXPIRATION DATE: 6/30/14

N 0°11'42" E 2511.02' [N 0°32' E 38.10 CHAINS]



1/4 CORNER SECTIONS 13, 14
 FOUND 1954 GLO BRASS CAP
 WITH THE FOLLOWING ACCESSORIES:
 11" D. FIR BEARS N 40° E 5.5 FT. - HEALED FACE
 14" D. FIR BEARS S 34-1/2° W 13.2 FT. - HEALED FACE
 NEW BEARING TREES THIS SURVEY
 13" D. FIR BEARS S 58° E 16.3 FT. - BLAZED, SCRIBED, 1/4 S13 BT
 11" D. FIR BEARS S 88° W 16.6 FT. - BLAZED, SCRIBED, 1/4 S14 BT
 STEEL POST ADJACENT TO CORNER

LEGEND

- FOUND 1/4 CORNER AS NOTED
- FOUND SECTION CORNER AS NOTED
- [] 1960 BUREAU OF LAND MANAGEMENT DEPENDENT RESURVEY OF SECTION 14
- BLM BUREAU OF LAND MANAGEMENT

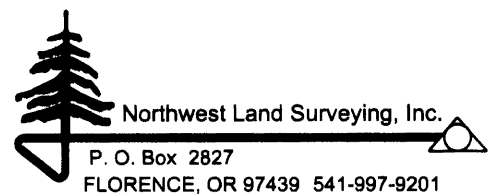

FILE NAME		
12-103S14R.TRV		
SCALE	DATE	DRAWN BY
400 Ft/in	2-20-2014	RLR
JOB	REVISION	SHEET
HEAD SISTER	---	1/1

This map drawn with TRAVERSE PC Software