

AMENDED RECORD OF SURVEY

(SURVEY M-166-18)
LOCATED IN THE
NE 1/4 OF SECTION 15 AND THE N 1/2 OF SECTION 13
TOWNSHIP 29 SOUTH, RANGE 9 WEST, W.M.
DOUGLAS COUNTY, OREGON

FILED
Date: 9-21-2015 By: JC
This survey consists of:
Map: M-166-43A-c
North: true
Corner: true
DOUGLAS COUNTY
SURVEYOR

AMENDMENT NOTE:

PIPELINE DESIGN CHANGES HAVE OCCURRED SINCE THE FILING OF SURVEY M166-18. ALL MONUMENTS SET IN M166-18 THAT ARE NO LONGER PART OF THE UPDATED DESIGN HAVE BEEN REMOVED. NEW MONUMENTS HAVE BEEN SET AS SHOWN HEREON.

THE ADDITIONAL RECORD DATA IS BEING SHOWN ON THIS SURVEY.

LEGEND

- 5/8" X 24" REBAR WITH 1 1/4" YELLOW PLASTIC CAP FROM SURVEY M166-18 VERIFIED OR RESET THIS AMENDED SURVEY. (KLEIN & ASSOC. PLS 59002)
- SET 5/8" X 24" REBAR WITH 1 1/4" YELLOW PLASTIC CAP SURVEY M166-18 VERIFIED OR RESET THIS AMENDED SURVEY. (KITZ 1853LS)
- ⊙ FOUND MONUMENT AS NOTED (SEE CORNER NOTES)
- COMPUTED POINT, NOT MONUMENTED
- ⊠ FOUND QUARTER CORNER SEE CORNER NOTES
- ⊠ FOUND SECTION CORNER SEE CORNER NOTES
- ⊠ QUARTER CORNER FOR REFERENCE ONLY
- ⊠ SECTION CORNER FOR REFERENCE ONLY
- POINT NUMBER
- [XXX.XX'] GROUND DISTANCE
- (XXX.XX') RECORD DISTANCE PER REFERENCED SURVEY
- R1 REFERENCED SURVEY
- PROPOSED ALIGNMENT
- TEMPORARY CONSTRUCTION EASEMENT
- TEMPORARY WORK AREA

SURVEYOR'S CERTIFICATE

I, JAMES M. KLEIN BEING DULY SWORN AS A PROFESSIONAL LAND SURVEYOR IN THE STATE OF OREGON DO HEREBY CERTIFY THAT THIS MAP CORRECTLY REPRESENTS A SURVEY CONDUCTED UNDER MY DIRECT SUPERVISION IN CONFORMANCE WITH THE REQUIREMENTS OF THE SURVEY RECORDING LAW, AS ESTABLISHED BY ORS CHAPTER 209, AND HAVE SET THE PROPER MONUMENTS AS REFERENCED IN THE LEGEND BY MY REGISTRATION NUMBER AND SEAL.

FURTHERMORE, I APPROVE THE LOCATION OF THE MONUMENTS AS DEPICTED ON THIS SURVEY DRAWING TO BE IN THEIR PROPER LOCATION.

JAMES M. KLEIN PLS. 59002

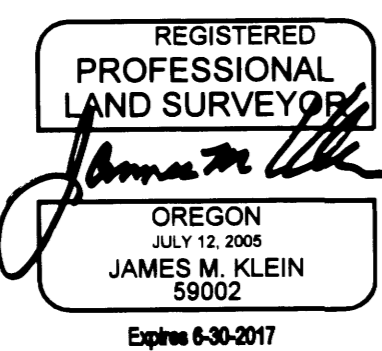

SURVEYOR'S CERTIFICATE

I, DOUGLAS A. POPHAM BEING DULY SWORN AS A PROFESSIONAL LAND SURVEYOR IN THE STATE OF OREGON, ALSO BEING A CERTIFIED FEDERAL SURVEYOR, DO HEREBY CERTIFY THAT THIS MAP CORRECTLY REPRESENTS A SURVEY THAT I HAVE REVIEWED AND VERIFIED. THIS SURVEY CONFORMS WITH THE REQUIREMENTS OF THE STATE OF OREGON SURVEY RECORDING LAW, AS ESTABLISHED BY ORS CHAPTER 209.

FURTHERMORE, I APPROVE THE DESCRIPTIONS, DIMENSIONS AND LOCATIONS OF THE RECOVERED MONUMENTS AS DEPICTED HEREON.

DOUGLAS A. POPHAM PLS. 2877 OFDS 1245

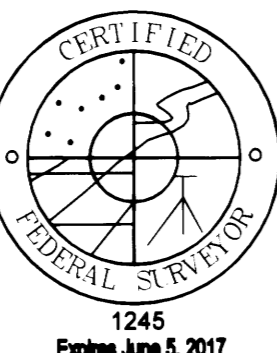
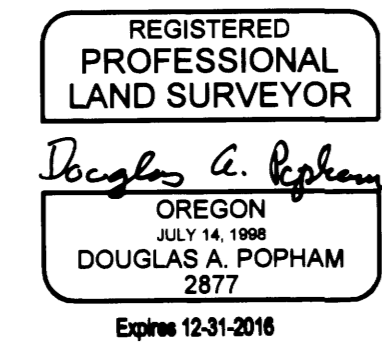

SURVEYOR'S CERTIFICATE

I, RICHARD R. KITZ BEING DULY SWORN AS A PROFESSIONAL LAND SURVEYOR IN THE STATE OF OREGON DO HEREBY CERTIFY THAT THIS MAP CORRECTLY REPRESENTS A SURVEY CONDUCTED UNDER MY DIRECT SUPERVISION IN CONFORMANCE WITH THE REQUIREMENTS OF THE SURVEY RECORDING LAW, AS ESTABLISHED BY ORS CHAPTER 209, AND HAVE SET THE PROPER MONUMENTS AS REFERENCED IN THE LEGEND BY MY REGISTRATION NUMBER AND SEAL.

FURTHERMORE, I APPROVE THE LOCATION OF THE MONUMENTS AS DEPICTED ON THIS SURVEY DRAWING TO BE IN THEIR PROPER LOCATION.

RICHARD R. KITZ PLS. 1853

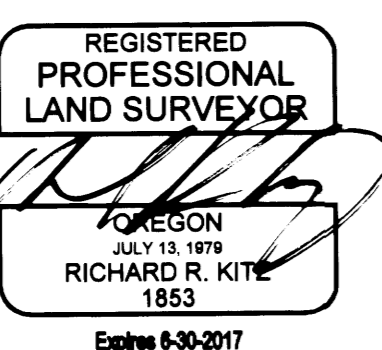

T. 29S., R. 09W	
15	13
SURVEY PERFORMED FOR: WILLIAMS PACIFIC CONNECTOR DATE: FEBRUARY 5, 2015 PROJECT: 14-02-05 DRAFT: GD, LS FILE: RS-29S-R09W-AWG	

SHEET INDEX:

SHEET 1 = COVER PAGE TOWNSHIP OVERVIEW
SHEET 2 = SECTION 15
SHEET 3 = SECTION 13

NARRATIVE

THE PURPOSE OF THIS SURVEY IS TO AMEND THE SURVEY FILED AS COUNTY SURVEY NO. M166-18. THIS SURVEY SHOWS ADDITIONAL INFORMATION FOR THE FOUND AND RECORD DATA BETWEEN EXISTING MONUMENTS. THIS SURVEY ALSO HAS AN ADDITIONAL SURVEY CERTIFICATE SHOWN.

THE TEMPORARY CONSTRUCTION CORRIDOR FOR THE WILLIAMS PACIFIC CONNECTOR GAS LINE. THIS SURVEY IS LOCATED IN TOWNSHIP 29 SOUTH, RANGE 9 WEST, OF THE WILLAMETTE MERIDIAN.

THE PUBLIC LAND SURVEY SYSTEM MONUMENTS WERE FOUND AND TIED BY KLEIN & ASSOCIATES AND VERIFIED BY DOUG POPHAM A CERTIFIED FEDERAL SURVEYOR.

THE TEMPORARY CONSTRUCTION EASEMENT WAS SURVEYED AND MONUMENTED BY EASTSIDE CONSULTANTS, INC.

THE INTERSECTION OF THE TEMPORARY CONSTRUCTION EASEMENT AND THE FEDERAL LANDS WERE MONUMENTED BY KLEIN & ASSOCIATES.

SCALE FACTOR NOTE

THE DISTANCES SHOWN ON THIS SURVEY ARE GRID DISTANCES UNLESS NOTED.
THE COMBINED SCALE FACTOR = 0.999804944
TO CONVERT FROM GRID TO GROUND MULTIPLY THE DISTANCE BY 1.000195054.

EXAMPLE: 300.00' GRID DISTANCE
300.00' x 1.000195054 = 300.06' GROUND DISTANCE.

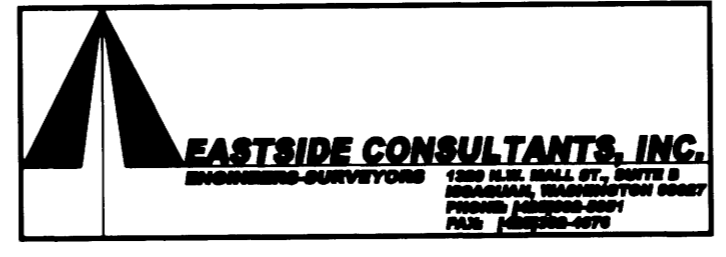

CORNER NOTES:

- (140907)** EAST 1/4 CORNER SECTIONS 11 AND 14 FOUND 2" ALUMINUM CAP STAMPED AA SURVEYING SERVICE, INC. BT REFERENCES: 1) 7" FIR WITH AA TAG DATED 1/84 S 51-3/4' E, 7.5' 2) 14.5" FIR WITH AA TAG DATED 1/84 S 42' W, 7.3' 3) 1" IRON PIPE SET BY BLM IN JAN. 1978 S 61-1/2' W, 1.05' FROM WHICH, 4) A 10.5" FIR WITH HEALED FACE TAG DATED 11/07 N 74-1/4' E, 10.9' TO NAIL 5) AN 11" FIR WITH HEALED FACE TAG DATED 11/07 S 0-1/4' E, 18.8' TO NAIL
- (142792)** 1/4 CORNER COMMON TO SECTIONS 9/10 FOUND 3-1/4" BRASS CAP ON 2-1/2" PIPE STAMPED BLM 1968 BT REFERENCES: 1) 20" FIR WITH HEALED FACE AND TAG DATED 08/00 N 16' E - 52.4' TO NAIL IN SIDE CENTER 2) 35' 3 FT. TALL STUMP WITH HEALED "X" N 39'15" E - 11.2' 3) 17" HEMLOCK WITH HEALED FACE AND TAG DATED 6/68 S 79' W - 106.3' 4) 19" WHITE FIR WITH HEALED FACE AND COOS COUNTY TAG DATED 8/00 N 41' W - 40.4' TO NAIL IN SIDE CENTER
- (148107)** NORTHWEST CORNER SECTION 10 FOUND 2-1/2" BRASS CAP ON 1" PIPE STAMPED COOS COUNTY, DOUGLAS CO. SURVEYORS OFF. 1959 BT REFERENCES: 1) 31" HEMLOCK WITH HEALED FACE AND BLM TAG DATED 5/68 N 18' E - 23.1' 2) 24" FIR WITH HEALED FACE AND BLM TAG DATED 05/68 S 37-1/2' E - 49.5' 3) 55" STUMP 6 FT. TALL WITH TAG DATED 1998 S 25' E - 31.7' 4) 31" CEDAR WITH TAG DATED 1998 S 58' W - 17.2' 5) 19.5" HEMLOCK WITH VISIBLE SCRIBE AND TAG DATED 05/03/05 N 10-1/4' W - 42.9' TO NAIL IN SIDE CENTER
- (140908)** CENTER-EAST 1/16 CORNER SECTION 14 FOUND 2" ALUMINUM CAP ON 5/8" REBAR STAMPED AA SURVEYING SERVICE, INC. BT REFERENCES: 1) 18.5" ALDER WITH AA TAG DATED 01/84 N 60' W - 7.4'
- (140909)** CENTER 1/4 CORNER SECTION 14 FOUND 2" ALUMINUM CAP ON 5/8" REBAR STAMPED LS 2485 2000. BT REFERENCES: 1) 14" DIA. 5 FT. TALL STUMP N 38' E - 18.7' 2) 13" DIA. 5 FT. TALL STUMP WITH TAG DATED 07/00 S 09' E - 5.0' 3) 15" 20 FT. TALL SNAG WITH TAG DATED 07/00 S 84' W - 15.4'
- (140910)** 1/4 CORNER SECTIONS 11/14 FOUND 2-1/2" BRASS CAP ON 1" PIPE STAMPED COUNTY SURVEYORS OFFICE 1959 BT REFERENCES: 1) 12" FIR WITH HEALED FACE AND TAG DATED 09/04 N 46' E - 28.55' 2) 12.5" FIR WITH HEALED FACE AND TAG DATED 08/00 S 18' E - 30.6' 3) 13" FIR WITH VISIBLE SCRIBE AND TAG DATED 09/04 S 32' W - 44.7' TO NAIL
- (140930)** CENTER 1/4 CORNER SECTION 10 FOUND 5/8" REBAR WITH YELLOW CAP STAMPED I.E. ENG BT REFERENCES: 1) 30" FIR WITH HEALED FACE AND TAG DATED 02/01 N 54-1/2' E - 11.4' 2) 7" HEMLOCK WITH HEALED FACE AND TAG DATED 02/01 S 14' W - 115.7' TO NAIL IN SIDE CENTER

BASIS OF BEARINGS NOTE:

THE PROJECT DATUM IS BASED ON PREVIOUSLY ESTABLISHED PROJECT CONTROL.
THE DATUM IS VERY CLOSE BUT NOT EXACTLY OREGON SOUTH ZONE 3602
THE PROJECT BEARINGS MATCH THE OREGON SOUTH ZONE 3602 BEARINGS

NOTE:

DISTANCES ARE IN US SURVEY FOOT.
MEAN MERIDIAN CONVERGENCE ANGLE = -2'12"40"

REFERENCE SURVEYS:

- BLM DEPENDENT RESURVEY NO. 7434 - AUGUST 18, 2010
- SURVEY NO. M136-62 - MARCH 16, 2001
- BLM ADMINISTRATIVE SURVEY NO. M81-12 - DATED NOV. 26, 1979
- SURVEY NO. M95-75 - JANUARY 1984
- BLM DEPENDENT RESURVEY NO. 7296 - OCT. 24, 2008
- BLM DEPENDENT RESURVEY NO. 7137 - OCT. 22, 2004
- BLM DEPENDENT RESURVEY NO. 5457 - MARCH 12, 1971
- BLM RETRACEMENT SURVEY NO. 7439 - SEPT. 27, 2010
- ORIGINAL GLO PLAT JULY 1856
- SURVEY NO. M135-53 - SEPT. 9, 2000
- BLM DEPENDENT RESURVEY NO. 5397 - JAN. 23, 1969

