

**CORNER NOTES:**

**(14018)**  
SOUTHEAST 1/16 CORNER SECTION 12  
FOUND 2-1/2" ALUMINUM CAP  
STAMPED PLS 866, 1980  
BT REFERENCES:  
1) FOUND 18.5" FIR WITH HEALED FACE  
AND TAG DATED 1/80  
S 07° W - 37.5'  
2) FOUND 18" D. FIR WITH HEALED FACE  
AND TAG DATE 1/80  
N 86° W - 14.3'

**(14018)**  
SOUTH 1/16 CORNER SECTION 12  
FOUND 3" BRASS CAP  
STAMPED PLS 944, 1978  
BT REFERENCES:  
1) FOUND 21" FIR WITH HEALED FACE  
AND TAG DATED 8/78  
S 55° W - 49.8' TO NAIL SIDE CENTER  
2) FOUND 21.5" HEMLOCK WITH VISIBLE SCRIBES  
AND TAG DATED 8/78  
N 81° W - 27.3'

**(96082)**  
NORTHEAST CORNER SECTION 13  
FOUND 3" BRASS CAP  
STAMPED PLS 944, 1979  
BT REFERENCES:  
1) FOUND 23.3" FIR WITH HEALED FACE  
AND TAG DATED 12/79  
N 58° E - 25.1'  
2) FOUND 5" FIR SNAG WITH VISIBLE SCRIBES  
N 39°15' W - 11.1'  
3) FOUND 59" FIR WITH HEALED FACE  
AND TAGS DATED 12/79 AND 1959  
N 71° W - 26.3'

**(14017)**  
1/4 CORNER SECTIONS 12 AND 13  
FOUND 2-1/2" BRASS CAP  
STAMPED COUNTY SURVEYORS OFFICE 1965  
BT REFERENCES:  
1) FOUND 16.5" FIR WITH HEALED FACE  
AND TAG DATED 11/79  
S 61° E - 25.4' TO NAIL SIDE CENTER  
AND TAG DATED 11/19/79  
S 2°30' E - 35.5'  
3) FOUND 13.7" CEDAR WITH HEALED FACE  
SET TAG DATED 10/13  
N 58° E - 41.7' TO NAIL SIDE CENTER

**(14024)**  
FOUND ORIGINAL LINE TREE  
FOUND 55" BURNED AND DECAYING SNAG  
WITH 2 VISIBLE NOTCHES ON THE NORTH  
PER THE ORIGINAL NOTES.  
(72.60 CHAINS NORTH OF SE CORNER OF SECTION 13)  
SET BEARING TREE TAG ON SNAG AND  
FLAGGED AND PAINTED THE NOTCHES.

**REFERENCE SURVEYS:**

- 1) RECORD OF SURVEY NO. M79-20 - MAY 22, 1980
- 2) RECORD OF SURVEY NO. M79-43 - JUNE 9, 1980
- 3) BLM DEPENDENT RESURVEY NO. 6077 - T305-R3W - JAN. 10, 1986
- 4) ORIGINAL GLO PLAT, TOWNSHIP 31 SOUTH, RANGE 3 WEST - JUNE 29, 1895
- 5) RECORD OF SURVEY NO. 166-29 - FEB. 9, 2015
- 6) RECORD OF SURVEY NO. M111-67 - APRIL 10, 1991
- 7) RECORD OF SURVEY NO. M84-4 - JUNE 18, 1980
- 8) ORIGINAL GLO NOTES, SOUTH LINE OF TOWNSHIP 31 SOUTH, RANGE 2 WEST - SEPT. 26, 1908

**LEGEND**

- SET 5/8" X 24" REBAR WITH 1 1/4" YELLOW PLASTIC CAP (KLEIN & ASSOC. LS 59002)
- SET 5/8" X 24" REBAR WITH 1 1/4" YELLOW PLASTIC CAP (PRIMM LAND SURVEYING, INC. LS 48490)
- ⊙ SET 5/8" X 24" REBAR WITH 1 1/4" YELLOW PLASTIC CAP (DYER PARTNER LS 2340)
- ⊙ FOUND MONUMENT OF RECORD, SEE CORNER NOTES
- COMPUTED POINT, NOT MONUMENTED
- ⊗ FOUND QUARTER CORNER SEE CORNER NOTES
- ⊗ FOUND SECTION CORNER SEE CORNER NOTES
- ⊗ COMPUTED QUARTER CORNER
- ⊗ COMPUTED SECTION CORNER
- △ CORNER SEARCHED AND NOT FOUND
- ①①①①① POINT NUMBER
- {xxx.xx'} GROUND DISTANCE
- (xxx.xx') RECORD DISTANCE PER REFERENCED SURVEY
- R1 REFERENCED SURVEY
- PROPOSED ALIGNMENT
- - - - - TEMPORARY CONSTRUCTION EASEMENT
- - - - - TEMPORARY WORK AREA

**RECORD OF SURVEY**

LOCATED IN THE  
SE 1/4 OF THE SE 1/4 OF SECTION 12  
AND THE  
THE NE 1/4 OF SECTION 13  
TOWNSHIP 31 SOUTH, RANGE 3 WEST, W.M.  
DOUGLAS COUNTY, OREGON

FILED  
Date: 8-17-2015  
This survey consists of:  
Map: M16-40A-1  
Name:  
Corner File:  
DOUGLAS COUNTY  
SURVEYOR

AREA SECTION 12 & 13

TEMPORARY CONSTRUCTION EASEMENT	15.72 ACRES
TEMPORARY WORK AREA	0.71 ACRES

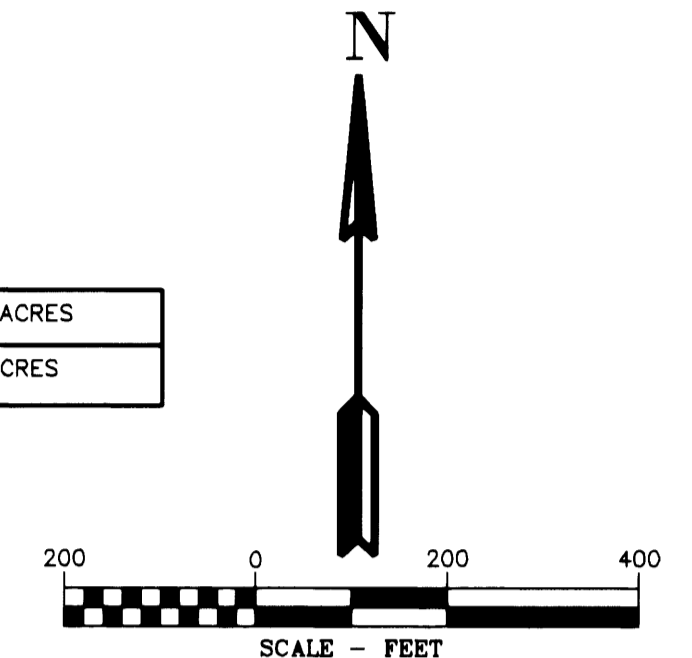

**LINE TABLE**

Line #	Direction	Length
L89	S13°33'31"W	228.07'
L90	S05°38'32"W	293.23'
L91	S63°46'45"W	17.66'
L92	S05°38'32"W	109.23'
L93	S32°06'39"E	236.28'
L94	S16°18'15"E	103.04'
L95	S03°00'32"E	15.84'
L96	S58°04'19"E	36.60'
L97	S03°00'32"E	40.30'
L98	S03°00'32"E	47.88'
L99	S35°22'01"W	78.92'
L100	S54°37'59"E	15.00'
L101	S35°22'01"W	73.70'
L102	S03°00'32"E	42.66'
L103	S86°59'28"W	15.00'



REGISTERED PROFESSIONAL LAND SURVEYOR  
Douglas C. Popham  
OREGON JULY 14, 1988  
DOUGLAS A. POPHAM 2877  
Expires 12-31-2016

REGISTERED PROFESSIONAL LAND SURVEYOR  
MICHAEL W. ERICKSON 2340  
Expires 12-31-2015

REGISTERED PROFESSIONAL LAND SURVEYOR  
James M. Klein  
OREGON JULY 28, 1988  
JAMES M. KLEIN 59002  
Expires 6-30-2017

**Primm Land Surveying, Inc.**  
1340 NE 4th Street, Hermiston, OR 97838  
TEL (541) 564-7887 FAX (541) 567-8020

**D THE DYER PARTNERSHIP ENGINEERS & PLANNERS, INC.**  
1330 Teakwood Avenue / Coos Bay, Oregon 97420  
(541) 269-0732 / WWW.DYERPART.COM

**Klein & Associates, Inc.**  
ENGINEERING • SURVEYING • PLANNING  
1411 13th Street • Hood River, OR 97031  
TEL: 541-386-3322 • FAX: 541-386-2515

PACIFIC CONNECTOR GAS PIPELINE PROJECT  
PACIFIC CONNECTOR GAS PIPELINE, LP  
RECORD OF SURVEY  
SECTION 12 & 13  
TOWNSHIP 31 SOUTH, RANGE 3 WEST, W.M.  
DOUGLAS COUNTY OREGON

DRAWN BY: LJS	DATE: 06-01-2015	ISSUED FOR BID:	SCALE: 1" = 200'
CHECKED BY:	DATE:	ISSUED FOR CONSTRUCTION:	
APPROVED BY:	DATE:	DRAWING NUMBER:	SHEET 4 OF 9

EAST 1/4 CORNER OF SECTION 13 WAS NOT FOUND. SAID CORNER WAS A FIR POST 4" SQUARE AND 4' LONG SET BY BUSHY IN 1894. A FOREST FIRE HAS DESTROYED THE WOOD POST AND THE ORIGINAL BEARING TREES. THIS POINT HAS BEEN COMPUTED BY SINGLE PROPORTION USING FOUND ORIGINAL LINE TREES AS DESCRIBED IN THE ORIGINAL NOTES NORTH AND SOUTH OF THIS CORNER.

