

**BOUNDARY SURVEY OF LOTS 5, 6 AND A PORTION OF LOT 7 OF  
BLOCK 7 OF THE CITY OF CANYONVILLE, LOCATED IN THE NW1/4  
OF SECTION 34, T.30S., R.5W., W.M., CITY OF CANYONVILLE,  
DOUGLAS COUNTY, OREGON  
W.O. 13-4420**

**SURVEY FOR**

ADVANTAGE CLINIC PROPERTIES, LLC  
442 SW UMATILLA AVE., STE 100  
REDMOND, OR 97756  
(541) 323-4612

**SURVEY BY**

ARMSTRONG SURVEYING  
& ENGINEERING, INC.  
267 NE SECOND ST. STE. 100  
PRINEVILLE, OR 97754  
(541) 447-7791

**FILED**  
Date: 11/5/2013 By: hwt  
This survey consists of:  
Map: M 165-76  
Narrative: \_\_\_\_\_  
Corner Rpt: \_\_\_\_\_  
**DOUGLAS COUNTY  
SURVEYOR**

**LEGEND**

- SET 5/8" x 30" LONG IRON ROD WITH YELLOW PLASTIC CAP MARKED "ARMSTRONG S&E".
- SET BRASS WASHER IN LEAD PLUG STAMPED "LS53270" IN EDGE OF CONCRETE PLANTER BOX.
- FOUND 3/4" IRON PIPE AS PER C.S. 55/14-1 BY JOHN LAURILA JR., DATED SEPTEMBER 8, 1966.
- 1( ) RECORD AS PER C.S. 55/14-1 BY JOHN LAURILA JR., DATED SEPTEMBER 8, 1966.
- 2( ) RECORD AS PER SURVEY MAP M 85-79 BY JOHN H. MARKHAM, JR., LS 1261, RECORDED OCTOBER 22, 1980.
- 3( ) RECORD AS PER SURVEY MAP M 50-36 BY EUGENE A. BLOOM, LS 492, DATED JULY 1973.
- SFNF SEARCHED FOR NOT FOUND

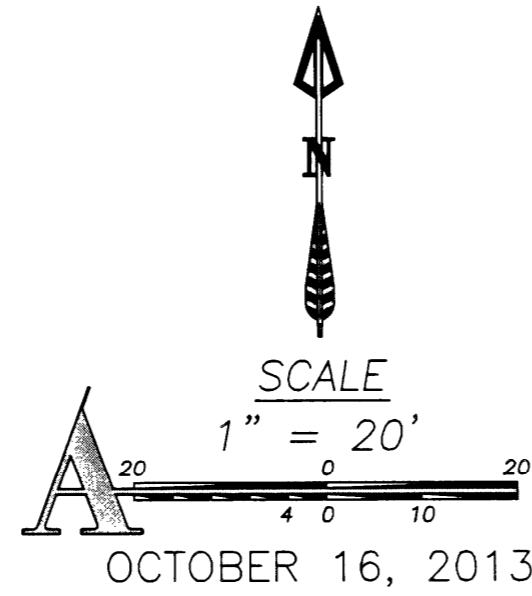

**SURVEYOR'S CERTIFICATE**

I, TODD R. CATTERSON, A REGISTERED PROFESSIONAL LAND SURVEYOR IN THE STATE OF OREGON, ON THE BASIS OF MY KNOWLEDGE, INFORMATION AND BELIEF, CERTIFY TO ADVANTAGE CLINIC PROPERTIES, LLC, THAT AS A RESULT OF A SURVEY MADE ON THE GROUND TO THE NORMAL STANDARD OF CARE OF PROFESSIONAL LAND SURVEYORS PRACTICING IN OREGON, I HAVE FOUND OR SET THE MONUMENTS AS SHOWN HEREON AND HAVE PREPARED THIS MAP AND NARRATIVE TO REPRESENT SAID SURVEY.

**SURVEY NARRATIVE**

WE WERE EMPLOYED BY ADVANTAGE CLINIC PROPERTIES, LLC, TO COMPLETE A BOUNDARY SURVEY OF THEIR PROPERTY DESCRIBED AS LOTS 5, 6 AND A PORTION OF LOT 7 OF BLOCK 7 OF THE CITY OF CANYONVILLE. SUBJECT PROPERTY WAS PREVIOUSLY SURVEYED DURING C.S. 55/14. SEARCH IN THE FIELD RECOVERED ALL OF THE MONUMENTS AROUND SAID SURVEY EXCEPT THE NORTHWEST AND NORTHEAST CORNERS OF LOT 5 AND I HELD THEM AS FOUND. AT THE NORTHWEST CORNER OF LOT 5 THE IRON PIPE WAS MISSING BUT A HOLE IN THE CONCRETE SIDEWALK WAS STILL THERE FROM WHERE THE PIPE WAS REMOVED. I RESET THE CORNER IN THE FOUND HOLE LOCATION. THE NORTHEAST CORNER OF LOT 5 WAS SET AT SINGLE PROPORTIONATE POSITION AT RECORD PLAT DIMENSIONS HOLDING SAID NORTHWEST CORNER OF LOT 5 AND THE FOUND IRON PIPE SET DURING C.S. 55/14 AT THE MID POINT OF LOT 4. THIS SURVEY WAS PERFORMED USING A TRIMBLE R8 GPS SYSTEM IN RTK MODE.



REGISTERED  
PROFESSIONAL  
LAND SURVEYOR

*Todd R. Catterson*

10/29/13 OREGON  
JAN. 15, 2002  
TODD R. CATTERSON  
53270

RENEWS 12/31/13

**ARMSTRONG**  
surveying & engineering, inc.  
established 1977

SHEET 1 OF 1  
DRG. NO. 13-4420CANYONVILLE.DWG  
W.O. 13-4420

MAP FILE M 165-76

MAP FILE M 165-76