

MAGNETIC DECLINATION 15°45' E

WILLIAMS FIRE REHAB
RECORD OF SURVEY FOR THE
UMPQUA NATIONAL FOREST
IN THE SE 1/4 OF SECTION 30
T.25 S., R.1 W., W.M.
DOUGLAS COUNTY, OREGON
JUNE 13, 2011

FILED
Date: 7-14-2011 By: JC
This survey consists of:
Map: M 162-51
Narrative:
Corner Rpt:

DOUGLAS COUNTY
SURVEYOR

MAP FILE M162-51

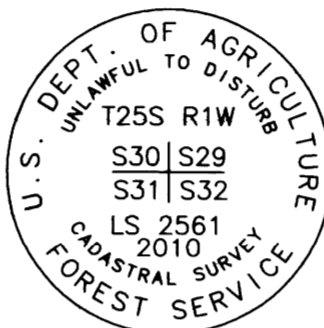
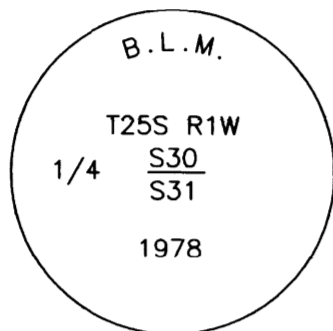

PRIVATE

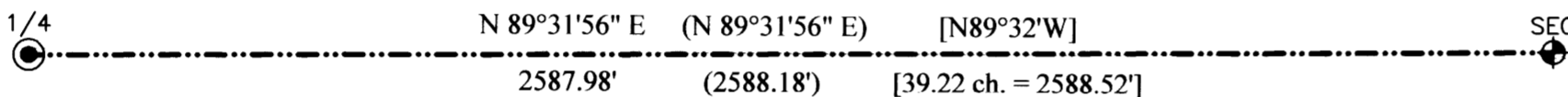

QUARTER CORNER S30 AND S31:

Found the B.L.M. Brass Cap stamped as shown, cemented in drill hole in rock outcrop, from which: [] = 1981 BLM Record
A 22" Fir bears [S55°E, 72.6 FT.], Healed Blaze.
A 26" Fir bears [N62°E, 69.3 FT.], Healed Blaze.

NATIONAL FOREST SYSTEM LANDS

SECTION CORNER S30, 31, 32, AND 29:

Set 3" Brass Cap on 2 1/2"x30" Galvanized Iron Pipe with flange, stamped as shown, projecting 3" above 2.5" dia. mound of stone painted red. Corner set from existing evidence; from which: [] = 1981 BLM Record
A 19" Fir Snag bears S48°W[S48°W], 66.2 FT.[66.66'], with Healed Double Blaze
A 21" Fir Snag bears S14°45'E[S15 1/2°E], 50.9 FT.[50.82'], with Healed Double Blaze
A 20" Fir bears N16°45'W[N15°W], 13.0 FT.[13.2'], with Healed Double Blaze
A 15" Fir bears N67°30'E [N67 1/2°E], 24.2 FT [24.75'], with Healed Double Blaze
Marked New BT's
A 21" Fir bears S59°W, 79.2 FT. scribed "T25SR1WS31""BT" on Double Blaze, with Brass Washer "LS2561" nailed to face on lower blaze between B&T
A 21" Fir bears S50°E, 13.4 FT. scribed "T25SR1WS32""BT" on Double Blaze, with Brass Washer "LS2561" nailed to face on lower blaze between B&T

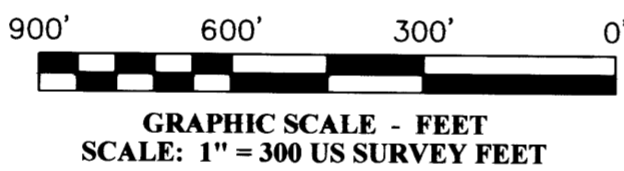

LEGEND:

- Posted Property Line
- Found Monument
- ⊕ Remonumented Corner
- () Record Per CSF M70-70
- [] Record Per 1981 BLM, J.E. Jelley

PURPOSE

The purpose of this survey was to determine and mark a portion Umpqua National Forest Boundary adjacent to private lands in an effort to perpetuate the boundary after recent fire activity.

HISTORY

1900 - Hezekiah H. Johnson, GLO contract #721, set the original corners in T25S R1W.
1956 - Hosford, LS 253, in CSF# M3-45, subdividing parts of Section 30 and tied the 1/4 corner found in this survey.
1962 - Milo E. Godfrey, County Surveyor, perpetuated the 1/4 corner between Sections 30 & 31
1978-1981 - James E. Jelley, BLM group 350 & 929, completes the subdivision of certain sections within T25S R1W, including remonumentation of corners found and/or remonumented in this survey.
1979 - Larry J. Friar, RLS 961, in CSF# M70-70, marking National Forest boundaries in Section 30, holds the position of the BLM monuments.
Jan. 2011, John Ransom, RLS 2561, in C.S. File 65/212, remonumented the Section Corner.

PROCEDURES

The survey was performed with Leica 1203+ total station.
The Section corner was remonumented from the existing bearing objects found. Measurements were made between the two depicted corner positions as part of an open loop. The true line was then marked with 6 foot aluminum posts with Property Boundary signs set on-line, brush was removed from line and trees blazed near true line per US Forest Service Standards.
The BLM monument for the section corner could not be found as recent fire activity may have resulted in corner being plowed out to use area as turn out. The remonumented position falls in center of newly created turn out on North side of Forest Road# 4705-500.

The Basis of Bearing for this survey is from CSF# M70-70, or N 89°31'56"E between corners depicted. Measurements to the BT's at section corner are side-center, record measurements used for quarter corner BT's with new diameters. Pipe diameters are measured outside diameter.

All computations and field notes are on file at the Willamette National Forest Supervisors Office, Springfield, OR.

I, John C. Ransom, a Registered Land Surveyor in the State of Oregon, hereby certify that this plat and the notes hereon are a true and correct representation of a survey I performed in September 2010, at the request of the USDA Forest Service, in accordance with the statutes of the State of Oregon and the BLM Manual of Surveying Instructions, 2009.

John Ransom
John C. Ransom, PLS
3106 Pierce Parkway, Suite D
Springfield, OR 97477

REVIEWED BY
MIME SCHWARTZ 7-13-11
SIGNATURE DATE
I CERTIFY THAT THIS SURVEY WAS PERFORMED AT THE REQUEST OF THE UMPQUA NATIONAL FOREST SUPERVISOR
John C. Ransom 7/14/2011
SIGNATURE DATE
ACTING

REGISTERED PROFESSIONAL LAND SURVEYOR
John Ransom
OREGON
REV. 11, 1998
JOHN C. RANSOM
2561
Expires: 12/31/2012

PLOTTER: HP DESIGNJET 500
INK: BLACK C4844A
MEDIA: CONTINENTAL MILANO JPC-4M1
TAX LOT MAP NO.: 25-1-00-5300

MAP FILE M162-51