

RECORD OF SURVEY
 FOR: SENECA JONES TIMBER COMPANY
 ALL QUARTERS, SECTION 24, T.27S., R.3W., W.M.
 DOUGLAS COUNTY, OREGON
 27 APRIL 2011

FILED
 DATE 5/12/2011 BY: JC
 This survey consists of:
 Map: M/62-30
 Narrative:
 Corner Rpt:

DOUGLAS COUNTY
 SURVEYOR

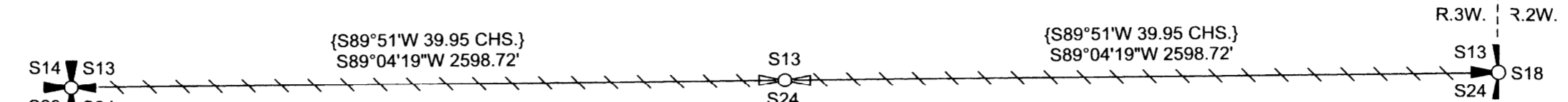
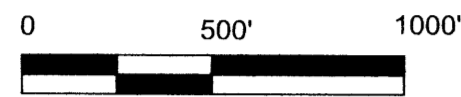
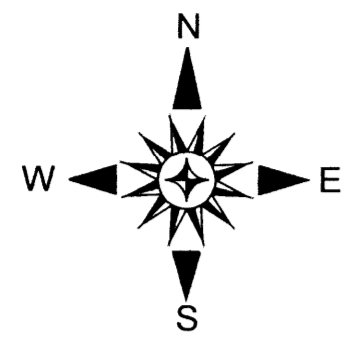

SECTION CORNER
 SECTIONS 13, 14, 23, 24
 FOUND 1969 DOUGLAS COUNTY BRASS CAP
 WITH THE FOLLOWING ACCESSORIES:
 42" D. FIR BEARS N45°E 4.0' - HEALED FACE
 18" D. FIR BEARS S49°E 38.3' - HEALED FACE
 19" X 4" LIVE D. FIR STUMP BEARS S83-1/2°W 26.7' - HEALED FACE
 34" D. FIR STUMP BEARS S35°E 32.7' - BARK SCRIBING VISIBLE
 20" X 4" D. FIR STUMP BEARS N20°W 28.4' - HEALED FACE

1/4 CORNER
 SECTIONS 13, 24
 SET 5/8" X 5" REBAR IN DRILLED ROCK WITH 2-1/2"
 ALUMINUM CAP, MARKED AS SHOWN, WITH
 THE FOLLOWING ACCESSORIES:
 18" D. FIR BEARS S50°E 39.0' - BLAZED, SCRIBED "1/4 S24 BT"
 18" D. FIR BEARS S3°W 38.2' - BLAZED, SCRIBED "1/4 S24 BT"
 11" D. FIR BEARS N89°W 15.0' - BLAZED, SCRIBED "1/4 S13 BT"
 SET 3/8" X 1-1/2" MAG PK NAIL IN DRILLED VERTICAL ROCK
 BEARING N54°W 22.12'

SECTION CORNER
 SECTIONS 13, 24 ONLY
 FOUND 1966 DOUGLAS COUNTY BRASS CAP
 WITH THE FOLLOWING ACCESSORIES:
 18" W. FIR BEARS S69-3/4°W 6.3' - HEALED FACE
 12" W. FIR BEARS N66-1/2°W 15.9' - HEALED FACE
 38" D. FIR STUMP BEARS S38°E 19.1' - ROTTED FACE

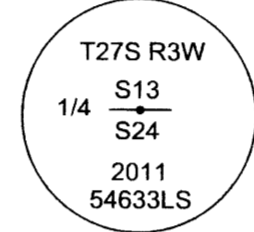

N1/16 CORNER
 SECTIONS 23, 24
 FOUND 1985 BLM BRASS CAP WITH
 THE FOLLOWING ACCESSORIES:
 19" D. FIR BEARS S77°W 27.4' - HEALED FACE
 13" MADRONE BEARS S45°E 20.8' - HEALED FACE

1/4 CORNER
 SECTIONS 23, 24
 FOUND 1947 DOUGLAS COUNTY BRASS CAP
 WITH THE FOLLOWING ACCESSORIES:
 20" D. FIR BEARS N13°W 9.2' - HEALED FACE
 15" D. FIR BEARS N45°W 18.8' - HEALED FACE
 10" D. FIR BEARS S27°E 20.5' - HEALED FACE
 36" D. FIR SNAG BEARS N43°E 18.5' - HEALED FACE
 22" W. RED CEDAR STAUB BEARS N78°W 16.5' - HEALED FACE

SECTION CORNER
 SECTIONS 23, 24, 25, 26
 FOUND 1947 DOUGLAS COUNTY BRASS CAP
 WITH THE FOLLOWING ACCESSORIES:
 35" D. FIR BEARS S12°E 53.8' - HEALED FACE
 19" HEMLOCK BEARS S41-1/4°W 65.3' - HEALED FACE
 13" HEMLOCK BEARS N84°W 15.2' - HEALED FACE
 48" D. FIR STUMP BEARS N12-3/4°E 75.9' - ROTTED FACE
 NEW BT THIS SURVEY:
 10" D. FIR BEARS N85°E 46.6' - BLAZED,
 SCRIBED "T27S R3W S24 BT"

1/4 CORNER
 SECTIONS 24, 25
 FOUND 1970 DOUGLAS COUNTY BRASS CAP
 WITH THE FOLLOWING ACCESSORIES:
 15" W. RED CEDAR BEARS N67°W 14.8' - HEALED FACE
 (RECORD 9" W. RED CEDAR S22°W 20.9' - DOWN)
 (RECORD 60" D. FIR SNAG S20°E 23.1' - DOWN)
 NEW BT THIS SURVEY:
 38" W. RED CEDAR BEARS S68°E 18.6' - BLAZED,
 SCRIBED "1/4 S25 BT"

SECTION CORNER
 SECTIONS 24, 25 ONLY
 FOUND 1969 DOUGLAS COUNTY BRASS CAP
 WITH THE FOLLOWING ACCESSORIES:
 51" D. FIR BEARS S65°E 29.0' - NO MARKS VISIBLE
 25" D. FIR BEARS S8°W 2.0' - HEALED FACE
 15" W. RED CEDAR BEARS N71°W 51.1' - HEALED FACE
 11" HEMLOCK BEARS N82°E 33.4' - HEALED FACE
 9" HEMLOCK BEARS N24-1/4°W 31.8' - SCRIBING VISIBLE

BASIS OF BEARING
 (S0°23'W 41.10 CHS.)
 (S0°23'00"W 2713.27')

(S0°33'W 20.87 CHS.)
 (S0°33'08"W 1377.24')

(S0°33'W 20.87 CHS.)
 (S0°35'22"W 1377.50')

(S0°23'W 41.10 CHS.)
 (S0°23'00"W 2713.27')

S23 S24
 S26 S25

S24 S25

S24 S19
 S25

NARRATIVE:
 THE PURPOSE OF THIS SURVEY WAS TO MARK THE LINES SHOWN AS POSTED ON THIS RECORD OF SURVEY.
 EXISTING CORNERS WERE TIED BY GROUND TRAVERSE FOR CONTROL AND HELD IN THEIR AS-TIED POSITIONS FOR THE POSTING OF TRUE LINE.
 AT THE 1/4 CORNER OF SECTIONS 13 AND 24, A THOROUGH SEARCH WAS PERFORMED FOR EVIDENCE OF THE 1882 GLO WITNESS CORNER. WITH NO EVIDENCE FOUND, I THEN SET THE TRUE 1/4 CORNER, AS DESCRIBED, AT PROPORTIONATE DISTANCE BETWEEN AS-TIED SECTION CORNERS.
 BETWEEN THE NORTHWEST CORNER OF SECTION 24 AND THE N1/16 CORNER OF SECTIONS 23 AND 24, TREES WERE BLAZED ON THE EAST SIDE OF LINE ONLY, AS I WAS UNSUCCESSFUL IN CONTACTING THE ADJACENT LAND OWNER IN SECTION 23.
 THE BASIS OF BEARING FOR THIS SURVEY WAS THE 1985 BLM DEPENDENT RESURVEY RECORD FOR THE LINE BETWEEN THE SOUTHWEST CORNER OF SECTION 24 AND THE WEST 1/4 CORNER OF SECTION 24, TOWNSHIP 27 SOUTH, RANGE 3 WEST, WILLAMETTE MERIDIAN.
 THIS SURVEY WAS PERFORMED USING A NIKON TOTAL STATION.

LEGEND

	FOUND SECTION CORNER AS NOTED
	FOUND 1/4 CORNER AS NOTED
	FOUND 1/16 CORNER AS NOTED
	SET 1/4 CORNER AS NOTED
	FOUND SECTION CORNER COMMON TO 2 SECTIONS ONLY AS NOTED
	PROPERTY LINE MARKED WITH RED PAINTED BLAZES, RED FLAGGING, AND 5-1/2" GALVANIZED STEEL POSTS SET AT 200' +/- INTERVALS
	PROPERTY LINE MARKED WITH RED PAINTED BLAZES ON EAST SIDE OF LINE ONLY, RED FLAGGING, AND 5-1/2" GALVANIZED STEEL POSTS SET AT 200' +/- INTERVALS
()	RECORD DATA - 1985 BLM DEPENDENT RESURVEY
{ }	RECORD DATA - 1882 GLO SURVEY
BLM	BUREAU OF LAND MANAGEMENT
GLO	GENERAL LAND OFFICE

REGISTERED PROFESSIONAL LAND SURVEYOR
Ronald L. Rice
 OREGON
 JULY 9, 2002
 RONALD L. RICE
 54633LS

Ward NorthWest, Inc.
 Land Surveying & Planning
 1732 Laurel PL. Suite A
 Florence, OR 97439
 541-997-9201

FILE NAME		
10-66 TRV		
SCALE	DATE	DRAWN BY
500 Ft/in	4-27-2011	JR
JOB	REVISION	SHEET
EVARTS	----	1/1

This map drawn with TRAVERSE PC Software

EXPIRATION DATE: 12-31-2012

MAP FILE M/62-30

MAP FILE M/62-30