

MAP FILE M155-62

FILED  
Date: 5-12-2008 By: JC  
This survey consists of:  
Map: M155-62  
Narrative:  
Corner Plat:  
DOUGLAS COUNTY SURVEYOR

# ADJUSTMENT OF COMMON BOUNDARY LINE SURVEY

DOUGLAS COUNTY PLANNING DEPARTMENT FILE NUMBER 07-M092.

Located in the:  
S.W. 1/4 of S.W. 1/4 of SECTION 5,  
TOWNSHIP 30 SOUTH RANGE 5 WEST,  
WILLAMETTE MERIDIAN, DOUGLAS COUNTY, OREGON

OWNER OF UNITS 1 & 2:  
SONDRA (ERBE) APPEL  
388 BARTLETT LANE  
GRANTS PASS, OR. 97527

ZONING:  
C-3 GENERAL COMMERCIAL  
COMPREHENSIVE PLAN DESIGNATION:  
CG GENERAL COMMERCIAL

PREPARED BY:  
RAYMOND F. BROWN - P.L.S. # 2391  
P. O. BOX 539  
CANYONVILLE, OREGON 97417  
Phone: (541) 839 - 6185

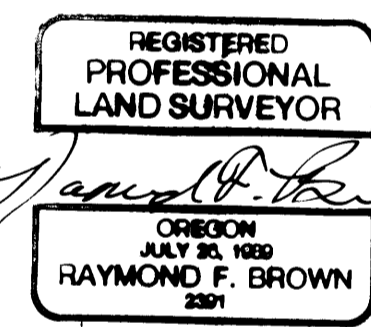

EXP. 12/31/09

APPROVALS:

*Keith L. Cubic*  
DOUGLAS COUNTY PLANNING DEPARTMENT  
DIRECTOR

5/9/08  
DATE

NARRATIVE:

PURPOSE OF THE SURVEY WAS TO CREATE THE BOUNDARY LINE ADJUSTMENT AS SHOWN. FIELD INVESTIGATION LOCATED THE SAID FOUND MONUMENTS AND CONDITIONS. A RE-TRACEMENT OF SURVEY FILE NUMBER M 144-66, WITH SUPPORT FROM SURVEY FILE NUMBER M 106-37, CONTROLLED THE SURVEY. THE ADJUSTED BOUNDARY WAS CONTROLLED BY A 20 FOOT MINIMUM SETBACK FOR ALL COMMERCIAL STRUCTURES, WHICH WOULD RELEASE ANY FIREWALL /SAFETY REQUIREMENT BY STATE BUILDING CODES.

MARCH, 2008  
SCALE: 1" = 20'



LINE INDEX:

- (A) N 26° 29' 11" E 5.55'
- (B) N 26° 52' 04" E 26.48'
- (C) N 30° 52' 32" W 11.97'

LEGEND:

- FD. 5/8" IRON ROD PER M 144-66.
- ⊙ FD. 5/8" IRON ROD PER M 106-37.
- SET 5/8" X 30" IRON ROD WITH PLASTIC CAP ATTACHED, MKD. " R. BROWN, PLS 2391 "
- ( ) - 1 RECORD AS PER M 144- 66.
- ( ) - 2 RECORD AS PER M 106-37.
- ( ) - 3 RECORD AS PER VOL. 10, PAGE 23.

FOR LEGAL OF ADJUSTMENTS AND COVENANTS, IF ANY, SEE DEED REFERENCE NUMBER 2008-008459

MAP FILE M155-62