

FILED

Date: 3-12-2008 By: J
This survey consists of:
Map: M155-17
Narrative: _____
Corner Rpt: _____

BOUNDARY SURVEY

LOCATED IN THE NORTHEAST QUARTER OF SECTION 24,
TOWNSHIP 31 SOUTH, RANGE 9 WEST, W.M.
DOUGLAS COUNTY, OREGON

DOUGLAS COUNTY
SURVEYOR

MAP FILE M155-17

SURVEY FOR: PLUM CREEK TIMBERLANDS, LP
DATE OF SURVEY: DECEMBER 2007

FND. BLM BCIP
PER VOL.31 PG.13184

BEARING TREES FOUND
59" FIR STUMP BRS N30°E 40.5'
28" FIR BRS. N54°E 8.0'
27" FIR SNAG BRS. S52°E 26.6'
7" FIR BRS. S15°W 14.6'
23" FIR BRS. N88°W 66.2'

BASIS OF BEARING PER GLO
WEST
2652.02' (40.12 CH.)

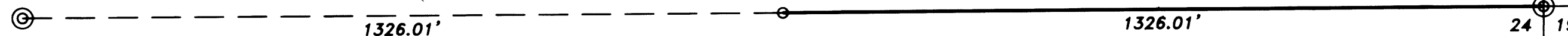

1/4 COR.
FND. BCIP PER CS54/32 LAYING ON ITS SIDE
RESET AT DISTANCE FROM FND. DOUGLAS COUNTY
SURVEYOR BT'S

E 1/16 COR.
SET 3/4"X36" I.ROD
W/3" ALUM. CAP

BEARING TREES FOUND
24" WHITE FIR BRS. N62°W 47.8' (N70°W 47.8')
36" WHITE FIR BRS. S12°E 49.5' (S21° 1/2 E 49.5')
36" D.FIR STUMP BRS. N58°E 51.7' (N50°E 52.8')

BEARING TREES MARKED
18" G.FIR BRS. S66°E 25.6'
12" D.FIR BRS. S46°W 14.0'



SCALE 1" = 200 Feet

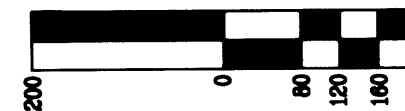

NARRATIVE
THE PURPOSE OF THIS SURVEY WAS TO MONUMENT THE EAST 1/16
CORNER BETWEEN SECTIONS 13 AND 24 AND TO LOCATE THE LINE
BETWEEN THE EAST 1/16 AND THE NORTHEAST CORNER OF
SECTION 24.
ASSISTING IN THIS SURVEY WAS DANNY DEAN.

BASIS OF BEARING
ASSUMED PER GLO SURVEY

REFERENCE SURVEYS
GLO SUBDIVISION OF T.31S R.9W BY W.BYARS, 1901

LEGEND

- SET MONUMENT AS NOTED
- ⊙ FND. MONUMENT AS NOTED
- LINE BLAZED/PAINTED RED
- () RECORD DIMENSION

REGISTERED
PROFESSIONAL
LAND SURVEYOR

Corey M. Woodruff
OREGON
July 12, 2005
Corey M. Woodruff
62978

EXPIRES 6/30/08

**Stuntzner Engineering
& Forestry, L.L.C.**

ENGINEERING • LAND SURVEYING • FORESTRY
PLANNING • WATER RIGHTS
705 South 4th St. Phone: (541) 267-2872
Post Office Box 118 Coos Bay, Oregon 97420 Fax: (541) 267-0688

Drawn By: Danny Dean	Date: February 2008
Checked By: Corey Woodruff	Drawing No.: 07-350
Designed By:	Revised:
Job Name: 07-350	Sheet 1 of 1

MAP FILE M155-17