

PROPERTY SURVEY
SECTION 28, T26S, R2W, W.M.
DOUGLAS COUNTY, OREGON
DECEMBER 2005

SURVEY BY:
HOSTETTER LAND SURVEYING
63538 PINTAIL DR.
COOS BAY, OR 97420

SURVEY FOR:
SENECA JONES TIMBER COMPANY
PO BOX 2129
ROSEBURG, OREGON 97470

FILED
Date: 12-28-2005 By: JLP
This survey consists of:
Map: M 149-17
Narrative:
Corner Rpt:
DOUGLAS COUNTY
SURVEYOR

FOUND: FOUND 3/4" IRON ROD AND BOTH
BTS DESCRIBED BY TRACY IN 1967 (RENEWAL
#87, DOUGLAS COUNTY)
FROM WHICH:
22" FIR, FACE EVIDENT, TRACY BT, NEW TAG & SPIKE,
BEARS; N44°18'E, 17.6 FT TO SPIKE. (TRACY: N47°E, 18.7')
31" CEDAR, OBT, SCRIBING VISIBLE,
BEARS; S 14°E, 9.9 FT.
14" FIR, SCRIBED "S28 1/4 BT", NEW BT,
BEARS; S85°22'W, 26.1 FT TO SPIKE.
16" FIR, SCRIBED "S21 1/4 BT", NEW BT,
BEARS; N 26°36'W, 33.7 FT TO SPIKE.

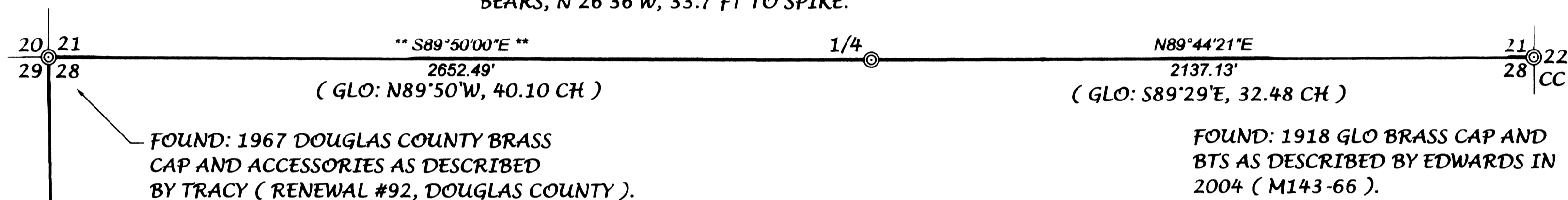

FOUND: 1967 DOUGLAS COUNTY BRASS
CAP AND ACCESSORIES AS DESCRIBED
BY TRACY (RENEWAL #92, DOUGLAS COUNTY).

FOUND: 1918 GLO BRASS CAP AND
BTS AS DESCRIBED BY EDWARDS IN
2004 (M143-66).

NARRATIVE:

THE PURPOSE OF THIS SURVEY WAS TO MARK PROPERTY LINES AS SHOWN.

A RANDOM TRAVERSE BETWEEN FOUND MONUMENTS WAS RUN WITH A NIKON
NPL- 820 TOTAL STATION. OFFSETS TO TRUE LINE WERE CALCULATED AND LINE
WAS MARKED WITH RED FLAGGING. BOTH SIDES OF LINE WERE BLAZED AND
PAINTED. 6 FT STEEL FENCE POSTS WERE PLACED ON LINE AT APPROXIMATE
180 FT INTERVALS.

BEARING TREE MEASUREMENTS TO ORIGINAL AND OTHER FOUND BTS ARE LISTED
TO THE CENTER OF THE TREE UNLESS OTHERWISE NOTED. BT TAGS PLACED ON TREES
MARKED IN THIS SURVEY, LIST BEARING AND DISTANCE FROM THE HEAD OF A
6" SPIKE, PLACED IN THE ROOT COLLAR, TO THE CORNER MONUMENT.

BEARINGS ARE BASED ON THE GLO RECORD FROM THE NW CORNER TO THE N 1/4
CORNER AS SHOWN.

FOUND: 1967 DOUGLAS COUNTY BRASS
CAP AND ACCESSORIES AS DESCRIBED
BY TRACY (RENEWAL #83, DOUGLAS COUNTY).



** BASIS OF BEARING: GLO **



REGISTERED
PROFESSIONAL
LAND SURVEYOR
Tony Hostetter
OREGON
TONY HOSTETTER
January 19, 1982
1975

EXPIRES: 6/30/07

MAP FILE M 149-17

MAP FILE M 149-17