

- LEGEND**
- FOUND BRASS CAP
  - FOUND IRON PIPE
  - SET 5/8" IRON ROD UNLESS OTHERWISE NOTED
  - SET 5/8"x30" IRON ROD w/CAP STAMPED "HIBBS-LS 52989"
  - △ CALCULATED POSITION
  - ( ) RECORD PER M143-42
  - [ ] RECORD PER LAND PARTITION 1993-0012
  - <-> RECORD PER M62-43
  - ( ) RECORD CS 3645
  - [ ] RECORD CS 51274-2
  - ( ) RECORD PER M39-26

**FIELD CREW:** NEIL & ERIC HIBBS, WAYNE ROGERS, & SCOTT THOMPSON  
**EQUIPMENT:** NIKON DTM-522 TOTAL STATION  
**OFFICE:** NEIL HIBBS

**NOTE:** POINT "A" IS PLSS #300300, T28S, R6W, W.M.

**FROM POINT "A":**  
 POINT "B" BEARS S0°32'35"W 1549.10' (S0°50'W 1549.1)  
 POINT "C" BEARS S21°22'59"E 1659.40' (S21°04'35"E 1659.21)  
 POINT "D" BEARS S42°25'40"E 1511.65' (S42°07'33"E 1511.55)  
 POINT "E" BEARS S9°29'11"E 1140.36' (S9°10'58"E 1140.32)  
 POINT "F" BEARS N73°17'28"E 1109.63' (N73°35'47"E 1109.63)

**NARRATIVE:**  
 THE PURPOSE OF THIS SURVEY WAS TO MARK A PORTION OF THE BOUNDARY BETWEEN THE BURKS AND MAC GREGOR PROPERTIES AND THAT OF THE COW CREEK BAND OF UMPQUA TRIBE OF INDIANS. THIS PROPERTY IS FARM LAND ON WHICH THERE HAVE BEEN NUMEROUS SURVEYS OVER THE YEARS. EXTENSIVE SEARCHES FAILED TO RECOVER A NUMBER OF THE MONUMENTS THAT HAD BEEN SET AT ONE TIME OR ANOTHER. LARGE QUANTITIES OF METAL WERE UNCOVERED IN THE PROCESS BUT ACTUAL MONUMENTS WERE FEW AND FAR BETWEEN. SOME OF THE RELATIONSHIPS BETWEEN FOUND MONUMENTS FIT VERY WELL WHILE OTHERS DID NOT FIT VERY WELL AT ALL. WHEN ATTEMPTING TO COMBINE THE DIFFERENT SURVEYS AND DEEDS, THERE ARE NUMEROUS DISCREPANCIES. THIS SURVEY WAS AN ATTEMPT TO FIT THE ELEMENTS OF THE DIFFERENT PROPERTIES TO CONDITIONS ON THE GROUND AS WELL AS POSSIBLE. IT IS RECOMMENDED THAT THE THREE PARTIES INVOLVED FILE A BOUNDARY LINE AGREEMENT WHICH HOLDS THE LINES MARKED PER THIS SURVEY TO ELIMINATE THE DISCREPANCIES THAT EXIST OTHERWISE.

POINT "B" WAS SET AT DISTANCE / DISTANCE INTERSECTION FROM POINTS "G" AND "H" PER M143-42. POINT "K" WAS SET AT DISTANCE / DISTANCE INTERSECTION FROM POINTS "E" AND "B" PER LAND PARTITION 1993-0012. COMPUTED THE SURVEY FILED AS CS 3645, BEGINNING AT POINT "A", HEADING NORTHERLY TO POINT "L", AND THEN FROM THERE, CREATING SEVERAL DIFFERENT TRAVERSES TO TRY AND CLOSE ALL ELEMENTS BACK AROUND TO THE POINT OF BEGINNING. THERE ARE NUMEROUS PROBLEMS IN THIS SURVEY WHICH PREVENTED GETTING ANY OF THE TRAVERSES FROM CLOSING BACK INTO THEMSELVES. COMPUTED POINT "J" AT RECORD DISTANCE FROM POINT "B" PER LAND PARTITION 1993-0012. ON LINE BETWEEN POINTS "B" AND "J", COMPUTED SURVEY FILED AS CS 51274-2, BEGINNING AT POINT "J" AND RUNNING COUNTER-CLOCKWISE, ROTATING AROUND POINT "J", TO BRING THE ALIGNMENT OF THE EASTERLY BOUNDARY OF THIS SURVEY INTO ALIGNMENT WITH LINE "J-M" AS CALCULATED PER CS 3645. THIS CAUSED THE NORTHWEST CORNER OF THE AREA SHOWN IN CS 51274-2 AND THE LINE HEADING SOUTHERLY FROM IT TO FALL SUBSTANTIALLY TO THE WEST OF THE EXISTING BREAK IN USE WHICH INCLUDES A LARGE UNDERGROUND IRRIGATION LINE. LOOKED TO THE MONUMENTS FOUND PER THE SURVEY FILED AS M62-43 FOR ANOTHER SOLUTION TO THIS PORTION OF THE BOUNDARY. POINT "N" WAS SET AT DISTANCE / DISTANCE INTERSECTION FROM POINTS "S" AND "I" PER M62-43, ROTATED PREVIOUSLY CALCULATED CS 51274-2, CLOCKWISE TO BRING THE NORTHWEST CORNER BACK INTO ALIGNMENT WITH AN EXTENSION OF LINE "I-N". THIS ALIGNMENT FITS THE ALIGNMENT OF THE EXISTING IRRIGATION LINE QUITE WELL. THE NORTHERLY BOUNDARY OF THE AREA ENCOMPASSED IN CS 51274-2 WAS HELD TO THIS LAST ALIGNMENT, RUNNING EASTERLY FROM THE NORTHWEST CORNER THEREOF WITH THE LAST COURSE BEING SHORTENED TO INTERSECT PREVIOUSLY CALCULATED LINE "M-Z", POINT "O" BEING SET AT THIS POINT. POINT "Q" AND "P" WERE CALCULATED AT RECORD DISTANCES FROM POINT "J" PER LAND PARTITION 1993-0012. ON LINE "J-M". POINT "R" WAS CALCULATED AT DISTANCE / DISTANCE RECORD FROM POINTS "E" AND "Q" PER LAND PARTITION 1993-0012. THE ENTIRE PROJECT WAS THEN ROTATED AROUND POINT "A", USING CS 3645 AS A BASE OF BEARING FOR LINE "A-K". THE AREA ENCOMPASSED BY SURVEY M39-26 WAS CALCULATED, HOLDING POINT "L" AS THE NORTHWEST CORNER THEREOF. THE CALCULATED SURVEY WAS THEN ROTATED AROUND POINT "L", BRINGING THE WESTERN LINE TO THE ALIGNMENT OF LINE "K-L". POINTS "T" AND "U" WERE SET AT CORRESPONDING BREAKS IN THIS ROTATED ALIGNMENT OF M39-26. MONUMENTS "V" AND "W" WERE SET ON LINE "E-U". MONUMENT "X" AND "XX" WERE SET ON EXTENSION OF LINE "A-L" PER CS 3645. POINT "Y" WAS SET ON LINE "O-Z".

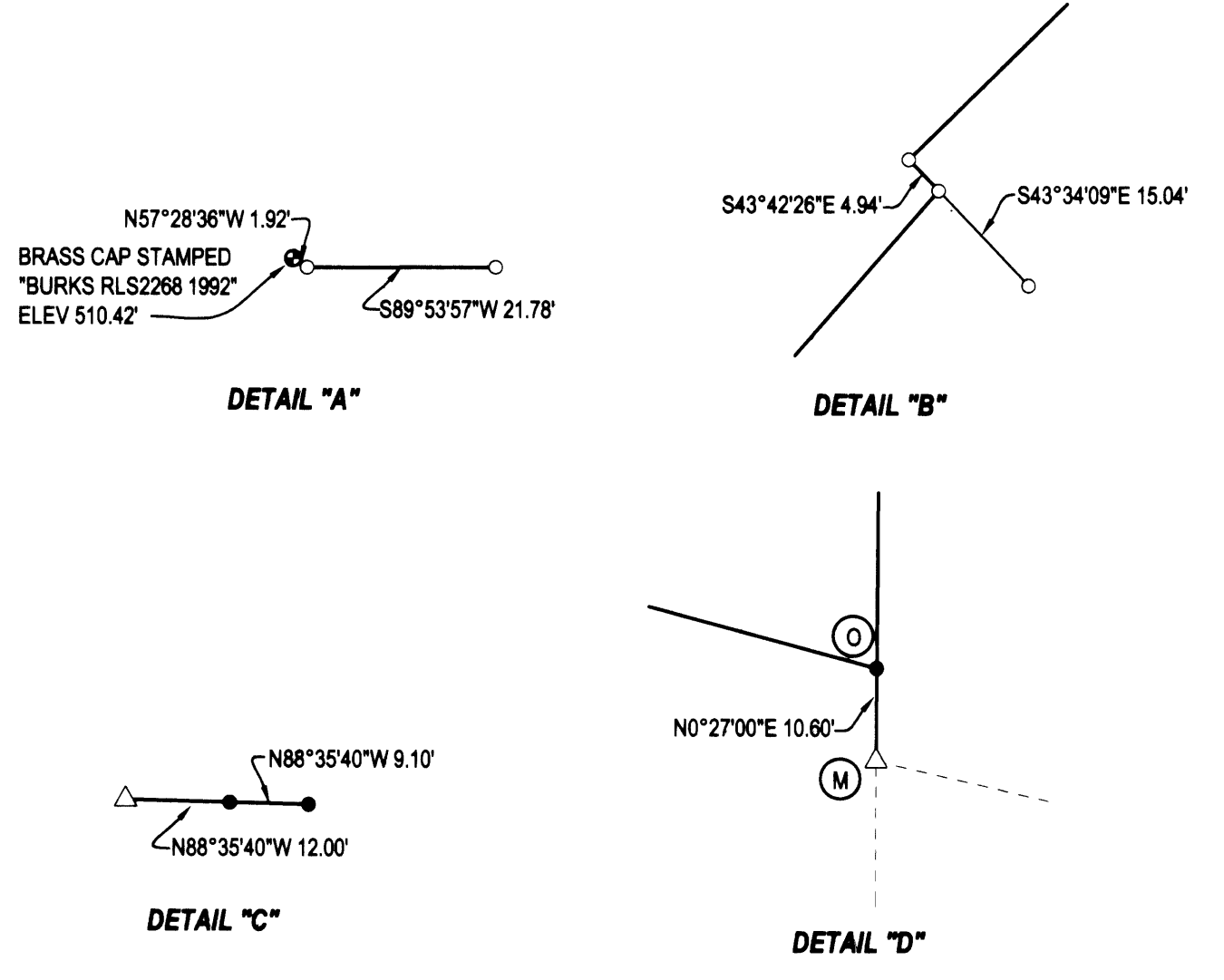

<p><b>SURVEY</b>                  T28S, R6W, W.M.                  LYING IN THE SE 1/4 SEC. 20, SW 1/4 SEC. 21, NW 1/4 SEC. 28 &amp; THE NE 1/4 SEC. 29                  WILLAMETTE MERIDIAN, DOUGLAS COUNTY, OREGON</p>		<p>REGISTERED                  PROFESSIONAL                  LAND SURVEYOR</p> <p>OREGON                  JANUARY 12, 1989                  F. NEIL HIBBS                  52989                  EXPIRATION DATE                  6/30/2009</p>
<p><b>CLIENT:</b>                  MICHAEL BURKS AND JILL MACGREGOR                  P.O. BOX 304                  DILLARD, OREGON 97470</p>	<p><b>SURVEYOR:</b>                    LAND SURVEYING, INC.                  1730 LOCKINGBASS ROAD                  ROSEBURG, OREGON 97470                  phone (541) 957-9303                  fax (541) 957-6306                  email: neilhibbs@wiolua.com</p>	
<p>DWG. SCALE: 1" = 200'</p>		<p>DATE: APRIL 2008</p>
<p>JOB #: 0453-01</p>		<p>PAGE: 1 OF 1</p>