

NE 1/4 SEC. 13, T. 26 S., R. 6 W., W.M. (11851-3)  
 SE 1/4 SEC. 25, T. 26 S., R. 6 W., W.M. (11851-2)  
 SE 1/4 SEC. 1, T. 27 S., R. 6 W., W.M. (ROSE CBL 1440)

NE 1/4 SEC. 24, T. 26 S., R. 6 W., W.M. (AKIN 2)  
 NW 1/4 SEC. 36, T. 26 S., R. 6 W., W.M. (11851-1)

LOCATED IN DOUGLAS COUNTY, OREGON

**FILED**  
 Date: 2/6/2004 By: JP  
 This survey consists of: 4 sheets  
 Map: M 143-67 A  
 Narrative: \_\_\_\_\_  
 Corner Rpt: \_\_\_\_\_  
**DOUGLAS COUNTY SURVEYOR**

MAP FILE M143-67A

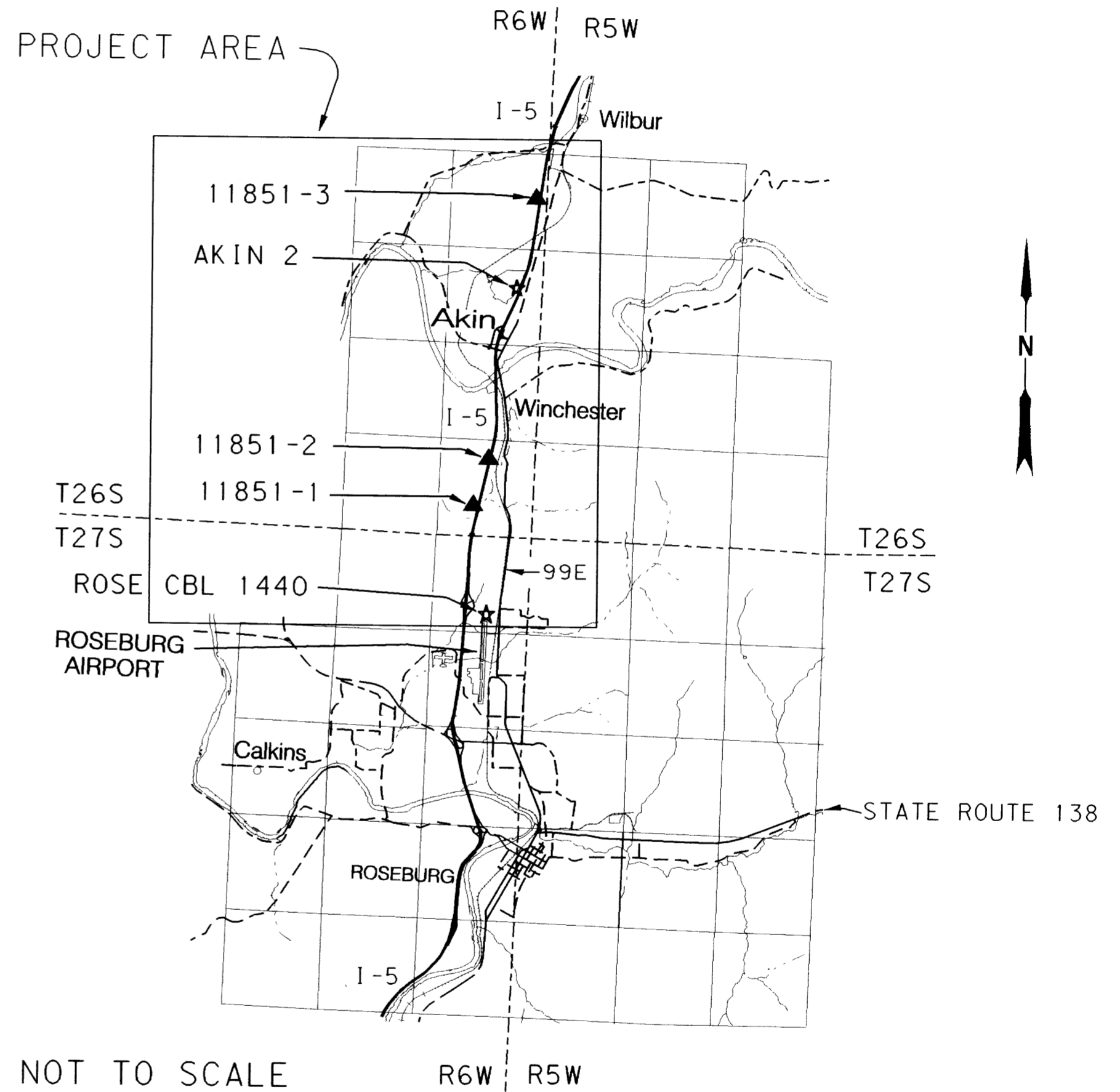
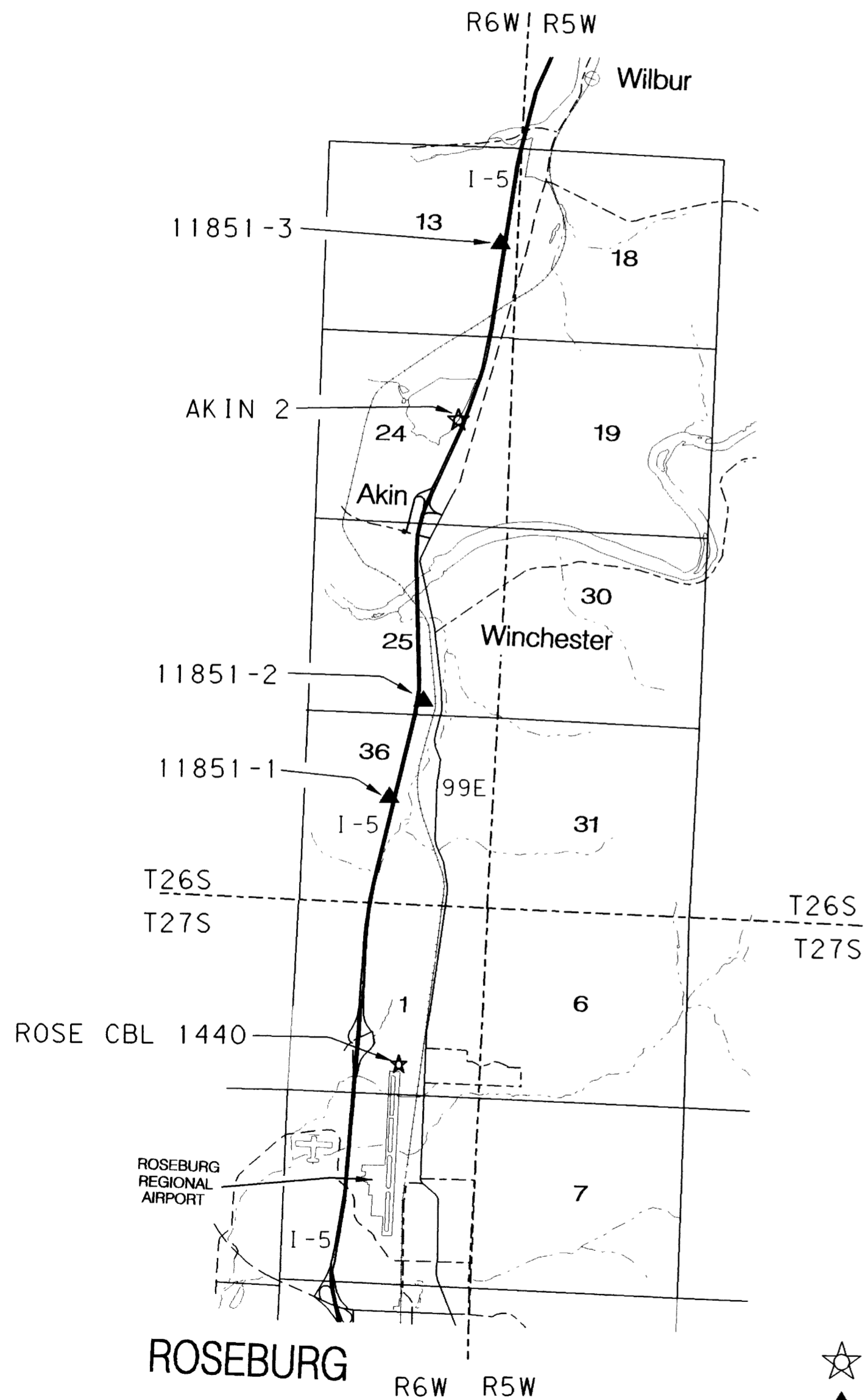

LEGEND

- ☆ FOUND GPS GEODETIC CONTROL STATION
- ▲ SET GEODETIC CONTROL STATION

REGISTERED PROFESSIONAL LAND SURVEYOR  
*J David Brinton*  
 OREGON DEPARTMENT OF TRANSPORTATION  
 DECEMBER 02, 1983  
 J DAVID BRINTON  
 2065  
 EXPIRES 12/31/2005

<b>METRIC SURVEY</b>		<b>OREGON DEPARTMENT OF TRANSPORTATION</b>	
		GEOMETRONICS UNIT 200 HAWTHORNE AVE. SE, # B-250 SALEM, OR 97301-5193 (503)986-3103; FAX (503)986-3548	
<b>GEODETIC SURVEY REPORT</b> N UMPQUA RIVER (OLD WINCHESTER) I-5 EXIT 129 WINCHESTER BRIDGE ALSO KNOWN AS PACIFIC HIGHWAY 001 GEOMETRONICS CONTROL FILE 03-011 FOR OREGON DEPARTMENT OF TRANSPORTATION REGION 3			
COUNTY : DOUGLAS	DRAWN BY: L POTTS	KEY #: 11851	SHEET OF
SURVEY DATE: 08-20-03		FILE NAME: 11851GPS.DGN	<b>1</b> <b>4</b>

NOT TO SCALE

NOT TO SCALE

MAP FILE M143-67A