

PROPERTY SURVEY FOR R.H. MAST AND MARK HOLLIDAY LOCATED IN SECTION 32 & 33 OF T20S, R10W, W.M. DOUGLAS COUNTY, OREGON

N1/16 S32 & S33 FD AND ACCEPTED HINTZ BC (M91-24) HALES BC FALLS UNDER LOG (M76-55) FD BT: 36" MAPLE W/ HEALED FACE AND TAG BEARS S67°W 9.4' TO SPIKE (M93-28)

FILED Date: 12/9/2003 By: JP This survey consists of: Map: M143-40 Narrative: Corner Rpt:

DOUGLAS COUNTY SURVEYOR

1/4 CORNER S32 & S33 FD RUSTY 1/2" IDIP (UNKNOWN RECORD) FD BTS: 40" ROTTED FIR STUB W/ VIS. SCRIBE BEARS N45°W 8.5' (ORIG.) 30" FIR WITH TAG AND HEALED FACE BEARS N8°W 24.0' (UNKNOWN)

S 1/16 S32 & S33 SET 3/4"X30" REBAR W/ 2" AL. CAP MKD BTS: 16" ALDER BS "S1/16 S32 BT" BEARS N76°W 12.4' 12" ALDER BS "S1/16 S33 BT" BEARS N76°E 10.9'

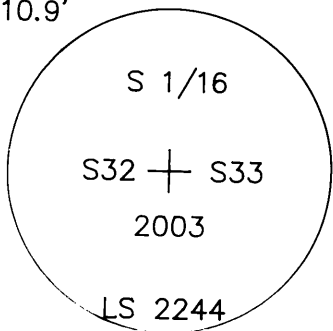

SECTION CORNER FD AND ACCEPTED DOUGLAS CO. BC (1982 DCSO) FD RUSTED OFF 2" IDIP (UNRECORDED GLO) FD PLOW SHEAR (UNKNOWN RECORD) FD BTS: 16" ALDER W/ BS AND TAG BEARS S63°W 4.7' (1926 DCSO & M91-24) 15" FIR SNAG 6' TALL BEARS N30°E 23.8' (1926 DCSO) 24" FIR W/ TAG AND HEALED FACE BEARS N2°E 83.8' (1982 DCSO) 8" FIR W/ TAG AND HEALED FACE BEARS S1°E 16.2' (1982 DCSO) 34" CEDAR W/ TAG AND HEALED FACE BEARS N71°W 32.9' (1982 DCSO)

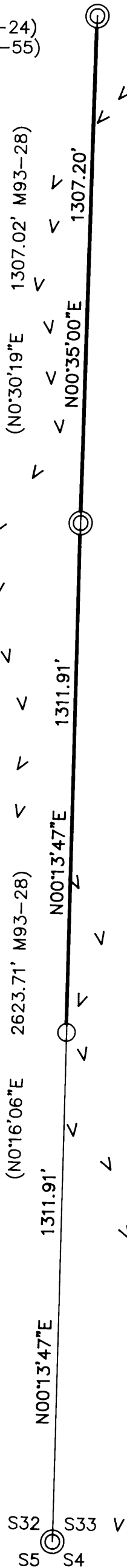

LEGEND table with symbols for FD corner, rebar, record information, blazed property line, ridge, DCSO, BS, BC and their descriptions.

NARRATIVE THE PURPOSE OF THIS SURVEY WAS TO SET THE S 1/16 CORNER AND MARK THE LINE BETWEEN THE S 1/16 AND THE N 1/16 FOR LOGGING. I FOUND AND ACCEPTED THE DCSO BC MARKING THE SECTION CORNER, THE 1/2" IDIP MARKING THE 1/4 CORNER AND THE BC SET BY HINTZ TO MARK THE N 1/16 CORNER. I THEN SET THE S 1/16 MID WAY BETWEEN THE SECTION CORNER AND THE 1/4 CORNER. I THEN BLAZED THE LINE BETWEEN THE S 1/16 AND THE N 1/16. EQUIPMENT USED WAS A TOPCON GTS 303 TOTAL STATION AND DATA COLLECTOR.

BASIS OF BEARINGS THE BASIS OF BEARINGS IS SOLAR AS PER SURVEY M93-28 (SECTION CORNER TO N1/16)

REFERENCE SURVEYS GLO SURVEY BY JOHN MELDRUM DATED DEC 12, 1867 M1-56 BY ROY GIBSON DATED JUNE 1956 M76-55 BY FORREST HALES DATED APRIL 1979 M93-28 BY RICHARD HINTZ DATED OCT 1982

BT NOTES BEARINGS TAKEN WITH COMPASS (DECL 18° E) TO CENTER OF ROOT BOLE. DISTANCES ARE TO A SPIKE AT SIDE CENTER.

REGISTERED PROFESSIONAL LAND SURVEYOR HARVEY WILCOX 2244 RENEWAL 6/30/04

DATE: 11/20/03 SCALE 1"=300'

HARVEY WILCOX SURVEYING 70442 HWY 101 NORTH BEND, OR 97459 PH: (541) 759-4467 FAX: (541) 759-4467 EMAIL: EASYBAR@GTE.NET