

RECORD OF SURVEY

NW 1/4, SECTION 15, T.26S., R.4W., W.M.

DOUGLAS COUNTY, OREGON

FILED
 Date: 6/23/2003 By: JP
 This survey consists of:
 Map: M142-42
 Name: _____
 Corner Rpt: _____

DOUGLAS COUNTY
 SURVEYOR

NORTH UMPQUA RIVER

FENCE CORNER FALLS
 N89°56'17"W, 1.12' OF
 PROPERTY LINE

LEGEND:

- ⊙ = SET 5/8" x 30" IRON ROD w/PLASTIC CAP MARKED "BTS ENG-SURV".
- = FOUND 3/4" IRON ROD PER M 12-37
- ⊙ = FOUND 5/8" IRON ROD PER M 24-66
- ⊙ = FOUND 1/2" IRON ROD PER M 71-34
- ◆ = FOUND 7/8" IRON ROD PER M 9-45
- ⊗ = FOUND 5/8" IRON ROD PER M 39-65
- △ = COMPUTED POINT
- = POSTED PROPERTY LINE WITH 6' STEEL POST
- () = RECORD PER M 71-34
- < > = RECORD PER M 12-37
- (()) = RECORD PER M 24-66

NARRATIVE:

THE PURPOSE OF THIS SURVEY WAS TO REMONUMENT MISSING PROPERTY CORNERS AND POST BOUNDARY LINES ON PARCEL 2, M 71-34. THE SURVEY WAS CONTROLLED BY MONUMENTS FOUND PER M 71-34, M 9-45, M 12-37, M 24-66 AND INST. NO. 98-03156. THE SOUTH LINE WAS CONTROLLED BY M 12-37 AND M 24-66. THE M 12-37 MONUMENT AT THE SW CORNER OF PARCEL 2 HAS BEEN DISTURBED AND IS NOW OUT OF POSITION. I REESTABLISHED THE SW CORNER OF PARCEL 2 AT THE INTERSECTION OF M 71-34 BEARING FROM THE FOUND M 12-37 MONUMENT AT THE NW CORNER OF PARCEL 2. A WELDED PIPE RAIL FENCE WAS FOUND TO ENCROACH ON EACH SIDE OF THE WEST LINE AS NOTED ON THE FACE OF THE MAP. THE EAST LINE WAS FOUND PER M 71-34. THE SE CORNER WAS REESTABLISHED AT THE INTERSECTION OF THE SOUTH AND EAST LINES OF M 71-34. I FOUND THE HUNTINGTON PROPERTY BUILDING & MISCELLANEOUS MATERIAL STORAGE AREA, THE CORNER OF A SHED AND LANDSCAPING IMPROVEMENTS TO ENCROACH OVER THE EAST LINE OF PARCEL 2 AS SHOWN ON THE FACE OF THE MAP.

THIS SURVEY WAS PERFORMED BY MATT DIXON AND MICKEY CALVERT USING A NIKON DTM 530 TOTAL STATION WITH COMPUTATIONS BY KRIS DEGROOT AND DRAFTING BY BILL WARREN.

NUMBER	DIRECTION	DISTANCE
L1	S 00°00'47" W	24.71'
L2	S 38°08'12" E	2.07'
L3	N 71°02'21" E	1.10'
L4	N 66°01'13" W	48.71'
L5	N 14°06'53" E	88.33'
L6	N 77°37'18" E	27.75'

(N 00°03'43" E 791.48')
 (S 00°03'43" W 791.14')
 < NORTH 791.31' >

FRANCES E. HUNTINGTON
 INST. NO. 98-00612
 PARCEL 2, M 71-34
 MLP BOOK 3, PAGE 215

LUCILLE M. BARKER TRUST
 INST. NO. 98-03156
 PARCEL 2, M 71-34
 MLP BOOK 3, PAGE 215

REGISTERED
 PROFESSIONAL
 LAND SURVEYOR

 OREGON
 JULY 17, 1981
 KRISTIAN O. DEGROOT
 1941

RENEWAL DATE: 12-31-03

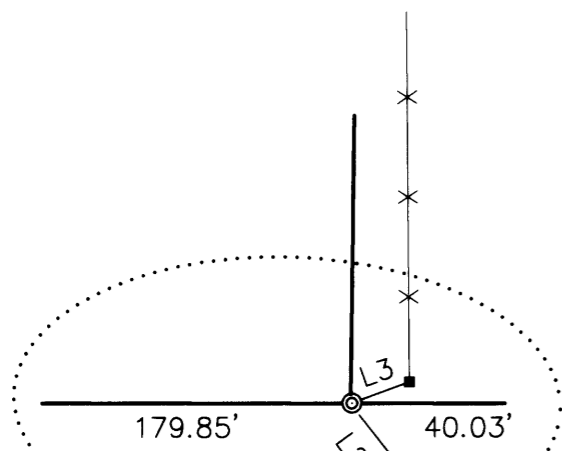

((179.72'))
 179.85' 40.03'

BASIS OF BEARINGS PER M 14-38
 N89°51'W, 219.89'

WHISTLERS LANE CO. RD. NO. 223

BTS ENGINEERING & SURVEYING, INC.
 431 S.E. MAIN ST., ROSEBURG, OR 97470
 PHONE (541) 673-0966 FAX (541) 673-0105

SCALE: 1" = 50'
 DATE: JUNE 11, 2003

FOR:
 LUCILLE BARKER
 1650 WHISTLERS LANE
 ROSEBURG, OR 97470

JOB #: 01-119
 FILE: BARKER1.DWG
 SHEET 1 OF 1