

# PROPERTY LINE SURVEY

FILED  
 Date: 9/27/2002 By: JP  
 This survey consists of:  
 Map: M140-80  
 Name: \_\_\_\_\_  
 Corner Rpt: \_\_\_\_\_  
 DOUGLAS COUNTY SURVEYOR

Located in the:  
 N. E. 1/4 of SECTION II,  
 TOWNSHIP 26 SOUTH, RANGE 3 WEST,  
 WILLAMETTE MERIDIAN, DOUGLAS COUNTY, OREGON

Prepared for:  
 ROBIN and TONY WILSON  
 23873 N. UMPQUA HWY.  
 P. O. BOX 157  
 IDLEYLD PARK, OR. 97447

Prepared by:  
 RAYMOND F. BROWN - P.L.S. 2391  
 P. O. BOX 539  
 CANYONVILLE, OR. 97417  
 Phone: ( 541 ) 839- 6185

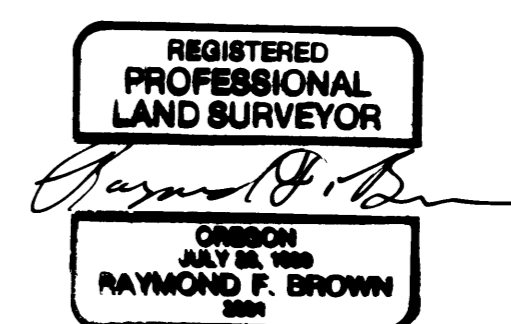

EXP. 12/31/03

### LEGEND:

- FD. 3/4" IRON ROD PER M 98-10, UNLESS OTHERWISE NOTED.
- SET 5/8" X 30" IRON ROD WITH PLASTIC CAP ATTACHED, MKD. " R. BROWN, PLS 2391 "
- ( ) - 1 RECORD AS PER M 98-10
- ( ) - 2 RECORD AS PER M 92-64.

### NARRATIVE:

PURPOSE OF THE SURVEY WAS TO VERIFY THE EASTERLY BOUNDARY OF THE IDLEYLD TRADING POST. FIELD INVESTIGATION LOCATED THE SAID FOUND MONUMENTS AND CONDITIONS. A RE-TRACEMENT OF SURVEY FILE NUMBER M 98-10, CONTROLLED THE SURVEY, WITH THE EXISTING TIE MADE TO THE NORTHEAST CORNER OF THE TIMBER RIVER CONDOMINIUMS, FROM THE SOUTHERLY RIGHT OF WAY OF THE NORTH UMPQUA HIGHWAY, AS DEFINED BY SAID M 98-10, USED AS " BASIS OF BEARING ".