

# LONE ROCK TIMBER CO.

PO BOX 1127 ROSEBURG OREGON 97470 DATE: JAN. 2002  
 SECTION 30, TOWNSHIP 32 SOUTH, RANGE 6 WEST, W.M. DOUGLAS COUNTY, OREGON  
 LONE ROCK TRACT: BECK TRACT SCALE 1" = 500'

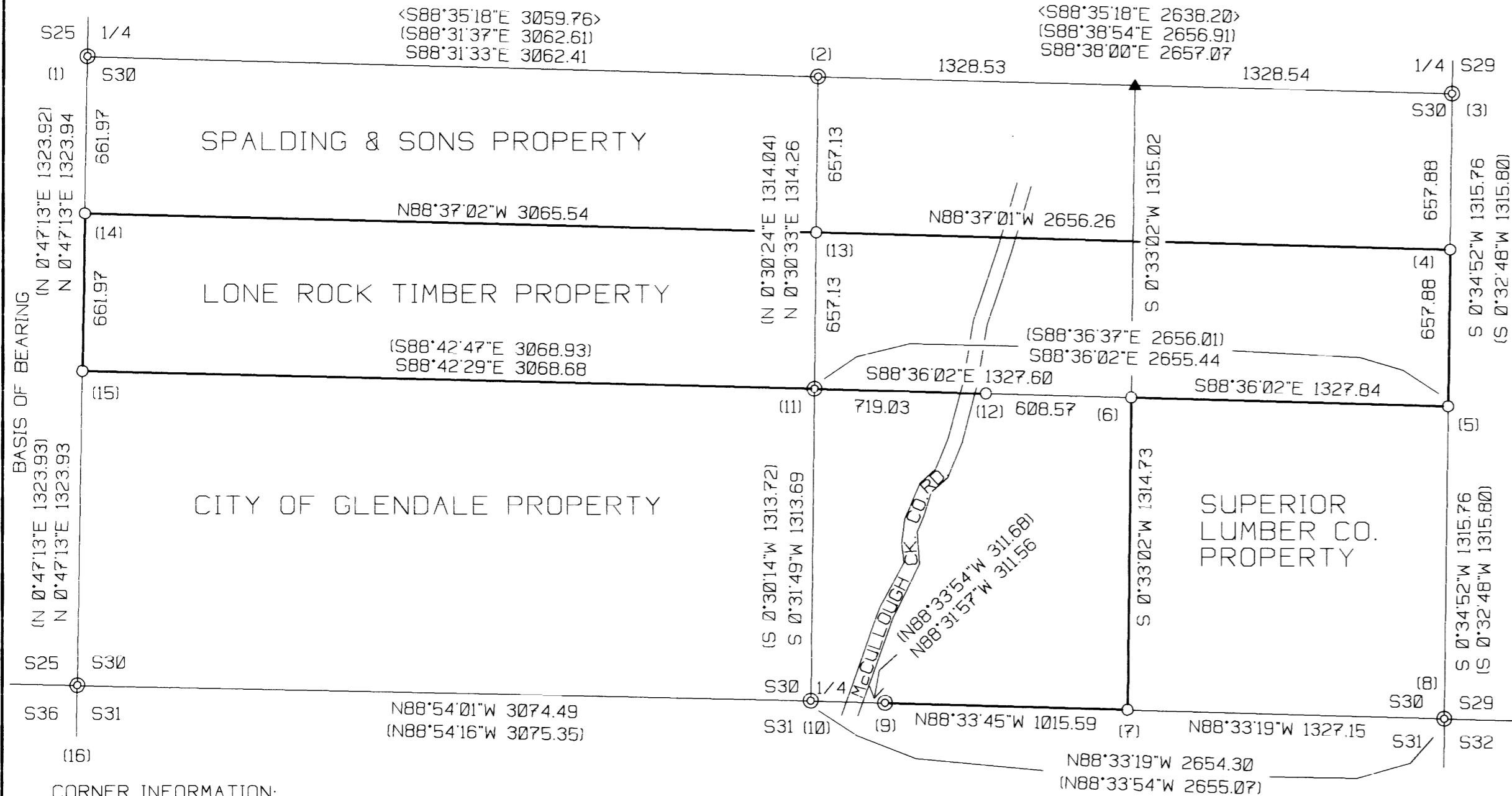
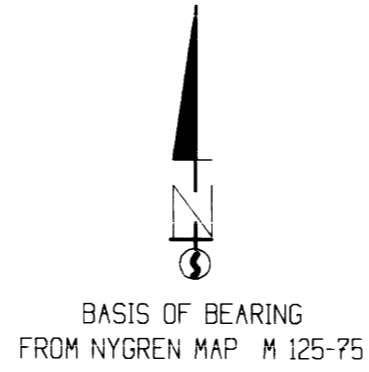

## NARRATIVE

THIS SURVEY WAS CONDUCTED TO ESTABLISH PROPERTY CORNERS AND PROPERTY LINES FOR TIMBER CUTTING PURPOSES. WE INITIATED THIS SURVEY AT THE WEST QUARTER OF SECTION 30 AN IRON PIPE SET FROM PERPETUATED ORIGINAL EVIDENCE BEGINNING A RANDOM TRAVERSE SOUTHERLY TO THE SOUTHWEST CORNER OF SECTION 30 A BLM BCIP SET FROM PERPETUATED ORIGINAL EVIDENCE. FROM A TRAVERSE POINT NEAR THE NORTHWEST CORNER OF LONE ROCK'S PROPERTY WE RAN A RANDOM CLOSED LOOP TRAVERSE AROUND THE PROPERTY CLOSING INTO OUR INITIAL TRAVERSE NEAR THE SOUTHWEST CORNER OF LONE ROCK'S TRACT. WE THEN RAN OPEN TRAVERSES TO THE SOUTH 1/4 (IRON ROD BY PROPORTION), SOUTHEAST CORNER (PIPE SET FROM ORIGINAL EVIDENCE), EAST 1/4 (IRON PIPE BY PROPORTION) AND THE CENTER OF SECTION 30. FROM TRAVERSE POINTS ON THE OPEN TRAVERSES WE THEN RAN GPS SESSIONS TO CHECK CLOSURE ON OUR OPEN TRAVERSES. FROM OUR CALCULATIONS WE SUBDIVIDED THE SOUTH HALF OF SECTION 30 SETTING THE ONE SIXTEENTH AND ONE-SIXTYFOURTH CORNERS AS SHOWN HEREON. WE ALSO SET AN IRON ROD ON THE EAST EDGE OF THE COUNTY ROAD RIGHT-OF-WAY ON LONE ROCK'S SOUTH PROPERTY LINE. THIS IRON ROD REFERENCES THE INTERIOR CORNER OF LONE ROCK'S PROPERTY, WHICH LIES APPROXIMATELY 16 FEET EAST IN THE MIDDLE OF MCCULLOUGH CREEK. THIS SURVEY WAS ACCOMPLISHED WITH A NIKON DTM 450 TOTAL STATION AND TRIMBLE 4000SE GPS BASE RECEIVER WITH PRO XR ROVER RECEIVERS. I WAS ASSISTED IN THIS SURVEY BY GARY ANGIOLET, MARK DVORCSAK AND IGNACIO ROMAN.

## FILED

Date: 1-9-2002 By: JC  
 This survey consists of:  
 Map: M 139-33  
 Narrative:  
 Corner Rpt:

DOUGLAS COUNTY SURVEYOR

## LEGEND:



- ⊙ - FOUND MONUMENT
- - SET 5/8" BY 40" IRON ROD WITH ALUMINUM CAP
- ▲ - COMPUTED NOT SET
- - LINES FLAGGED, BLAZED & TAGGED
- - PROJECTED LINES
- ( ) - NYGREN 1996 RECORD SURVEY FILED IN DOUGLAS COUNTY SURVEYORS OFFICE AS M25-75
- < > - PAULIN RECORD SURVEY FILED IN DOUGLAS COUNTY SURVEYORS OFFICE AS M 24-1

## CORNER INFORMATION:

THE FOLLOWING IS A RECORD OF ALL CORNERS FOUND OR SET DURING THE COURSE OF THIS SURVEY.

- 1) THE WEST 1/4 CORNER OF SECTION 30  
 FOUND 2" IRON PIPE SET IN MAP M24-1.  
 -- 45" DOUGLAS FIR BEARS N89°W, 26.4 FEET (RECORD WEST 25.74 FEET) WELL HEALED FACE AND TAG  
 -- 19" PINE STUMP BEARS S79°W, 65.6 FEET (RECORD S80 1/2°W, 64.6 FEET) HEALED FACE AND TAG  
 -- 12" MADRONE BEARS N72 1/4°, 24.2 FEET (RECORD N72 1/2°E, 24.5 FEET) HEALED FACE AND TAG  
 CORNER SITS ON A SOUTHWEST SLOPE APPROXIMATELY 10 FEET WEST OF DRAW.
- 2) THE CENTER 1/4 CORNER OF SECTION 30  
 FOUND 1 1/2" IRON PIPE SET IN MAP M24-1.  
 -- 20" FIR STUMP CUT BELOW SCRIBING WITH TAG NAILED TO TOP OF STUMP AS PER RECORD S41°W, 8.8 FEET  
 -- 10" FIR STUMP CUT AT GROUND LEVEL AS PER RECORD N42°E, 20.9 FEET  
 CORNER SITS ON SOUTHEAST SLOPE RECENT LOGGING SOUTH OF CORNER.
- 3) THE EAST 1/4 CORNER OF SECTION 30  
 FOUND 1 1/2" IRON PIPE SET IN CS 41/375.  
 -- 30" STUMP CUT BELOW SCRIBING WITH TAG NAILED TO TOP OF STUMP BEARS S47 1/2°W, 12.7 FEET (RECORD S45°W 12.54 FEET)  
 -- 36" DOUGLAS FIR BEARS N15 1/2°E, 22.0 FEET (RECORD N13°E, 21.12 FEET) HEALED FACE AND TAG  
 CORNER LIES ON SMALL RIDGETOP AT FENCE CORNER. FENCE RUNS EAST AND SOUTH FROM CORNER.
- 4) THE NORTH SOUTH 1/64 BETWEEN SECTIONS 29 AND 30  
 SET 5/8" X 40" IRON ROD WITH YELLOW PLASTIC CAP MARKED LONE ROCK TIMBER PLS 2291.  
 -- 14" DOUGLAS FIR BEARS S22°W, 10.2 FEET, WE SCRIBE NS 1/64 S30 B.T. AND TAG TREE  
 -- 6" DOUGLAS FIR BEARS N23 3/4°E, 44.1 FEET, WE SCRIBE B.T. AND TAG TREE  
 CORNER LIES ON WEST SLOPE APPROXIMATELY 2.5 FEET WEST OF NORTH SOUTH FENCE LINE.
- 5) THE S1/16 CORNER BETWEEN SECTIONS 29 AND 30  
 SET 5/8" X 40" IRON ROD WITH YELLOW PLASTIC CAP MARKED LONE ROCK TIMBER PLS 2291.  
 -- 19" DOUGLAS FIR BEARS N3 1/4°W, 21.6 FEET, WE SCRIBE S1/16 S30 B.T. AND TAG TREE  
 -- 10" DOUGLAS FIR BEARS S13 1/2°E, 14.5 FEET, WE SCRIBE S1/16 S29 B.T. AND TAG TREE  
 CORNER LIES ON SOUTHWEST SLOPE WITH RECENT LOGGING TO EAST AND OLDER LOGGING TO SOUTHWEST.
- 6) THE SOUTHEAST 1/16 CORNER OF SECTION 30  
 SET 5/8" X 40" IRON ROD WITH YELLOW PLASTIC CAP MARKED LONE ROCK TIMBER PLS 2291.  
 -- 12" DOUGLAS FIR BEARS N71°E, 14.0 FEET, WE SCRIBE SE1/16 S30 B.T. AND TAG TREE  
 -- 12" DOUGLAS FIR BEARS S36 1/4°W, 24.6 FEET, WE SCRIBE SE1/16 S30 B.T. AND TAG TREE  
 CORNER LIES ON STEEP NORTHWEST SLOPE ON WEST EDGE OF SMALL SPUR RIDGE.
- 7) THE EAST 1/16 CORNER BETWEEN SECTIONS 30 AND 31  
 SET 5/8" X 40" IRON ROD WITH YELLOW PLASTIC CAP MARKED LONE ROCK TIMBER PLS 2291.  
 -- UNRECORDED 3/4" IRON ROD BEARS N79°38'40"W, 0.98 FEET  
 -- 9" DOUGLAS FIR BEARS S41 1/2°E, 9.0 FEET, WE SCRIBE E1/16 S31 B.T. AND TAG TREE  
 -- 12" DOUGLAS FIR BEARS N3 1/4°E, 35.5 FEET, WE SCRIBE E1/16 S30 B.T. AND TAG TREE  
 CORNER LIES ON SOUTH SLOPE APPROXIMATELY 70 FEET NORTH OF CENTERLINE OF ROCK ROAD.

- 8) THE SOUTHEAST SECTION CORNER OF SECTION 30  
 FOUND 2" IRON PIPE SET BY PRICE IN C.S. FILE 41/375.  
 -- 31" 6 FOOT TALL DOUGLAS FIR STUMP BEARS N62 3/4°W, 18.9 FEET (RECORD N67°W, 19.14 FEET) HEALED FACE AND TAG  
 -- 18" 6 FOOT TALL DOUGLAS FIR STUMP BEARS S67 1/4°W, 15.9 FEET (RECORD S64°W, 15.84 FEET) HEALED FACE AND TAG  
 CORNER LIES 1.0 FEET SOUTH OF FENCE CORNER. FENCE RUNS NORTH AND EAST FROM CORNER.
- 9) WITNESS CORNER FOR PROPERTY CORNER  
 FOUND 5/8" IRON ROD SET IN MAP M125-75  
 -- 25" DOUGLAS FIR BEARS N20°E 23.9 FEET WE SCRIBE B.T. AND TAG TREE  
 CORNER LIES ABOVE HIGH WATER MARK ON WEST BANK OF MCCULLOUGH CREEK.
- 10) THE SOUTH 1/4 CORNER OF SECTION 30  
 FOUND 1 1/2" IRON PIPE WITH STONE ALONG SIDE SET IN CS FILE 40/395.  
 -- 24" FIR STUMP BEARS N2 3/4°W, 13.5 FEET (RECORD N4°W 13.3 FEET) HEALED FACE AND TAG  
 -- 11" MADRONE BEARS S16°E, 33.5 FEET (RECORD S15 1/2°E 33.8 FEET) HEALED FACE AND TAG.  
 CORNER LIES APPROXIMATELY 180 FEET WEST OF MCCULLOUGH CREEK COUNTY ROAD.
- 11) THE CENTERSOUTH 1/16 CORNER FOR SECTION 30  
 FOUND DOUGLAS COUNTY CAP RESET 1982.  
 -- 18" CEDAR BEARS S51°E, 72.5 FEET AS PER RECORD HEALED FACE AND TAG  
 -- 16" MADRONE BEARS N68°W, 34.8 FEET AS PER RECORD HEALED FACE AND TAG  
 CORNER LIES IN MIDDLE OF SKID ROAD.
- 12) IRON ROD ON LINE  
 SET 5/8" X 40" IRON ROD WITH YELLOW PLASTIC CAP MARKED LONE ROCK TIMBER PLS 2291 ON EAST EDGE OF COUNTY RIGHT-OF-WAY FOR MCCULLOUGH CREEK COUNTY ROAD.  
 -- 8" DOUGLAS FIR BEARS N14 1/4°E, 10.3 FEET, WE SCRIBE B.T. AND TAG TREE  
 THE CORNER LIES AT EAST EDGE OF RIGHT-OF-WAY A FENCE ENDS APPROXIMATELY N10°E, 8.5 FEET AND HIGH WATER MARK ON MCCULLOUGH CREEK BEARS EAST 8.0 FEET.
- 13) THE CENTER NORTH SOUTH 1/64 CORNER FOR SECTION 30  
 SET 5/8" X 40" IRON ROD WITH YELLOW PLASTIC CAP MARKED LONE ROCK TIMBER PLS 2291.  
 -- 12" DOUGLAS FIR BEARS N55 3/4°E, 17.4 FEET, WE SCRIBE CNS 1/64 B.T. AND TAG TREE  
 -- 12" DOUGLAS FIR BEARS S62 1/2°W, 11.2 FEET, WE SCRIBE CNS 1/64 B.T. AND TAG TREE  
 CORNER LIES APPROXIMATELY 35.0 FEET SOUTH OF SKID ROAD AND APPROXIMATELY 100.0 FEET EAST OF DRAW.
- 14) THE NORTH SOUTH 1/64 CORNER BETWEEN SECTIONS 25 AND 30  
 SET 5/8" X 40" IRON ROD WITH YELLOW PLASTIC CAP MARKED LONE ROCK TIMBER PLS 2291.  
 -- 9" PINE BEARS N53 3/4°W, 23.2 FEET, WE SCRIBE NS 1/64 S25 B.T. AND TAG TREE  
 -- 21" CEDAR BEARS S4°E, 18.7 FEET, WE SCRIBE NS 1/64 S30 B.T. AND TAG TREE  
 CORNER LIES ON STEEP SOUTH SLOPE APPROXIMATELY 2.5 FEET EAST OF THE EAST EDGE OF SKID ROAD.
- 15) THE SOUTH 1/16 CORNER BETWEEN SECTIONS 25 AND 30.  
 SET 5/8" X 40" IRON ROD WITH YELLOW PLASTIC CAP MARKED LONE ROCK TIMBER PLS 2291.  
 -- 11" DOUGLAS FIR BEARS N17 3/4°W, 27.9 FEET, WE SCRIBE S1/16 S25 B.T. AND TAG TREE  
 -- 11" DOUGLAS FIR BEARS S40 3/4°E, 7.4 FEET, WE SCRIBE S1/16 S30 B.T. AND TAG TREE  
 CORNER LIES ON WEST SLOPE APPROXIMATELY 40.0 FEET SOUTH OF DIRT ROAD AND 35.0 FEET WEST OF SAME DIRT ROAD.
- 16) THE SOUTH WEST SECTION CORNER OF SECTION 30.  
 FOUND 1978 BLM BRASS CAP WITH 1 1/2" IRON PIPE ALONG SIDE  
 -- 36" FIR STUMP BEARS N24°W, 12.5 FEET AS PER RECORD  
 -- 16" PINE STUMP BEARS S28 3/4°E, 19.1 FEET AS PER RECORD  
 -- 13" FIR STUMP BEARS N12°E, 42.90 FEET AS PER RECORD  
 -- 9" PINE STUMP BEARS S40°W, 98.0 FEET AS PER RECORD  
 -- 32" FIR STUMP BEARS N82 1/4°W, 104.3 FEET AS PER RECORD  
 CORNER LIES APPROX. 30 FEET EAST AND 70 FEET NORTH OF THE 32-7-25.1 ROAD

MAP FILE M 139-33

MAP FILE M 139-33