

LONE ROCK TIMBER CO.

PO BOX 1127 ROSEBURG, OREGON 97470

J22-6-24 SURVEY

SECTION 24, TOWNSHIP 22 SOUTH, RANGE 06 WEST, W.M.

DOUGLAS COUNTY, OREGON

SCALE: 1" = 200'

DATE: JANUARY 2002

NARRATIVE:

THIS SURVEY WAS CONDUCTED TO ESTABLISH PROPERTY LINES FOR TIMBER CUTTING PURPOSES. WE INITIATED THIS SURVEY AT THE NORTHWEST CORNER OF SECTION 24 A BRASS CAP SET FROM ORIGINAL EVIDENCE BEGINNING A RANDOM TRAVERSE EASTERLY TO THE NORTH 1/4 CORNER OF SECTION 24 SET FROM PERPETUATED ORIGINAL EVIDENCE. WE CLOSED OUR SURVEY ON CONTROL NEAR THE NORTH 1/4 WE HAD PREVIOUSLY SET FROM OUR 1999 SURVEY FOR THE BREAKDOWN OF SECTION 24. WE FOUND THE ORIGINAL 50' B.T. AND 50' B.T. SNAG DESCRIBED BY THIEL CS FILE 2/49 FOR THE SOUTHWEST CORNER OF DLC #45. WE DID NOT FIND ANY EVIDENCE OF THIEL'S 1" X 30" PIPE OR B.T. N19°E, 5 LKS. WE SET A 5/8" IRON ROD FOR THE DLC CORNER TAKING ACCOUNT 0.5 FEET FOR GROWTH MEASURING FROM THE FACE OF THE CLOSEST ORIGINAL B.T. FOR THE BEST FIT FROM THE TWO B.T. TREES. I MARKED THE PROPERTY LINES AS SHOWN HEREON BASED ON CONSULTATION AND OPINION OF C. ALBERT WHITE, RETIRED CADASTRAL SURVEYOR WITH BLM AND AUTHOR OF "A CASEBOOK OF OREGON DONATION LAND CLAIMS." GARY ANGIOLET, MARK DVORCAK AND IGNACIO ROMAN USED A NIKON DTM 450 TOTAL STATION TO ASSIST ME WITH THIS SURVEY.

FILED

Date: 1-9-2002 By: X

This survey consists of:

Map: M139-32

Narrative:

Corner Rpt:

DOUGLAS COUNTY
SURVEYOR

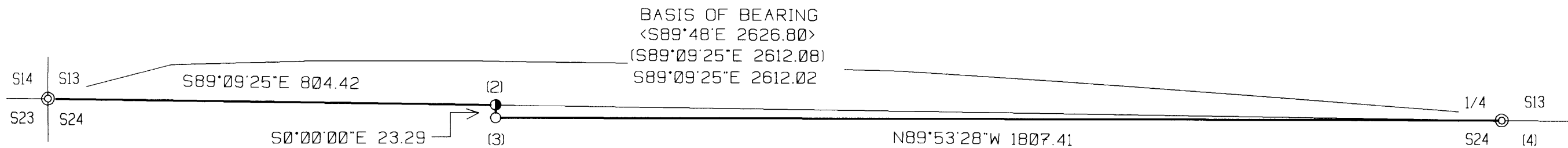

CORNER INFORMATION:

- 1) THE NORTHWEST SECTION CORNER OF SECTION 24
FOUND 1961 DOUGLAS COUNTY BRASS CAP ON IRON PIPE THAT IS SEVERELY BENT TO THE SOUTHWEST.
-- 22" DOUGLAS FIR BEARS N2 3/4°E, 14.5 FEET AS PER RECORD
-- 20" DOUGLAS FIR BEARS N42 3/4°E, 46.8 FEET (RECORD N38°E, 46.86 FEET) WELL HEALED FACE AND TAG
-- 22" DOUGLAS FIR BEARS S7 3/4°E, 60.0 FEET (RECORD S7°E, 60.72 FEET) WELL HEALED FACE AND TAG
-- 21" DOUGLAS FIR BEARS S10°W, 76.8 FEET (RECORD S10°W, 76.56 FEET) WELL HEALED FACE AND TAG
CORNER LIES ON RIDGETOP 15 FEET NORTH OF CENTERLINE OF NEW ROCK ROAD. AN OLD FENCE CORNER BEARS N80°W, 5.5 FEET AND RUNS NORTH AND WEST FROM CORNER.
- 2) PROPERTY CORNER
SET 5/8" X 30" IRON ROD WITH YELLOW PLASTIC CAP MARKED LONE ROCK TIMBER PLS 2291 ON SECTION LINE AND NORTH OF SOUTHWEST CORNER OF DLC 45.
-- THE SOUTHWEST CORNER OF DLC 45 BEARS SOUTH 23.29 FEET
CORNER LIES ON NORTHWEST SLOPE APPROXIMATELY 500 FEET EAST OF END OF ROCK ROAD THAT RUNS BY THE NORTHWEST SECTION CORNER.
- 3) THE SOUTHWEST SECTION CORNER FOR DLC 45
SET 5/8" X 40" IRON ROD WITH 2 1/2" ALUMINUM CAP 9.4 FEET (ALLOWANCE FOR GROWTH) FROM FACE OF ORIGINAL B.T. CAP MARKED LONE ROCK TIMBER T22S R6W SW DLC45 S24 2001 PLS 2291.
-- 63" ORIGINAL DOUGLAS FIR BEARING TREE BEARS S10°W, 9.4 FEET TO FACE OF SCRIBE MARKS VISIBLE (RECORD S10°W, 9.9 FEET)
-- 38" BADLY BURNED ORIGINAL DOUGLAS FIR SNAG BEARS S16 1/2°E, 20.6 FEET (RECORD S15°E, 19.80 FEET) OLD AXE MARKS ON SMALL FACE
-- 10" DOUGLAS FIR BEARS N48 1/4°W, 14.7 FEET WE SCRIBE BT AND TAG TREE
-- 5/8" IRON ROD BEARS NORTH 23.29 FEET
-- NO TRACE OF BEARING TREE N19°E, 5 LINKS IN CS FILE 2/49
CORNER LIES ON 40% NORTHEAST SLOPE 10 FEET NORTHEAST OF SMALL FLAT BENCH.
- 4) THE 1/4 CORNER BETWEEN SECTIONS 13 AND 24
FOUND 1979 DOUGLAS COUNTY BRASS CAP WITH HAINES T-IRON ALONG SIDE.
-- 20" DOUGLAS FIR BEARS N36°E, 21.9 FEET (RECORD N36 1/2°E, 22.2 FEET) WELL HEALED FACE AND TAG
-- 36" DOUGLAS FIR STUMP BEARS S16°E, 145 FEET (RECORD S16°E, 145.9 FEET) WELL HEALED FACE AND TAG
CORNER LIES ON NORTHWEST SLOPE AND OLD FENCE CORNER BEARS N40°E, APPROXIMATELY 25 FEET. FENCE RUNS NORTH AND EAST

REGISTERED
PROFESSIONAL
LAND SURVEYOR

Ken W. Hoffine

OREGON
JULY 16, 1987
KEN W. HOFFINE
2291

EXPIRES 6-30-03

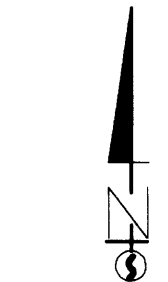

BASIS OF BEARING
MAP M136 - 56

LEGEND:

- ⊙ - FOUND MONUMENT
- - SET 5/8" X 40" IRON ROD WITH 2 1/2" ALUMINUM CAP
- - SET 5/8" X 40" IRON ROD WITH YELLOW PLASTIC CAP
- - PROJECTED LINES
- - LINES FLAGGED, BLAZED & TAGGED
- [] - LONE ROCK TIMBER RECORD SURVEY FILED IN DOUGLAS COUNTY SURVEYORS OFFICE M136-56
- < > - GLO FIELD NOTES PAGE 1436 FILED IN DOUGLAS COUNTY SURVEYORS OFFICE

MAP FILE M139-32

MAP FILE M139-32