

PROPERTY SURVEY
 FOR: ROSEBURG RESOURCES CO.
 SW1/4 AND SE1/4, SECTION 28, T21S, R8W, W.M.
 DOUGLAS COUNTY, OREGON
 19, NOVEMBER 2001

FILED
 Date: 12/18/2001 By: JP
 This survey consists of:
 Map: M139-25
 Narrative:
 Corner Rpt:
 DOUGLAS COUNTY
 SURVEYOR

MAP FILE M139-25

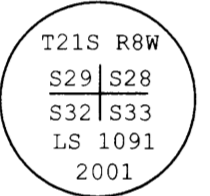
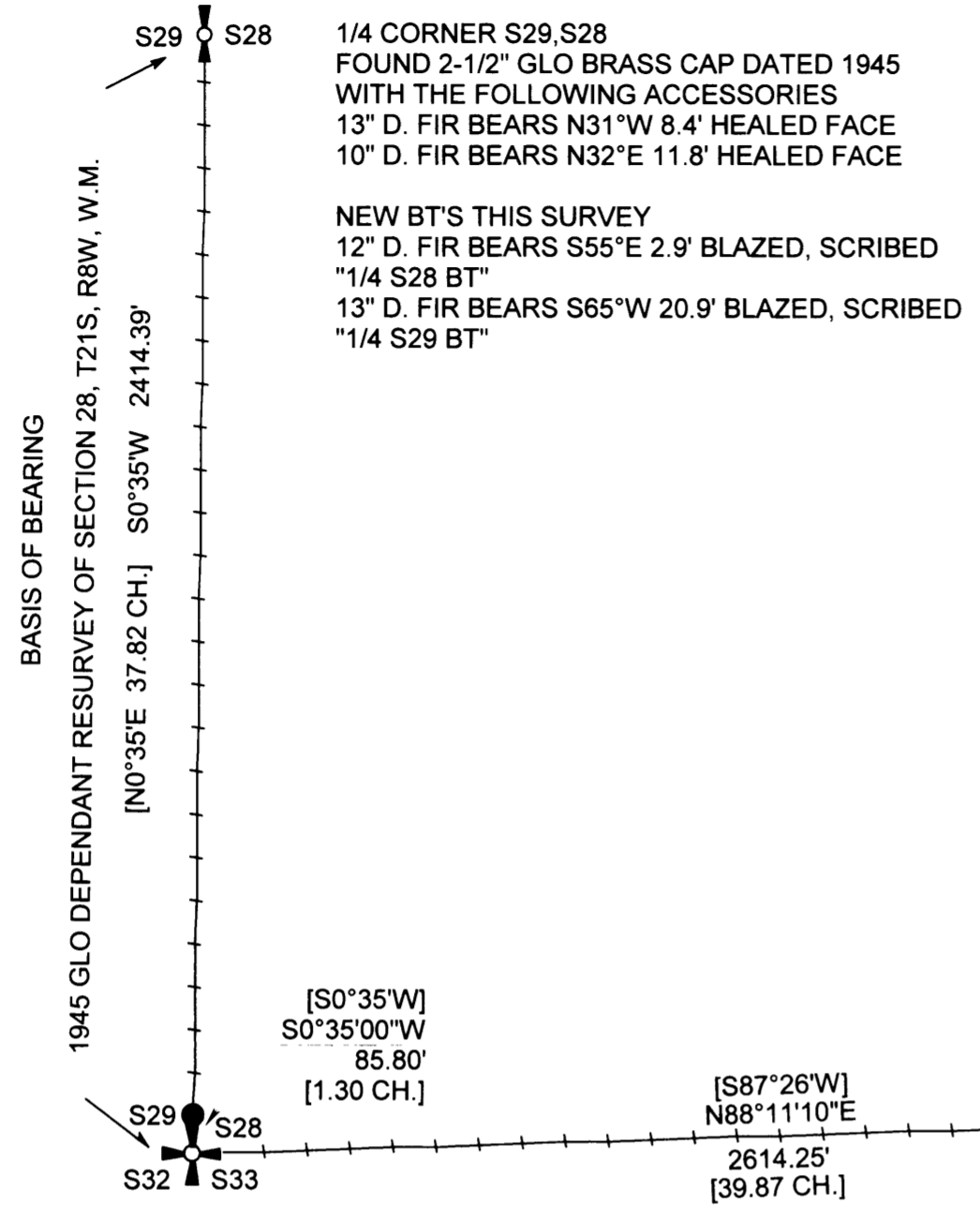

SECTION CORNER S28,S29,S32,S33
 SET THIS SURVEY 5/8" X 3/6" REBAR WITH 2-1/2" ALUMINUM CAP
 MARKED AS SHOWN WITH THE FOLLOWING ACCESSORIES
 9" D. FIR BEARS N65°E 3.8' BLAZED, SCRIBED "T21S R8W S28 BT"
 13" D. FIR BEARS S30°E 9.3' BLAZED, SCRIBED "T21S R8W S33 BT"
 12" D. FIR BEARS S68°W 8.7' BLAZED, SCRIBED "T21S R8W S32 BT"
 10" D. FIR BEARS N88°W 19.9' BLAZED, SCRIBED "T21S R8W S29 BT"
 2-1/2" GLO BRASS CAP SET AS WITNESS CORNER DATED 1945
 BEARS N0°35'00"E 85.80'

WC 1/4 S28,S33
 FOUND 2-1/2" GLO BRASS CAP DATED 1945
 WITH THE FOLLOWING ACCESSORIES
 22" X 10' D. FIR STAUB BEARS N71°W 6.8' NO VISIBLE MARKS
 (RECORD N81-1/4"W 11LKS.)
 18" X 10" D. FIR SNAG BEARS S6°W 31.0' VISIBLE AXE WORK

NEW BT'S THIS SURVEY
 10" D. FIR BEARS S65°W 9.8' BLAZED, SCRIBED "X" AT BEAST HEIGTH
 "WC 1/4 S33 BT" AT BASE
 10" D. FIR BEARS N26°E 21.5' BLAZED, SCRIBED "X" AT BEAST HEIGTH
 "WC 1/4 S28 BT" AT BASE
 13" D. FIR BEARS N58°E 20.5' BLAZED, SCRIBED "X" AT BEAST HEIGTH
 "WC 1/4 S28 BT" AT BASE
 12" D. FIR BEARS S66°E 11.0' BLAZED, SCRIBED "X" AT BEAST HEIGTH
 "WC 1/4 S33 BT" AT BASE
 1941 GLO RECORD POSITION FOR TRUE 1/4 CORNER IS S87°26'W 0.86 CH.
 FROM WC

WC S27,S28,S33,S34
 FOUND 2-1/2" GLO BRASS CAP DATED 1945
 WITH THE FOLLOWING ACCESSORIES
 48" R. CEDAR BEARS N26-1/4°E 170 LKS. HEALED FACE
 72" D. FIR BEARS N58-1/4°W 222 LKS.
 18" HEM. BEARS S60°E 17.9' SEMI-HEALED FACE
 12" D. FIR BEARS S88°W 15.1' SEMI-HEALED FACE
 1945 GLO RECORD POSITION FOR TRUE SECTION
 CORNER IS N0°32'E 0.1 CH. FROM WC

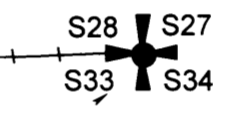
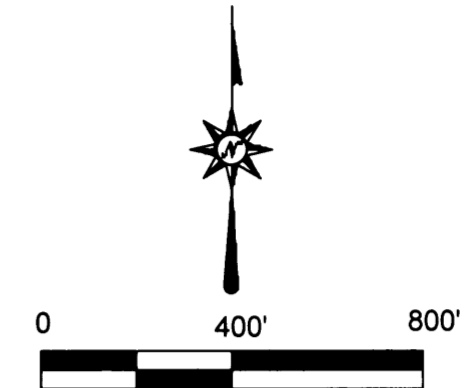

WITNESS CORNER BEARS
 S0°32'00"W 6.60'
 [S0°32'W 0.10 CH.]
 FROM TRUE CORNER
 POSITION

LEGEND

- TRUE 1/4 CORNER MONUMENT AS NOTED
- WITNESS CORNER MONUMENT AS NOTED
- TRUE SECTION CORNER POSITION AS NOTED
- RECORD DATA 1945 GLO DEPENDANT RESURVEY
- GLO GENERAL LAND OFFICE
- LINE MARKED WITH RED PAINTED BLAZES,
RED FLAGGING AND 5-1/2" GALVIANIZED STEEL POSTS

NARRATIVE

THE PURPOSE OF THIS SURVEY WAS TO MARK THE LINES OF SECTION 28 AS SHOWN ON THIS PLAT.

SECTION LINES WERE RETRACED IN A CLOSED LOOP TRAVERSE TO TIE CONTROLLING MONUMENTS ESTABLISHED IN THE 1945 GLO DEPENDANT RESURVEY. WE WERE ABLE TO ESTABLISH THE SW CORNER OF SECTION 28 AT IT'S RECORD POSITION FROM THE AS TIED WITNESS CORNER POSITION.

LINE WAS MARKED WITH RED PAINTED BLAZES, RED FLAGGING AND 5-1/2" GALVANIZED STEEL POSTS PLACED AT APPROXIMATELY 200' INTERVALS OR LESS. ALL BEARING TREES ESTABLISHED DURING THIS SURVEY HAVE RED PAINTED FACES, RED PAINTED BAND AROUND THE TREE AND YELLOW BEARING TREE TAG. THERE IS A 5-1/5" GALVANIZED STEEL POST ADJACENT TO ALL CORNERS.

THE BASIS OF BEARING FOR THIS SURVEY WAS THE SECTION LINE FROM THE 1/4 CORNER OF SECTIONS 28,29 TO THE SECTION CORNER OF SECTIONS 28,29,32,33 AS SHOWN IN THE 1945 GLO DEPENDANT RESURVEY OF SECTION 28.

THIS SURVEY WAS PERFORMED USING A PENTAX TOTAL STATION

PLOTTER: HP DESIGNJET 500
 INK: BLACK C4910A
 MEDIA: CLEARPRINT DRAFTING VELLUM
 TRANSLUCENT-100% NEW COTTON FIBER
 SOLVENT FREE

REGISTERED
 PROFESSIONAL
 LAND SURVEYOR

 OREGON
 ROBERT B. WARD JR.
 JULY 30, 1976
 LS 1091
 EXPIRES: 6/30/02

Ward NorthWest, Inc.
 P.O. BOX 105 FLORENCE, OR 97439
 (541) 997-9201 FAX: 541-997-3546

FILE: X:\SURVEY\0101-66101-66.TRV

MAP FILE M139-25