

TOPOGRAPHIC SURVEY

LOCATED in Lots 9 and 10, Block 6, CHADWICK ADDITION to Roseburg
and the NW 1/4 of Section 19, T. 27 S., R. 5 W., W.M. in Douglas County, Oregon.

May 8, 2003

FILED
Date: 5/22/2003 By: DP
This survey consists of:
Map: M137-61
Name: DP
Corner Rpt: _____
DOUGLAS COUNTY
SURVEYOR

NOTES: ELEVATIONS ARE ASSUMED.
ELEVS. SHOWN ON FACE OF CURB ARE TOP CURB.
NON-VISIBLE UTILITY LOCATIONS ARE SHOWN AS
PER PAINTED LOCATIONS BY UTILITIES OR
THEIR CONTRACTORS.

SURVEYED FOR: JAMES FARRELL
1243 SE DOUGLAS AVE.
ROSEBURG, OREGON

SURVEYED BY: DAVID EDWARDS LAND SURVEYING
P.O. BOX 361
OAKLAND, OREGON 97462
PHONE: (541) 459-0512

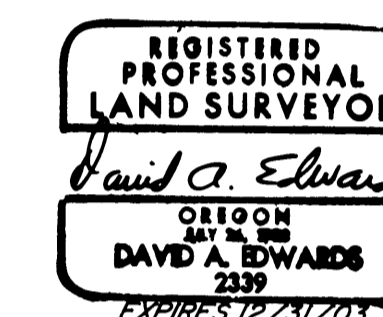

LEGEND

- OHU — INDICATES OVERHEAD UTILITY LINES
- INDICATES 3/4" DIAM. IRON ROD FOUND.
- INDICATES 5/8" X 30" STEEL PIN W/RED PLASTIC CAP MKD. "D.A. EDWARDS-LS 2339" SET.
- INDICATES UTILITY POLE
- ⊙ INDICATES SANITARY SEWER MANHOLE
- ▲ INDICATES TELEPHONE RISER
- INDICATES DOWN GUY ANCHOR
- + INDICATES SPOT ELEVATION
- UTEL — INDICATES UNDERGROUND TELEPHONE
- PSL — INDICATES PRIVATE SEWER LINE
- ▲ INDICATES STREET SIGN
- INDICATES WATER METER
- ◀ INDICATES FIRE HYDRANT
- ⊙ INDICATES MAPLE TREE

SCALE: 1" = 10'

BASIS OF BEARINGS: M 14-32

NARRATIVE

THE PURPOSE OF THIS SURVEY IS TO SHOW THE EXISTING TOPOGRAPHIC FEATURES OF THE FARRELL LOTS. ALSO, TO RESET THE SOUTHEAST AND SOUTHWEST CORNERS OF LOT 9. THE LATTER WAS ACCOMPLISHED BY USING RECORD BEARING AND DISTANCES FROM FOUND MONUMENTS PER M 14-32 AS SHOWN HEREON.

FIELD CREW: BRANT MILLER AND BRANDY SWEARINGEN.
EQUIPMENT: NIKON TOTAL STATION.
COMPS. AND DRAFTING: DAVID EDWARDS.

