

TOWNSHIP 29 SOUTH RANGE 9 WEST
 W1/2 E1/2 SECTION 14
 DOUGLAS COUNTY, OREGON
 SURVEY FOR MOORE MILL & LUMBER CO.

FILED
 Date: 7-17-2000 By: J.P.
 This survey consists of:
 Map: M135-53
 Narrative:
 Corner Rpt:

DOUGLAS COUNTY
 SURVEYOR

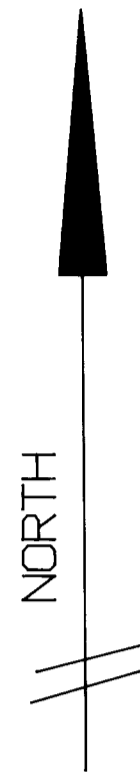

SCALE 1" = 400 FEET
 DATE OF SURVEY JULY & AUGUST 2000

LEGEND

- ⊙ MONUMENT FOUND AS NOTED
- SET 5/8" X 30" IRON ROD WITH 2" ALUMINUM CAP MARKED PER 1973 MANUAL OF SURVEYING INSTRUCTIONS
- CALCULATED FROM RECORD SURVEY
- HEAVY LINE HAS BEEN BLAZED ON BOTH SIDES OF TRUE LINE AND PAINTED WITH RED TREE MARKING PAINT WITH RED FLAGGING HUNG ALONG THE TRUE LINE
- EXISTING FENCE LINE

SURVEY NARRATIVE

THIS SURVEY WAS CONDUCTED AT THE REQUEST OF THE OWNER, MOORE MILL & LUMBER CO. TO LOCATE AND MARK THE PROPERTY LINES. PROPERTY LINES WERE BLAZED ON BOTH SIDES OF THE TRUE LINE AND PAINTED WITH RED TREE MARKING PAINT WITH RED FLAGGING HUNG ALONG THE TRUE LINE. BEARINGS WERE BASED ON DOUGLAS COUNTY RECORD SURVEY NUMBER M95 75A WHICH STATES THE BASIS OF BEARING IS RECORD GLO PLAT 1966. THE CORNERS SHOWN AS FOUND CONTROLLED THE LOCATION OF CORNERS SET THIS SURVEY.

REGISTERED
 GARY T. SMITHER
 OREGON
 ANNO 29
 GARY T. SMITHER
 Expires 6/2002



GARY T. SMITHER
 OREGON SURVEYOR

P.O. BOX 545, NORTH BEND, OREGON 97459
 FAX & PHONE: (541) 751-9624

N1/4 FOUND 2 1/2" BRASS CAP ON IRON PIPE MARKED PER RECORD M95-75B WITH RED STEEL FENCE POST 1 FOOT SOUTH OF CORNER

FROM WHICH OLD BEARING TREES:

44" D. FR STUMP NORTH 42.5 FT. BARK SCRIBE HAS BEEN CUT OUT WITH CHAIN SAW AND METAL ROOFING PLACED OVER STUMP

35" D. FR S 18" W 26.4 FT. WITH BEARING TREE TAG

17" D. FR SOUTH 35.0 FT. ROTTING AWAY WITH BEARING TREE TAG

9" HEMLOCK N 49" W 3.0 FT. ROTTING AWAY

FROM WHICH NEW BEARING TREES:

10" W. FR S 18" E 30.6 FT. TO SPIKE SIDE CENTER SCRIBED T 29 R9 1/4 S14 BT WITH BEARING TREE TAG

2" W. FR S 29" W 27.4 FT. TO SPIKE SIDE CENTER SCRIBED T29 R 9 1/4 S14 BT WITH BEARING TREE TAG

W 1/4

RECORD S 89°43'09" E 2618.39'

CV/4

SET 2" ALUMINUM CAP ON 5/8" X 30" IRON ROD MARKED:

T29S R 9 W
 C 1/4
 S14
 2000
 2485

FROM WHICH NEW BEARING TREES:

13" D. FR S 9" E 5.0 FT. TO SPIKE SIDE CENTER SCRIBED CV/4 S14 BT WITH BEARING TREE TAG

14" W. FR S 84" W 15.4 FT. TO SPIKE SIDE CENTER SCRIBED CV/4 S14 BT WITH BEARING TREE TAG

12" D. FR N 45" W 12.9 FT. TO SPIKE SIDE CENTER SCRIBED CV/4 S14 BT WITH BEARING TREE TAG

14" W. FR N 38" E 18.7 FT. TO SPIKE SIDE CENTER SCRIBED CV/4 S14 BT WITH BEARING TREE TAG

S 1/4 SET IN FENCE LINE

FOUND 2 1/2" BRASS CAP ON IRON PIPE MARKED PER RECORD M95-75B.

FROM WHICH OLD BEARING TREES:

2" D. FR N 27" E 48.0 FT. TO SPIKE SIDE CENTER WITH HEALED FACE AND BEARING TREE TAG

DID NOT LOOK FOR 14" FR SNAG AT S 8" W. 114.3 FT. IN REPRODUCTION STAND

FROM WHICH NEW BEARING TREES:

12" W. FR N 39" W 16.9 FT. TO SPIKE SIDE CENTER SCRIBED 1/4 S14 BT WITH BEARING TREE TAG

20" W. FR N 27" E 30.5 FT. TO SPIKE SIDE CENTER SCRIBED 1/4 S14 BT WITH BEARING TREE TAG

8" D. FR N 66" E 13.7 FT. TO SPIKE SIDE CENTER SCRIBED 1/4 S14 BT WITH BEARING TREE TAG

N1/4

RECORD N 89°42'30" E 1329.83'

MEASURED N 89°44'17" E 1330.06'

E 1/6

SECTION 11
 SECTION 14

RECORD N 0°04'39" E 2638.28'
 MEASURED N 0°04'20" E 2638.64'

CV/4

RECORD S 89°43'09" E 1331.61'

MEASURED S 89°43'09" E 1331.61'

BASIS OF BEARING

RECORD S 0°02'19" W 2651.57'

MEASURED S 0°02'19" W 2651.25'

CE 1/6

FOUND 2" ALUMINUM CAP ON 5/8" IRON ROD MARKED PER RECORD M95-75B

FROM WHICH:

17" D. FR S 46" W 10.8 FT. WITH HEALED FACE AND BEARING TREE TAG

14" ALDER N 60" W 7.4 FT. WITH BARK SCRIBE AND BEARING TREE TAG

RECORD N 0°04'39" E 2665.25'
 MEASURED N 0°04'01" E 2665.86'

S1/4

RECORD N 89°42'36" W 1332.90'

MEASURED N 89°44'01" W 1332.96'

RECORD S 0°02'59" W 2665.47'

MEASURED S 0°02'17" W 2665.53'

E 1/6

SECTION 14
 SECTION 23

FENCE LINE

E 1/6 SET IN FENCE LINE

FOUND 2 1/2" BRASS CAP ON IRON PIPE MARKED PER RECORD M95-75B. OLD BEARING TREE SNAGS ARE GONE.

FROM WHICH NEW BEARING TREES:

5" D. FR N 36" E 12.0 FT. TO SPIKE SIDE CENTER "X" AT BREAST HEIGHT AND "BT" AT BASE WITH BEARING TREE TAG

7" D. FR N 65" W 20.6 FT. TO SPIKE SIDE CENTER SCRIBED E1/6 S14 BT WITH BEARING TREE TAG

MAP FILE M135-53

MAP FILE M135-53