

FILED

Date: 1-21-2000 By: JP  
This survey consists of:  
Map: M134-6  
Narrative: \_\_\_\_\_  
Corner Rpt: \_\_\_\_\_

DOUGLAS COUNTY  
SURVEYOR

LEGEND

- MONUMENTS FOUND AND USED FOR CONTROL
  - MONUMENTS SET - NO MONUMENTS SET THIS SURVEY
  - //— LINES MARKED WITH RED PAINTED BLAZES, RED PLASTIC RIBBON AND RED METAL FENCE POSTS
  - ( ) DATA OF RECORD - SURVEY M3-23 BY WILFORD HAINES AND DATED OCTOBER 18, 1956
- BASIS OF BEARING - LINE "A-B" FROM SURVEY M3-23 BY WILFORD HAINES
- DISTANCES TO BEARING TREES ARE CENTER MEASURE
- ALL NEW BEARING TREES ARE SCRIBED AND HAVE A METAL WASHER STAMPED P.L.S. 1039 NAILED TO LOWER BLAZE. LOWER BLAZES ARE PAINTED RED.
- DIRT OR ROCK ROAD = - - - - - RIDGE = ~~~~~~
- CREEK OR DRAW = —————>

**BOUNDARY SURVEY  
FOR  
SENECA JONES TIMBER COMPANY  
IN  
N1/2 SECTION 32, T20S, R6W, W.M.  
DOUGLAS COUNTY, OREGON  
BY  
ROBERTS SURVEYING INC.  
P.O. BOX 7155  
EUGENE, OREGON 97401  
PHONE 345-1112**

MAP FILE M134-6

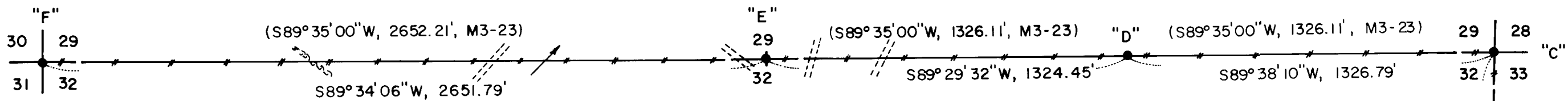

"D" EAST 1/16 CORNER TO SECTIONS 29 AND 32  
FD. HAINES "T" IRON SET IN SURVEY M3-23  
22" FIR, N46°E, 14.0' (SCAR VIS.), 1956 B.T.  
22" FIR, S57°E, 11.5' (SCAR VIS.), 1956 B.T.

"A" EAST 1/4 CORNER TO SECTION 32  
FD. HAINES "T" IRON SET IN SURVEY M3-23

"E" NORTH 1/4 CORNER TO SECTION 32  
FD. HAINES "T" IRON SET IN SURVEY M3-23. "T" IRON FALLS ON SOUTH EDGE OF 4' WIDE CREEK. BOTH OF HAINES 1956 B.T.'S WERE UP-ROOTED BY LOGGING.  
SET 8" ALDER, N42°E, 16.2' (BARK SCRIBED/METAL WASHER)  
12" ALDER, S55°E, 9.0' (BARK SCRIBED/METAL WASHER)

"B" NORTH 1/16 CORNER TO SECTIONS 32 AND 33  
FD. HAINES "T" IRON SET IN SURVEY M3-23  
42" FIR, N43°E, 97.3' (SCAR VIS.), 1956 B.T.  
46" FIR, S24°W, 59.9' (SCAR VIS.), 1956 B.T.

"F" N.W. CORNER SECTION 32  
FD. HAINES "T" IRON SET IN SURVEY M3-23.  
40" FIR, N48°W, 36.6' (SCAR VIS.), ORIG. B.T.  
24" FIR STUMP, S56°E, 34.2' (SCAR VIS.), 1956 B.T.  
26" FIR, S65°W, 40.8' (SCAR VIS.), 1956 B.T.  
40" FIR, N58°E, 37.6' (BARK SCRIBED), 1956 B.T.  
SET 6" HEMLOCK, S66°E, 7.9' (SCRIBED/METAL WASHER)

"C" N.E. CORNER SECTION 32  
FD. HAINES "T" IRON SET IN SURVEY M3-23  
38" FIR, S85°E, 42.5' (BARK SCRIBE), 1956 B.T.  
44" FIR, N25°W, 74.0' (BARK SCRIBE), 1956 B.T.  
48" FIR STUMP, N27°E, 72.4' (SCAR VIS.), 1956 B.T.  
46" FIR, S47°W, 50.2' (SCAR VIS.), 1956 B.T.

**NARRATIVE**, THE PURPOSE OF THIS SURVEY IS TO BLAZE AND POST THE FOLLOWING LINES. 1) THE N1/2 OF THE N1/2, EAST LINE SECTION 32 2) THE NORTH LINE OF SECTION 32. THE NORTH 1/16 CORNER TO SECTIONS 32 AND 33, THE N.E. SECTION CORNER, THE EAST 1/16 CORNER TO SECTIONS 29 AND 32, THE NORTH 1/4 CORNER AND THE N.W. SECTION CORNER WERE FOUND IN THE FIELD AND USED AS CONTROL FOR THIS SURVEY. A CLOSED RANDOM PROPERTY LINE TRAVERSE, USING A WILD T-16 THEODOLITE AND A DI-4L E.D.M., WAS RUN ALONG THE PROPERTY LINES TO BE BLAZED AND POSTED. OFFSETS WERE COMPUTED FROM THIS PROPERTY LINE TRAVERSE TO THE TRUE PROPERTY LINES. PROPERTY LINES WERE MARKED WITH RED PAINTED BLAZES, RED PLASTIC RIBBON AND RED METAL FENCE POSTS.

*L. D. Roberts*  
EXPIRES 12-31-2000

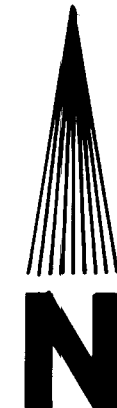

SCALE 1" = 400'  
JANUARY 7, 2000

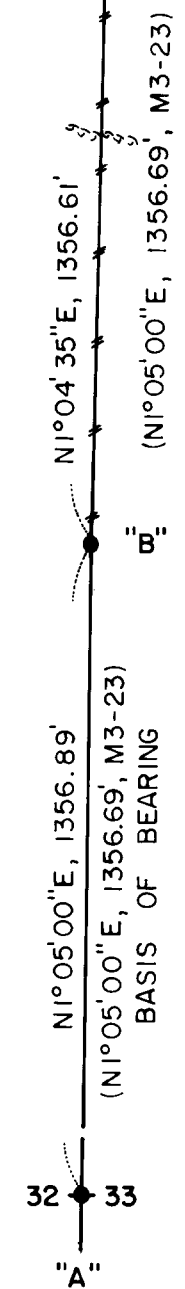

MAP FILE M134-6