

MAP FILE 1134-24E

RCL	DEC. 1999
Calculated RCL	Date
Drawn	Date
Checked	Date

REGISTERED PROFESSIONAL LAND SURVEYOR
Robert C. Lennox
 OREGON
 JULY 14, 1998
 ROBERT C. LENNOX
 2886
 RENEWAL: 12-31-00

UNLESS OTHERWISE STATED, ALL UNITS SHOWN ON THIS SHEET ARE
METRIC UNITS

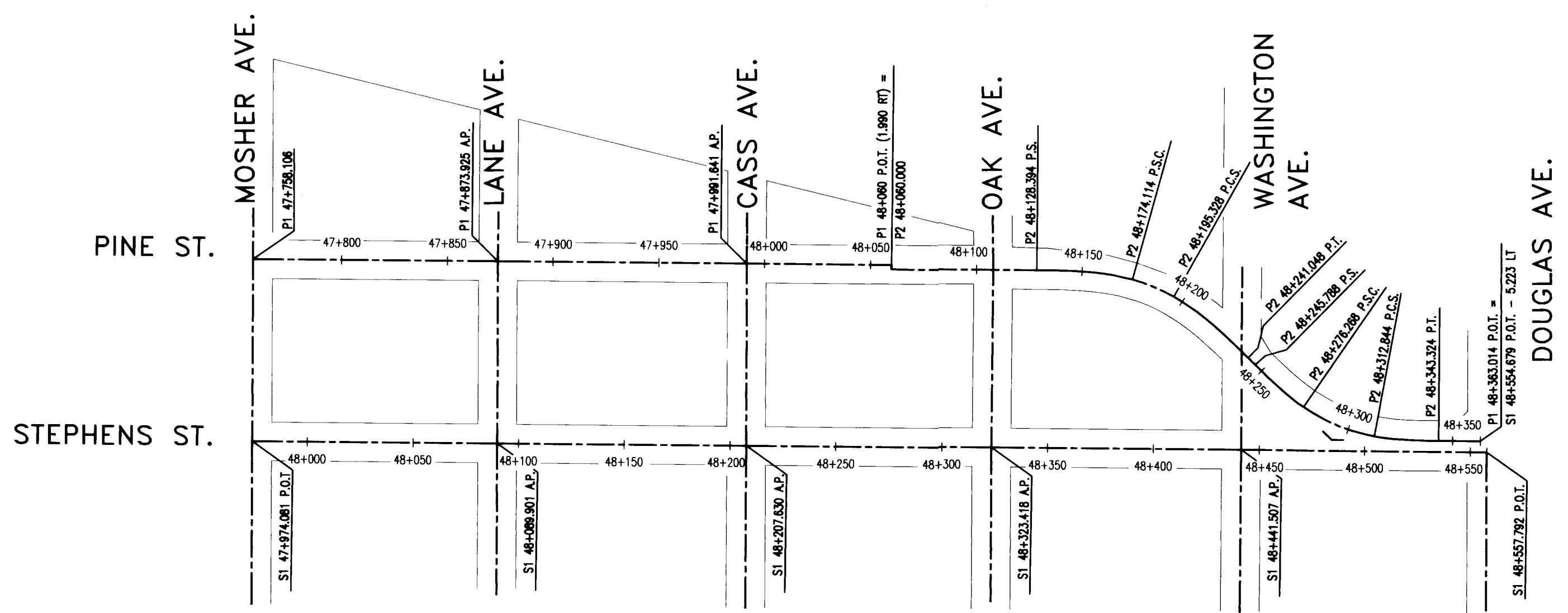
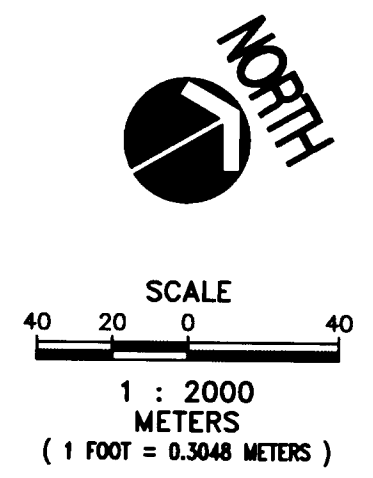

**PINE STREET
 P1 CENTERLINE ALIGNMENT DATA**

DESC.	STATION	SPIRAL/CURVE DATA	NORTHING	EASTING
P.D.T.	47+758.106		175079.4610	1268705.3368
		BEARING = N 29°46'54" E DISTANCE = 115.819		
A.P.	47+873.925		175179.9831	1268762.8635
		BEARING = N 29°49'21" E DISTANCE = 117.716		
A.P.	47+991.641		175282.1102	1268821.4054
		BEARING = N 29°54'30" E DISTANCE = 68.359		
A.P.	48+060.000 = P2 48+60.000 1.990 LT		175341.3654	1268855.4901

**PINE STREET
 P2 CENTERLINE ALIGNMENT DATA**

DESC.	STATION	SPIRAL/CURVE DATA	NORTHING	EASTING
P.I.	48+060.000 = P1 48+60.000 1.990 RT.		175340.3729	1268857.2154
		BEARING = N 29°54'30" E DISTANCE = 68.394		
P.S.	48+128.394		175399.6588	1268891.3177
S.P.I.		DISTANCE = 45.720 DEGREE = 20° THETA = 15°00'00" BEARING = N 34°54'20" E CHORD = 45.581	175426.1751	1268906.5704
P.S.C.	48+174.114		175437.0396	1268917.4002
R.P.			175375.3947	1268979.2426
		DELTA = 13°55'12" DEGREE = 20° DISTANCE = 21.214 BEARING = N 51°52'06" E CHORD = 21.162		
P.C.S.	48+195.328		175450.1065	1268934.0461
S.P.I.			175458.0466	1268947.1714
		DISTANCE = 45.720 DEGREE = 20° THETA = 15°00'00" BEARING = N 68°49'52" E CHORD = 45.581		
P.T.	48+241.048		175466.5665	1268976.5512
		BEARING = N 73°49'41" E DISTANCE = 4.740		
P.S.	48+245.788		175467.8865	1268981.1033
S.P.I.			175473.5551	1269000.6504
		DISTANCE = 30.480 DEGREE = 20° THETA = 10°00'00" BEARING = N 70°29'45" E CHORD = 30.439		
P.S.C.	48+276.268		175478.0493	1269009.7953
R.P.			175556.4158	1268971.2821
		DELTA = 24°00'00" DEGREE = 20° DISTANCE = 36.576 BEARING = N 51°49'41" E CHORD = 36.309		
P.C.S.	48+312.844		175500.4892	1269038.3402
S.P.I.			175508.3145	1269044.8665
		DISTANCE = 30.480 DEGREE = 20° THETA = 10°00'00" BEARING = N 33°09'38" E CHORD = 30.439		
P.T.	48+343.324		175525.9707	1269054.9899
		BEARING = N 29°49'41" E DISTANCE = 19.690		
P.D.T.	48+363.014		175543.0523	1269064.7837

**STEPHENS STREET
 S1 CENTERLINE ALIGNMENT DATA**

DESC.	STATION	SPIRAL/CURVE DATA	NORTHING	EASTING
P.D.T.	47+974.081		175036.7529	1268780.5608
		BEARING = N 29°48'37" E DISTANCE = 115.820		
A.P.	48+089.901		175137.2475	1268838.1385
		BEARING = N 29°49'05" E DISTANCE = 117.729		
A.P.	48+207.630		175239.3899	1268896.6786
		BEARING = N 29°49'52" E DISTANCE = 115.788		
A.P.	48+323.418		175339.8352	1268954.2769
		BEARING = N 29°49'53" E DISTANCE = 118.089		
A.P.	48+441.507		175442.2766	1269013.0200
		BEARING = N 29°49'47" E DISTANCE = 116.285		
A.P.	48+557.792		175543.1548	1269070.8631

- LEGEND**
- P.O.T. DENOTES POINT ON TANGENT
 - A.P. DENOTES ANGLE POINT
 - P.I. DENOTES POINT OF INTERSECTION
 - P.S. DENOTES POINT OF SPIRAL
 - P.S.C. DENOTES POINT OF SPIRAL CURVE
 - S.P.I. DENOTES SPIRAL POINT OF INTERSECTION
 - R.P. DENOTES RADIUS POINT
 - P.C. DENOTES POINT OF CURVE SPIRAL
 - P.T. DENOTES POINT OF TANGENT

Preconstruction and Centerline Survey
 FOR
 Oregon Department of Transportation
 Proposed Centerline Alignment
 LOCATED IN THE NW 1/4 SECTION 19, T. 27 S., R. 5 W., W. M.
 AND
 LOCATED IN THE NE 1/4 SECTION 24, T. 27 S., R. 6 W., W. M.
 CITY OF ROSEBURG, DOUGLAS COUNTY, OREGON

FILED
 Date: 2/17/2000 By: JLP
 This survey consists of: 5 Pgs.
 Map: 1134-24 E
 Narrative: _____
 Corner Rpt: _____

DOUGLAS COUNTY SURVEYOR

 17355 S.W. BOONES FERRY ROAD
 LAKE OSWEGO, OREGON 97035
 (503)635-3618 FAX (503)635-5395

5 OF 5
 Sheet No.
9054-003
 Project No.

MAP FILE 1134-24E