

# METES & BOUNDS SURVEY MAP

## LONE ROCK TIMBER CO.

PO BOX 1127 ROSEBURG OREGON 97470  
SECTIONS 27 & 28, TOWNSHIP 25 SOUTH, RANGE 5 WEST, W.M.  
WAHL TRACT

DATE: JULY, 2000  
DOUGLAS COUNTY, OREGON  
SCALE 1" = 500'

FILED  
Date: 8-21-2000 By: [Signature]  
This survey consists of:  
Map: M132-44  
Narrative: [Signature]  
Corner Ppt: [Signature]

DOUGLAS COUNTY  
SURVEYOR



BASIS OF BEARING  
FROM BURT HOLT MAP M 56/65  
COMPUTED BETWEEN FOUND MONUMENTS  
#22 AND #39 AS SHOWN HEREON

### NARRATIVE

THIS SURVEY WAS CONDUCTED TO ESTABLISH PROPERTY LINES FOR TIMBER CUTTING PURPOSES. THIS SURVEY IS A RETRACEMENT OF A 1976 BURTON HOLT MAP M56-65. ALL 36 MONUMENTS SET FOR HOLT'S SURVEY WERE REMOVED SHORTLY AFTER THE SURVEY BY A DISGRUNTLED RELATIVE OF PREVIOUS OWNER ACCORDING TO NEIGHBORS ACCOUNTS. WE RAN AN OPEN RANDOM TRAVERSE INITIATED AT THE WEST 1/4 OF SECTION 28, RUNNING EASTERLY TO THE WAHL ELEVATION BRASS CAP THEN CONTINUING TO THE SOUTHEAST CORNER OF SECTION 27. WE THEN SET UP AND RAN A GPS NETWORK OF THIS SURVEY FOR CONTROL AT EACH OF THE FOUND MONUMENTS FOR CONTROL. WE FOUND A LARGE DIFFERENCE IN CLOSURE FOR HOLT'S MAP BETWEEN THE EAST CORNER OF SECTION 28 AND THE WAHL ELEVATION MARKER. USING OLD FENCE CORNER LOCATIONS AND FOUND 1/4" TO 3/8" (4" TO 8" LONG) IRON PINS (PRESUMABLY SET BY LATER NEIGHBORS "TO ATTEMPT" REESTABLISHMENT OF PROPERTY LINE) WE DETERMINED A SIGNIFICANT BEARING PROBLEM BETWEEN POINTS #18 AND #19. SUBSEQUENT DISCUSSIONS WITH BURTON HOLT LED US TO HERMAN PESKE (L#1651) WHO WAS AN UNLICENSED CREWMAN ON THIS SURVEY IN 1976. PESKE WAS ABLE TO FIND AN ORIGINAL FIELD NOTEBOOK FROM WHICH I WAS ABLE TO USE THE FIELD ANGLES TO COMPUTE AND DETERMINE THE ERROR BETWEEN POINTS #18 AND #19. WE COMPUTED THE BEARING FROM HOLT'S MAP BETWEEN THE WAHL ELEVATION CAP AND THE SOUTHEAST CORNER OF SECTION 27 TO DETERMINE A BASIS OF BEARING. WE THEN USED COMPASS RULE TO BALANCE HOLT'S CORRECTED BEARINGS AND DISTANCES BETWEEN OUR COORDINATES FOR THE FOUND MONUMENTS. WE SET THE CORNERS AS SHOWN HEREON MARKING PROPERTY LINES. THIS SURVEY WAS DONE WITH A NIKON BTM 450 TOTAL STATION WITH A TRIMBLE 4000 SE BASE AND TWO PRO XL PHASE-CARRIER WAVE CAPABLE ROVER GPS RECEIVERS. GARY ANGLETT, MARK DVORSCAK AND IGNACIO ROMAN ASSISTED ME.

REGISTERED  
PROFESSIONAL  
LAND SURVEYOR  
*Ken W. Hoffine*  
OREGON  
2011 # 1897  
KEN W. HOFFINE  
228

EXPIRES 6-30-01

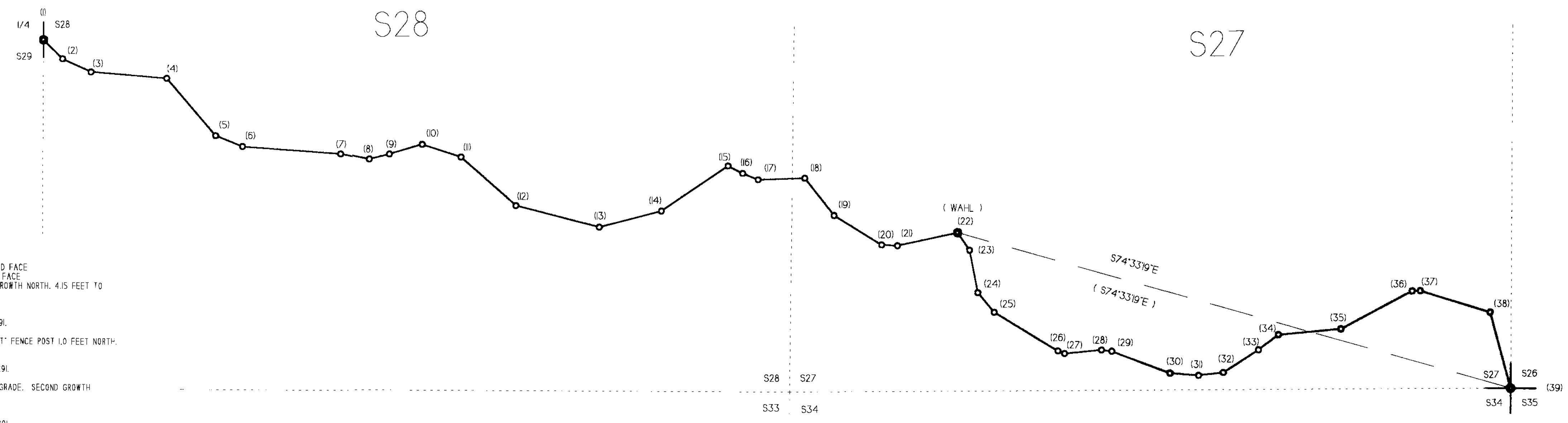

### CORNER INFORMATION

- 1) THE 1/4 CORNER BETWEEN SECTIONS 28 AND 29  
FOUND 1955 DOUGLAS COUNTY COP IN GOOD CONDITION  
-- 10" DOUGLAS FIR BEARS N46 3/4" E. 48.75 FEET (RECORD N48° E. 48.8 FEET), HEALED FACE  
-- 10" DOUGLAS FIR BEARS N76 1/4" W. 19.40 FEET (RECORD N75° W. 19.3 FEET), HEALED FACE  
CORNER LIES ON FLAT RIDGETOP RECENTLY PLANTED CLEARCUT SOUTHWEST. SECOND GROWTH NORTH. 4.15 FEET TO OLD FENCE CORNER.
- 2) PROPERTY CORNER  
SET 5/8" X 1/2" IRON ROD WITH YELLOW PLASTIC CAP MARKED LONE ROCK TIMBER PLS 2291.  
-- 10" DOUGLAS FIR BEARS N47 3/4" E. 30.14 FEET, WE TAG AND SCRIBE "BT".  
CORNER LIES ON FLAT GRASSY RIDGETOP. SECOND GROWTH TIMBER NORTH. SET STEEL "T" FENCE POST 1.0 FEET NORTH.
- 3) PROPERTY CORNER  
SET 5/8" X 3/4" IRON ROD WITH YELLOW PLASTIC CAP MARKED LONE ROCK TIMBER PLS 2291.  
-- 10" DOUGLAS FIR BEARS N48 1/4" E. 33.75 FEET, WE TAG AND SCRIBE "BT".  
CORNER LIES ON FLAT GRASSY RIDGETOP APPROXIMATELY 15 FEET NORTH OF OLD ROAD GRADE. SECOND GROWTH TIMBER NORTH. SET STEEL "T" FENCE POST 1.0 FEET NORTH.
- 4) PROPERTY CORNER  
SET 5/8" X 3/4" IRON ROD WITH YELLOW PLASTIC CAP MARKED LONE ROCK TIMBER PLS 2291.  
-- 10" DOUGLAS FIR BEARS S32 3/4" E. 35.09 FEET, WE TAG AND SCRIBE "BT".  
CORNER LIES ON FLAT GRASSY RIDGETOP. OLD 1/4" IRON ROD FOUND 0.09 FEET FROM SET CORNER. SET STEEL "T" FENCE POST 1.0 FEET NORTH.
- 5) PROPERTY CORNER  
SET 5/8" X 3/4" IRON ROD WITH YELLOW PLASTIC CAP MARKED LONE ROCK TIMBER PLS 2291.  
-- 24" DOUGLAS FIR BEARS S22° W. 13.54 FEET, WE TAG AND SCRIBE "BT".  
CORNER LIES ON FLAT GRASSY RIDGETOP. SECOND GROWTH TIMBER NORTH. SET STEEL "T" FENCE POST 1.0 FEET NORTH.
- 6) PROPERTY CORNER  
SET 5/8" X 3/4" IRON ROD WITH YELLOW PLASTIC CAP MARKED LONE ROCK TIMBER PLS 2291.  
-- 15" DOUGLAS FIR BEARS N41 1/2" E. 75.55 FEET, WE TAG AND SCRIBE "BT".  
CORNER LIES ON FLAT GRASSY RIDGETOP. OLD 1/4" STEEL PIN FOUND 0.1 FEET EAST OF SET CORNER. SET STEEL "T" FENCE POST 1.0 FEET NORTH.
- 7) PROPERTY CORNER  
SET 5/8" X 3/4" IRON ROD WITH YELLOW PLASTIC CAP MARKED LONE ROCK TIMBER PLS 2291.  
-- 8" DOUGLAS FIR BEARS N26 1/2" W. 4.06 FEET, WE TAG AND SCRIBE "BT".  
CORNER LIES ON FLAT GRASSY RIDGETOP. OLD 1/4" STEEL PIN FOUND ALONG SIDE SET CORNER. SET STEEL "T" FENCE POST 1.0 FEET NORTH.
- 8) PROPERTY CORNER  
SET 5/8" X 3/4" IRON ROD WITH YELLOW PLASTIC CAP MARKED LONE ROCK TIMBER PLS 2291.  
-- 7" DOUGLAS FIR BEARS S39 3/4" E. 28.47 FEET, WE TAG AND SCRIBE "BT".  
CORNER LIES ON FLAT RIDGETOP IN SECOND GROWTH TIMBER APPROXIMATELY 4.0 FEET NORTH OF OLD ROAD GRADE. OLD 3/8" IRON ROD FOUND ALONG SIDE SET CORNER. SET STEEL "T" FENCE POST 1.0 FEET NORTH.
- 9) PROPERTY CORNER  
SET 5/8" X 3/4" IRON ROD WITH YELLOW PLASTIC CAP MARKED LONE ROCK TIMBER PLS 2291.  
-- 17" DOUGLAS FIR BEARS S71 3/4" E. 18.89 FEET, WE TAG AND SCRIBE "BT".  
CORNER LIES ON FLAT RIDGETOP APPROXIMATELY 4.0 FEET NORTH OF OLD ROAD GRADE. SET STEEL "T" FENCE POST 1.0 FEET NORTH.
- 10) PROPERTY CORNER  
SET 5/8" X 3/4" IRON ROD WITH YELLOW PLASTIC CAP MARKED LONE ROCK TIMBER PLS 2291.  
-- 19" DOUGLAS FIR BEARS S10 1/4" W. 5.13 FEET, WE TAG AND SCRIBE "BT".  
CORNER LIES ON FLAT RIDGETOP IN SECOND GROWTH TIMBER. OLD 3/8" STEEL ROD BENT INTO LOOP FOUND 0.14 FEET FROM SET CORNER. AN OLD 4" DIAMETER WOOD FENCE POST BEARS WEST 0.6 FEET. SET STEEL "T" FENCE POST 1.0 FEET NORTH.
- 11) PROPERTY CORNER  
SET 5/8" X 3/4" IRON ROD WITH YELLOW PLASTIC CAP MARKED LONE ROCK TIMBER PLS 2291.  
-- 25" DOUGLAS FIR BEARS N80° W. 48.13 FEET, WE TAG AND SCRIBE "BT".  
CORNER LIES ON EAST SIDE OF RIDGETOP KNOB. SET STEEL "T" FENCE POST 1.0 FEET NORTH.
- 12) PROPERTY CORNER  
SET 5/8" X 3/4" IRON ROD WITH YELLOW PLASTIC CAP MARKED LONE ROCK TIMBER PLS 2291.  
-- 18" DOUGLAS FIR BEARS N1/4" E. 45.42 FEET, WE TAG AND SCRIBE "BT".  
CORNER LIES 70 FEET SOUTH OF RIDGETOP ON NORTH EDGE OF OLD ROAD GRADE IN PASTURE. OLD 3/8" STEEL ROD FOUND N78° E. 0.28 FEET FROM SET CORNER. SET STEEL "T" FENCE POST 1.0 FEET NORTH.
- 13) PROPERTY CORNER  
SET 5/8" X 3/4" IRON ROD WITH YELLOW PLASTIC CAP MARKED LONE ROCK TIMBER PLS 2291.  
-- 17" DOUGLAS FIR BEARS N45 1/2" E. 13.39 FEET, WE TAG AND SCRIBE "BT".  
CORNER LIES IN PASTURE WITH SCATTERED HARDWOODS. OLD 3/8" STEEL ROD FOUND N25° E. 0.28 FEET FROM SET CORNER. SET STEEL "T" FENCE POST 1.0 FEET NORTH.
- 14) PROPERTY CORNER  
SET 5/8" X 3/4" IRON ROD WITH YELLOW PLASTIC CAP MARKED LONE ROCK TIMBER PLS 2291.  
-- 18" DOUGLAS FIR BEARS N51° E. 30.12 FEET, WE TAG AND SCRIBE "BT".  
CORNER LIES ON RIDGETOP IN PASTURE. OLD 3/8" IRON ROD FOUND N50° E. 0.45 FEET FROM SET CORNER. SET STEEL "T" FENCE POST 1.0 FEET NORTH.
- 15) PROPERTY CORNER  
SET 5/8" X 3/4" IRON ROD WITH YELLOW PLASTIC CAP MARKED LONE ROCK TIMBER PLS 2291.  
-- 24" DOUGLAS FIR BEARS N75° E. 20.16 FEET, WE TAG AND SCRIBE "BT".  
CORNER LIES NEAR NORTH EDGE OF FLAT RIDGETOP. OLD 3/8" STEEL ROD FOUND N1° E. 0.29 FEET FROM SET CORNER. SET STEEL "T" FENCE POST 1.0 FEET NORTH.
- 16) PROPERTY CORNER  
SET 5/8" X 3/4" IRON ROD WITH YELLOW PLASTIC CAP MARKED LONE ROCK TIMBER PLS 2291.  
-- 7" DOUGLAS FIR BEARS S22 1/4" E. 99.33 FEET, WE TAG AND SCRIBE "BT".  
CORNER LIES ON FLAT RIDGETOP. SET STEEL "T" FENCE POST 1.0 FEET NORTH.

- 17) PROPERTY CORNER  
SET 5/8" X 3/4" IRON ROD WITH YELLOW PLASTIC CAP MARKED LONE ROCK TIMBER PLS 2291.  
-- 9" DOUGLAS FIR BEARS S71 1/2" E. 57.62 FEET, WE TAG AND SCRIBE "BT".  
CORNER LIES 20 FEET NORTH OF RIDGETOP AT NORTH EDGE OF OLD ROAD GRADE. SET STEEL "T" FENCE POST 1.0 FEET NORTH.
- 18) PROPERTY CORNER  
SET 5/8" X 1/2" IRON ROD WITH YELLOW PLASTIC CAP MARKED LONE ROCK TIMBER PLS 2291.  
-- 8" DOUGLAS FIR BEARS S55° W. 105.57 FEET, WE TAG AND SCRIBE "BT".  
CORNER LIES ON ROCK RIDGETOP WITH THIN SOIL. OLD FENCE POST HOLE FOUND 6.4 FEET FROM SET CORNER. SET STEEL "T" FENCE POST 1.0 FEET NORTH.
- 19) PROPERTY CORNER  
SET 5/8" X 3/4" IRON ROD WITH YELLOW PLASTIC CAP MARKED LONE ROCK TIMBER PLS 2291.  
-- 20" DOUGLAS FIR BEARS N9° W. 10.43 FEET, WE TAG AND SCRIBE "BT".  
CORNER LIES APPROXIMATELY 50 FEET SOUTH OF RIDGETOP ON NORTH EDGE OF OLD ROAD GRADE. SET STEEL "T" FENCE POST 1.0 FEET NORTH.
- 20) PROPERTY CORNER  
SET 5/8" X 1/2" IRON ROD WITH YELLOW PLASTIC CAP MARKED LONE ROCK TIMBER PLS 2291.  
-- 11" OAK BEARS N42 1/2" W. 22.82 FEET, WE TAG AND SCRIBE "BT".  
CORNER LIES APPROXIMATELY 50 FEET SOUTH OF RIDGETOP ON NORTH EDGE OF OLD ROAD GRADE. GRASS WITH SCATTERED HARDWOODS.
- 21) PROPERTY CORNER  
SET 5/8" X 3/4" IRON ROD WITH YELLOW PLASTIC CAP MARKED LONE ROCK TIMBER PLS 2291.  
-- 27" DOUGLAS FIR BEARS S40 1/2" W. 44.36 FEET, WE TAG AND SCRIBE "BT".  
CORNER LIES ON RIDGETOP. OLD 3/8" STEEL ROD FOUND S64° W. 0.5 FEET FROM SET CORNER. SET STEEL "T" FENCE POST 1.0 FEET NORTH.
- 22) ELEVATION MARKER  
FOUND 1971 DOUGLAS COUNTY SURVEYOR'S BRASS CAP SET IN 11" X 11" CONCRETE.  
-- COUNTY SURVEYOR'S REFERENCE MARK. 1971 BRASS CAP SET IN 11" X 11" CONCRETE BEARS S36° W. 24.9 FEET  
(BY TAPE AND HAND COMPASS) MARKED R.M. I. (NO RECORD)  
-- COUNTY SURVEYOR'S REFERENCE MARK. 1971 BRASS CAP SET IN 11" X 11" CONCRETE BEARS S50° E. 3.11 FEET  
(BY TAPE AND HAND COMPASS) MARKED R.M. 2. (NO RECORD)  
CORNER LIES ON TOP OF GRASSY KNOB. AN OLD FENCE IS N45° E. 3.5 FEET. FENCE RUNS NORTHWEST/SOUTHEAST.
- 23) PROPERTY CORNER  
SET 5/8" X 3/4" IRON ROD WITH YELLOW PLASTIC CAP MARKED LONE ROCK TIMBER PLS 2291.  
-- 25" DOUGLAS FIR WITH DEAD TOP BEARS N25 1/2" W. 34.89 FEET, WE TAG AND SCRIBE "BT".  
CORNER LIES ON EAST SIDE OF RIDGETOP KNOB. SET STEEL "T" FENCE POST 1.0 FEET NORTH.
- 24) PROPERTY CORNER  
SET 5/8" X 3/4" IRON ROD WITH YELLOW PLASTIC CAP MARKED LONE ROCK TIMBER PLS 2291.  
-- 18" DOUGLAS FIR BEARS S77 3/4" E. 34.32 FEET, WE TAG AND SCRIBE "BT".  
CORNER LIES ON EAST SIDE OF OLD RIDGETOP ROAD GRADE. SET STEEL "T" FENCE POST 1.0 FEET NORTH.
- 25) PROPERTY CORNER  
SET 5/8" X 3/4" IRON ROD WITH YELLOW PLASTIC CAP MARKED LONE ROCK TIMBER PLS 2291.  
-- 10" DOUGLAS FIR BEARS N61 1/2" E. 39.00 FEET, WE TAG AND SCRIBE "BT".  
CORNER LIES ON EAST EDGE OF OLD RIDGETOP ROAD GRADE. SET STEEL "T" FENCE POST 1.0 FEET NORTH.
- 26) PROPERTY CORNER  
SET 5/8" X 3/4" IRON ROD WITH YELLOW PLASTIC CAP MARKED LONE ROCK TIMBER PLS 2291.  
-- 15" DOUGLAS FIR BEARS N31 3/4" E. 10.69 FEET, WE TAG AND SCRIBE "BT".  
CORNER LIES ON NORTH EDGE OF OLD RIDGETOP ROAD GRADE. SET STEEL "T" FENCE POST 1.0 FEET NORTH.
- 27) PROPERTY CORNER  
SET 5/8" X 3/4" IRON ROD WITH YELLOW PLASTIC CAP MARKED LONE ROCK TIMBER PLS 2291.  
-- 17" DOUGLAS FIR BEARS N61 1/2" E. 39.00 FEET, WE TAG AND SCRIBE "BT".  
CORNER LIES ON NORTH EDGE OF OLD RIDGETOP ROAD GRADE. SET STEEL "T" FENCE POST 1.0 FEET NORTH.
- 28) PROPERTY CORNER  
SET 5/8" X 3/4" IRON ROD WITH YELLOW PLASTIC CAP MARKED LONE ROCK TIMBER PLS 2291.  
-- 15" DOUGLAS FIR BEARS N8 1/4" E. 43.33 FEET, WE TAG AND SCRIBE "BT".  
CORNER LIES ON FLAT RIDGETOP. SET STEEL "T" FENCE POST 1.0 FEET NORTH.
- 29) PROPERTY CORNER  
SET 5/8" X 3/4" IRON ROD WITH YELLOW PLASTIC CAP MARKED LONE ROCK TIMBER PLS 2291.  
-- 20" BLACK OAK BEARS N41° E. 15.49 FEET, WE TAG AND SCRIBE "BT".  
CORNER LIES ON SOUTH SIDE OF RIDGETOP. SET STEEL "T" FENCE POST 1.0 FEET NORTH.

- 30) PROPERTY CORNER  
SET 5/8" X 3/4" IRON ROD WITH YELLOW PLASTIC CAP MARKED LONE ROCK TIMBER PLS 2291.  
-- 20" DOUGLAS FIR BEARS N49 1/2" E. 18.01 FEET, WE TAG AND SCRIBE "BT".  
CORNER LIES ON NORTH EDGE OF OLD RIDGETOP ROAD GRADE. SET STEEL "T" FENCE POST 1.0 FEET NORTH.
- 31) PROPERTY CORNER  
SET 5/8" X 3/4" IRON ROD WITH YELLOW PLASTIC CAP MARKED LONE ROCK TIMBER PLS 2291.  
-- 12" DOUGLAS FIR BEARS N29 3/4" E. 27.89 FEET, WE TAG AND SCRIBE "BT".  
CORNER LIES ON NORTH EDGE OF OLD RIDGETOP ROAD GRADE. SET STEEL "T" FENCE POST 1.0 FEET NORTH.
- 32) PROPERTY CORNER  
SET 5/8" X 3/4" IRON ROD WITH YELLOW PLASTIC CAP MARKED LONE ROCK TIMBER PLS 2291.  
-- 18" DOUGLAS FIR BEARS N49 3/4" E. 28.31 FEET, WE TAG AND SCRIBE "BT".  
CORNER LIES ON NORTH EDGE OF OLD RIDGETOP ROAD GRADE. SET STEEL "T" FENCE POST 1.0 FEET NORTH.
- 33) PROPERTY CORNER  
SET 5/8" X 3/4" IRON ROD WITH YELLOW PLASTIC CAP MARKED LONE ROCK TIMBER PLS 2291.  
-- NO SUITABLE BEARING TREES NEARBY  
CORNER LIES ON NORTH EDGE OF OLD RIDGETOP ROAD GRADE. SET STEEL "T" FENCE POST 1.0 FEET NORTH.
- 34) PROPERTY CORNER  
SET 5/8" X 3/4" IRON ROD WITH YELLOW PLASTIC CAP MARKED LONE ROCK TIMBER PLS 2291.  
-- NO SUITABLE BEARING TREES NEARBY  
CORNER LIES ON NORTH CUT BANK OF OLD RIDGE ROAD. OLD 3/8" STEEL ROD FOUND N22° E. 1.33 FEET FROM SET CORNER. SET STEEL "T" FENCE POST 1.0 FEET NORTH.
- 35) PROPERTY CORNER  
SET 5/8" X 3/4" IRON ROD WITH YELLOW PLASTIC CAP MARKED LONE ROCK TIMBER PLS 2291.  
-- 12" DOUGLAS FIR BEARS S48 3/4" E. 40.32 FEET, WE TAG AND SCRIBE "BT".  
FOUND OLD BENT 5/8" IRON ROD N3 1/2" E. 1.55 FEET. CORNER LIES APPROXIMATELY 10 FEET NORTH OF OLD RIDGETOP ROAD GRADE. SET STEEL "T" FENCE POST 1.0 FEET NORTH.
- 36) PROPERTY CORNER  
SET 5/8" X 3/4" IRON ROD WITH YELLOW PLASTIC CAP MARKED LONE ROCK TIMBER PLS 2291.  
-- 10" DOUGLAS FIR BEARS S1 1/4" E. 36.52 FEET, WE TAG AND SCRIBE "BT".  
CORNER LIES ON GRASSY RIDGETOP KNOB APPROXIMATELY 15 FEET NORTH OF OLD ROAD GRADE. SET STEEL "T" FENCE POST 1.0 FEET NORTH.
- 37) PROPERTY CORNER  
SET 5/8" X 3/4" IRON ROD WITH YELLOW PLASTIC CAP MARKED LONE ROCK TIMBER PLS 2291.  
-- 17" DOUGLAS FIR BEARS S14 1/2" W. 49.88 FEET, WE TAG AND SCRIBE "BT".  
CORNER LIES ON RIDGETOP APPROXIMATELY 14.5 FEET SOUTH OF OLD RIDGETOP FENCE LINE. SET STEEL "T" FENCE POST 1.0 FEET NORTH.
- 38) PROPERTY CORNER  
SET 5/8" X 3/4" IRON ROD WITH YELLOW PLASTIC CAP MARKED LONE ROCK TIMBER PLS 2291.  
-- 17" DOUGLAS FIR BEARS S37 1/2" E. 37.39 FEET, WE TAG AND SCRIBE "BT".  
CORNER LIES ON RIDGETOP. AN OLD FENCE CORNER BEARS N01° E. 2.1 FEET. FENCE RUNS SOUTHEASTERLY AND WESTERLY. WITNESS ROD IS IN SOUTHEASTERLY FENCE LINE. AN OLD 1/4" STEEL ROD IS 0.73 FEET NORTH OF SET CORNER.
- 39) SECTION CORNER COMMON TO SECTIONS 27, 28, 34, 35, TOWNSHIP 25S, R5W  
FOUND 1960 C.S. BRASS CAP ON 1 1/2" IRON PIPE PROJECTING IN ABOVE GROUND.  
-- 27" DOUGLAS FIR BEARS S66° W. 73.5 FEET (AS PER RECORD)  
-- 23" DOUGLAS FIR BEARS N23° W. 75.3 FEET (AS PER RECORD)  
-- 22" DOUGLAS FIR BEARS N07° E. 148.1 FEET (AS PER RECORD)  
CORNER LIES ON SOUTH FACING SLOPE IN OLD FENCE LINE APPROXIMATELY 100 FEET SOUTH OF OLD ROAD GRADE. FENCE RUNS NORTHERLY AND SOUTHERLY.

- LEGEND:
- - FOUND MONUMENT
  - - SET 5/8" IRON ROD WITH YELLOW PLASTIC CAP
  - - LINES FLAGGED, BLAZED & TAGGED
  - - PROJECTED COMPUTED LINE
  - - PROJECTED APPROXIMATE SECTION LINE
  - ( ) - COMPUTED BEARING FROM HOLT MAP M 56/65

LABEL	BEARING	DISTANCE	RECORD BEARING	RECORD DISTANCE
1	S45°22'53"E	196.314	S45°23'19"E	196.160
2	S85°23'35"E	227.510	S85°24'04"E	227.510
3	S85°24'37"E	553.263	S85°25'09"E	553.400
4	S40°42'23"E	548.953	S40°43'04"E	548.470
5	S68°24'25"E	211.866	S68°25'09"E	211.640
6	S85°57'57"E	713.753	S85°58'44"E	713.940
7	S78°50'46"E	208.051	S78°51'39"E	208.050
8	N75°50'06"E	150.354	N75°49'06"E	150.480
9	N73°15'01"E	248.930	N73°14'01"E	249.100
10	S72°08'46"E	126.632	S72°09'54"E	126.800
11	S48°40'14"E	534.151	S48°41'29"E	533.780
12	S75°52'06"E	625.888	S75°53'24"E	625.880
13	N75°17'51"E	467.574	N75°16'31"E	467.910
14	N55°36'50"E	585.855	N55°35'36"E	586.520
15	S63°22'05"E	120.120	S63°23'29"E	120.080
16	S68°05'25"E	121.880	S68°06'54"E	121.830
17	N87°50'02"E	339.494	N87°49'31"E	339.640
18	S38°35'33"E	345.570	S38°33'26"E	345.200
19	S58°48'25"E	405.530	S58°46'21"E	405.350
20	S87°45'27"E	115.427	S87°43'26"E	115.460
21	N77°35'38"E	447.790	N77°37'29"E	448.090
22	S34°50'32"E	153.449	S34°50'36"E	153.450
23	S11°16'33"E	315.610	S11°16'41"E	315.630
24	S40°16'42"E	185.997	S40°16'46"E	186.000
25	S38°55'29"E	542.228	S38°55'31"E	542.240
26	S69°00'37"E	52.149	S69°00'46"E	52.150
27	N84°18'16"E	270.750	N84°18'19"E	270.760
28	S83°51'57"E	75.854	S83°51'46"E	75.860
29	S69°28'14"E	452.231	S69°28'16"E	452.230
30	S85°52'28"E	208.570	S85°52'31"E	208.570
31	N83°16'46"E	81.615	N83°16'49"E	81.620
32	N56°48'02"E	304.559	N56°48'09"E	304.570
33	N52°30'09"E	182.761	N52°30'14"E	182.760
34	N84°21'46"E	458.858	N84°21'49"E	458.860
35	N61°40'29"E	586.778	N61°40'31"E	586.800
36	N88°10'07"E	59.822	N88°10'46"E	59.820
37	S73°13'30"E	531.443	S73°13'35"E	531.470
38	S15°23'34"E	574.279	S15°23'37"E	574.290