

COUNTY SURVEYORS FILE DATA  
DO NOT REMOVE FROM OFFICE

**W&H PACIFIC**  
8405 S.W. NIMBUS AVENUE  
BEAVERTON, OREGON 97008  
(503) 626-0455

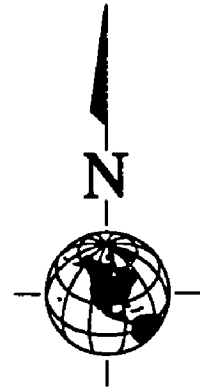

SHEET 1 IS INTENDED FOR A GRAPHIC REPRESENTATION OF THE SHEET LAYOUT AND IS NOT TO SCALE

**RECORD OF SURVEY  
RIGHT-OF-WAY OF CANYONVILLE  
TRAIL HIGHWAY (CO. RD. NO. 1)**

LOCATED IN THE NORTH HALF OF SECTION 32 AND THE NORTH HALF OF SECTION 33  
IN TOWNSHIP 30 SOUTH, RANGE 2 WEST OF THE WILLAMETTE MERIDIAN  
IN DOUGLAS COUNTY, OREGON

NOT TO SCALE

DATE: 1/15/99

FILED DATE: 5-11-99 BY: JP  
THIS SURVEY CONSISTS OF: 4 Pages  
Map: M129-42A  
Narrative: \_\_\_\_\_  
Corner Rpt. \_\_\_\_\_  
DOUGLAS COUNTY SURVEYOR

**INDEX**

- SHEET 1 - INDEX, OVERALL SITE MAP, NARRATIVE.
- SHEET 2 - BEGIN PROJECT 36+100 TO 36+900
- SHEET 3 - 36+900 TO 37+700
- SHEET 4 - 37+700 TO END PROJECT 38+450

30 29

31 32

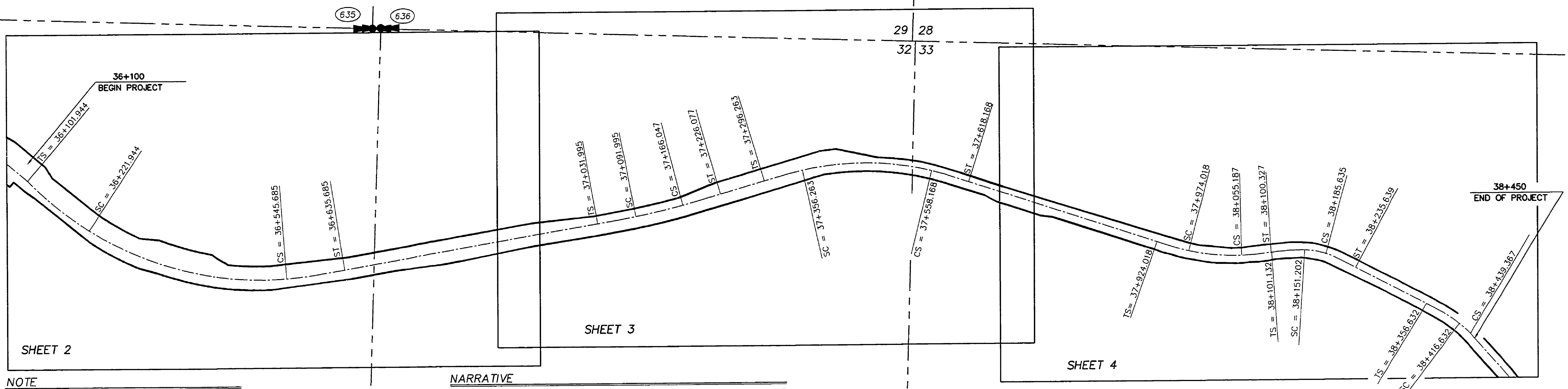

**NOTE**

1. INITIAL CONTROL WAS ESTABLISHED BY FHWA IN 1986. THE CLOSURES OF THAT CONTROL WERE IN ACCORDANCE WITH FHWA STANDARDS. THIS CONTROL WAS USED TO PERFORM THE FIELD SURVEY BY W&H PACIFIC. WE VERIFIED POSITIONAL RELATIONSHIPS THROUGH MEASUREMENTS FORWARD AND BACK AND FOUND IT TO BE ACCEPTABLE. THE RELATIONSHIP OF THE ROADWAY CENTER LINE TO THE EXISTING CONTROL IS AS ESTABLISHED BY FHWA. THE CONTROL WAS UTILIZED TO RECOVER AND LOCATE MONUMENTATION AS SHOWN ON THIS SURVEY.
2. THE PROPOSED RIGHT-OF-WAY AS DEPICTED HEREON IS SHOWN FOR INFORMATIONAL PURPOSES ONLY. FOR RIGHT-OF-WAY INFORMATION PLEASE SEE RIGHT-OF-WAY PLANS AS DEVELOPED BY THE FEDERAL HIGHWAY ADMINISTRATION AND DOUGLAS COUNTY PUBLIC WORKS.
3. THE CONTROL MONUMENTS AS SHOWN ARE WITHIN THE CONSTRUCTION ZONE AND ARE NOT INTENDED TO REMAIN A PERMANENT REFERENCE TO THE CENTER LINE ALIGNMENT.
4. INSTRUMENTATION USED FOR THIS SURVEY WERE 1 SECOND LEICA TOTAL STATIONS WITH A FORWARD AND DIRECT OBSERVATION TO EACH MONUMENT.
5. RECORD INFORMATION IS AVAILABLE FROM:  
  
U.S. DEPARTMENT OF TRANSPORTATION  
FEDERAL HIGHWAY ADMINISTRATION  
WESTERN FEDERAL LANDS HIGHWAY DIVISION  
610 E. 5TH AVE.  
VANCOUVER, WA. 98661

**NARRATIVE**

1. THE PURPOSE OF THIS SURVEY IS TO LOCATE AND REFERENCE EXISTING MONUMENTS, RECOVER THIS SURVEY, BOTH RECORD AND NON-RECORD IN ORIGIN THAT ARE NEAR OR WITHIN PROPOSED AREAS OF CONSTRUCTION INSIDE THE NEWLY ACQUIRED RIGHT-OF-WAY, AS SHOWN ON U.S. DEPARTMENT OF TRANSPORTATION, FEDERAL HIGHWAY ADMINISTRATION, RIGHT-OF-WAY MAP ENTITLED CANYONVILLE-TRAIL HIGHWAY-OREGON FOREST HIGHWAY PROJECT PHF 16-1(1) DATED JULY, 1998.
2. COORDINATES ARE A LOCAL COORDINATE SYSTEM BASED ON THE FEDERAL HIGHWAY ADMINISTRATION CONTROL SURVEY. BEARINGS ARE BASED UPON THIS COORDINATE SYSTEM. (SEE NOTE BELOW).

**LEGEND**

- TS TANGENT TO SPIRAL
- SC SPIRAL TO CURVE
- CS CURVE TO SPIRAL
- ST SPIRAL TO TANGENT
- APARENT SECTION LINES
- NEWLY ACQUIRED RIGHT-OF-WAY LINE
- CENTERLINE OF ROADWAY
- APPARENT 1/4 CORNER PER FHWA RIGHT-OF-WAY PLANS PFH 16-1(4). NOT RECOVERED THIS SURVEY.
- (XXX) MONUMENT LOCATIONS PER FHWA RIGHT-OF-WAY PLANS PFH 16-1(4). SEE MONUMENT TABLE BELOW.

NOTE: ALL STATIONS AND OFFSETS ARE SHOWN IN METERS

**MONUMENT TABLE**

POINT NO.	STATION	OFFSET	DESCRIPTION	ORIGIN OR FIRST RECORD
635	36+781.959	341.238 LT	3" BRASS CAP	M 121-77
636	36+790.577	339.391 LT	3" BRASS CAP	M 121-77

REGISTERED PROFESSIONAL LAND SURVEYOR  
JACK A. BUTLER  
OREGON  
MAY 21, 1992  
2550  
RENEWAL: 12-31-00