

BOUNDARY SURVEY  
FOR  
SENECA JONES TIMBER COMPANY  
IN  
SECTION 32, T20S, R6W, W.M.  
DOUGLAS COUNTY, OREGON  
BY  
ROBERTS SURVEYING INC.  
P.O. BOX 7155  
EUGENE, OREGON 97401  
PHONE 345-1112

FILED  
Date: 11-25-97 By: PJC  
This survey consists of:  
Map: M 127 - 70  
Narrative: \_\_\_\_\_  
Corner Rpt: \_\_\_\_\_  
DOUGLAS COUNTY  
SURVEYOR

MAP FILE M 127 - 70

LEGEND,

- MONUMENTS FOUND AND USED FOR CONTROL
- MONUMENTS SET - NO MONUMENTS SET IN THIS SURVEY.
- ( ) DATA OF RECORD - 1872 G.L.O. SURVEY AND SURVEY M3-23 BY WILFORD HAINES IN 1956.
- //— BASIS OF BEARING - LINE "A-B" FROM SURVEY M3-23
- //— LINES MARKED WITH RED PAINTED BLAZES, RED PLASTIC RIBBON AND GREEN METAL FENCE POSTS.
- DISTANCES TO BEARING TREES ARE CENTER MEASURE
- ALL NEW B.T.'S ARE SCRIBED AND HAVE A METAL WASHER MARKED P.L.S. 1039 NAILED TO LOWER BLAZE
- ROAD = - - - - - RIDGE = ~~~~~ DRAW OR CK. —>

NARRATIVE, THE PURPOSE OF THIS SURVEY IS TO BLAZE AND POST THE SOUTH 1/2 OF THE EAST LINE AND THE ENTIRE SOUTH LINE OF SAID SECTION 32. THE EAST 1/4 CORNER, THE S.E. SECTION CORNER, THE SOUTH 1/4 CORNER AND THE S.W. SECTION CORNER WERE FOUND IN THE FIELD AND USED AS CONTROL FOR THIS SURVEY. A CLOSED RANDOM PROPERTY LINE TRAVERSE, USING A WILD T-16 THEODOLITE AND A DI-4L E.D.M., WAS RUN ALONG THE PROPERTY LINES TO BE BLAZED AND POSTED. OFFSETS WERE COMPUTED FROM THIS PROPERTY LINE TRAVERSE TO THE TRUE PROPERTY LINE. PROPERTY LINES WERE MARKED WITH RED PAINTED BLAZES, RED PLASTIC RIBBON AND GREEN METAL FENCE POSTS.

"A" EAST 1/4 CORNER SECTION 32

- FD. "T" IRON SET BY WILFORD HAINES IN SURVEY M3-23
- 50" DOWNED FIR, N01°W, 33.0' (NO MARKS), 1872 B.T.
- SET 6" FIR, S07°W, 11.6' (SCRIBED/METAL WASHER/PAINTED RED)
- 6" FIR, S71°E, 13.5' (SCRIBED/METAL WASHER/PAINTED RED)

"B" S.E. CORNER SECTION 32

- FD. "T" IRON SET BY WILFORD HAINES IN SURVEY M3-23
- 6" FIR SNAG, N16°E, 13.3' (SCRIBE VIS.), 1956 B.T.
- 12" FIR, N35°W, 16.0' (SCAR VIS.), 1956 B.T.
- 12" FIR, S55°W, 9.4' (SCAR VIS.), 1956 B.T.
- SET 8" FIR, N04°E, 11.6' (SCRIBED/WASHER/PAINTED RED)

"C" SOUTH 1/4 CORNER SECTION 32 ONLY

- FD. "T" IRON SET BY WILFORD HAINES IN SURVEY M3-23
- 60" FIR STUMP, N32°W, 50.0' (NO MARKS), 1956 B.T.
- "X" IN BEDROCK, S24°W, 3.8', 1956 B.O.
- SET 6" FIR, S47°W, 5.4' (SCRIBED/WASHER/PAINTED RED)
- 8" MAPLE, N60°W, 9.2' (SCRIBED/WASHER/PAINTED RED)

"D" S.W. CORNER SECTION 32

- FD. "T" IRON SET BY WILFORD HAINES IN SURVEY M3-23
- 48" FIR STUMP, N25°E, 151.0' (SCAR VIS.), 1956 B.T.
- 52" FIR STUMP, N32°W, 115.0' (SCAR VIS.), 1956 B.T.
- SET 6" FIR, N26°E, 15.2' (SCRIBED/WASHER/PAINTED RED)
- 8" FIR, N57°W, 14.9' (SCRIBED/WASHER/PAINTED RED)

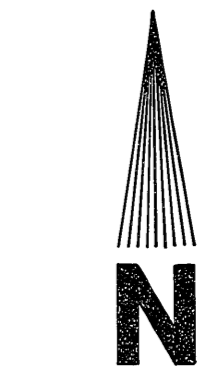
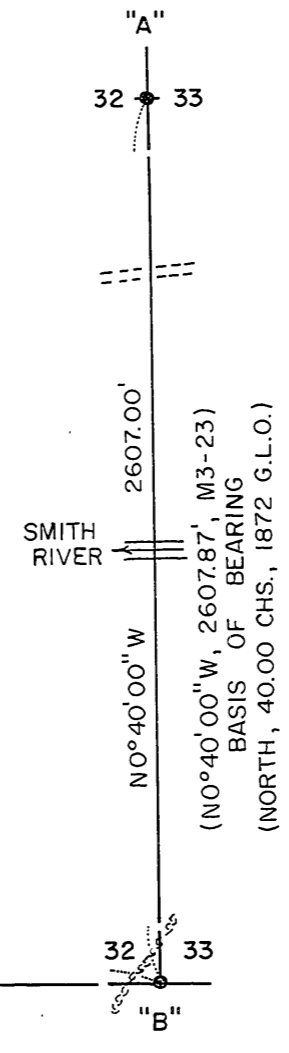

SCALE 1" = 500'  
NOVEMBER 11, 1997

REGISTERED  
PROFESSIONAL  
LAND SURVEYOR

*L. D. Roberts*

OREGON  
AUGUST 1975  
L. D. ROBERTS  
1039

EXPIRES 12-31-98

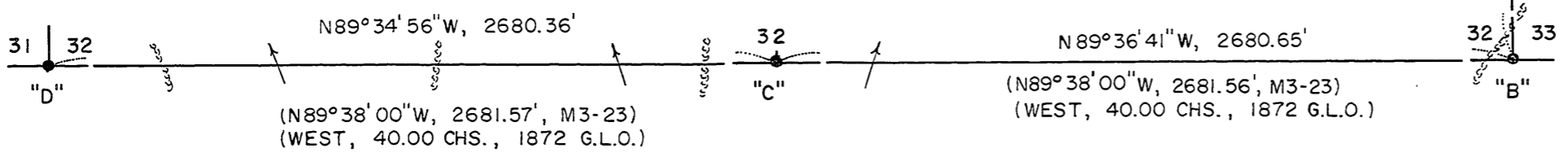

COUNTY SURVEYORS FILE DATA  
DO NOT REMOVE FROM OFFICE

MAP FILE M 127 - 70