

SURVEYED BY:  
FORT UMPQUA LAND SURVEYING  
PO BOX 699  
SUTHERLIN, OREGON 97479  
(503) 746-1898 (503) 459-9529  
WILLIAM O. BECKLEY, PLS 2417

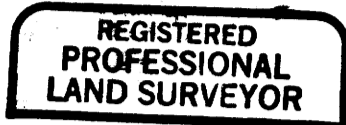

OREGON  
JANUARY 23, 1990  
WILLIAM O. BECKLEY  
2417  
EXPIRES 12-31-95

### PARTITION PLAT NO.

PARTITION PLAT FOR MARGIE RIDDLE  
OF TAX LOT 800 ASSESSORS MAP 225 7W 19B, DEED 79-08262  
IN THE NW 1/4 SECTION 19, T22S, R7W, WILLAMETTE MERIDIAN  
COUNTY OF DOUGLAS, STATE OF OREGON.  
11 MARCH 1995

FILED  
Date: 1-27-97 By: JP  
This survey consists of:  
Map: M126-30 AFB  
Narrative:  
Corner Rpt:

DOUGLAS COUNTY  
SURVEYOR

#### DECLARATION

KNOW ALL PEOPLE BY THESE PRESENTS THAT MARGIE RIDDLE IS THE OWNER OF THE LAND REPRESENTED ON THE ANNEXED PLAT AND MORE PARTICULARLY DESCRIBED IN THE ACCOMPANYING SURVEYORS CERTIFICATE AND HAS CAUSED THE SAME TO BE PARTITIONED AS SHOWN ON THIS LAND PARTITION PLAT IN ACCORDANCE WITH THE PROVISIONS OF CHAPTER 92 OF OREGON REVISED STATUTES.

Margie Riddle  
MARGIE RIDDLE

#### ACKNOWLEDGEMENT:

STATE OF OREGON )  
                          ) SS  
COUNTY OF DOUGLAS )

KNOW ALL PEOPLE BY THESE PRESENTS: THAT ON THIS 12<sup>th</sup>

DAY OF July 1995, BEFORE ME, A NOTARY PUBLIC IN AND FOR SAID STATE AND COUNTY, DID PERSONALLY APPEAR MARGIE RIDDLE, WHO BEING DULY SWORN, DID SAY THAT SHE IS THE IDENTICAL PERSON NAMED IN THE FOREGOING INSTRUMENT AND EXECUTED SAID INSTRUMENT FREELY AND VOLUNTARILY.

Linda Dee Higgins  
NOTARY PUBLIC, STATE OF OREGON

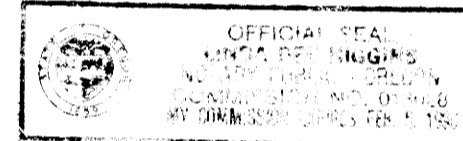

#### APPROVALS

I HEREBY CERTIFY THAT ALL TAXES AND SPECIAL ASSESSMENTS OR OTHER CHARGES REQUIRED BY LAW, HAVE BEEN PAID.

APPROVED \_\_\_\_\_ 1995

BY \_\_\_\_\_  
DOUGLAS COUNTY TAX COLLECTOR

APPROVED: \_\_\_\_\_ 1995

BY \_\_\_\_\_  
DOUGLAS COUNTY PLANNING DIRECTOR

APPROVED: \_\_\_\_\_ 1995

BY \_\_\_\_\_  
DOUGLAS COUNTY SURVEYOR

#### SURVEYORS CERTIFICATE

I, WILLIAM O. BECKLEY, A REGISTERED PROFESSIONAL LAND SURVEYOR IN THE STATE OF OREGON, DO HEREBY CERTIFY THAT I HAVE CORRECTLY SURVEYED AND MARKED WITH PROPER MONUMENTS THE LAND SHOWN ON THE ANNEXED PLAT AND THAT SAID LAND IS DESCRIBED AS FOLLOWS:

BEGINNING AT A FOUND BRASS CAP PER M86-29 AT THE SW CORNER OF THE J. SCOTT D.L.C. NO. 41, T22S, R7W, W.M.; THENCE S89°13'46"E 46.00' TO THE INITIAL POINT A SET 5/8" IRON ROD WITH YPC INSCRIBED "FORT UMPQUA PLS 2417" AND THE TRUE POINT OF BEGINNING; THENCE S89°13'46"E 394.92' TO A SET 5/8" IRON ROD WITH YPC INSCRIBED "FORT UMPQUA PLS 2417"; THENCE S34°13'23"W 718.59' TO A SET 5/8" IRON ROD WITH YPC INSCRIBED "FORT UMPQUA PLS 2417"; THENCE N49°16'24"W 203.49' TO A FOUND 1/2" IRON PIPE; THENCE N40°37'10"E 35.43' TO A FOUND 5/8" IRON ROD; THENCE N49°27'00"W 155.97' TO A FOUND 5/8" IRON ROD WITH YPC INSCRIBED "LS 1076"; THENCE N37°25'08"E 426.12' TO THE TRUE POINT OF BEGINNING. CONTAINING 4.48 ACRES. ALL IN THE NW 1/4 SECTION 19, T22S, R7W, WILLAMETTE MERIDIAN, COUNTY OF DOUGLAS, STATE OF OREGON.

William O. Beckley  
WILLIAM O. BECKLEY, PLS 2417

FILED THIS \_\_\_\_\_ DAY OF \_\_\_\_\_ 1995

By \_\_\_\_\_  
DOUGLAS COUNTY CLERK

By \_\_\_\_\_  
DEPUTY

MAP FILE M126-30B

1-29-97  
JLM

FILED AS SURVEY ONLY.  
NOT APPROVED AS PARTITION.

MAP FILE M126-30B