



PROPERTY SURVEY FOR MENASHA CORPORATION

LOCATED IN SECTION 22, T. 29 S., R. 9 W., W. M.

NARRATIVE

THE PURPOSE OF THIS SURVEY WAS TO ESTABLISH THE PROPERTY LINES AND CORNERS FOR MENASHA CORPORATION IN SECTION 22, TOWNSHIP 29 SOUTH, RANGE 9 WEST, W.M., DOUGLAS COUNTY, OREGON. THE SECTION WAS SUBDIVIDED FOLLOWING THE 1973 BLM MANUAL OF INSTRUCTIONS. EQUIPMENT USED WAS A NIKON DTM A5 TOTAL STATION WITH DATA COLLECTOR AND TRIMBLE 4000ST GPS RECEIVERS. BASIS OF BEARINGS WAS BY SOLAR OBSERVATION USING THE HOUR ANGLE METHOD. CORNERS USED FOR CONTROL ARE THE FOUR FOUND 1/4 SECTION CORNERS.

ALL MEASUREMENTS TO BEARING TREES ESTABLISHED THIS SURVEY ARE TO A SPIKE SET IN THE SIDE CENTER OF THE TREE, AND ANGLES WERE MEASURED TO THE CENTER OF THE TREE. A TAG WAS ATTACHED TO THE TREE FACING THE CORNER. THE PROPERTY LINES WERE BLAZED AND PAINTED ORANGE.

1/4 SEC. CORNER TO SECTIONS 15 & 22
FOUND 1" IRON PIPE WITH 2" COUNTY SURVEYOR'S BRASS CAP
MARKED "T29S R9W 1/4 S15 S22 1959" SET IN SANDSTONE LEDGE.
B.T.'S
COUNTY SURVEYOR'S 18", NOW 27" CEDAR, S 55 1/2° E, 42.7'
ORIG. 50" FIR, NOW BURNT FIR STUMP, NO VISIBLE MARKS, S 80° E, 17.2'
ORIG. 8" MAPLE IS MISSING.
(C.S. FILE NO. 49/100)

FILED
Date: 10-31-96 By: JC
This survey consists of:
Map: M125-76
Narrative:
Corner Rpt:
DOUGLAS COUNTY SURVEYOR CB

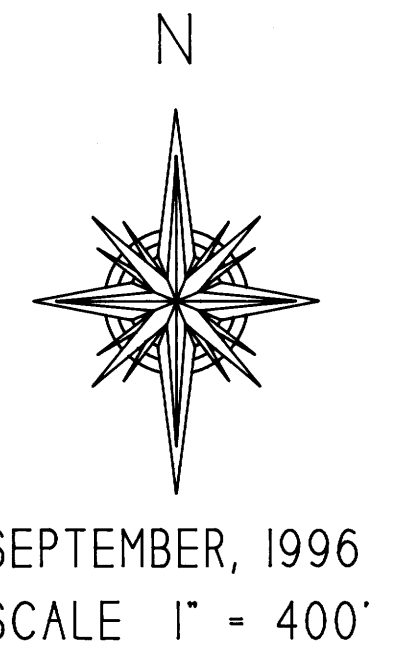

S 15
1/4 COR.
S 22

N 0°01'42"E
2637.29

CENTER 1/4 SEC. CORNER, SECTION 22
SET 2" IRON PIPE WITH 2" BRASS CAP, MARKED
"T29S R9W C 1/4 S22 LS 2052 1996"
B.T.'S
5" CHINQUAPIN, S 12°E, 25.5', BARK SCRIBED "C 1/4 S22 BT"
10" DOUG. FIR, S 62°W, 52.6', BLAZED & SCRIBED "C 1/4 S22 BT"
11" DOUG. FIR, N 82°W, 49.9', BLAZED & SCRIBED "C 1/4 S22 BT"
8" CHINQUAPIN, N 32°E, 15.7', BLAZED & SCRIBED "C 1/4 S22 BT"

1/4 COR.
S 21 S 22

N89°23'16"E
2660.47

C 1/4 S 22

N89°23'16"E
2637.46

1/4 COR.
S 22 S 23

1/4 SEC. CORNER TO SECTIONS 21 & 22
FOUND 1" IRON PIPE WITH 2 1/2" BLM BRASS CAP, 2" ABOVE GROUND, MARKED
"T29S R9W 1/4 S21 S22 1978"
B.T.'S
4", NOW 9" DOUGLAS FIR, HEALED SCAR, N 44°W, 10.5'
(RECORD N 38°W, 16 1/2 LKS)
OTHER B.T.'S ARE MISSING
(COUNTY SURVEYOR'S RECORD, PAGE 16420, DEPENDENT RESURVEY,
PORTION OF SUBDIVISIONAL LINES, T 29 S, R 9 W.)

1/4 SEC. CORNER TO SECTIONS 22 & 23
FOUND 1" IRON PIPE WITH 2" COUNTY SURVEYOR'S BRASS CAP,
12" ABOVE GROUND, MARKED "T29S R9W S22 S23 1959 BLM 1966"
B.T.'S
BYRON'S 12", NOW 28" CEDAR, N 27°E, 94.3'(REC. 94.0')
BYRON'S 12", NOW 27" W. FIR, S 29 1/2°W, 71.0'
(C.S. FILE NO. 49/100)

N 0°01'42"E
2604.82

S 22
1/4 COR.
S 27

1/4 SEC. CORNER TO SECTIONS 22 & 27
FOUND 1" IRON PIPE WITH 2 1/2" COUNTY SURVEYOR'S BRASS CAP
MARKED "T29S R9W 1/4 S22 S27 1959," 18" ABOVE GROUND,
WITH PARTIALLY BURIED STONE ALONGSIDE.
B.T.'S
ORIG. 12", NOW 28" ROTTED FIR STUMP, NO VISIBLE MARKS,
S 44°E, 9.3'(RECORD 8.6')
ORIG. 12", NOW 24" ROTTED FIR STUMP, HEALED SCAR,
N 22°W, 9.3'(RECORD 9.0')
CO. SURVEYOR'S 16", NOW 24" LOW CUT FIR STUMP, NO MARKS,
N 22°W, 44.4'(RECORD 41.4')
CO. SURVEYOR'S 17", NOW 19" DOUGLAS FIR, HEALED SCAR,
S 10°W, 33.5'
(C.S. FILE NO. 49/100 AND 53/53)

REGISTERED PROFESSIONAL LAND SURVEYOR
John Minor
OREGON
JULY 15, 1983
JOHN MINOR
2052

SURVEYED BY: JOHN MINOR
MENASHA CORPORATION
P.O. BOX 588
NORTH BEND, OR 97459
LICENSE RENEWAL 12-31-96

COUNTY SURVEYORS FILE DATA
DO NOT REMOVE FROM OFFICE

LEGEND
SURVEYED LINES
PAINTED & BLAZED LINES
FOUND CORNERS
CORNERS SET
CALCULATED CORNERS

MAP FILE M125-76

MAP FILE M125-76