

A SURVEY FOR TOM VAN EPPS & ROSEBURG RESOURCES

IN THE NW 1/4 OF SECTION 4, T29S, R4W, W.M.
DOUGLAS COUNTY, OREGON

FILED

Date: 7-8-96 By: JC
This survey consists of:
Map: M125-24
Narrative: _____
Corner Rpt: _____

**COUNTY SURVEYORS FILE DATA
DO NOT REMOVE FROM OFFICE**

DOUGLAS COUNTY
SURVEYOR
JP *CB*

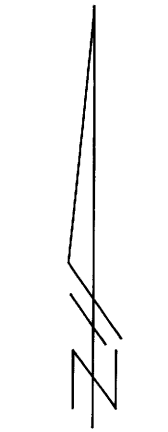

1" = 200'
APRIL 1996

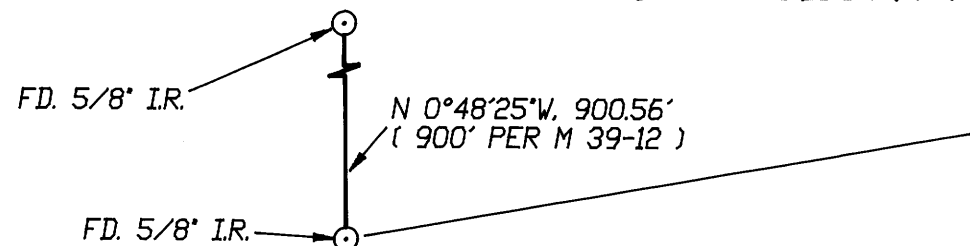

N 0°53'42"W 2018.58'
(2022.98' PER INST. NO. 85-2123)
LINE IS POSTED ON THIS BEARING

N 0°57'57"W
1118.03'

LEGEND:

⊕ - APPROX. LOCATION OF METAL FENCE POST

FIELD CREW: G. LANG, L. LANG
EQUIPMENT: TM 6, RED 1 EDM
COMPUTATIONS: G. LANG
DRAFTING: BILL WARREN

NARRATIVE:

THE PURPOSE OF THIS SURVEY WAS TO SET A LINE MONUMENT BETWEEN THE TWO EXISTING CORNERS SHOWN. THIS MONUMENT WAS PLACED GIVING FULL DEED DISTANCES OF 395' & 349' TO PARCELS PREVIOUSLY SOLD. LINES WERE MARKED NORTHERLY & EASTERLY OF SET MONUMENT.

SURVEYED BY: GREG LANG
7550 WILLIS CREEK RD.
WINSTON, OREGON 97496



EXPIRES: 12-31-96

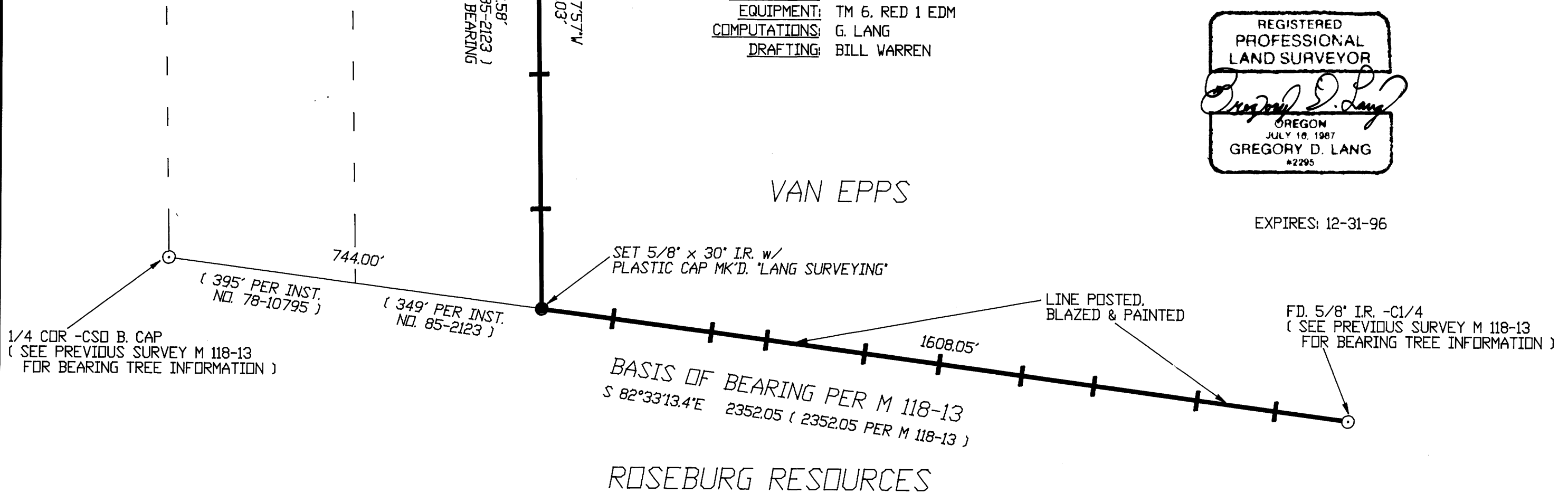

744.00'

(395' PER INST. NO. 78-10795)

(349' PER INST. NO. 85-2123)

1/4 COR - CSD B. CAP
(SEE PREVIOUS SURVEY M 118-13 FOR BEARING TREE INFORMATION)

BASIS OF BEARING PER M 118-13
S 82°33'13.4"E 2352.05 (2352.05 PER M 118-13)

1608.05'

LINE POSTED, BLAZED & PAINTED

FD. 5/8" I.R. -C1/4
(SEE PREVIOUS SURVEY M 118-13 FOR BEARING TREE INFORMATION)

ROSEBURG RESOURCES

MAP FILE M125-24

MAP FILE M125-24