

**COUNTY SURVEYORS FILE DATA  
DO NOT REMOVE FROM OFFICE**

FILED

Date: 2-22-96 By: MP  
This survey consists of:  
Map: M 123-32  
Narrative: \_\_\_\_\_  
Corner Rpt: \_\_\_\_\_

BOUNDARY LINE SURVEY  
LOCATED BETWEEN SECTIONS 5 AND 8, T.23 S., R.8 W., W.M.  
DOUGLAS COUNTY, OREGON

DOUGLAS COUNTY  
SURVEYOR *MP*

SURVEY FOR:

IP TIMBERLANDS OPERATING CO., LTD.  
711 PORT DOCK ROAD  
REEDSPORT, OR. 97467

SURVEY BY:

CLYDE F. MULKINS  
TIMBER CRUISING & ENGINEERING  
P.O. BOX 750  
COOS BAY, OR. 97420

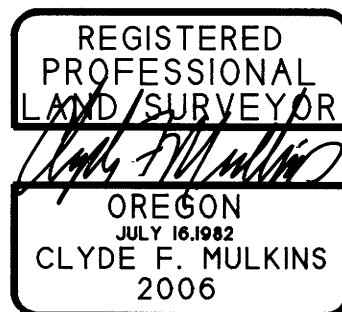

EXPIRES 12-31-96

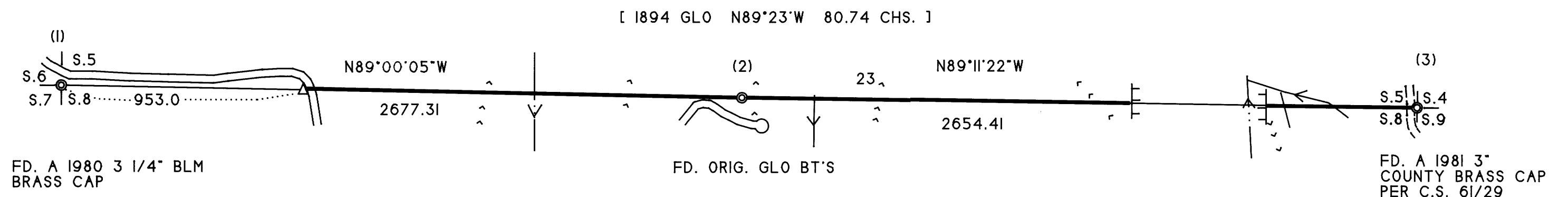

LEGEND

- FD. CORNERS AS SHOWN
- △ CROSSING POST (6' ALUM. POST)
- <<< RIDGES
- ←←← CREEK / DRAW
- ( ) CORNER REF. NO.
- ≡≡≡≡ GRAVEL ROAD
- ==== DIRT ROAD
- LINES FLAGGED AND BLAZED
- ||| BLUFFS

CORNER NOTES

CORNER #1: FD. A 1980 BLM BRASS CAP AT THE CORNER OF SECTIONS 5, 6, 7, AND 8, FROM WHICH: FD. A 32" DF WITH A HEALED FACE BEARS N69 3/4"W. 29.0 FT.; FD. A 29" CEDAR WITH A HEALED FACE BEARS N45"E. 18.5 FT. (TAG READS 17.0 FT., RECORD 17.8 FT.); FD. A 24" DF STUMP 4' HIGH WITH A HEALED FACE BEARS S75"E. 15.0 FT. (RECORD 15.1 FT.); FD. A 23" HEMLOCK WITH A HEALED FACE BEARS S10"W. 13.0 FT. (RECORD 13.9 FT.).

CORNER #2: FD. THE ORIGINAL 1/4 CORNER POSITION BETWEEN SECTIONS 5 AND 8. SET A 3 1/4" ALUM. CAP ON A 36" ALUM. ROD FROM WHICH: FD. A 55" DF (UPROOTED AND SLID DOWN HILL) WITH VISIBLE SCRIBES (S28"E. 18 LKS. RECORD); FD. A 45" DF STUMP WITH SCRIBE FRAGMENTS BEARS N72"W. 42.9 FT. (RECORD 65 LKS); FD. A STEEL FENCE POST (BLM'S APPROX. 1/4 CORNER) BEARS N81"W. 10.4 FT.; I SCRIBED 1/4 S5 BT" ON A 40" DF BEARS N12"W. 27.1 FT.; I SCRIBED 1/4 S5 BT" ON A 34" DF BEARS N71"E. 27.4 FT.; I SCRIBED 1/4 S8 BT" ON AN 11" DF BEARS S5"E. 18.8 FT.; I SCRIBED 1/4 S5 BT" ON A 10" DF BEARS N71"W. 33.4 FT.

CORNER #3: FD. A 1981 DOUGLAS COUNTY BRASS CAP AT THE CORNER OF SECTIONS 4, 5, 8, AND 9, FROM WHICH: FD. A 43" DF WITH A HEALED FACE BEARS N67"W. 25.1 FT.; FD. A 15" DF WITH A HEALED FACE BEARS N64"E. 5.7 FT.; FD. A 19" DF WITH A HEALED FACE BEARS S13"E (RECORD S18"E). 15.4 FT.; FD. A 12" DF WITH A HEALED FACE BEARS S34"W. 62.0 FT.

NARRATIVE

THE PURPOSE OF THIS SURVEY WAS TO MARK THE LINES, AS SHOWN, FOR FUTURE FOREST OPERATIONS. RECORD CORNER NOTES USED TO PERFORM THIS SURVEY WERE: PG. 16832 OF DEPENDENT RESURVEY. PORTION OF SUBDIVISIONAL LINES OF T.23 S., R.8 W., W.M. BY THE BLM FOR THE CORNER OF SECTIONS 5, 6, 7, AND 8, AND GOVERNMENT CORNER RENEWAL 118, T.23 S., R.8 W., W.M. BY DOUGLAS COUNTY SURVEYOR'S OFFICE. BLM HAD RETRACED THIS LINE IN THE EARLY 1970'S BY ADMINISTRATIVE SURVEY.

THE ORIGINAL POSITION OF THE 1/4 CORNER OF SECTIONS 5 AND 8 WAS REESTABLISHED USING RECORD BEARING AND DISTANCE FROM THE CENTER OF THE FOUND 45" DF STUMP WITH SCRIBE FRAGMENTS PER CORNER NOTE FOR CORNER #2. THE STEEL FENCE POST THE BLM ESTABLISHED FOR THIS 1/4 CORNER BY ADMINISTRATIVE SURVEY WAS ESTABLISHED BY SINGLE PROPORTION MEASUREMENT OR BY A PRESUMED POSITION FOR THE 55" DF UPROOT IGNORING THE ABOVE MENTIONED 45" DF STUMP.

ASSISTING ME WITH THIS SURVEY WERE TROY RAMBO AND RANDY MADDEN. THE FIELD WORK WAS PERFORMED BETWEEN DECEMBER 1 AND DECEMBER 16, 1995. THIS WAS A CLOSED LOOP TRAVERSE. TRAVERSING WAS PERFORMED USING A TOPCON GTS-301 TOTAL STATION.

SCALE 1" = 400'  
DECEMBER 17, 1995

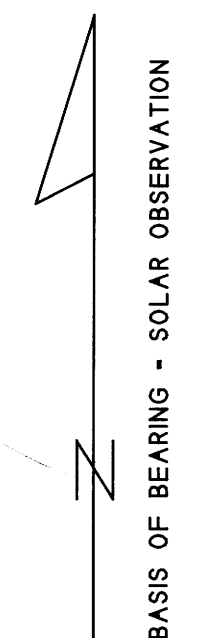

BASIS OF BEARING - SOLAR OBSERVATION

MAP FILE M 123-32

MAP FILE M 123-32