

Date: 1-22-96 By: JP
This survey consists of: 2 sheets
Map: M123-21B
Narrative: _____
Corner Rpt: _____

DOUGLAS COUNTY
SURVEYOR

CORNER NOTES

- (1) SECTION CORNER 34-35/3-2
FOUND: 1963 D C S D 2.5' B.C.
BTS: 43' I. CEDAR N51°W 30.5 FT. HEALED FACE W/TAG
20' W. OAK S48°E 63.8 FT.
33' D. FIR S76°W 65.4 FT.
22' W. OAK S85°E 436.0 FT. OPEN FACE, SCRIBING VISIBLE W/TAG
21' W. OAK S13°W 199.1 FT. OPEN FACE,
27' W. OAK N02°E 282.0 FT. OPEN FACE,
- (2) E 1/16 SECTION 34-3
CALCULATED POSITION ONLY, NO MONUMENT SET
- (3) 1/4 CORNER SECTION 34/3
FOUND: 1961 D C S D 2.5' B.C.
BTS: 19' D. FIR S40°W, 4.3 FT. HEALED FACE W/TAG
27' D. FIR N43°E, 3.4 FT.
44' D. FIR S11°E, 168.9 FT.
- (4) W 1/16 CORNER SECTION 34/3
SET: 5/8" X 30" REBAR W/YPC "LS 2603" 4" ABOVE GROUND
BTS: 10" D. FIR S62°E, 30.1 FT. BLAZED AND SCRIBED "W1/16 S3 BT"
10" D. FIR S34°W, 11.9 FT.
SET 5' STEEL POST 1 FT. SOUTH
- (5) SECTION CORNER 33-34/4-3
FOUND: 1961 D C S D 2.5' B.C.
BTS: DID NOT TIE BEARING TREES.
- (6) S 1/16 SECTION 33-34
SET: 5/8" X 30" REBAR W/YPC "LS 2603" 4" ABOVE GROUND
BTS: 40" D. FIR N32°W, 20.6 FT. BLAZED & SCRIBED "S1/16 S33 BT"
22" D. FIR N87°E, 9.3 FT. "S1/16 S34 BT"
SET 5' STEEL POST 1 FT. EAST
- (7) CS 1/16 CORNER SECTION 34
SET: 5/8" X 30" REBAR W/YPC "LS 2603"
EXTENDS 4" ABOVE MOUND OF STONES
BTS: 15" D. FIR S68°E, 17.5 FT. BLAZED & SCRIBED "CS 1/16 S34 BT"
17" D. FIR N02°W, 5.7 FT.
SET 5' STEEL POST 1 FT. EAST
- (8) S 1/16 SECTION 34-35
FOUND: 1985, 1972 BLM 3' BC.
BTS: 12" D. FIR N86°W 27.9 FT. HEALED FACE W/TAG
9" D. FIR N40°E 24.6 FT.
SET 5' STEEL POST 1 FT. WEST
- (9) 1/4 CORNER SECTION 34-35
FOUND: 1985, 1972 BLM 2.5' BC.
BTS: 16" ASH N61°E 43.3 FT. HEALED FACE W/TAG
30" D. FIR N76°W 24.6 FT.
- (10) CE 1/16 CORNER SECTION 34
CALCULATED POSITION ONLY, NO MONUMENT SET
- (11) C 1/4 SECTION 34
SET: 5/8" X 30" REBAR W/YPC "LS 2603" 4" ABOVE GROUND
BTS: 11" D. FIR S75°W, 60.3 FT. BLAZED & SCRIBED "C1/4 S34 BT"
8" D. FIR N41°W, 67.3 FT. BLAZED & SCRIBED "C1/4 S34 BT"
9" D. FIR N19°E, 89.4 FT. BLAZED & SCRIBED "C1/4 S34 BT"
9" D. FIR S23°E, 60.7 FT. BLAZED & SCRIBED "C1/4 S34 BT"
SET 5' STEEL POST 1 FT. SOUTH
- (12) 1/4 CORNER SECTION 33-34
FOUND: 1963 D C S D 2.5' BC 1' ABOVE GROUND
BTS: 30" D. FIR STUMP S26°E 26.0 FT. HEALED FACE W/TAG
AND FENCE ATTACHED
28" D. FIR STUMP S29°W 38.4 FT.
- (13) CN 1/16 CORNER SECTION 34
SET: 5/8" X 30" REBAR W/YPC "LS 2603" 4" ABOVE GROUND
BTS: 15" D. FIR N62°W 14.9 FT. BLAZED & SCRIBED "CN1/16 S34 BT"
13" D. FIR N29°E 16.3 FT. BLAZED & SCRIBED "CN1/16 S34 BT"
SET 5' STEEL POST 1 FT. SOUTH
- (14) NE 1/16 CORNER SECTION 34
SET: 5/8" X 30" REBAR W/YPC "LS 2603" 4" ABOVE GROUND
BTS: 34" D. FIR N17°E 52.8 FT. BLAZED & SCRIBED "NE1/16 S34 BT"
12" D. FIR N68°W 78.1 FT.
SET 5' STEEL POST 1 FT. WEST

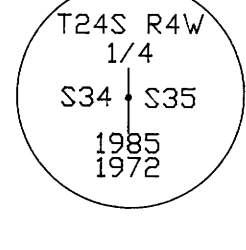
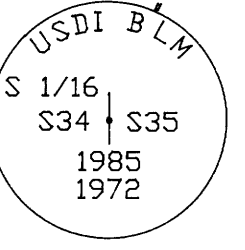
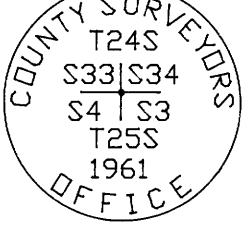
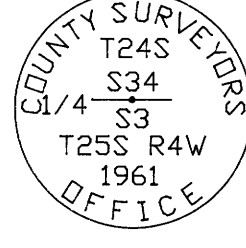
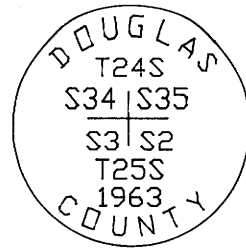

- (15) NE 1/16 SECTION 34-35
FOUND: 1985, 1972 BLM 3' BC
BTS: 5' D. FIR N40°W 42.9 FT. SCRIBING VISIBLE
24' D. FIR S21°E 42.3 FT. HEALED FACE
20' D. FIR STUMP S21°E 19.6 FT.
PARTIALLY HEALED FACE/W 1' SPIKE @ TOP CENTER
- (16) CORNER SECTION 27-26/34-35
FOUND: NO MONUMENT FOUND, LOGGING DAMAGE
BTS: 16" D. FIR N74°E 406.52 FT.
23" D. FIR S32°E 310.86 FT.
28" D. FIR STUMP S135°W 262.65 FT.
N W BEARING TREE MISSING
- (17) E 1/16 CORNER SECTION 27/34
SET: 5/8" X 30" REBAR W/YPC "LS 2603" 4" ABOVE GROUND
BTS: 10" D. FIR N81°E 13.9 FT. BLAZED & SCRIBED "E 1/16 S27 BT"
16" D. FIR S26°W 12.0 FT. "E 1/16 S34 BT"
SET 5' STEEL POST 1 FT. SOUTH
- (18) 1/4 CORNER SECTION 27/34
FOUND: 1963 D C S D 2.5' BC
BTS: (ORIG.) MADRONE SPROUTS (2 DOWN) 1-6" SNAG STANDING
S82°W 21.0 FT. (HOLE IN CENTER OF CLUMP) NO MARKS VISIBLE
12" D. FIR S35°W, 15.2 FT. HEALED FACE
23" D. FIR N33°E, 21.6 FT.
SET 5' STEEL POST 1 FT. WEST
- (19) SECTION CORNER 28-27/33-34
FOUND: 1963 DCSO 2 1/2" BC
BTS: 18" D. FIR STUMP S52°E, 15.3 FT. HEALED FACE
23" D. FIR S43°W, 21.8 FT.
9" W. OAK N85°W, 9.9 FT.
19" W. OAK N73°W, 102.5 FT.
18" D. FIR STUMP N50°E, 21.1 FT. DISTURBED OUT OF POSITION
15" W. OAK S15°W, 57.7 FT. ROTTEN OPEN FACE
- (20) CS 1/16 CORNER SECTION 27
CALCULATED POSITION ONLY, NO MONUMENT SET
- (21) SE 1/16 CORNER SECTION 27
SET: 5/8" X 30" REBAR W/YPC "LS 2603" 4" ABOVE GROUND
BTS: 20" D. FIR S34°W, 37.3 FT. BLAZED & SCRIBED "SE 1/16 S27 BT"
20" D. FIR N46°W, 43.3 FT. BLAZED & SCRIBED "SE 1/16 S27 BT"
SET 5 FT. STEEL POST 1' EAST
- (22) S 1/16 CORNER SECTION 27-26
SET: 5/8" X 30" REBAR W/YPC "LS 2603" 4" ABOVE GROUND
BTS: 10" D. FIR N14°W, 21.4 FT. BLAZED & SCRIBED "S 1/16 S27 BT"
15" MADRONE S83°W, 18.6 FT. BLAZED & SCRIBED "S 1/16 S27 BT"
SET 5 FT. STEEL POST 1' NORTH
- (23) 1/4 CORNER SECTION 27-26
FOUND: 1963 D C S D 2.5' BC
BTS: 16" D. FIR N39°W 16.1 FT. HEALED FACE
15" W. OAK SNAG N20°E 23.9 FT.
- (24) CE 1/16 CORNER SECTION 27
CALCULATED POSITION ONLY, NO MONUMENT SET
- (25) C 1/4 CORNER SECTION 27
CALCULATED POSITION ONLY, NO MONUMENT SET
- (26) 1/4 CORNER SECTION 28-27
SET: 1.5" X 30" G.I.P. /W 2.5" BRASS CAP, FLUSH /W GROUND
BTS: 30" D. FIR S34°E, 394.9 FT. BLAZED & SCRIBED "W 1/4 S27 BT"
27" D. FIR N36°W, 331.6 FT. "E 1/4 S28 BT"
P.K. NAIL IN 6" X 6" WOOD POST @ NE CORNER OF POLE BARN S76°W 246.15 FT.
SET: 5/8" X 30" REBAR W/YPC "LS 2603 RM" S63°W 243.1 FT.
- (27) SECTION CORNER 21-22/28-27
FOUND: 1" DD. 3/4" ID. I. PIPE 19" ABOVE GROUND
BTS: 8" B. OAK S61°W 24.5 FT. HEALED FACE
7" W. OAK N52°W 22.2 FT.
9" W. OAK S37°E 35.8 FT.
9" W. OAK N06°E 56.2 FT.
21" W. OAK N41°E 48.2 FT.
31" W. OAK S70°E 184.5 FT.
17" W. OAK N16°W 38.5 FT. OPEN FACE
ROTTED OAK LOG S72°W 53.5 FT.
SEVERAL IN AREA, NO VISIBLE MARKS

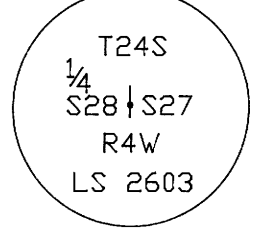
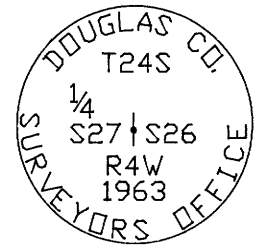
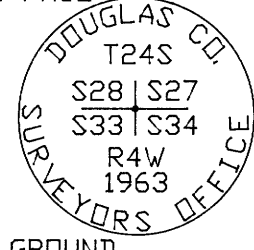
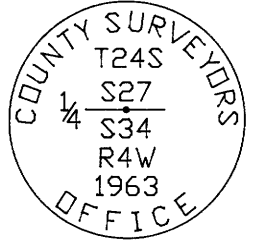
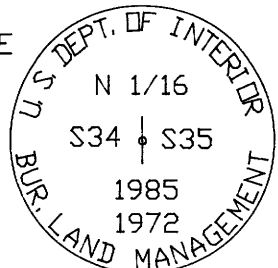

- (28) 1/4 CORNER SECTION 22/27
SET: 1995 2 1/2" BC ON G.I.P. 4" ABOVE GROUND
30" W. OAK N39°E 11.2 FT. ROTTED OPEN FACE
6" W. OAK S74°W 9.9 FT. BLAZED & SCRIBED "N 1/4 S27 BT"
7" W. OAK S20°E 6.2 FT. "N 1/4 S27 BT"
8" W. OAK N21°W 29.0 FT. "S 1/4 S22 BT"
9" W. OAK N12°E 21.7 FT. "S 1/4 S22 BT"
SET 5' STEEL POST 1' EAST
E-W FENCE 1.6' SOUTH OF CORNER
- (29) SECTION CORNER 22-23/27-26
SET: 1995 2 1/2" BC ON GALVANIZED I.P. 4" ABOVE GROUND
BTS: 15" D. FIR S41°E 21.6 FT. BLAZED & SCRIBED "T24S R4W S26 BT"
24" D. FIR S86°W 21.7 FT. BLAZED & SCRIBED "T24S R4W S27 BT"
SET RM 5/8" X 30" REBAR W/YPC "LS 2603 RM" FLUSH W/GROUND
N49°W 46.5 FT.
SET RM 5/8" X 30" REBAR W/YPC "LS 2603 RM" FLUSH W/GROUND
N44°E 50.5 FT.
SET 5' STEEL POST 1' NORTH
- (30) 1/4 CORNER SECTION 22-23
FOUND: 2" DD. 1 1/2" ID. I. PIPE 1.2' ABOVE GROUND
BTS: 18" W. OAK S04°W 11.5 FT. HEALED FACE
27" W. OAK N87°W 14.1 FT. CHOPPED OPEN FACE, SCRIBING VISIBLE
- (31) 1/4 CORNER SECTION 23/26
FOUND: 1995 D C S D 2.5' B.C.
BTS: 30" D. FIR STUMP S54°W 85.15 FT. (ORIGINAL)
10" D. FIR N79°E 11.3 FT. BLAZED & SCRIBED "1/4 S23 CS BT"
12" D. FIR S26°W 36.6 FT. "1/4 S26 CS BT"
9" D. FIR S135°E 11.6 FT.
4" D. FIR N44°W 7.8 FT. "X BT"
- (32) SECTION CORNER 23-24/26-25
FOUND: 1963 BLM 3' BC
BTS: 12" W. OAK S24°E 15.1 FT. HEALED FACE
15" W. OAK S48°W 19.2 FT.
14" W. OAK N33°W 37.5 FT.
30" D. FIR ROTTED STUMP S05°W 805.2 FT. (RECORD)
- (33) 1/4 CORNER SECTION 26-25
FOUND: 1963 BLM 3' BC
BTS: 14" MAPLE SNAG S07°E 3.7 FT. OPEN FACE, SCRIBING VISIBLE
8" D. FIR N62°W 22.4 FT. HEALED FACE
18" D. FIR S23°W 41.4 FT.

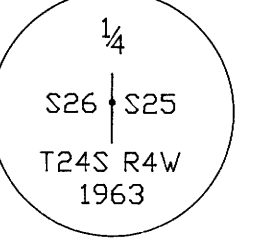
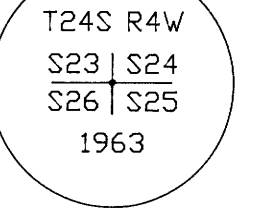
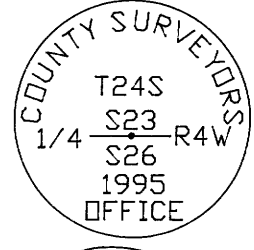
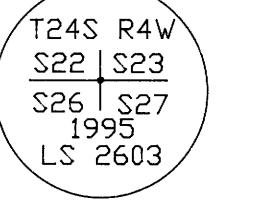
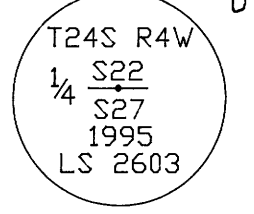

**SURVEY FOR
ROGER AND MARGARET TILBURY
SECTIONS 26, 27, 34
TOWNSHIP 24 SOUTH, RANGE 4 WEST, W.M.
DOUGLAS COUNTY, OREGON
DECEMBER 5, 1995**

REGISTERED
PROFESSIONAL
LAND SURVEYOR

Harvey M. Christensen
OREGON
MARCH 16, 1993
HARVEY M. CHRISTENSEN
2603

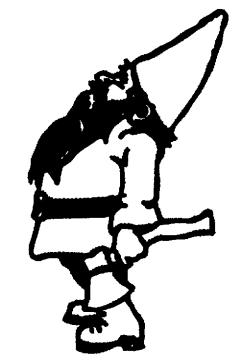

LICENSE RENEWAL DATE DECEMBER 31, 1997

**NORTHWEST TIMBERLAND CONSULTING, INC.
4680 BRIARS - EUGENE, OR 97404-1113
PHONE (541) 461-4076**

**COUNTY SURVEYORS FILE DATA
DO NOT REMOVE FROM OFFICE**