

1/4 COR. BR. CAP ON IP. BT'S IN GOOD CONDITION PER CS FILE 52/87.

COUNTY SURVEYORS FILE DATA
DO NOT REMOVE FROM OFFICE

BR. CAP ON IP. SEE CS FILE 52/87. 14" D. FIR N78 E. 38.5' HAS BEEN CUT FLUSH WITH GROUND IN CURRENT LOGGING OPERATION. 33" D. FIR N58 W. 70.5' NOW A ROTTEN STUMP. THE D. FIR S82 E. 38.3' & THE B. OAK S69 W. 16.4' ARE IN GOOD CONDITION.

MAP FILE M122-73

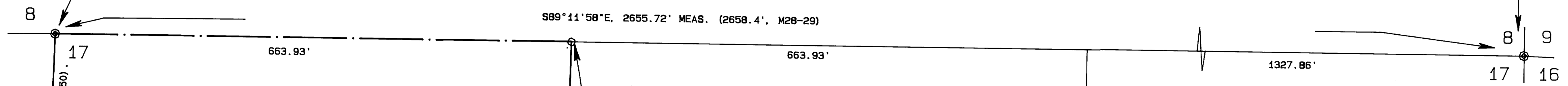

FILED

Date: 11-14-95 By: JC
This survey consists of:
Map: M122-73
Narrative: _____
Corner Rpt: _____

PROPERTY SURVEY

FOR
WALT LOOMIS

DOUGLAS COUNTY SURVEYOR CB

IN THE NE1/4, SECTION 17, T26S, R6WMM, DOUGLAS COUNTY, OREGON.

THE PURPOSE OF THIS SURVEY WAS TO MONUMENT THE W1/2 OF THE NW1/4 OF THE NE1/4 OF SECTION 17. THE EAST LINE OF THE SUBJECT PARCEL WAS DIFFICULT TO DO BECAUSE THE NE1/16 COR WAS NOT FOUND. AN OAK TREE FENCE CORNER WAS ASSUMED AS THE NE1/16 CORNER FOR THE PURPOSE OF DIVIDING THE NW1/4 OF THE NE1/4 IN HALF. A PROPOSED BOUNDARY LINE AGREEMENT BETWEEN WALT LOOMIS AND MELVIN TORGUSON WILL SOLIDIFY THEIR INTENTIONS. THE BASIS OF BEARINGS FOR THE SURVEY WAS THE WEST LINE OF THE NW1/4 OF THE NE1/4, SEE M77-9, AND M28-29. THE MONUMENTS FOUND ON THE NORTH LINE OF SECTION 17 CONTROLLED THE POSITION OF THE MONUMENT SET ON THE NORTH LINE OF SECTION 17, AND THE MONUMENT SET AT THE SE CORNER OF LOOMIS WAS PLACED AT THE MID-POINT OF THE ASSUMED SOUTH LINE OF THE NW1/4 OF THE NE1/4.

OCTOBER 4, 1995

LEGEND

- ⊙ FOUND MONUMENT AS NOTED.
- SET 5/8"X30" IRON ROD W/PLASTIC CAP 'LS 1331'.

REGISTERED PROFESSIONAL LAND SURVEYOR
J. Gregory Solarz
OREGON
SEPTEMBER 23, 1977
J. GREGORY SOLARZ
1331
EXPIRES: 6/96

KE KOOS ENGINEERING
2524 BROADWAY
NORTH BEND, OREGON

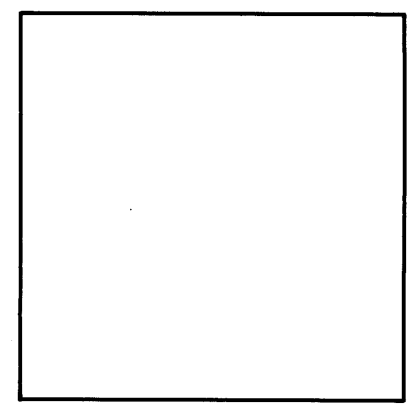

COUNTY SURVEYOR

FD. 14" OAK AS FENCE CORNER. FENCES RUN EAST, WEST, AND SOUTH FROM HERE. EVIDENCE OF FENCE IMBEDDED OVER 2" INTO TREE. FOR PURPOSES OF BOUNDARY LINE AGREEMENT, THIS TREE IS CONSIDERED THE 1/16 CORNER. SUBSEQUENTLY, THE MIDPOINT BETWEEN HERE AND THE CN 1/16 COR, SEC. 17 IS THE PROPERTY LINE BETWEEN LOOMIS AND TORGUSON.

KE1936

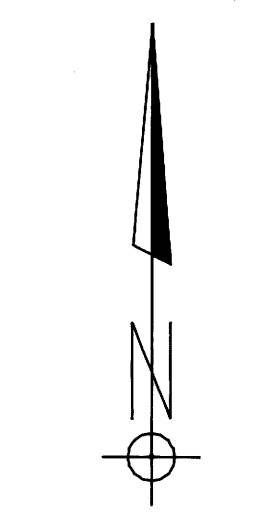

1" = 100'

BASIS OF BEARING

S02°38'33"W, 1320.65' MEAS. (1320.73' M77-9)

319.72' MEAS. (319.72 M76-50)

5/8" IRON ROD IN N-S FENCE LINE; SEE M76-50.

663.93'

663.93'

1327.86'

PROPOSED BOUNDARY LINE AGREEMENT

SET 5/8"X30" IRON ROD ON NORTH EDGE OF GRAVEL ROAD; FLUSH WITH GROUND.

N01°56'44"E, 1322.57' MEAS.

565.33'

757.24'

SET 5/8" IR AT MID-POINT BETWEEN CN1/16 COR AND OAK TREE ASSUMED BY LOOMIS & TORGUSON TO BE THE NE1/16 COR FOR THE PURPOSE OF A BOUNDARY LINE AGREEMENT.

679.95'

679.95'

S89°00'08"E, 1359.90' MEAS.

CN1/16 COR, 3/4" IP, SEE M77-9 & M28-29.

MAP FILE M122-73