

MAP FILE M121-25

MAP FILE M121-25

SURVEY FOR:  
STATE OF OREGON - DEPARTMENT OF FORESTRY  
SECTION 23, T.23 S., R.10 W., W.M.

DOUGLAS COUNTY, OREGON  
THEODOLITE AND EDM SURVEY BY:  
L.D. SMITH AND T. VAN VLEET  
DRAWN BY: T. VAN VLEET  
DECEMBER 12, 1994  
SCALE 1" = 200'

SURVEY BY:  
REGISTERED  
PROFESSIONAL  
LAND SURVEYOR

*Lloyd D. Smith*  
OREGON  
JULY 22, 1977  
LLOYD D. SMITH  
1101

LLOYD D. SMITH  
300 5TH ST., BAY PARK  
COOS BAY, OREGON

EXPIRATION DATE OF CERTIFICATE 6-30-96

FILED  
Date: 12/30/94 By: JP  
This survey consists of:  
Map: M121-25  
Narrative: \_\_\_\_\_  
Corner Rpt: \_\_\_\_\_

DOUGLAS COUNTY, OREGON  
SURVEYOR

SURVEY NARRATIVE TO COMPLY WITH PARAGRAPH 209.250 OREGON REVISED STATUTES

LEGEND

- OSBF P/C = OREGON STATE BOARD OF FORESTRY 1 1/2" X 36" GALVANIZED IRON PIPE WITH 3" BRONZE CAP
- BCIP = G.K. MILLER 2 1/2" BRASS CAP ON A 2 1/2" X 30" IRON PIPE
- ⊙ = MONUMENT FOUND
- X = ORANGE CARSONITE MARKER AND STATION, CBM-250R LABELED BOUNDARY MARKER
- BTT = BEARING TREE TAG
- YMLP = YELLOW METAL LOCATION POSTER
- WPCP = 4" X 4" X 72" WHITE PAINTED CEDAR POST
- ⊙ → = TRUE BLAZED AND POSTED
- #1 ( ) = RECORD BEARING AND DISTANCE IN FEET (A.G. GIBSON, 1967, COUNTY SURVEY NO. 55-50)
- #2 ( ) = RECORD BEARING AND DISTANCE IN FEET (G.K. MILLER, 1983, COUNTY SURVEY NO. M95-29A)

PURPOSE

TO SEPARATE STATE FOREST LANDS AND PRIVATE LANDS LOCATED IN SECTION 23 AND 24, TOWNSHIP 23 SOUTH, RANGE 10 WEST, WILLAMETTE MERIDIAN.

PROCEDURE

A RANDOM TRAVERSE WAS RAN BETWEEN FOUND CORNERS. BEARINGS AND DISTANCES WERE COMPUTED AND OFFSETS CALCULATED TO POINTS ON TRUE LINE FOR CARSONITE BOUNDARY MARKERS. FOR A DETAILED REPORT ON FOUND CORNERS SEE COUNTY RECORDS.

S 1/16 CORNER FOUND  
2 1/2" BCIP, 1983, (IN PLACE)  
18" FIR N35°E 7.5' (NOW 19" X 5' HIGH STUMP IN PLACE, FACE CLOSED)  
18" FIR N02°W 7.7' (NOW 20" IN PLACE, FACE CLOSED)  
OSBF P/C S02°20' 07" W 5.97' (IN PLACE)

SECTION CORNER FOUND  
24" FIR (ORIG) N60°E 20 LKS (NOW 12" X 3' ROTTED STUB IN PLACE, NO SCRIBES VISIBLE)  
72" FIR (ORIG) S45°E 5 LKS (NOW 53" X 2' HIGH STUMP IN PLACE)  
16" FIR (ORIG) S75°W 11 LKS (NOW ROTTED TO GROUND LEVEL IN PLACE)  
OSBF P/C, A. GIBSON 1967, (IN PLACE)  
13" FIR N26°E 34.2' (NOW 15" X 5' HIGH STUMP IN PLACE, FACE CLOSED) BTT  
12" FIR S01°E 22.8' (NOW 21" IN PLACE, FACE CLOSED) BTT  
8" BOWED FIR S56°W 19.4' (NOW 15" IN PLACE, FACE CLOSED) BTT  
15" FIR N64°W 37.5' (NOW 22" IN PLACE, FACE CLOSED) BTT  
36" FIR STUMP S71°W 14.6' (NO RECORD, IN PLACE)  
WPCP WEST 1.5' (IN PLACE)

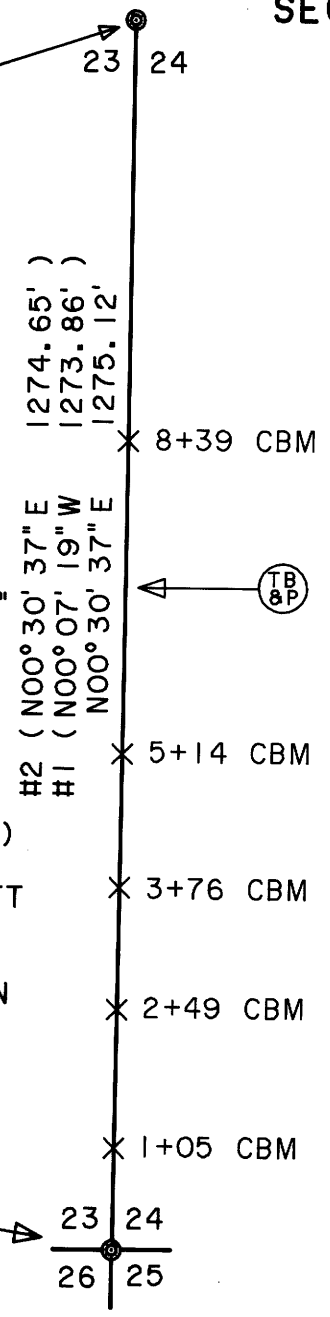

BASIS OF BEARING

G.K. MILLER 1983, SURVEY (COUNTY SURVEY NO. M95-29A) FROM THE SECTION CORNER OF SECTIONS 23, 24, 25 AND 26 TO THE SOUTH 1/16 CORNER OF SECTIONS 23 AND 24, TOWNSHIP 23 SOUTH, RANGE 10 WEST, WILLAMETTE MERIDIAN.

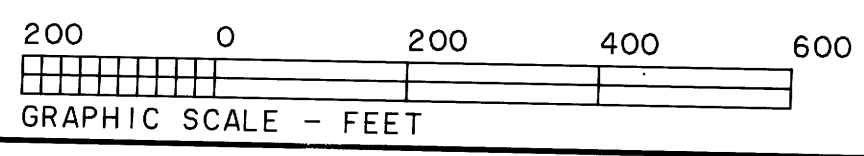

ODF PLAT NO. 336

COUNTY SURVEYORS FILE DATA  
DO NOT REMOVE FROM OFFICE