



PROPERTY SURVEY FOR MENASHA CORPORATION

LOCATED IN SECTION 6, T.22S., R.8W., W.M.

FILED

Date: 5/9/94 By: JP
This survey consists of:
Map: M118-72
Narrative: _____
Corner Rpt: _____

DOUGLAS COUNTY
SURVEYOR

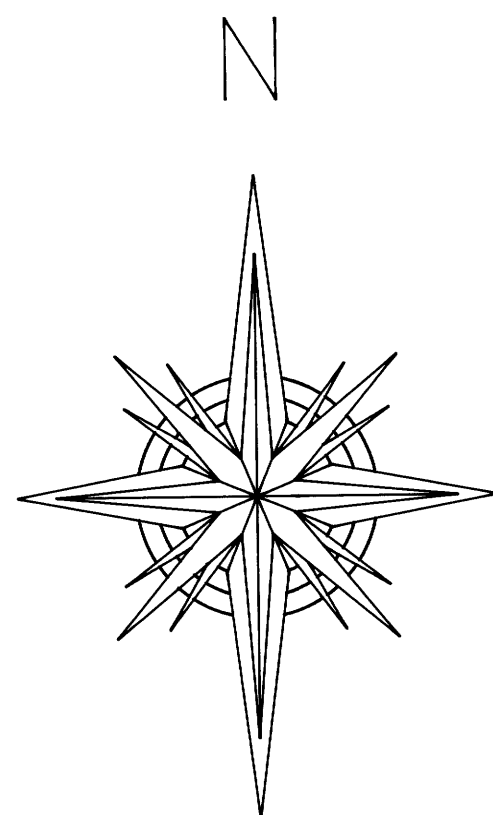

SCALE: 1" = 1000'
MAY 1994

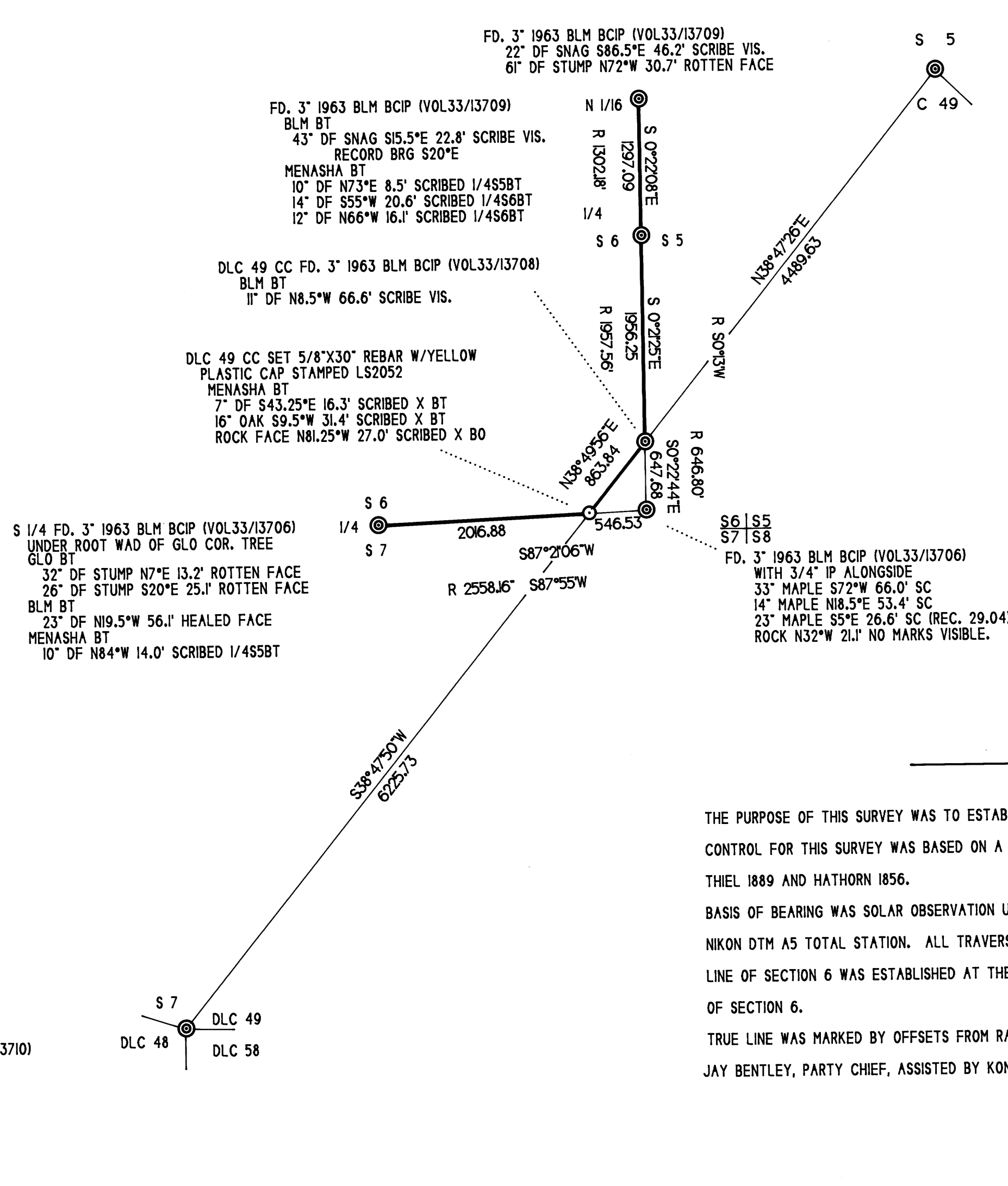

LEGEND

SURVEYED LINES _____
 PAINTED & BLAZED LINES _____
 FOUND CORNERS ○
 CORNERS SET ○

ABBREVIATIONS

R - 1963 BLM DEPENDENT SURVEY
 SC - SIDE CENTER

NARRATIVE

THE PURPOSE OF THIS SURVEY WAS TO ESTABLISH MENASHA'S PROPERTY LINES AND CORNERS IN SECTION 6. CONTROL FOR THIS SURVEY WAS BASED ON A DEPENDENT 1963 BLM SURVEY AND ORIGINAL SURVEYS BY THIEL 1889 AND HATHORN 1856.

BASIS OF BEARING WAS SOLAR OBSERVATION USING THE HOUR ANGLE METHOD. EQUIPMENT USED WAS A NIKON DTM A5 TOTAL STATION. ALL TRAVERSES WERE CLOSED LOOPS. THE DLC 49 CC ON THE SOUTH LINE OF SECTION 6 WAS ESTABLISHED AT THE INTERSECTION OF THE DLC LINE AND THE SOUTH LINE OF SECTION 6.

TRUE LINE WAS MARKED BY OFFSETS FROM RANDOM TRAVERSE POINTS. SURVEY CREW CONSISTED OF JAY BENTLEY, PARTY CHIEF, ASSISTED BY KONRAD COX AND DAVE GIESLEMAN.

SURVEY PERFORMED BY:
 JOHN MINOR LS2052
 P.O. BOX 588
 NORTH BEND, OR 97459

REGISTERED
 PROFESSIONAL
 LAND SURVEYOR

John Minor
 OREGON
 JULY 15, 1983
 JOHN MINOR
 #2052

LICENSE RENEWAL 12-3-94

MAP FILE M118-72

MAP FILE M118-72