

# A SURVEY FOR K.E. & K.J. CATES

IN THE SW 1/4 OF SECTION 20, T29S, R8W, W.M.  
DOUGLAS COUNTY, OREGON

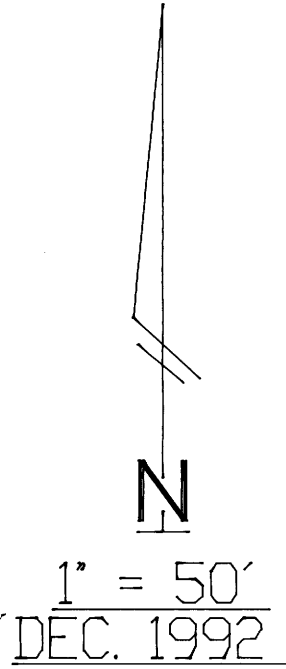

**LEGEND:**

- - FOUND 1/2" I ROD UNLESS OTHERWISE NOTED
- - SET 5/8" x 30" IR/PLASTIC CAP MARKED "LANG SURVEYING"
- ( ) - RECORD PER M 64-57 UNLESS OTHERWISE NOTED.
- [ ] - RECORD PER VOL. 742, PG. 172
- △ - COMPUTED POINT

FD. 5/8" I ROD BY STATE HWY. DEPT. (STA. 1701+25 - 36' RT)

PREVIOUS LOCATION OF 5/8" I ROD BY "AA SURVEYING SERVICE INC." COMPUTED BY REMEASURED CO-ORDINATES (SEE STATE HWY. DRWG. # 9B-30-17)

PREVIOUS LOCATION OF 1" BOLT COMPUTED BY REMEASURED CO-ORDINATES (SEE STATE HWY. DRWG. # 9B-30-17)

FD. 5/8" I ROD BY STATE HWY. DEPT.

BASIS OF BEARING PER M 64-57 EASTERLY SIDE OF VOLUME 142, PG. 146

CORNER TIE - SECTION CORNER  
FD. 1 1/4" PIPE (O.D.) 19120  
IN FENCE CORNER 30129  
BEARS S 41°10'29" W  
3196.11' FROM THIS FD. BOLT

- A - S 44°37'55" E 28.18'
- B - S 44°12'01" E 14.29'
- C - N 1°00'26" W 10.07'
- D - N 22°33'35" E 21.45'

OCCUPANCY LINE & USED AS LINE OF SENIOR DEED (SEE VOL. 142, PG. 146) ALSO USED IN DESCRIPTIONS PER M 64-57

**NARRATIVE:**

PURPOSE: TO SURVEY PROPERTY DESCRIBED IN VOL. 742, PG. 172, DEED RECORDS, DOUGLAS COUNTY, OREGON

WESTERLY LINE LOCATED PER STATE HWY. R/W (SEE DRG. NO. 9B-30-17). NORTH LINE PER "REMEASURED CO-ORDINATES" OF SAID STATE DRG. (W. END) & FOUND 1" BOLT (E. END). EAST LINE AS SURVEYED BY M 64-57. SOUTH LINE PER DEED DISTANCES.

FIELD CREW: GREG & ED

EQUIP.: TM6 & RED 1 EDM

COMPS.: G. LANG

DRAFTING: B&B DRAFTING

**NOTE:**

OWNERSHIP OF INST# 89-12843 SHOULD BE CHECKED BY TITLE COMPANY TO ENSURE CLEAR TITLE.  
A TITLE REPORT HAS NOT BEEN SUPPLIED. THIS SURVEY MAY NOT THEREFORE SHOW ALL EASEMENTS, RESTRICTIONS, ETC. WHICH MIGHT BE APPURTENANT.  
OWNER MAY WANT TO SECURE ACCESS RIGHTS WITH THIS TRANSACTION.

SURVEYED BY: GREG LANG  
7550 WILLIS CREEK RD.  
WINSTON, OR. 97496

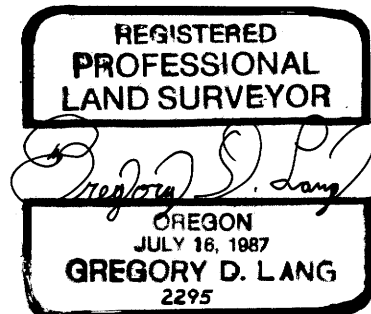

EXPIRATION DATE: 12-31-94

COUNTY SURVEYORS FILE DATA  
DO NOT REMOVE FROM OFFICE

MAP FILE M117-45

MAP FILE M117-45