

**"A" C.E. 1/16 CORNER SECTION 26**  
 SET 3/4" x 30" ALUM. ROD WITH 3/4" ALUM. CAP.  
 (BURIED PURPLE M.M. UNDER 30" ALUM. ROD)  
 10" FIR, S53°E, 14.9' (SCRIBED/PAINTED RED)  
 12" FIR, N54°E, 20.8' (SCRIBED/PAINTED RED)

**NORTH 1/4 CORNER SECTION 26**  
 FD. 1960 WILFORD HAINES "T" IRON  
 26" MAPLE, N15°E, 22.0' (NO MARKS), 1883 B.T.  
 54" FIR SNAG, S01°W, 38.0' (BARK SCRIBE), 1883 B.T.  
 16" FIR STUMP, N11°W, 58.5' (NO MARKS), 1961 B.T.  
 6" FIR, N54°W, 20.3' (SCAR VIS.), 1984 B.T.  
 16" CEDAR, S57°E, 54.0' (SCAR VIS.), 1984 B.T.

**"B" CENTER 1/4 CORNER SECTION 26**  
 SET 3/4" x 30" ALUM. ROD WITH 3/4" ALUM. CAP  
 (BURIED PURPLE M.M. UNDER 30" ALUM. ROD)  
 14" FIR, S39°W, 18.9' (SCRIBED/PAINTED RED)  
 16" FIR, N38°W, 25.8' (SCRIBED/PAINTED RED)  
 18" FIR, N46°E, 10.4' (SCRIBED/PAINTED RED)  
 22" HEM, S53°E, 10.8' (SCRIBED/PAINTED RED)

**"C" C.S. 1/16 CORNER SECTION 26**  
 SET 3/4" x 30" ALUM. ROD WITH 3/4" ALUM. CAP.  
 (BURIED PURPLE M.M. UNDER 30" ALUM. ROD)  
 14" FIR, S44°W, 12.8' (SCRIBED/PAINTED RED)  
 22" FIR, N09°E, 17.1' (SCRIBED/PAINTED RED)

**"D" WEST 1/16 CORNER SECTION 26**  
 SET 3/4" x 30" ALUM. ROD WITH 3/4" ALUM. CAP FOR  
 WITNESS CORNER. TRUE CORNER BEARS N88°31'W,  
 30.00'. BURIED PURPLE M.M. UNDER 30" ALUM. ROD.  
 8" FIR, N88°E, 22.4' (SCRIBED/PAINTED RED)  
 24" FIR, S04°W, 10.6' (SCRIBED/PAINTED RED)

**"E" SOUTH 1/16 CORNER SECTION 26**  
 SET 3/4" x 30" ALUM. ROD WITH 3/4" ALUM. CAP.  
 (BURIED PURPLE M.M. UNDER 30" ALUM. ROD)  
 14" FIR, S58°W, 16.1' (SCRIBED/PAINTED RED)  
 24" FIR, N06°E, 26.2' (SCRIBED/PAINTED RED)

**WEST 1/4 CORNER SECTION 26**  
 FD. 1958 DOUGLAS COUNTY BRASS CAP.  
 50" FIR STUMP, N71°E, 41.0' (SCAR VIS.), 1883 B.T.  
 66" CEDAR STUMP, S89°W, 36.0' (SCRIBE VIS.), 1883 B.T.  
 20" HEMLOCK, S39°W, 5.8' (SCAR VIS.), 1958 B.T.  
 24" CEDAR, N17°E, 96.8' (SCRIBE VIS.), 1958 B.T.

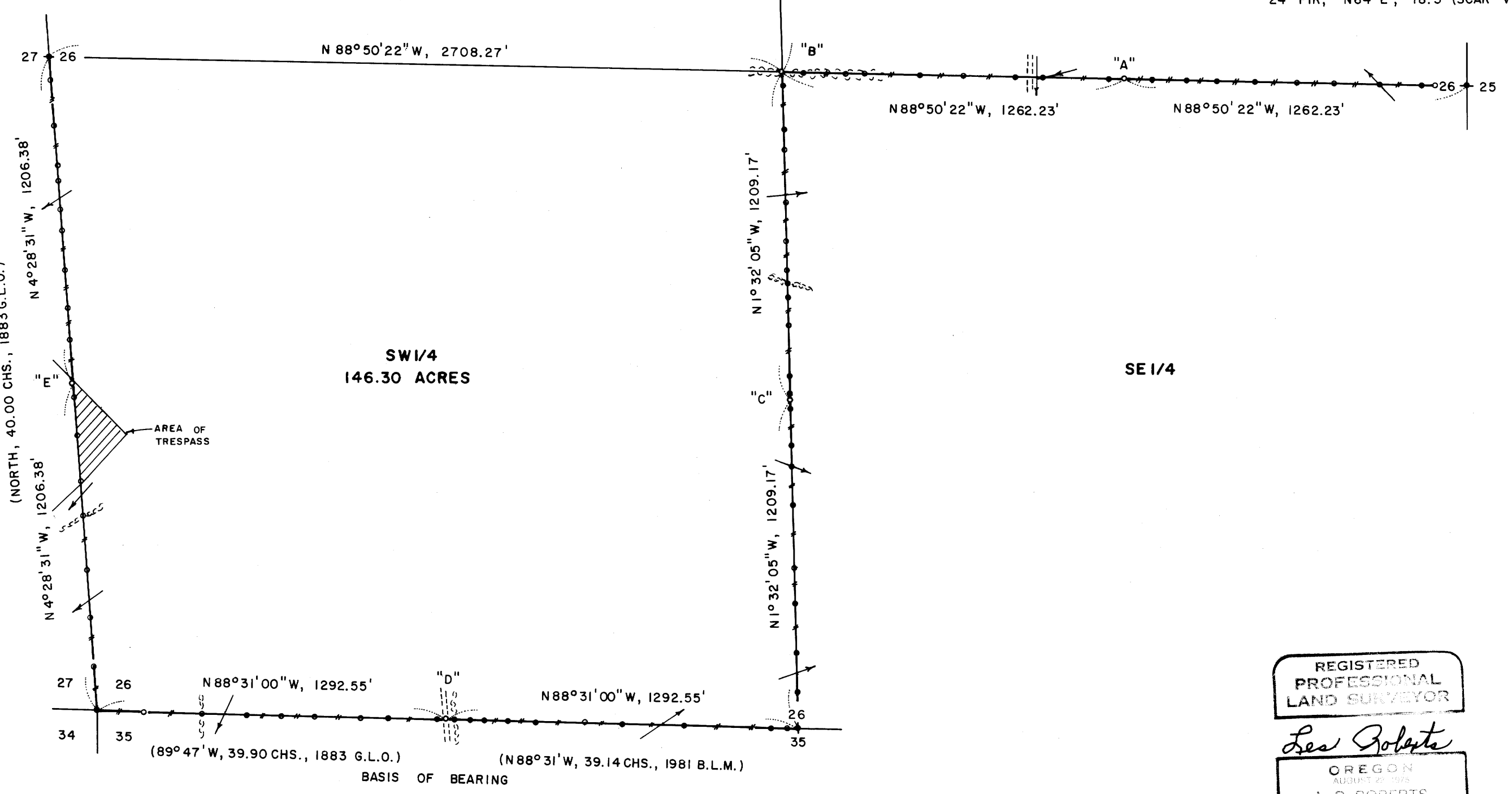

**NARRATIVE**, THE PURPOSE OF THIS SURVEY IS TO POST AND BLAZE THE NORTH AND WEST LINES OF THE SE 1/4 OF SECTION 26. ALSO TO POST AND BLAZE THE SOUTH AND WEST LINES OF THE SW 1/4 OF SECTION 26. THE FOLLOWING CORNERS WERE ALSO SET IN THIS SURVEY; 1) THE C.E. 1/16 CORNER, 2) THE CENTER 1/4 CORNER, 3) THE C.S. 1/16 CORNER, 4) THE WEST 1/16 CORNER SOUTH LINE AND 5) THE SOUTH 1/16 CORNER WEST LINE SECTION 26. THE NORTH 1/4 CORNER, THE EAST 1/4 CORNER, THE SOUTH 1/4 CORNER, THE S.W. SECTION CORNER AND THE WEST 1/4 CORNER WERE FOUND IN THE FIELD, AS SHOWN, AND USED AS CONTROL FOR THIS SURVEY. A SERIES OF CLOSED MEANDER, WILD T-16 THEODOLITE AND A WILD DI-4L E.D.M., CONTROL TRAVERSES WERE RUN BETWEEN THE ABOVE MENTIONED CONTROLLING CORNERS. THE CENTER 1/4 CORNER, MONUMENT "B", WAS SET AT THE POINT OF INTERSECTION OF THE N-S AND E-W CENTERLINES OF SECTION 26. THE C.E. 1/16 CORNER, MONUMENT "A", WAS SET HALFWAY BETWEEN THE EAST 1/4 CORNER AND THE CENTER 1/4 CORNER AS SHOWN. THE C.S. 1/16 CORNER, MONUMENT "C", WAS SET HALFWAY BETWEEN THE SOUTH 1/4 CORNER AND CENTER 1/4 CORNER AS SHOWN. THE WEST 1/16 CORNER BETWEEN SECTIONS 26 AND 35, MONUMENT "D", WAS SET HALFWAY BETWEEN THE SOUTH 1/4 CORNER AND THE S.W. SECTION CORNER AS SHOWN. THE SOUTH 1/16 CORNER BETWEEN SECTIONS 26 AND 27, MONUMENT "E", WAS SET HALFWAY BETWEEN THE S.W. SECTION CORNER AND THE WEST 1/4 CORNER. A CLOSED RANDOM, WILD T-16 THEODOLITE AND A WILD DI-4L E.D.M., PROPERTY LINE TRAVERSE WAS RUN ALONG ALL PROPERTY LINES TO BE BLAZED AND POSTED. OFFSETS WERE COMPUTED FROM THIS PROPERTY LINE TRAVERSE TO THE TRUE PROPERTY LINE. PROPERTY LINES WERE MARKED WITH RED PAINTED BLAZES, RED RIBBON, YELLOW INTERNATIONAL PAPER COMPANY BOUNDARY LINE DECALS ATTACHED TO 72" ALUMINUM POSTS AND BURIED FLUORESCENT ORANGE MAGNET MARKERS. ALUMINUM POSTS AND BURIED MAGNETIC MARKERS ARE REFERENCED BY A 4" x 6" ALUMINUM BOUNDARY LINE TAG NAILED TO A NEARBY TREE. TAG NOTES BEARING AND DISTANCE FROM TREE TO ALUMINUM POST OR BURIED MAGNETIC MARKER.

**EAST 1/4 CORNER SECTION 26**  
 FD. 1981 B.L.M. BRASS CAP  
 5" FIR, N50°W, 15.7' (SCAR VIS.), 1981 B.T.  
 24" FIR, N64°E, 18.3' (SCAR VIS.), 1981 B.T.

**LEGEND**

- MONUMENTS FOUND AND USED FOR CONTROL
- MONUMENTS SET, 3/4" x 30" ALUMINUM RODS WITH 3/4" ALUMINUM CAPS. CAPS STAMPED S-T-R, DATE AND "P.L.S. 1039".
- ( ) DATA OF RECORD, 1883 G.L.O. SURVEY AND 1981 B.L.M. SURVEY.
- BASIS OF BEARING, WEST 1/2 SOUTH LINE SECTION 26 FROM 1981 B.L.M. SURVEY.
- LINES BLAZED AND POSTED THIS SURVEY.
- DISTANCES TO B.T.'S ARE CENTER MEASURE
- (M.M.) INDICATES LOCATION OF BURIED MAGNETIC MARKERS. MARKERS ARE FLUORESCENT ORANGE IN COLOR AND ARE BURIED, 12" TO 18" DEEP, ALONG LINE AS SHOWN.
- ALL NEW B.T.'S ARE SCRIBED AND HAVE A BRASS WASHER STAMPED "P.L.S. 1039" NAILED TO LOWER BLAZE. SCRIBED BLAZES ARE PAINTED RED.
- NEW B.T.'S HAVE A 6" STEEL SPIKE DRIVEN INTO THE CENTER OF THE TREE TO SERVE AS A CHAINING POINT FOR MEASURED DISTANCES.

LOCATION OF BURIED MAGNETIC MARKERS										
E 1/4 COR.	0'	WEST	(AL. POST)	S 1/4 COR.	0'	WEST	(AL. POST)			
E-W 26-1	37'	WEST	(M.M.)	S26-1	39'	WEST	(M.M.)			
E-W 26-2	105'	WEST	(M.M. & AL. POST)	S26-2	99'	WEST	(M.M. & AL. POST)			
E-W 26-3	160'	WEST	(M.M.)	S26-3	418'	WEST	(M.M. & AL. POST)			
E-W 26-4	317'	WEST	(M.M. & AL. POST)	S26-4	644'	WEST	(M.M. & AL. POST)			
E-W 26-5	482'	WEST	(M.M. & AL. POST)	S26-5	783'	WEST	(M.M. & AL. POST)			
E-W 26-6	622'	WEST	(M.M.)	S26-6	963'	WEST	(M.M. & AL. POST)			
E-W 26-7	771'	WEST	(M.M. & AL. POST)	S26-7	1072'	WEST	(M.M.)			
E-W 26-8	913'	WEST	(M.M.)	S26-8	1154'	WEST	(M.M. & AL. POST)			
E-W 26-9	1027'	WEST	(M.M. & AL. POST)	S26-9	1202'	WEST	(M.M.)			
E-W 26-10	1154'	WEST	(M.M.)	WIT. COR.	1262'	WEST	(M.M. & AL. POST)			
C.E. 1/16	1262'	WEST	(M.M. & AL. POST)	W. 1/16	1292'	WEST	(CORNER NOT SET)			
E-W 26-11	1313'	WEST	(M.M. & AL. POST)	S26-11	1325'	WEST	(M.M.)			
E-W 26-12	1558'	WEST	(M.M. & AL. POST)	S26-12	1502'	WEST	(M.M. & AL. POST)			
E-W 26-13	1658'	WEST	(M.M. & AL. POST)	S26-13	1605'	WEST	(M.M.)			
E-W 26-14	1851'	WEST	(M.M. & AL. POST)	S26-14	1772'	WEST	(M.M. & AL. POST)			
E-W 26-15	2008'	WEST	(M.M. & AL. POST)	S26-15	1897'	WEST	(M.M.)			
E-W 26-16	2213'	WEST	(M.M.)	S26-16	2027'	WEST	(M.M. & AL. POST)			
E-W 26-17	2287'	WEST	(M.M. & AL. POST)	S26-17	2198'	WEST	(M.M. & AL. POST)			
E-W 26-18	2439'	WEST	(M.M.)	S26-18	2408'	WEST	(M.M. & AL. POST)			
C. 1/4 COR.	2524'	WEST	(M.M. & AL. POST)	S.W. COR.	2585'	WEST	(AL. POST)			
N-S 26-1	54'	SOUTH	(M.M.)	W26-1	160'	NORTH	(M.M. & AL. POST)			
N-S 26-2	208'	SOUTH	(M.M. & AL. POST)	W26-2	340'	NORTH	(M.M. & AL. POST)			
N-S 26-3	288'	SOUTH	(M.M.)	W26-3	512'	NORTH	(M.M. & AL. POST)			
N-S 26-4	488'	SOUTH	(M.M. & AL. POST)	W26-4	716'	NORTH	(M.M. & AL. POST)			
N-S 26-5	618'	SOUTH	(M.M. & AL. POST)	W26-5	846'	NORTH	(M.M.)			
N-S 26-6	730'	SOUTH	(M.M.)	W26-6	1011'	NORTH	(M.M. & AL. POST)			
N-S 26-7	779'	SOUTH	(M.M. & AL. POST)	W26-7	1156'	NORTH	(M.M.)			
N-S 26-8	827'	SOUTH	(M.M.)	S. 1/16 COR.	1206'	NORTH	(M.M. & AL. POST)			
N-S 26-9	937'	SOUTH	(M.M. & AL. POST)	W26-10	1364'	NORTH	(M.M. & AL. POST)			
N-S 26-10	1115'	SOUTH	(M.M. & AL. POST)	W26-11	1486'	NORTH	(M.M.)			
N-S 26-11	1191'	SOUTH	(M.M.)	W26-12	1624'	NORTH	(M.M. & AL. POST)			
C.S. 1/16	1209'	SOUTH	(M.M. & AL. POST)	W26-13	1769'	NORTH	(M.M. & AL. POST)			
N-S 26-13	1234'	SOUTH	(M.M.)	W26-14	1848'	NORTH	(M.M.)			
N-S 26-14	1379'	SOUTH	(M.M. & AL. POST)	W26-15	1952'	NORTH	(M.M. & AL. POST)			
N-S 26-15	1448'	SOUTH	(M.M.)	W26-16	2021'	NORTH	(M.M.)			
N-S 26-16	1598'	SOUTH	(M.M. & AL. POST)	W26-17	2160'	NORTH	(M.M. & AL. POST)			
N-S 26-17	1825'	SOUTH	(M.M. & AL. POST)	W26-18	2327'	NORTH	(M.M.)			
N-S 26-18	1958'	SOUTH	(M.M. & AL. POST)	W. 1/4 COR.	2413'	NORTH	(AL. POST)			
N-S 26-19	2141'	SOUTH	(M.M. & AL. POST)							
N-S 26-20	2282'	SOUTH	(M.M. & AL. POST)							
S. 1/4 COR.	2418'	SOUTH	(AL. POST)							

REGISTERED  
PROFESSIONAL  
LAND SURVEYOR  
*Les Roberts*  
OREGON  
L. D. ROBERTS  
1039

**S.W. CORNER SECTION 26**  
 FD. 1957 DOUGLAS COUNTY BRASS CAP  
 16" YEW, S67°W, 21.2' (SCAR VIS.), 1883 B.T.  
 38" FIR STUMP, S41°E, 38.0' (NO MARKS), 1883 B.T.  
 44" FIR, N63°W, 24.0' (SCAR VIS.), 1883 B.T.  
 14" FIR, N14°W, 10.1' (SCAR VIS.), 1957 B.T.  
 20" HEMLOCK, N34°E, 44.6' (SCAR VIS.), 1957 B.T.  
 24" HEMLOCK, S16°W, 40.1' (SCAR VIS.), 1957 B.T.  
 28" FIR, S84°E, 44.1' (SCAR VIS.), 1957 B.T.

**SOUTH 1/4 CORNER SECTION 26**  
 FD. 1981 B.L.M. BRASS CAP  
 22" FIR, N51°E, 32.0' (SCAR VIS.), 1981 B.T.  
 24" FIR, S36°E, 42.9' (SCAR VIS.), 1981 B.T.

63/138  
M115-63

63/138  
M115-63

M115-63

FILED

OK  
OCT 6 1992

OREGON CORNER RESTORATION FORM

Section 26 Township 21S Range 7W

COUNTY SURVEYOR  
DOUGLAS COUNTY, ORE.

County Douglas Date 07-07-92

CORNER DESIGNATION

Center 1/4 Corner  
Section 26

- Condition Report Only
- Not Found
- Renewed
- Unrecorded
- Surveyed In
- Referenced Out

Previous Renewals/Surveys, etc. No previous surveys.

Monument(s) & Accessories Found: (Condition and Source)

None

Monument Detail

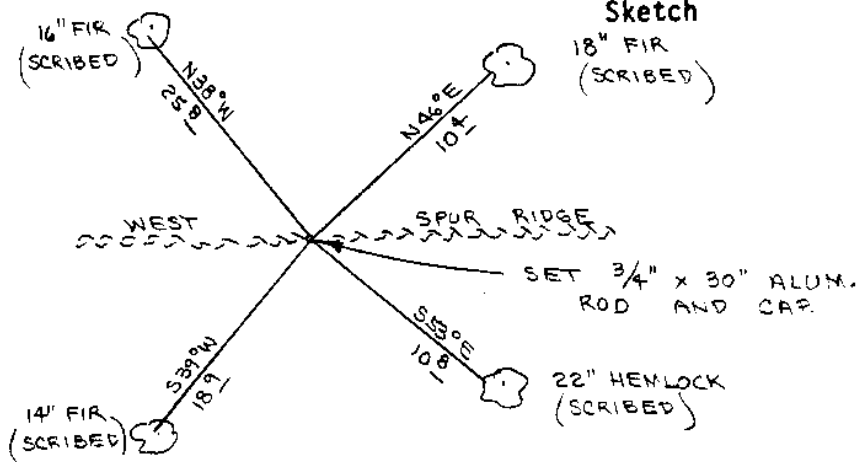

Monument Set (Procedures and Description)

Set 3/4" x 30" aluminum rod with 3 1/8" aluminum cap. Buried purple magnetic marker under 30" aluminum rod. Set 72" aluminum post, with land monument survey sign bolted to, beside aluminum rod. See filed survey for survey procedures.

New Accessories

- 14" Fir, S39W, 18.9' (Scribed/Painted Red/Brass Washers)
- 16" Fir, N38W, 25.8' (Scribed/Painted Red/Brass Washers)
- 18" Fir, N46E, 10.4' (Scribed/Painted Red/Brass Washers)
- 22" Hemlock, S53E, 10.8' (Scribed/Painted Red/Brass Washers)

Location & Comments

Corner lies on top of spur Compass Declination 20 1/2  
ridge. Ridge bears East & Firm/Agency Roberts  
West. Surveying, Inc.  
Address 29 West 29th St.  
Eugene, Oregon 97405  
Party Chief Stuart Duce  
Notes  
Witness Rick Jones

Surveyor's Seal

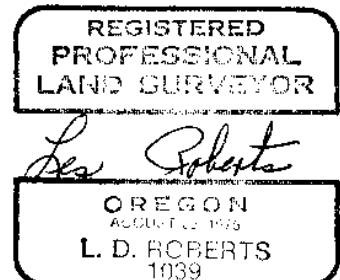

C.S. File No. 63/138-22

FILED

M115-23

vh  
OCT 6 1992

OREGON CORNER RESTORATION FORM

Section 26 Township 21S Range 7W  
County Douglas Date 07-02-92

COUNTY SURVEYOR  
DOUGLAS COUNTY, ORE.

CORNER DESIGNATION

West 1/16 Corner, South  
Line Section 26.

- Condition Report Only
- Not Found
- Renewed
- Unrecorded
- Surveyed In
- Referenced Out

Previous Renewals/Surveys, etc. 1883 G.L.O. Survey by Laban Wheeler.  
1981 B.L.M. Cadastral Survey.

Monument(s) & Accessories Found: (Condition and Source)

None

Monument Detail

Sketch

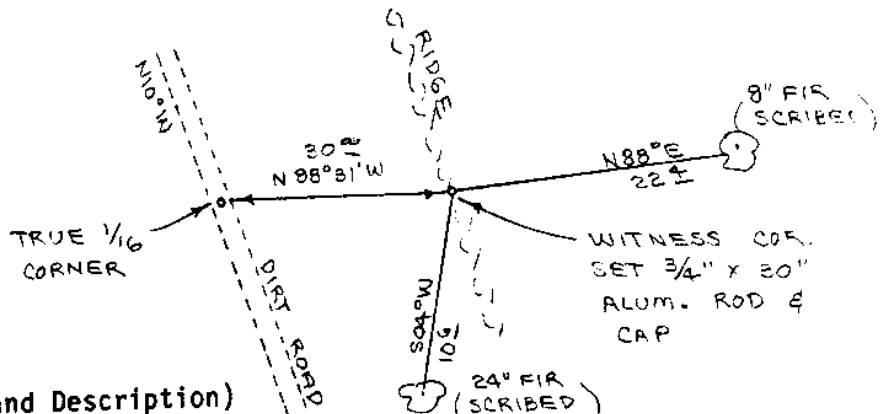

Monument Set (Procedures and Description)

Set 3/4" x 30" aluminum rod with 3/4" aluminum cap for witness corner to West 1/16 corner. True corner bears N88°31' W, 30.00 feet. True 1/16 corner falls in dirt road that is to be reconstructed. Set 72" aluminum post, with land monument survey sign bolted to, beside aluminum rod. See filed survey for survey procedures. Buried purple magnetic marker under New Accessories 30" aluminum rod.

- 8" Fir, N88E, 22.4' (Scribed/Painted Red/Brass Washers)
- 24" Fir, S04W, 10.6' (Scribed/Painted Red/Brass Washers)

Location & Comments

Corner lies on top of \_\_\_\_\_  
ridge and about 30' East  
of dirt road. Ridge bears  
North-South.

Compass Declination 20 1/2  
Firm/Agency Roberts  
Surveying, Inc.  
Address 29 West 29th St.  
Eugene, Oregon 97405  
Party Chief Stuart Duce  
Notes \_\_\_\_\_  
Witness Rick Jones

Surveyor's Seal



FILED

OCT 6 1992

M115-63

OREGON CORNER RESTORATION FORM

Section 26 Township 21S Range 7W

County Douglas Date 07-06-92

COUNTY SURVEYOR  
DOUGLAS COUNTY, ORE.

CORNER DESIGNATION

South 1/16 Corner, West  
Line Section 26

- Condition Report Only
- Not Found
- Renewed
- Unrecorded
- Surveyed In
- Referenced Out

Previous Renewals/Surveys, etc. 1883 G.L.O. Survey by Laban Wheeler.

Monument(s) & Accessories Found: (Condition and Source)

None

Monument Detail

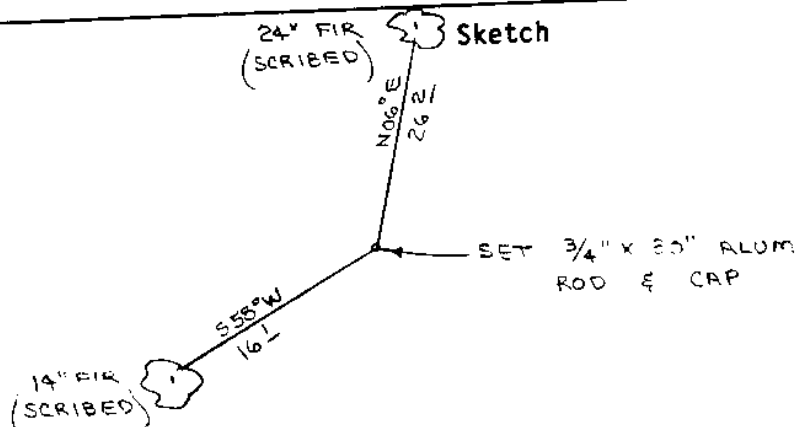

Monument Set (Procedures and Description)

Set 3/4" x 30" aluminum rod with 3/4" aluminum cap. Buried purple magnetic marker under 30" aluminum rod. Set 72" aluminum post, with land monument survey sign bolted to, beside aluminum rod. See filed survey for survey procedures.

New Accessories

- 14" Fir, S58W, 16.1' (Scribed/Painted Red/Brass Washers)
- 24" Fir, N06E, 26.2' (Scribed/Painted Red/Brass Washers)

Location & Comments

Surveyor's Seal

Compass Declination 20 1/2

Firm/Agency Roberts

Surveying, Inc.

Address 29 West 29th St.

Eugene, Oregon 97405

Party Chief Stuart Duce

Notes \_\_\_\_\_

Witness Rick Jones

M115-63

FILED

OCT 6 1992

OREGON CORNER RESTORATION FORM

Section 26 Township 21S Range 7W

COUNTY SURVEYOR  
DOUGLAS COUNTY, ORE.

County Douglas Date 06-11-92

CORNER DESIGNATION

C.S. 1/16 Corner  
Section 26

- Condition Report Only
- Not Found
- Renewed
- Unrecorded
- Surveyed In
- Referenced Out

Previous Renewals/Surveys, etc. No previous surveys.

Monument(s) & Accessories Found: (Condition and Source)

None

Monument Detail

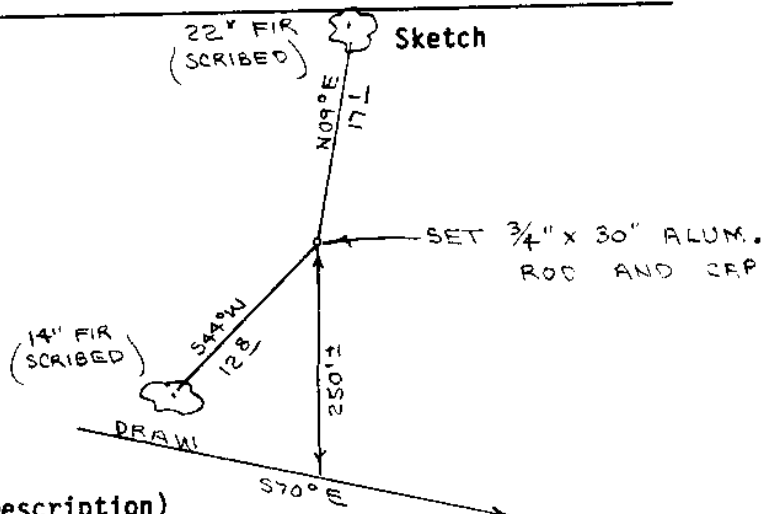

Monument Set (Procedures and Description)

Set 3/4" x 30" aluminum rod with 3/4" aluminum cap. Buried purple magnetic marker under 30" aluminum rod. Set 22" aluminum post, with land monument survey sign bolted to, beside aluminum rod. See filed survey for survey procedures.

New Accessories

- 14" Fir, S44W, 12.8' (Scribed/Painted Red/Brass Washers)
- 22" Fir, N09E, 17.1' (Scribed/Painted Red/Brass Washers)

Location & Comments

Corner lies on steep East slope about 250' North of Draw. Draw bears S70E.

Compass Declination 20 1/2

Firm/Agency Roberts Surveying Inc.

Address 29 West 29th St. Eugene, Oregon 97405

Party Chief Stuart Duce

Notes \_\_\_\_\_

Witness Tim Bageant

Surveyor's Seal



C.S. File No. 63/138-22

M 115-63

FILED

JK

OCT 6 1992

OREGON CORNER RESTORATION FORM

Section 26 Township 21S Range 7W

County Douglas Date 07-02-92

COUNTY SURVEYOR  
DOUGLAS COUNTY, ORE.

CORNER DESIGNATION

West 1/4 Corner  
Section 26

- Condition Report Only
- Not Found
- Renewed
- Unrecorded
- Surveyed In
- Referenced Out

Previous Renewals/Surveys, etc. 1883 G.L.O. Survey by Laban Wheeler.  
See corner renewal #28 in 1958.

Monument(s) & Accessories Found: (Condition and Source)

Found 1958 Douglas County Brass Cap set firmly in the ground.

50" Fir Stump, N71E, 41.0' (Scar Vis.), 1883 BT. Rec. N71E, 40.9'

66" Cedar Stump, S89W, 36.0' (Scribe Vis.), 1883 BT. Rec. West, 35.6'

20" Hemlock, S39W, 5.8' (Scar Vis.), 1958 BT. Rec. S39W, 5.9'

24" Cedar, N17E, 96.8' (Scribe Vis.), 1958 BT. Rec. N18E, 97.5'

Monument Detail

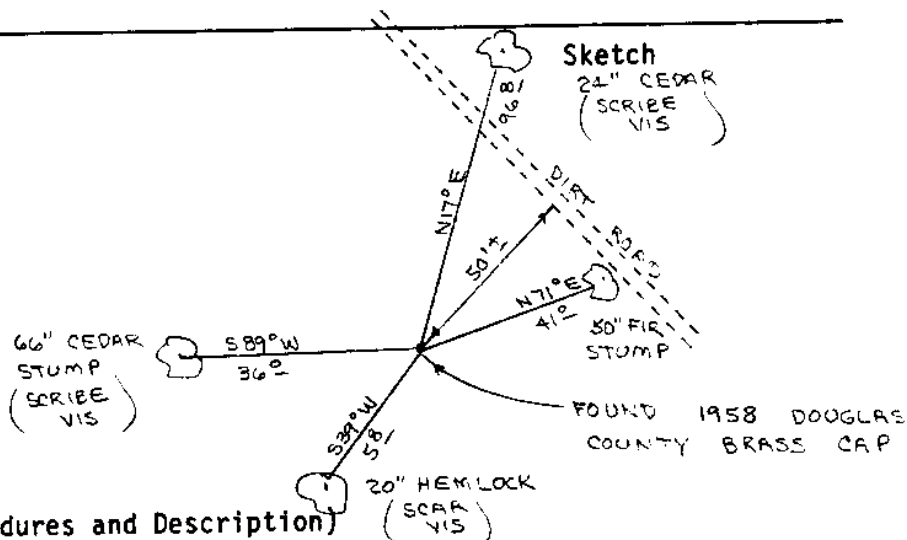

Monument Set (Procedures and Description)

\_\_\_\_\_

\_\_\_\_\_

\_\_\_\_\_

\_\_\_\_\_

New Accessories

Set 72" aluminum post, with land monument survey sign bolted to, beside  
brass cap. Painted all bearing trees red.

Location & Comments

Corner lies on flat  
ground about 50' West of  
dirt logging road. Road  
bear N20W and S20E,

Compass Declination 20 1/2

Firm/Agency Roberts  
Surveying, Inc.

Address 29 West 29th St,  
Eugene, Oregon 97405

Party Chief Les Roberts

Notes \_\_\_\_\_

Witness Stuart Duce.

Surveyor's Seal

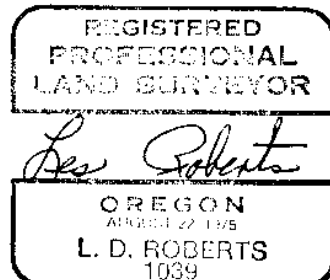

C.S. File No. 63/138-22  
E

M115-63

FILED

JK

OCT 6 1992

OREGON CORNER RESTORATION FORM

Section 26 Township 21S Range 7W

County Douglas Date 07-07-92

COUNTY SURVEYOR  
DOUGLAS COUNTY, ORE.

CORNER DESIGNATION

C.E. 1/16 Corner  
Section 26

- Condition Report Only
- Not Found
- Renewed
- Unrecorded
- Surveyed In
- Referenced Out

Previous Renewals/Surveys, etc. No previous surveys.

Monument(s) & Accessories Found: (Condition and Source)

None

Monument Detail

Sketch

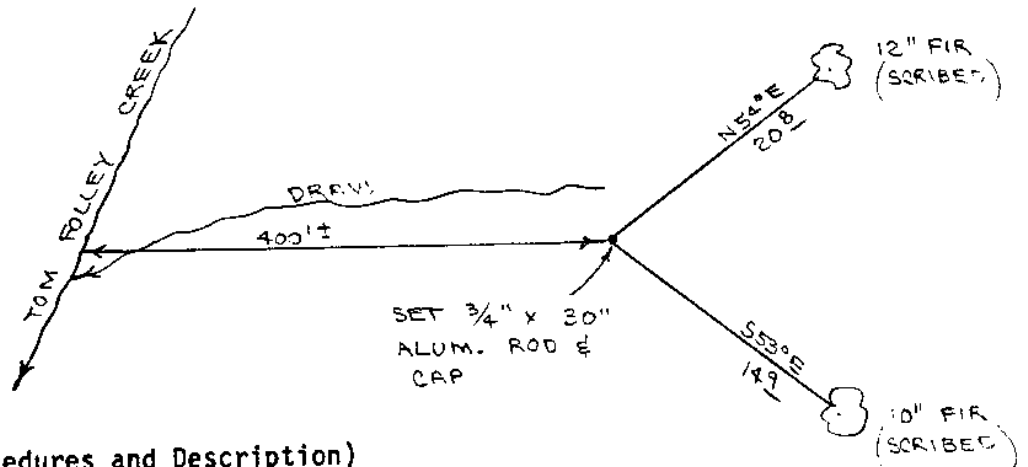

Monument Set (Procedures and Description)

Set 3/4" x 30" aluminum rod with 3/4" aluminum cap. Buried purple magnetic marker under 30" aluminum rod. Set 72" aluminum post, with land monument survey sign bolted to, beside aluminum rod. See filed survey for survey procedures.

New Accessories

10" Fir, S53E, 14.9' (Scribed/Painted Red/Brass Washers)

12" Fir, N54E, 20.8' (Scribed/Painted Red/Brass Washers)

Location & Comments

Corner lies on North slope Compass Declination 20 1/2

about 400 feet East of Big Firm/Agency Roberts

Tom Folley Creek Surveying, Inc.

Address 29 West 29th St.

Eugene, Oregon 97405

Party Chief Stuart Duce

Notes

Witness Rick Jones

Surveyor's Seal

REGISTERED  
PROFESSIONAL  
LAND SURVEYOR

*L. D. Roberts*

OREGON  
REGISTERED 1975  
L. D. ROBERTS  
1039

C.S. File No. 63/138-22  
F

M 115-23

FILED

*sh*

OCT 6 1992

OREGON CORNER RESTORATION FORM

Section 26 Township 21S Range 7W

County Douglas Date 06-05-92

COUNTY SURVEYOR  
DOUGLAS COUNTY, ORE.

CORNER DESIGNATION

South 1/4 Corner  
Section 26

- Condition Report Only
- Not Found
- Renewed
- Unrecorded
- Surveyed In
- Referenced Out

Previous Renewals/Surveys, etc. 1883 G.L.O. Survey by Laban Wheeler.  
1981 B.L.M. Cadastral Survey.

Monument(s) & Accessories Found: (Condition and Source)

Found 1981 B.L.M. Brass Cap set firmly in the ground.  
22" Fir, N51E, 32.0' (Scar Vis.), 1981 BT. Record N51E, 31.7'  
24" Fir, S36E, 42.9' (Scar Vis.), 1981 BT. Record S35E, 42.5'

Monument Detail

Sketch

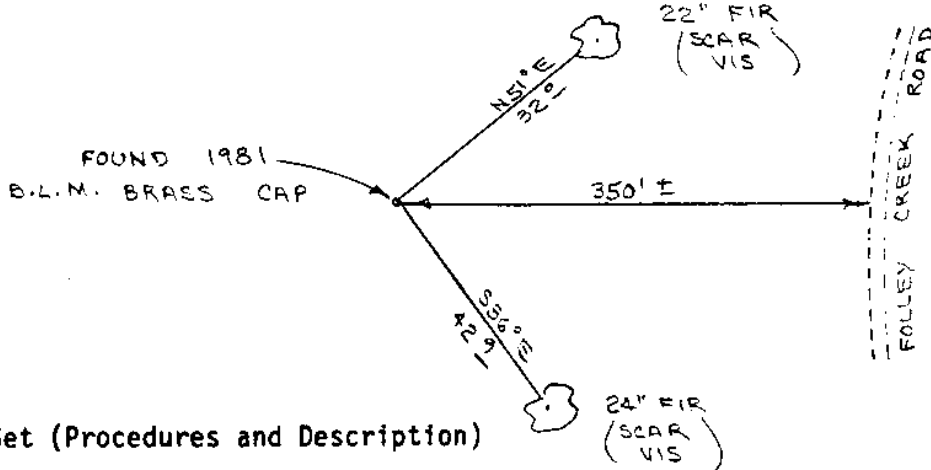

Monument Set (Procedures and Description)

New Accessories

Set 72" aluminum post, with land monument survey sign bolted to, beside  
brass cap. Painted all bearing trees red.

Location & Comments

Corner lies on steep East Compass Declination 20 1/2  
slope about 350 feet West Firm/Agency Roberts  
of Big Tom Folley Creek Surveying Inc.  
Road. Address 29 West 29th St,  
Eugene, Oregon 97405  
Party Chief Ted Baker  
Notes  
Witness Stuart Duce

Surveyor's Seal

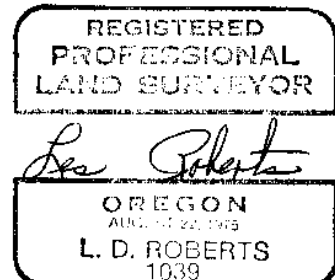

C.S. File No. 63/138-22  
6.

M 115-63

FILED

JK

OCT 6 1992

OREGON CORNER RESTORATION FORM

Section 26 Township 21S Range 7W

County Douglas Date 06-30-92

COUNTY SURVEYOR  
DOUGLAS COUNTY, ORE.

CORNER DESIGNATION

S.W. Corner  
Section 26

- Condition Report Only
- Not Found
- Renewed
- Unrecorded
- Surveyed In
- Referenced Out

Previous Renewals/Surveys, etc. 1883 G.L.O. Survey by Laban Wheeler.  
1981 B.L.M. Cadastral Survey. See renewal #17 in 1957.

Monument(s) & Accessories Found: (Condition and Source)

- Found 1957 Douglas County Brass Cap set firmly in the ground.
- 16" Yew, S67W, 21.2' (Scar Vis.), 1883 BT. Record S66W, 21.1'
  - 38" Fir Stump, S41E, 38.0' (No Marks), 1883 BT. Record S41E, 37.6'
  - 44" Fir, N63W, 24.0' (Scar Vis.), 1883 BT. Record N65W, 23.1'
  - 14" Fir, N14W, 10.1' (Scar Vis.), 1957 BT. Record N14W, 10.4'
  - 20" Hemlock, N34E, 44.6' (Scar Vis.), 1957 BT. Record N33E, 45.6'
  - 24" Hemlock, S16W, 40.1' (Scar Vis.), 1957 BT. Record S15 1/2 W, 40.8'
  - 28" Fir, S84E, 44.1' (Scar Vis.), 1957 BT. Record S85E, 45.2'

Monument Detail

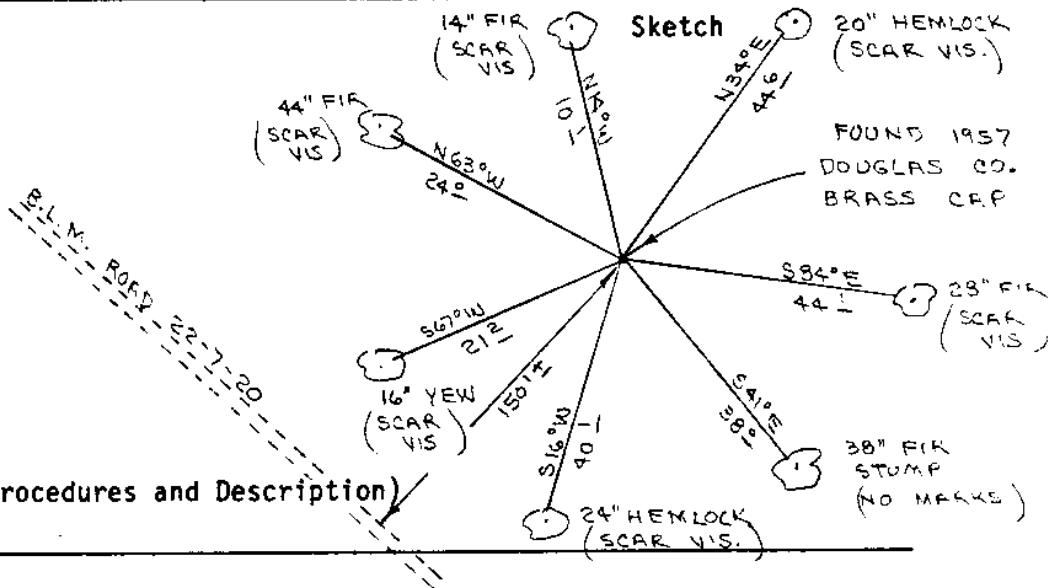

Monument Set (Procedures and Description)

New Accessories

Set 72" aluminum post, with land monument survey sign bolted to, beside  
brass cap. Painted all bearing trees red.

Location & Comments

Corner lies on S.E. slope about 150' from B.L.M. Road 22-7-20.

Compass Declination 20 1/2

Firm/Agency Roberts Surveying, Inc.

Address 29 West 29th St. Eugene, Oregon 97405

Party Chief Ted Baker

Notes

Witness Stuart Duce

Surveyor's Seal

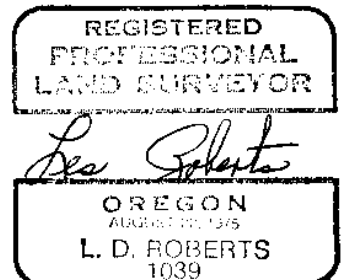

C.S. File No. 63/138-22

M115-63

FILED

OCT 6 1992

OREGON CORNER RESTORATION FORM

Section 26 Township 21S Range 7W

County Douglas Date 06-07-92

COUNTY SURVEYOR  
DOUGLAS COUNTY, ORE.

CORNER DESIGNATION

North 1/4 Corner  
Section 26

- Condition Report Only
- Not Found
- Renewed
- Unrecorded
- Surveyed In
- Referenced Out

Previous Renewals/Surveys, etc. 1883 G.L.O. Survey by Laban Wheeler.  
See renewal #48 in 1960, renewal #51 in 1961 and renewal #116 in 1984.

Monument(s) & Accessories Found: (Condition and Source)

- Found 1" x 1" x 36" "T" iron set by Wilford Haines in 1960.
- 26" Maple, N15E, 22.0' (No Marks), 1883 BT. Record N14E, 24.4'
- 54" Fir Snag, S01W, 38.0' (Bark Scribe), 1883 BT. Record South, 42.2'
- 16" Fir Stump, N11W, 58.5' (No Marks), 1961 BT. Record N11W, 58.8'
- 6" Fir, N54W, 20.3' (Scar Vis.), 1984 BT. Record N54 1/2 W, 20.1'
- 16" Cedar, S57E, 54.0' (Scar Vis.), 1984 BT. Record S57 1/2 E, 53.9'

Monument Detail

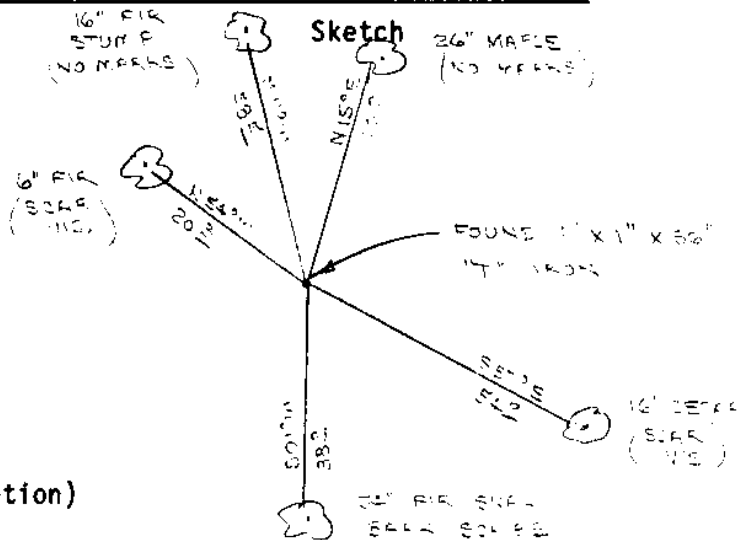

Monument Set (Procedures and Description)

\_\_\_\_\_  
 \_\_\_\_\_  
 \_\_\_\_\_  
 \_\_\_\_\_

New Accessories

Set 72" aluminum post, with land monument survey sign bolted to, beside  
"T" iron. Painted all bearing trees red.

Location & Comments

Corner lies on very steep North slope at the head of a small draw. Compass Declination 20 1/2  
Firm/Agency Roberts Surveying, Inc.  
Address 29 West 29th St. Eugene, Oregon 97405  
Party Chief Les Roberts  
Notes  
Witness Stuart Duce

Surveyor's Seal

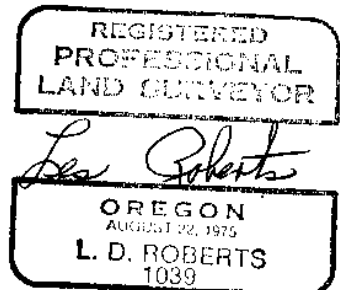

C.S. File No. 63/138-22

M 115-63

FILED

OCT 6 1992

OREGON CORNER RESTORATION FORM

Section 26 Township 21S Range 7W

County Douglas Date 06-05-92

COUNTY SURVEYOR  
DOUGLAS COUNTY, ORE.

CORNER DESIGNATION

East 1/4 Corner  
Section 26

- Condition Report Only
- Not Found
- Renewed
- Unrecorded
- Surveyed In
- Referenced Out

Previous Renewals/Surveys, etc. 1883 G.L.O. Survey by Laban Wheeler.  
1981 B.L.M. Cadastral Survey.

Monument(s) & Accessories Found: (Condition and Source)

Found 1981 B.L.M. Brass Cap set firmly in the ground.

5" Fir, N50W, 15.7' (Scar Vis.), 1981 BT. Record N49W . 15.8'

24" Fir, N64E, 18.3' (Scar Vis.), 1981 BT. Record N65 1/2 E, 18.1'

Monument Detail

Sketch

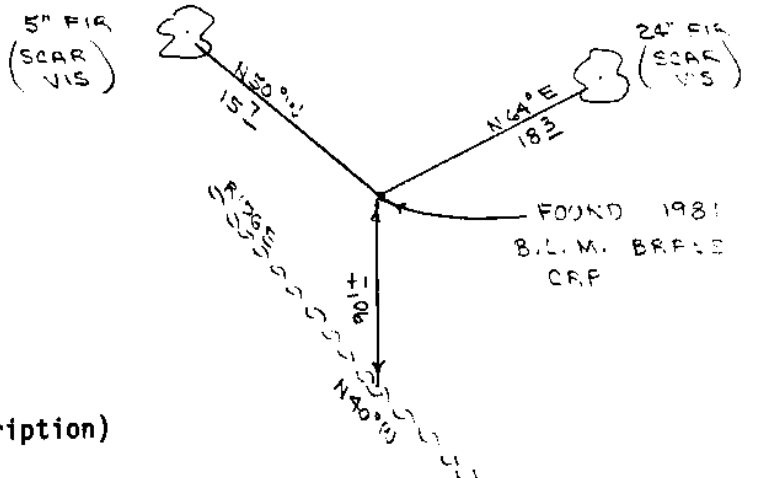

Monument Set (Procedures and Description)

\_\_\_\_\_  
\_\_\_\_\_  
\_\_\_\_\_  
\_\_\_\_\_

New Accessories

Set 72" aluminum post, with land monument survey sign bolted to, beside  
brass cap. Painted all bearing trees red.

Location & Comments

Corner lies on N.W. slope Compass Declination 20 1/2  
about 90 feet North of spur Firm/Agency Roberts  
ridge. Ridge bears N40W. Surveying, Inc.  
Address 29 West 29th St.  
Eugene, Oregon 97405  
Party Chief Ted Baker  
Notes  
Witness Stuart Duce

Surveyor's Seal

REGISTERED  
PROFESSIONAL  
LAND SURVEYOR

*L.D. Roberts*  
OREGON  
AUGUST 22, 1975  
L. D. ROBERTS  
1039