

SURVEY OF THE SECTION LINE BETWEEN SECTIONS 21 AND 28, T.29S., R.7W., W. M.,

COUNTY SURVEYORS FILE DATA
DO NOT REMOVE FROM OFFICE

DOUGLAS COUNTY, OREGON

MARCH 1, 1992

FOR HERZSTEIN, SINDERBRAND, TAYLOR, AND WESTBROOK

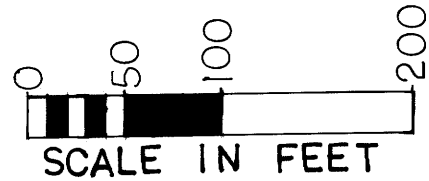

REGISTERED
PROFESSIONAL
LAND SURVEYOR

LEH

OREGON
JULY 26, 1985
LEONARD E. HERZSTEIN
2150

3-24-92

HERZSTEIN/SINDERBRAND
SW 1/4 SE 1/4, SEC. 21

BASIS OF BEARINGS (N 89° 15' W, 19.42 CHAINS = 1281.72 FEET)
N 89° 15' W, 1282.0 FEET

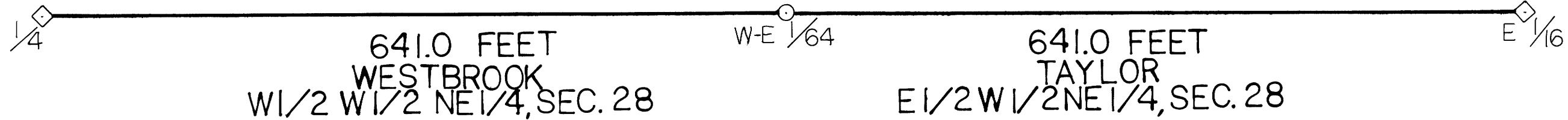

LEGEND

- ◇ FOUND BRASS CAP, SEE NARRATIVE
- SET ALUMINUM CAP, SEE NARRATIVE
- () RECORD PER B.L.M., 1966

LEONARD E. HERZSTEIN 1741 BYRON CREEK ROAD, WINSTON, OREGON, 97496 L.S. 2150

63/56 (MRR)
M 114 - 65

63/56
M 114 - 65

SURVEY NARRATIVE TO ACCOMPANY SURVEY PLAT OF
SECTION 21 AND 28, T. 29 S., R. 7 W.,
WILLAMETTE MERIDIAN
DOUGLAS COUNTY, OREGON

This survey was made at the request of David and Candi Taylor, Robert Westbrook, Leonard Herzstein and Sharon Sinderbrand. The accompanying plat correctly represents the survey I performed from July, 1991 to March, 1992. The purpose of this survey was to locate the section line of Sections 21 and 28 between the 1/4 corner and the East 1/16 corner and to establish the West-East 1/64 corner.

The section line was originally established by Nathaniel Ford in 1854. The original section corner of Sections 21, 22, 27 and 28 and the original 1/4 corner of Sections 21 and 28 were recovered in 1966 by B. L. M. Cadastral Surveyor, John M. Jelley. B. L. M. also established the East 1/16 corner on the section line.

The control traverse was run with a 20" optical transit (Lietz 10B) and a 200 foot steel tape. The basis of bearing was the record bearing on the section line between the East 1/16 corner and the 1/4 corner from the 1966 B. L. M. survey. The W-E 1/64 corner was established at mid-point between the found corners. The true line was blazed.

All bearing trees (BTs) were measured to the center of the tree rootcrown. The bearings to the new BTs were determined by tying the trees to the control traverse and using values to the nearest 15 minutes. BT sizes were diameters taken at breast height.

CORNERS FOUND

1/4 corner of S21 and S28: I found a 2-1/4 inch diameter iron pipe, firmly set by B.L.M. in 1966, projecting 6 inches above the ground, with a 3 inch diameter brass cap attached and marked as shown.

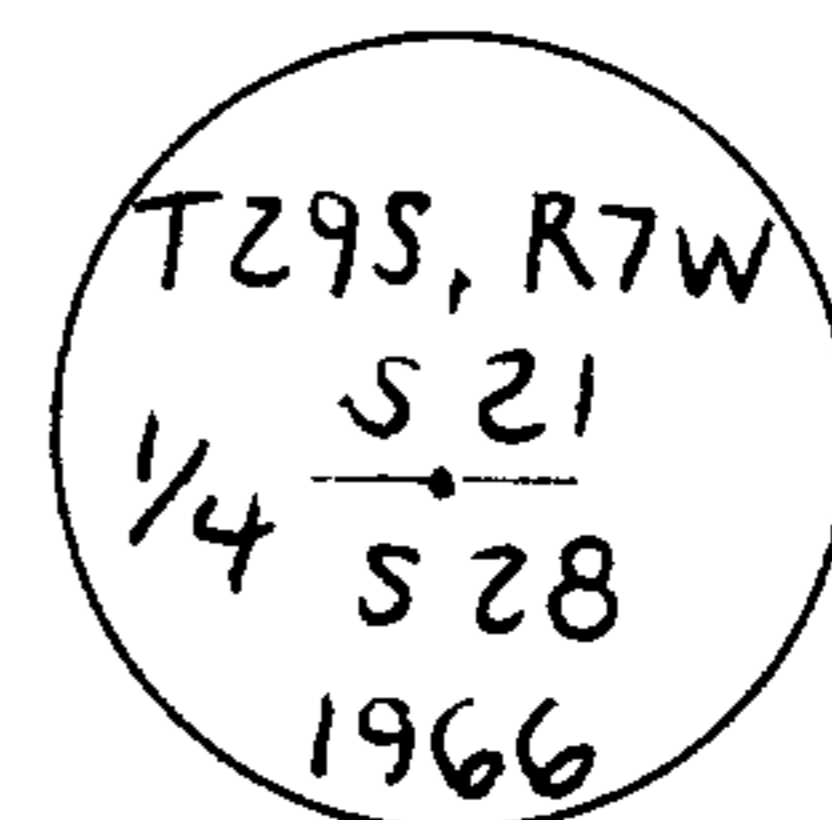

From which the bearing trees marked by B.L.M. in 1966:

- a 30" white fir, bears N 58°E, 56.8 ft., with a healed double blaze.
- a 16" Douglas fir, bears S 60°E, 27.9 ft., with a healed double blaze. (Record 43 lks = 28.38 ft.)

M 114-65

SECTIONS 21 AND 28, T. 29 S., R. 7 W.

East 1/16 corner of S21 and S28: I found a 2-1/4 inch diameter iron pipe, firmly set by B.L.M. in 1966, projecting 6 inches above the ground, with a 3 inch diameter brass cap attached and marked as shown.

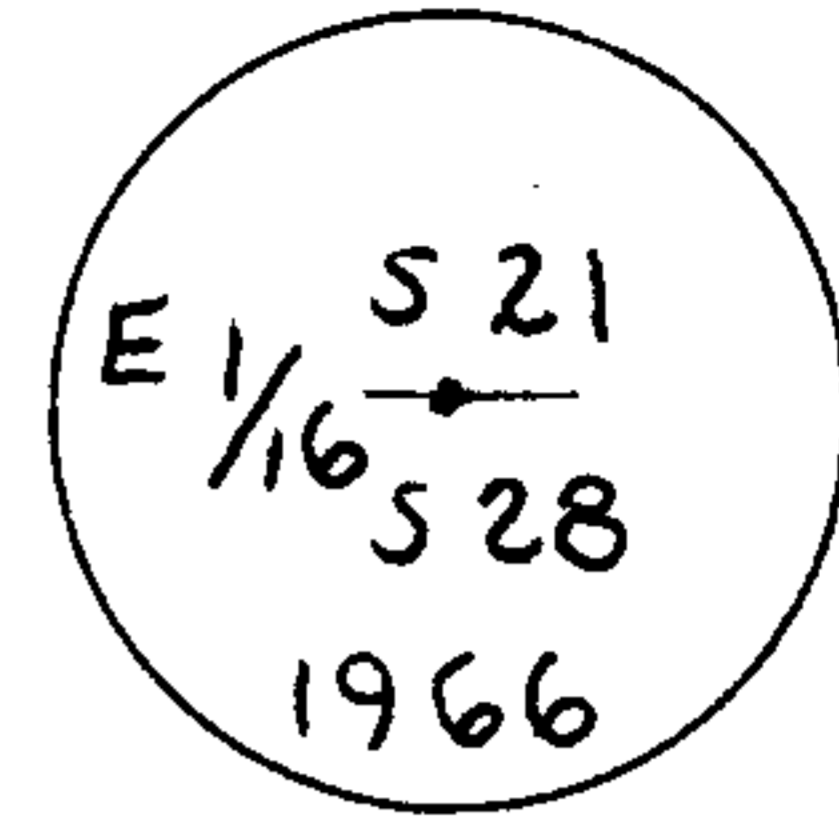

From which the bearing trees marked by B.L.M. in 1966:

- a 22" ponderosa pine, bears N 71-1/2°W, 31.7 ft., with a healed double blaze.
- a 18" ponderosa pine, bears S 51°W, 20.5 ft., with a healed double blaze.

CORNER SET

West-East 1/64 corner of S21 and S28: I set a 5/8 inch diameter rebar, 30 inches long, driven 30 inches in the ground, with a 2 inch diameter aluminum cap attached and stamped as shown.

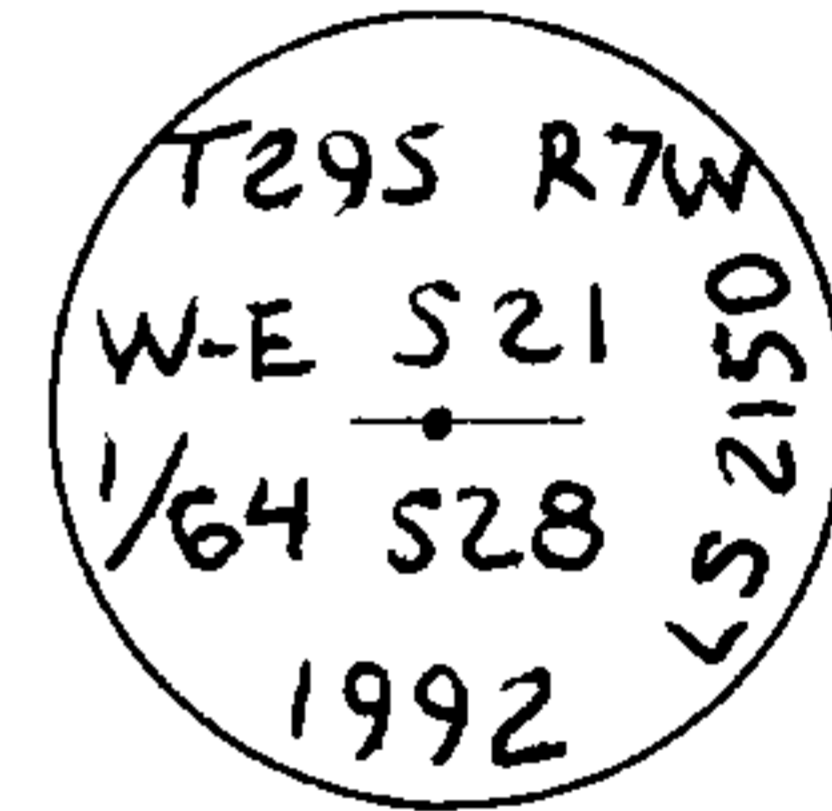

From which I mark new bearing trees:

- an 8" Douglas fir, bears N 11-1/4°E, 6.8 ft., scribed "1/64 S21 BT" on a single blaze.
- a 6" Douglas fir, bears S 82-1/4°E, 21.8 ft., scribed "S28" "BT" on a double blaze.

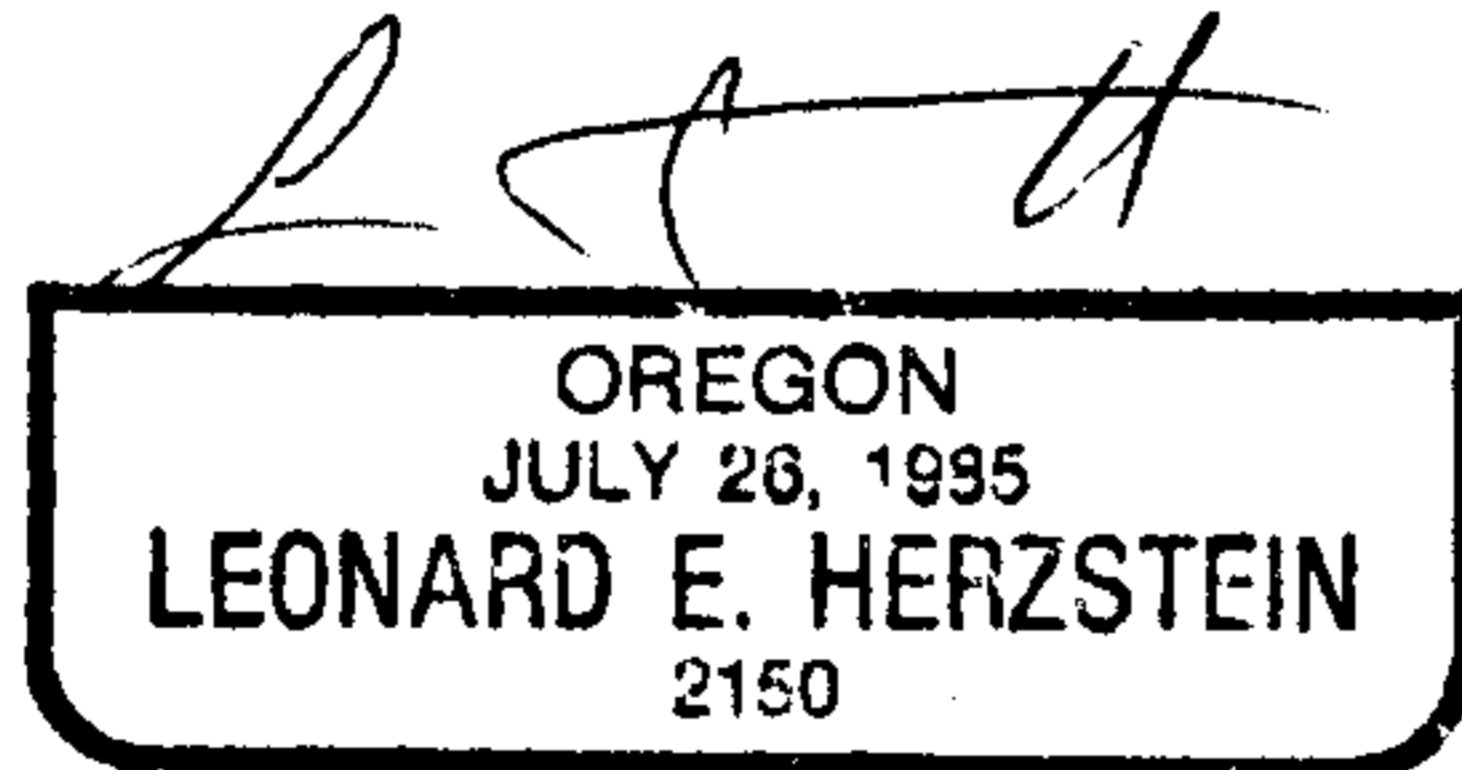
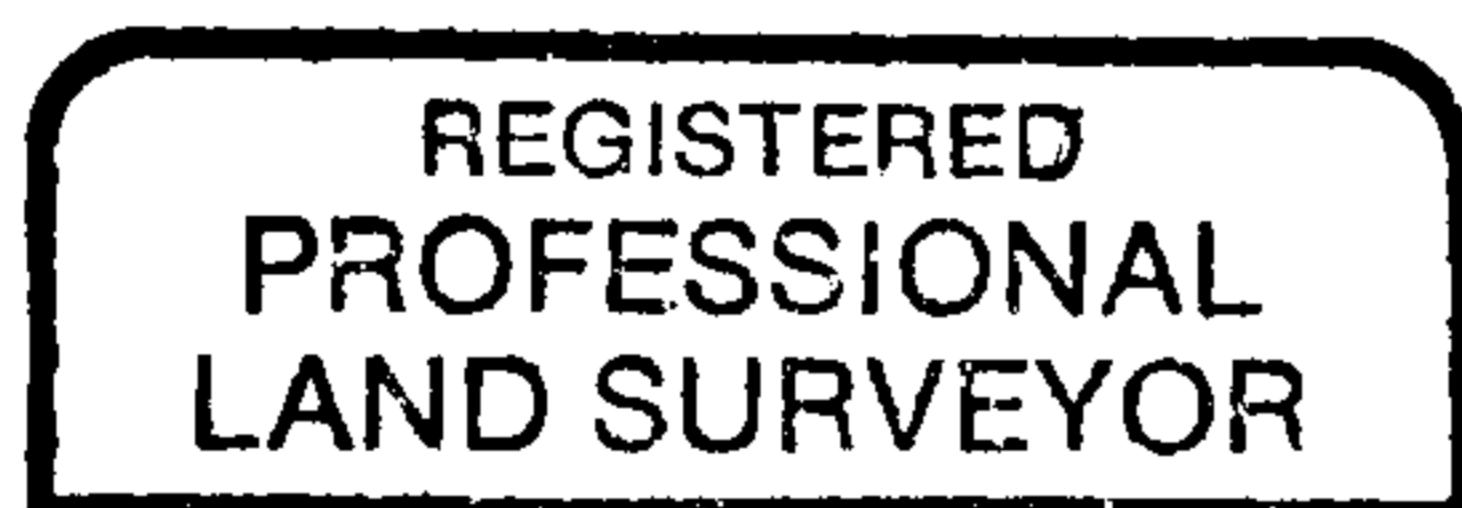

3-24-92

FILED JP

MAR 25 1992

COUNTY SURVEYOR DOUGLAS COUNTY, ORE.

Leonard E. Herzstein, 1741 Byron Creek Road, Winston, Oregon